

T. 3 N., R. 29 E., W.M.

RECEIVED

JAN 31 2000

TRANSFER APPLICATION
ADDITIONAL POINT OF DIVERSION

UNDER
CERTIFICATE NO. 75837

IN NAME OF
RON HOLEMAN

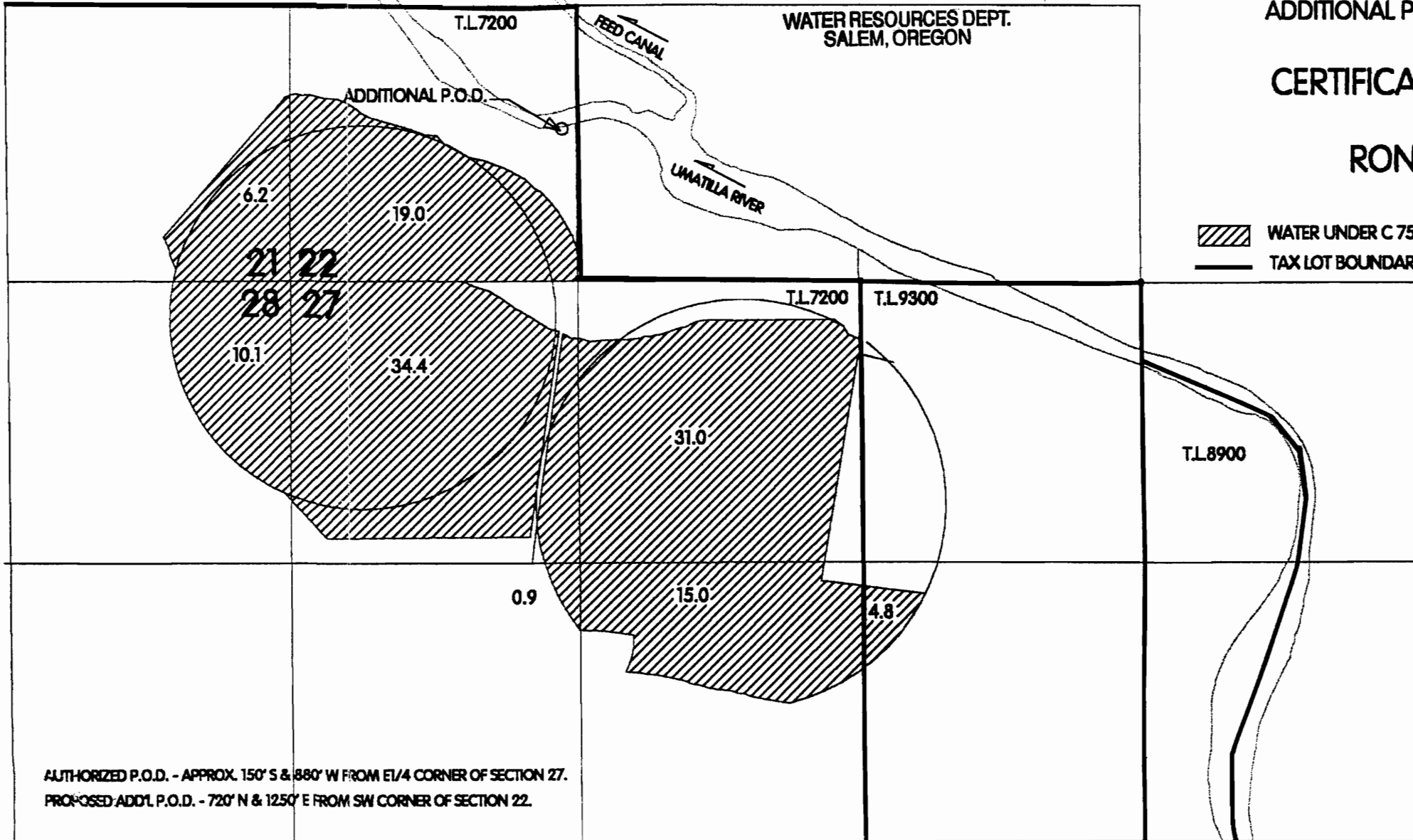

WATER UNDER C 75837 SUBJECT TO TRANSFER
 TAX LOT BOUNDARY



SCALE 1" = 660'

T-8431

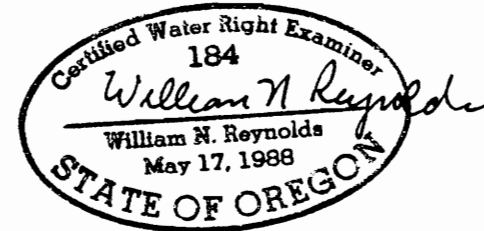

AUTHORIZED P.O.D. - APPROX. 150' S & 880' W FROM E1/4 CORNER OF SECTION 27.
PROPOSED ADD'L P.O.D. - 720' N & 1250' E FROM SW CORNER OF SECTION 22.

The preparation of this map is for the purpose of identifying the location of water rights only, and has no intent to provide dimensions or locations of property ownership lines.

AUTHORIZED P.O.D.