

T.5S. R.1W. Sec. 26 & 35

APR 15 2003

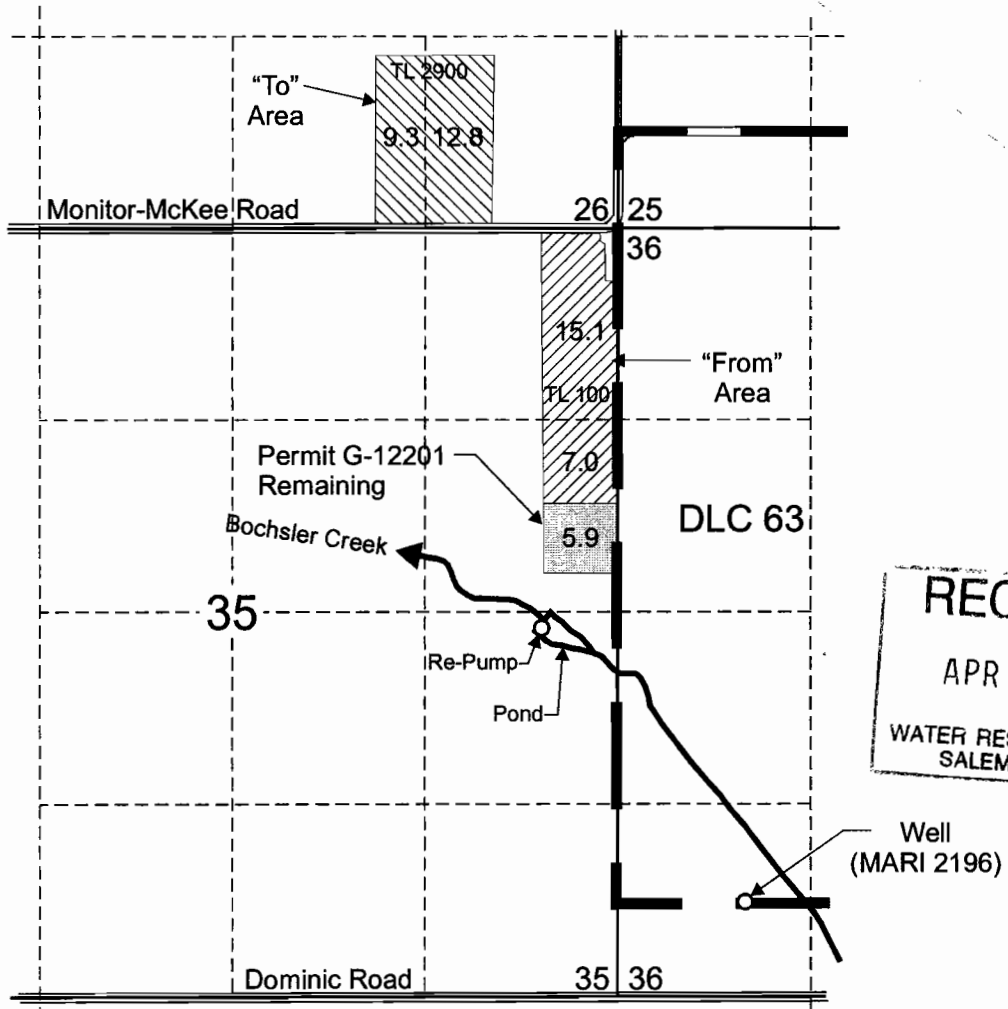

RECEIVED
 APR 15 2003
 WATER RESOURCES DEPT
 SALEM, OREGON

Well (MARI 2196) is located 660 feet north and 870 feet east of the southwest corner of Section 36.

- Area (5.9 Acres) remaining under Application G-12879, Permit G-12201.
- "From" Area (22.1 Acres)
- "To" Area (22.1 Acres)

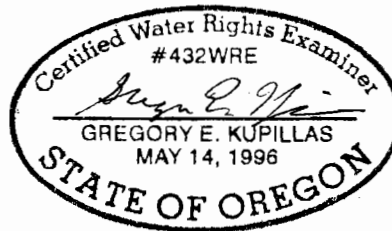

EXPIRATION DATE: 6/30/03

Scale: 1" = 1,320'



This map was prepared for the purpose of identifying the location of a water right only and is not intended to provide legal dimensions or location of property ownership lines.

Map to Accompany a Water Right Transfer

Pacific Hydro-Geology Inc.

Dan Hammelman
 T.5S. R.1W. Sec. 26, Tax Lot 2900 and
 T.5S. R.1W. Sec. 35, Tax Lot 100

T9406