

# TRANSFER APPLICATION MAP FROM PERMIT G-11302

T35S R6W Sec 9 NW1/4 W.M.  
Josephine County  
May 13, 2003

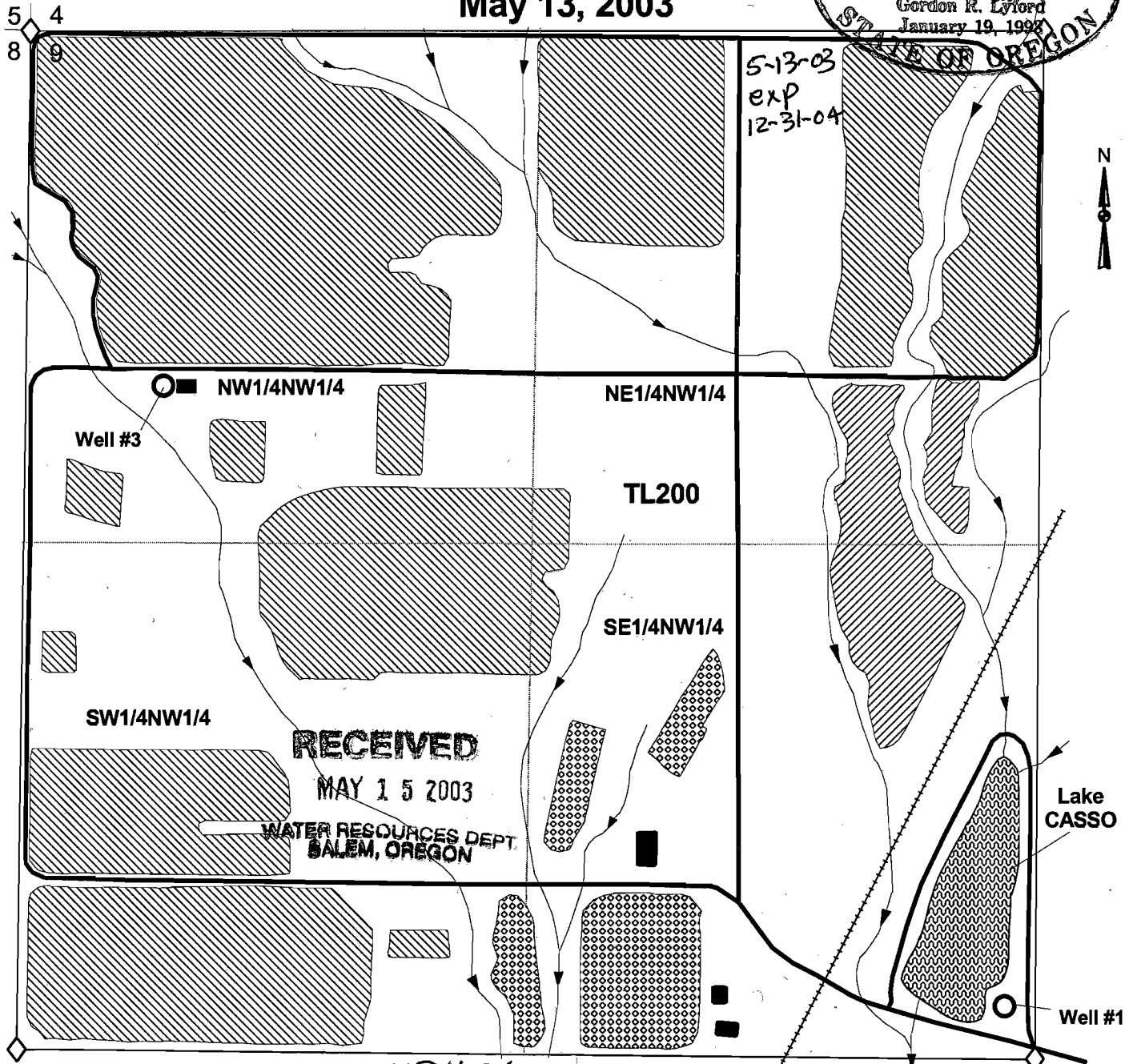
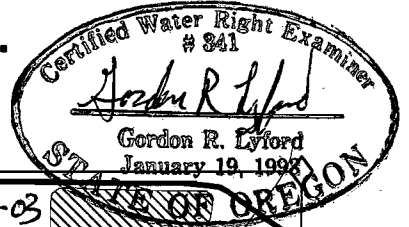

## Legend

- Wells
- Orchard Roads
- ++++ Railroad
- ▶ Streams
- Buildings
- ~~~~~ Reservoir

Scale: 1" = 400'

- 22.4 acres NW1/4NW1/4, 19.5 acres SW1/4NW1/4, 13.5 acres NE1/4 NW1/4, and 0.5 acres SE1/4NW1/4 of irrigation water rights with a priority of September 29, 1987 from Well #3 under Permit G-11302 and Application G-11703. See the claim of Beneficial Use Survey Site Report and Map dated May 1, 2002. Remaining rights, no changes proposed.
- 2.4 acres NE1/4NW1/4, and 2.6 acres SE1/4NW1/4 of irrigation water rights with a priority of September 29, 1987 from Well #3 under Permit G-11302 and Application G-11703. See the Claim of Beneficial Use Survey Site Report and Map dated May 1, 2002. Proposed change in Place of Use and change in Point of Appropriation to Well #1.
- 0.5 acres SW1/4NW1/4, and 4.5 acres SE1/4NW1/4 for proposed new Place of Use and Point of Appropriation from Well #1.

Well #1 is located 120 feet North and 70 feet West of the center of Section 9.  
Well #3 is located 920 feet South and 380 feet East of the Northwest corner of Section 9.

This map was prepared by Gordon R. Lyford and Glenn Calascibetta for the Bureau of Land Management that manages tax lot 200. This map was prepared for the purposes of identifying the location of water rights only and is not intended to provide legal dimensions or the location of property ownership lines.