

TRANSFER APPLICATION MAP IN THE NAME OF KIRPAL LIGHT SATSANG, INC.

PERMIT 50121

CERTIFICATE PENDING

SECTIONS 9 & 10, TOWNSHIP 25 SOUTH, RANGE 7 WEST, W.M.

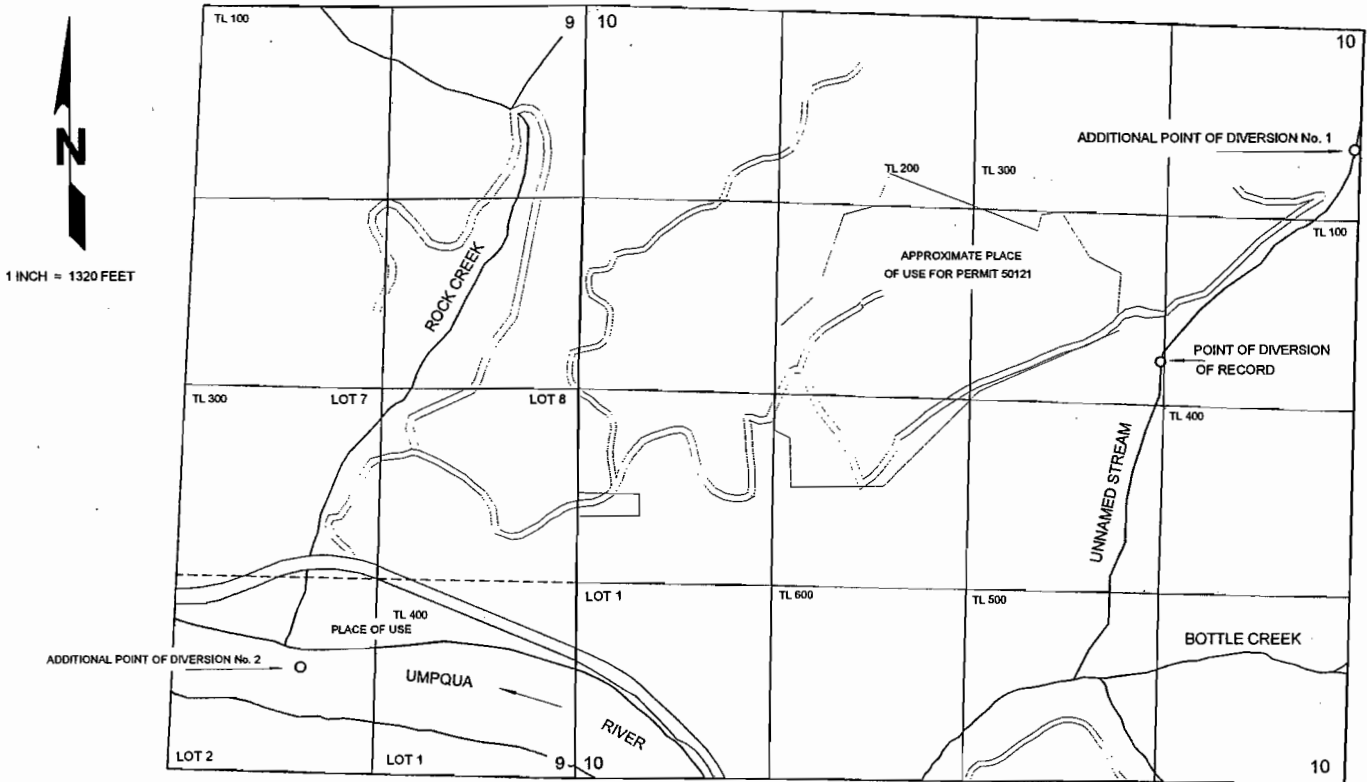

THE ORIGINAL POINT OF DIVERSION ON THE UNNAMED STREAM IS LOCATED 2480 FEET SOUTH AND 3950 FEET EAST FROM THE NORTHWEST CORNER OF SECTION 10, WITHIN THE SE $\frac{1}{4}$ NE $\frac{1}{4}$;
 ADDITIONAL POINT OF DIVERSION No. 1 IS TO BE LOCATED ON THE UNNAMED STREAM 825 FEET SOUTH AND 60 FEET WEST FROM THE NORTHEAST CORNER OF SECTION 10, WITHIN THE NE $\frac{1}{4}$ NE $\frac{1}{4}$; AND
 ADDITIONAL POINT OF DIVERSION No. 2 IS TO BE LOCATED ON THE UMPQUA RIVER 775 FEET NORTH AND 1880 FEET WEST FROM THE SOUTHEAST CORNER OF SECTION 9, WITHIN THE SE $\frac{1}{4}$ SE $\frac{1}{4}$;
 ALL WITHIN TOWNSHIP 25 SOUTH, RANGE 7 WEST, W.M.; DOUGLAS COUNTY.

THE PIPELINES FROM BOTH THE NEW ADDITIONAL POINTS OF DIVERSION WILL BE PLACED ALONG, OR WITHIN, THE ROADWAYS.

RECEIVED

MAY 23 2003

WATER RESOURCES DEPT.
SALEM, OREGON

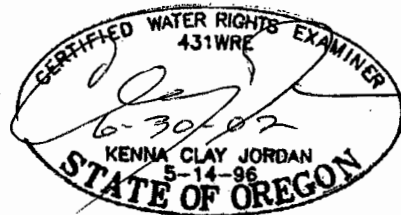

THE PURPOSE OF THIS MAP IS TO IDENTIFY THE LOCATION OF THE WATER RIGHT.
 IT IS NOT INTENDED TO PROVIDE INFORMATION RELATIVE TO THE LOCATION OF
 PROPERTY OWNERSHIP BOUNDARY LINES.

T9448