

FINAL PROOF MAP T-8961
 NE1/4SW1/4, SEC. 3, T.39S., R.3W., W.M.
 JACKSON COUNTY, OREGON
 FOR
 WILLIAM D. WRIGHT
 2433 UPPER APPLGATE ROAD
 JACKSONVILLE, OREGON 97530

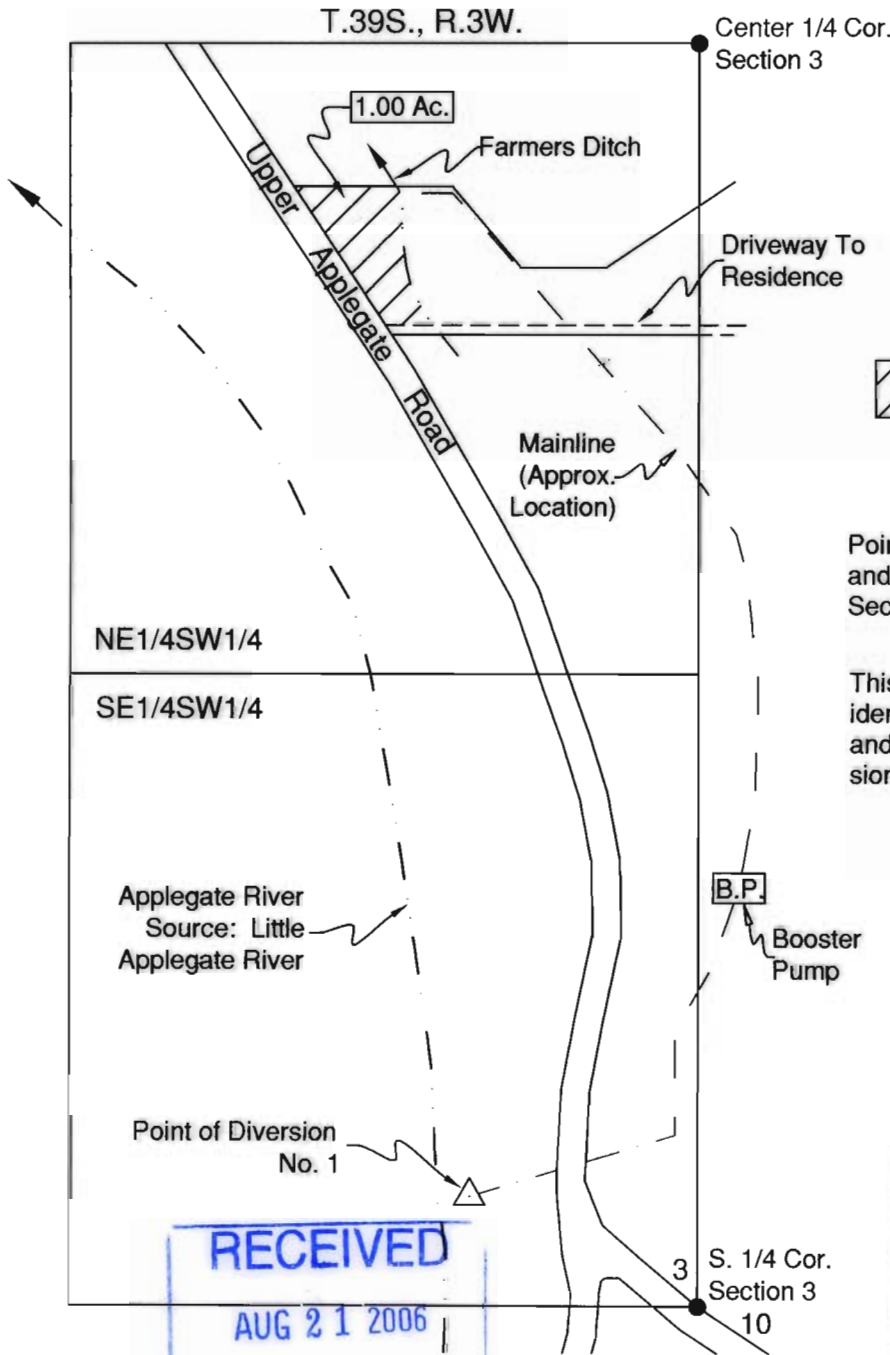

Scale: 1"=400'
 Date: July 19, 2006

LEGEND

- Found Survey Monument
- ▨ Denotes Area Under Special Order Volume 59 Pages 464-467, Priority Date Sept. 1, 1857.

Point of Diversion No. 1 - Situated 480' West and 230' North of South One-Quarter Corner, Section 3. Fish Screen at Point of Diversion

This map was prepared for the purpose of identifying the location of a water right only and is not intended to provide legal dimensions or location of property ownership.



HAROLD L. CENTER
 2604 David Lane
 Medford, OR. 97504
 Phone 541-535-6108
 Oregon Certificate No. 152
 Certificate Renewal Date: 12/31/2007

RECEIVED
 AUG 21 2006
 WATER RESOURCES DEPT
 SALEM, OREGON