

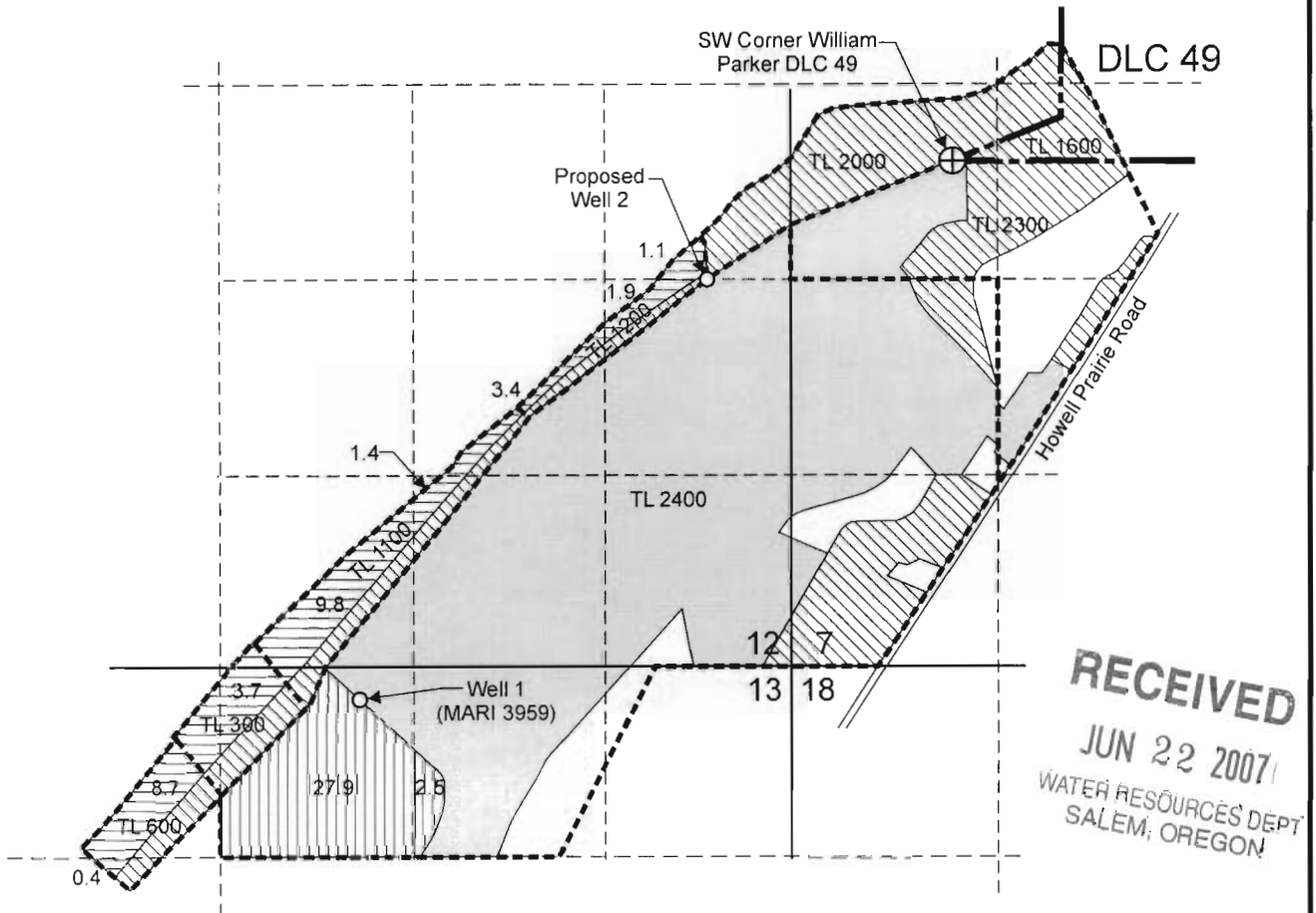





# T.6S. R.1&2W. Section 7, 12, & 13, W.M.



Existing Well 1 (MARI 3959) is located 210 feet south and 2,980 feet west from the NE corner, Section 13.

Proposed Well 2 is located 800 feet south and 1,690 feet west from the SW corner, William Parker DLC 49.

-  "From" area (30.4 Acres proposed for primary irrigation under Permit G-15990.
-  "To" area (30.4 Acres).
-  Remaining area (92.1 acres) proposed for primary irrigation under Permit G-15990.
-  Area (225.7 acres) proposed for supplemental irrigation under Permit G-15990.
-  Tax lot boundary



EXPIRATION DATE: 6/30/09

This map was prepared for the purpose of identifying the location of a water right only and is not intended to provide legal dimensions or location of property ownership lines.

Scale: 1" = 1,320'



Map to Accompany a Permit Amendment  
Permit G-15990 (Application G-15722)

Jacksons Inc.  
William and Janice Cox

Pacific Hydro-Geology Inc.

Rvsd 11/2006