

RECEIVED

APR 11 2011

WATER RESOURCES DEPT
SALEM, OREGON

Attachment A
Map of "From" Lands

T 11227

ATTACHMENT A

Terra Poma Land, LLC

Jasa Portion, Certificate 52082, Transfer Application 'From' Lands

Township 4 North, Range 26 East (W.M.) Morrow County

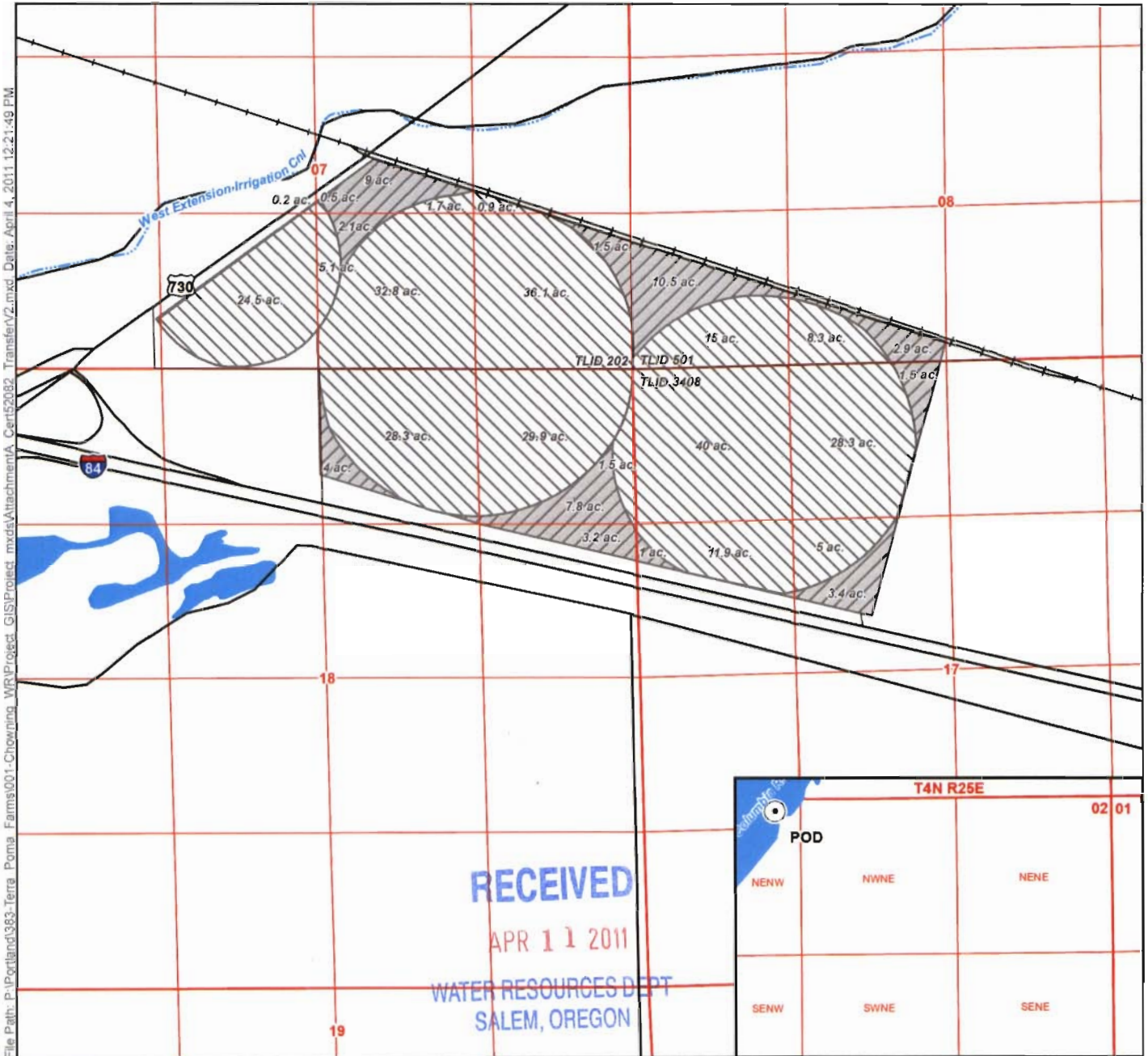

File Path: P:\Portland\363_Terra_Poma_Farms\001-Chowping_WR\Project_GIS\Project_mxd\AttachmentA_Cert52082_Transfer\2.mxd, Date: April 4, 2011 12:21:49 PM

LEGEND

- POD
- ▨ From Land Acres to be Transferred Off
- ▩ Rights Remaining in Place C. 52082
- ⊕ Taxlots
- Roads
- Railroads
- ~ Watercourses
- Waterbodies

T 11227

Certified Water Rights Examiner Stamp

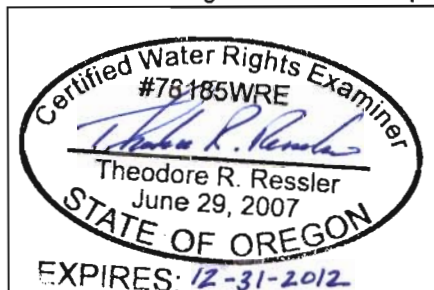

Disclaimer

This map was prepared for the purpose of identifying the location of a water right only and it is not intended to provide legal dimensions or location of property ownership lines.

Map Notes

Date: April 4, 2010
 Data Sources: ESRI, OWRD, BLM
 Prepared By: GSI Water Solutions, Inc.

POD Location Description

Point of Diversion
 Located 120 feet South and 2,980 feet West from the NE corner of Section 2, Township 4 North, Range 25 East, (W.M.)



RECEIVED

APR 11 2011

WATER RESOURCES DEPT
SALEM, OREGON

Attachment B
Map of "To" Lands

T 11227

ATTACHMENT B
Terra Poma Land, LLC
Transfer Application 'To' Lands
Township 3 North, Range 27 East (W.M.) Morrow County

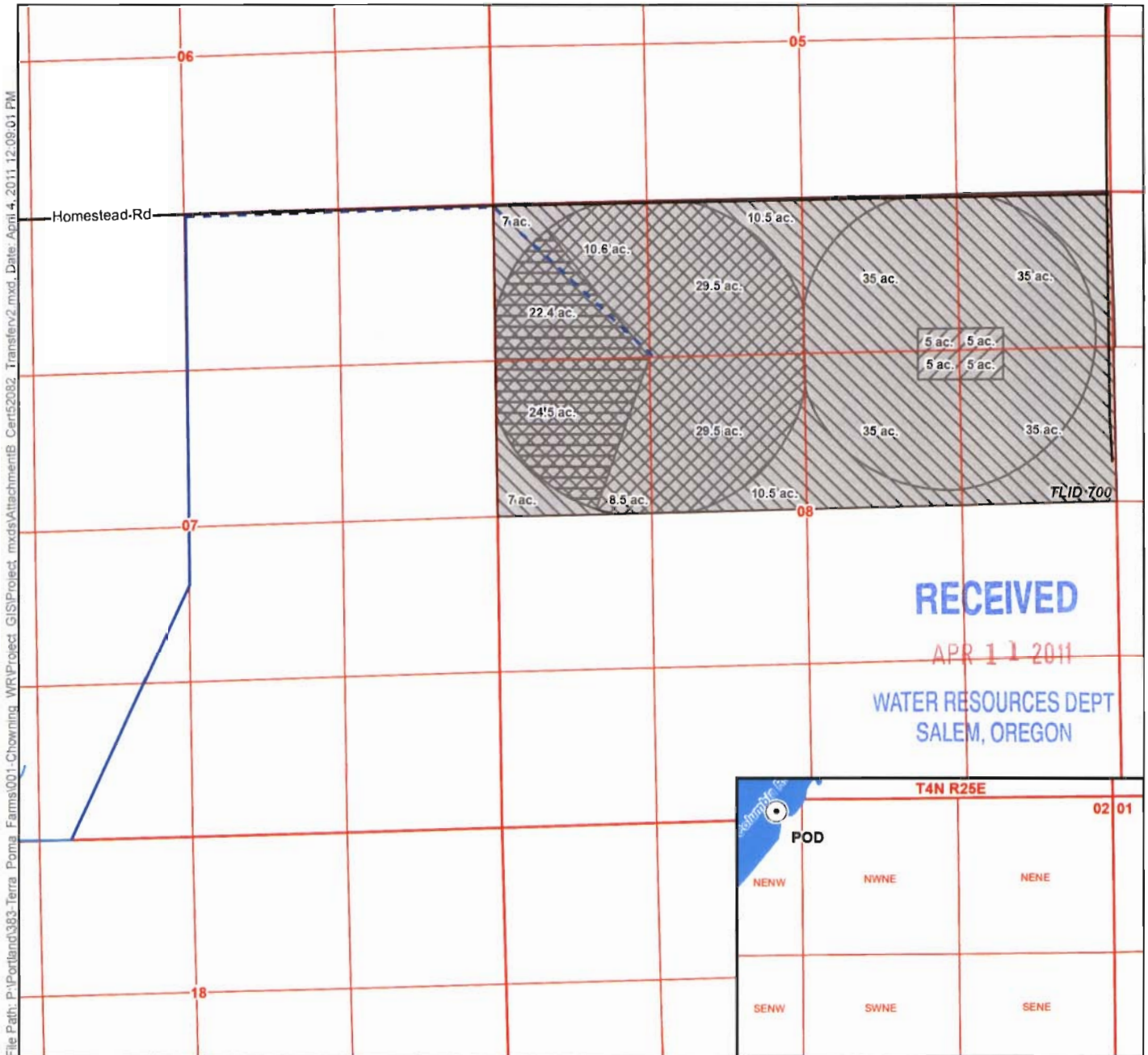

RECEIVED

APR 11 2011

WATER RESOURCES DEPT
 SALEM, OREGON

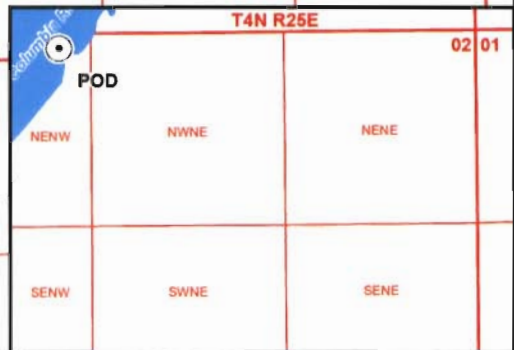

File Path: P:\Portland\383-Terra Poma Farms\001-Chowning_WR\Project_GIS\Project_mxd\AttachmentB_Cert52082_Transferv2.mxd, Date: April 4, 2011 12:08:01 PM

LEGEND

- Point of Diversion (POD)
- C.34280 Primary
- C.31097 Primary
- Diminish to Supplemental
- Transfer in C. 52082
- Pipeline
- Proposed Pipeline
- Canal
- Taxlots
- Roads
- Watercourses
- Waterbodies

T 11227

Certified Water Rights Examiner Stamp



Disclaimer

This map was prepared for the purpose of identifying the location of a water right only and it is not intended to provide legal dimensions or location of property ownership lines.

Map Notes

Date: April 4, 2010
 Data Sources: ESRI, OWRD, BLM
 Prepared By: GSI Water Solutions, Inc.

POD Location Description

Point of Diversion
 Located 120 feet South and 2,980 feet West
 from the NE corner of Section 2, Township 4 North,
 Range 25 East, (W.M.)

