

Map
 Showing Land
 of
 S.P. Williams
 Irrigated from
 Prairie Creek
 Rights

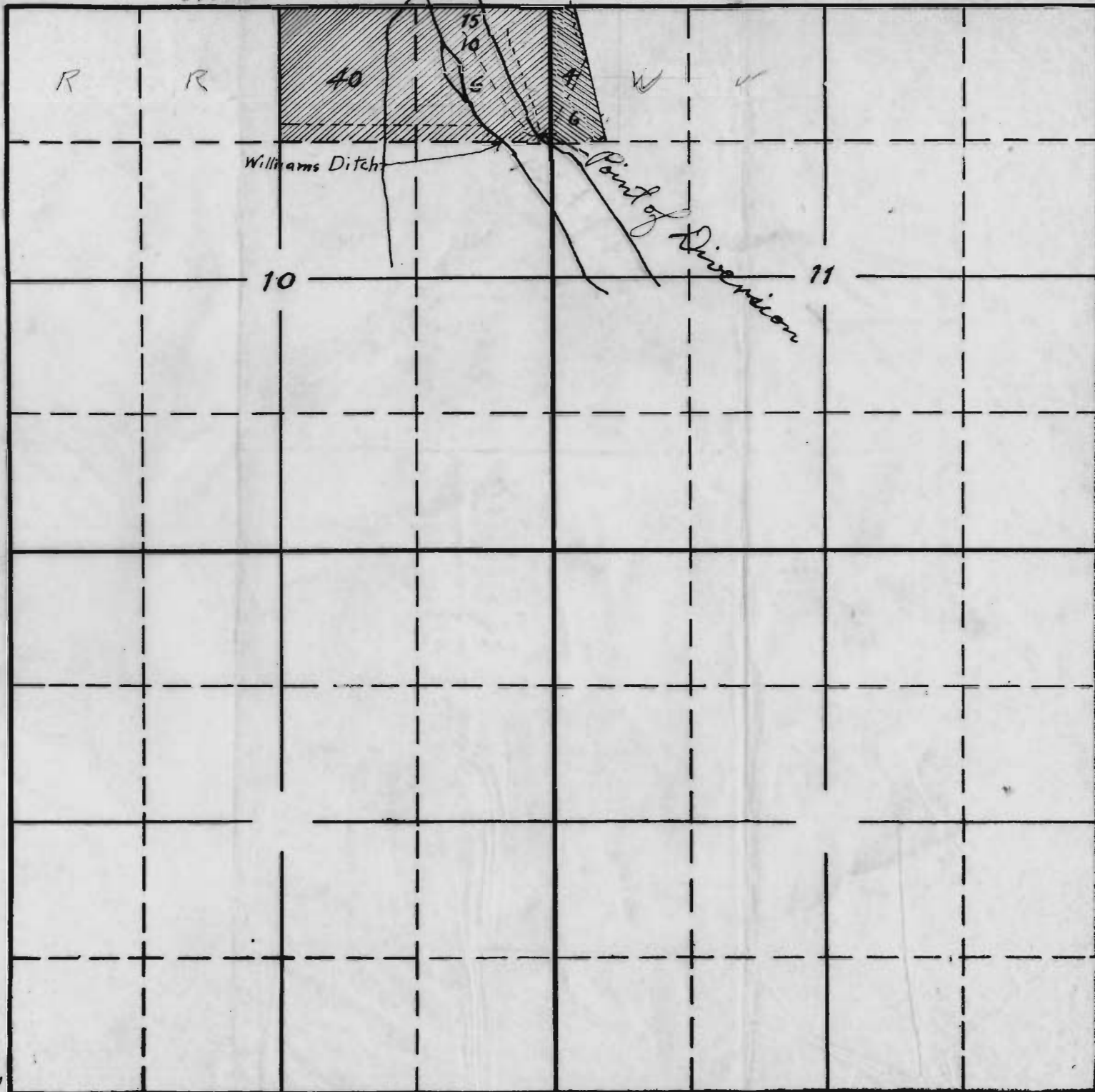

Sec. 10+11

Tp. 3 South

R. 45 East

West

East

-LEGEND-

 Irrigated Land with Areas

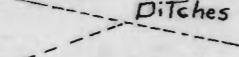
 Ditches

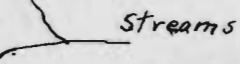
 Streams

Transfer W-6

Drawn from copy of
 Adjudication Map

Glenn Jacob

South