

T. 9 S. R. 40 E. W. M.

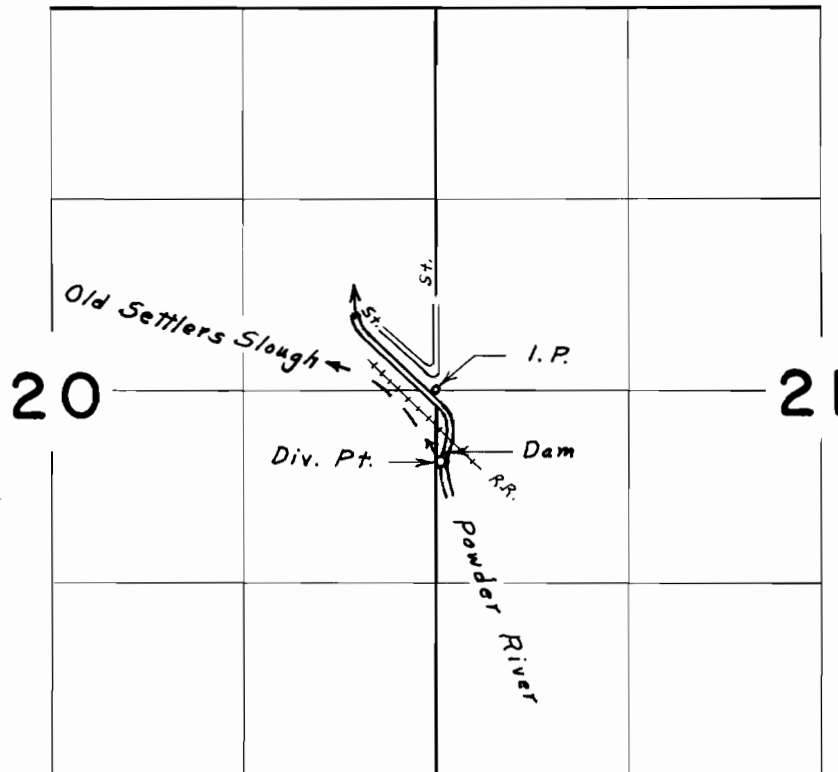

Div. Pt. located 400' S. & 30' E. from W. & Cor. Sec. 21

FINAL PROOF SURVEY
UNDER

Application No. _____ Transfer No. W-145
Permit No. _____

IN NAME OF

DAN R. WARNOCK, Jr.

Surveyed July 23, 1970, by L. E. Gould