

T. 35 S. R. 1 W. W. M.

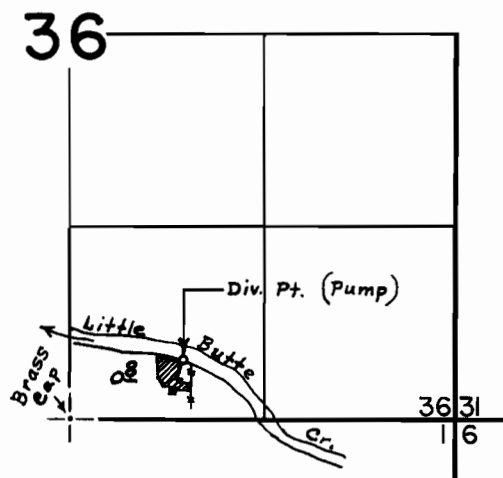

Div. pt. is located 400' N. & 775' E. from
S 1/4 Cor. Sec. 36.

FINAL PROOF SURVEY UNDER

Transfer No. W-148

Application No. _____ Permit No. _____

IN NAME OF

J. W. & Yvonne L. White

Surveyed Jan. 15, 1970, by D. C. Hendrix