

RECEIVED

APR 8 1955

STATE ENGINEER
SALEM, OREGON

N E. Corner of
N.W. 1/4, Section
21, T 2 N R 32 E W.M.

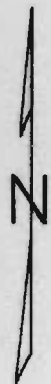
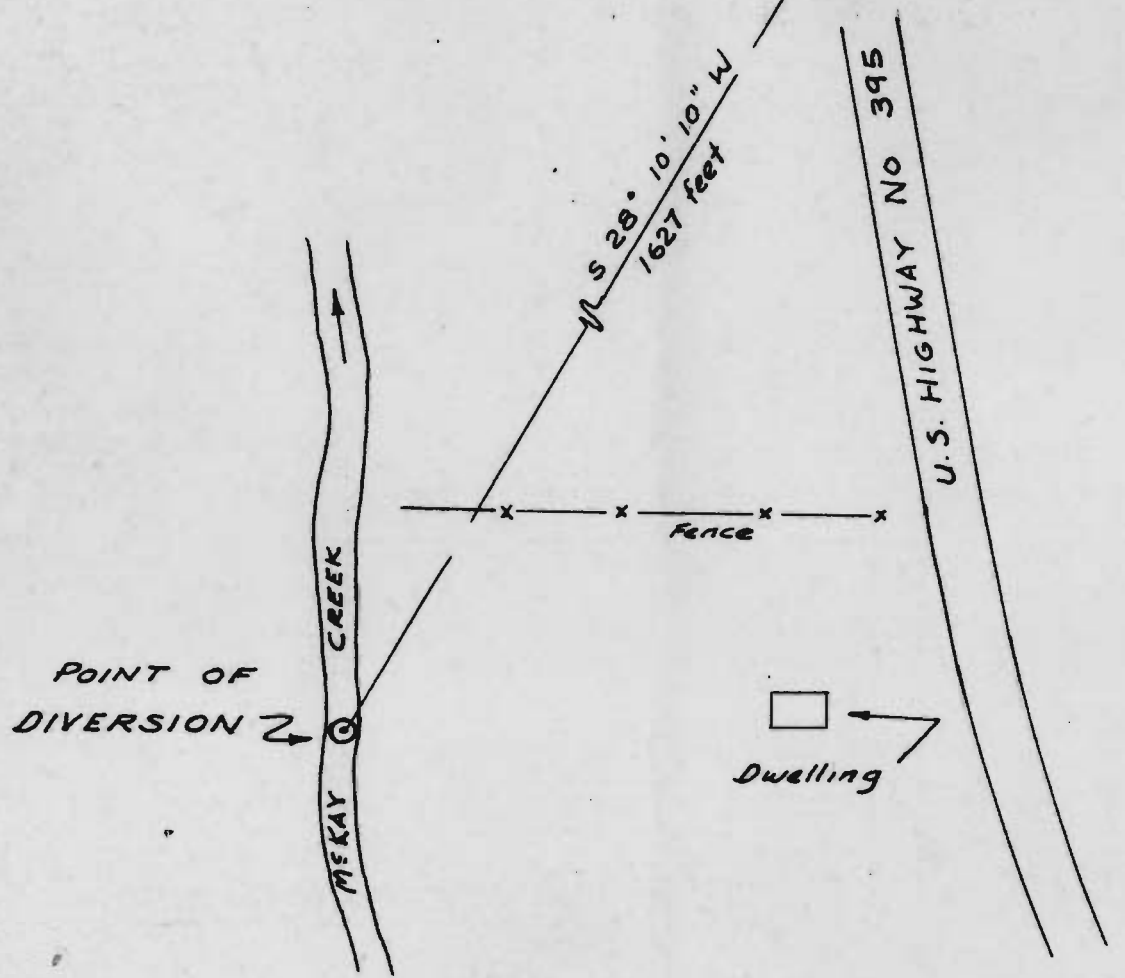

Archie French

Map showing DIVERSION
POINT ON MCKAY CREEK
in NW 1/4 of Section
21, T 2 N R 32 E W.M.
Drawn by Archie French
Scale 1" = 200' Date 4-4-55