

FINAL PROOF SURVEY MAP IN THE NAME OF RONNY O. HAGA

APPLICATION R-70196
S-70197

PERMIT R-11808
52296

SECTIONS 4 AND 9, TOWNSHIP 29 SOUTH, RANGE 14 WEST, W.M.

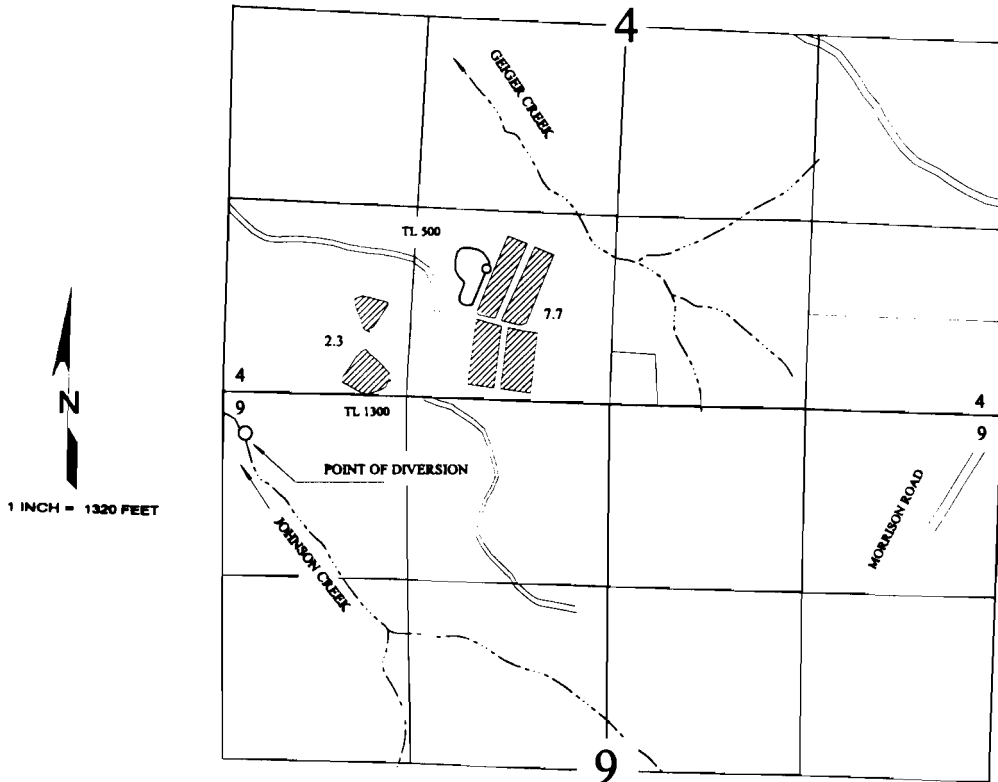

THE JOHNSON CREEK POINT OF DIVERSION IS LOCATED 300 FEET SOUTH AND 150 FEET EAST FROM THE NORTHWEST CORNER OF SECTION 9, BEING WITHIN THE NW $\frac{1}{4}$ NW $\frac{1}{4}$ OF SECTION 9; AND THE RESERVOIR IS LOCATED 840 FEET NORTH AND 1800 FEET EAST FROM THE NORTHWEST CORNER OF SECTION 9, BEING WITHIN THE SE $\frac{1}{4}$ SW $\frac{1}{4}$ OF SECTION 4; BOTH IN TOWNSHIP 29 SOUTH, RANGE 14 WEST, W.M.; COOS COUNTY.

RECEIVED

SEP 21 2000

WATER DIVISION OF THE
STATE OF OREGON

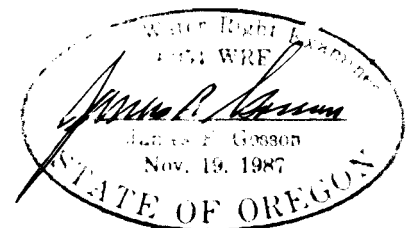

THE PURPOSE OF THIS MAP IS TO IDENTIFY THE LOCATION OF THE WATER RIGHT. IT IS NOT INTENDED TO PROVIDE INFORMATION RELATIVE TO THE LOCATION OF PROPERTY OWNERSHIP BOUNDARY LINES.