



Oregon
Kate Brown, Governor

Water Resources Department
725 Summer St NE, Suite A
Salem, OR 97301
(503) 986-0900
Fax (503) 986-0904

10/24/2022

Hamilton Farms LLC
ATTN: Matt Hamilton
14190 Airlie Rd.
Monmouth, OR 97361

Dear Applicant,

On 10-17-2022, the Water Resources Department received the Claim of Beneficial Use (COBU) for the following files:

Application T-12149

The COBU included a report and map. In the future the Department will review your submittal. At that time we will review these items and provide a final certificate, proposed certificate, or a request for additional information.

If you are interested in having your COBU reviewed sooner, you may pay to have your file processed immediately, using the Reimbursement Authority program, which is described at: <https://www.oregon.gov/owrd/programs/waterrights/ra/pages/default.aspx>.

Customer Service phone: (503) 986-0900

Enclosed is your receipt for the \$230.00 COBU recording fee.

If you sell the property, please contact the Department, or have the new owners contact the Department about the need to file an assignment.

Sincerely,
Dante Luongo

Cc: file

Checklist for Claims of Beneficial Use Received at CSG Counter

Application #:	WRD Reviewer: Dante Luongo
Transfer #: T-12149	
Date Received: 10-21-2022	
CWRE Name: Robyn Cook	
Priority Date (s): 3-31-1970 and 1-1-1993	

Fees Required:

- YES NO A fee of \$230 must accompany this form for permits with priority dates of July 9, 1987, or later.
- YES NO A fee of \$230 must accompany this form for any transfers including a water right with a priority date of July 9, 1987, or later.
 Example – A transfer involves 5 rights and one of the rights has a priority date of July 9, 1987, or later, the fee is required.

Fill in App or Transfer Number

Map Review:

- Map on polyester film (OAR 690-014-0170(1) & 310-0050(1)(b))
- Application & permit #; or transfer # (OAR 690-014-0100(1))
- Disclaimer (OAR 690-014-0170(5))
- North arrow (OAR 690-310-0050(2)(c))
- CWRE stamp and signature (OAR 690-014 & 310-0050)
- Appropriate scale (1" = 1320', 1" = 400', or the original full-size scale of the county assessor map) (014 & 310)
- Township, range, section, and tax lot numbers (OAR 690-310-0050(4))

MONEY SLIP

DATE: _____ RECEIPT #: _____

RECEIVED FROM: _____ APPLICATION: _____
 PERMIT: _____
 TRANSFER: _____

CASH CHECK # _____ OTHER (IDENTIFY) _____ TOTAL RECEIVED: \$ _____

6407 COME'S OTHER (IDENTIFY) _____

6242 MISC. LABOR _____ 6244 Misc. Power Right Perm _____ 6243 Cont. Work _____

6243 TREASURY _____ 6276 MISC. OPERATING ACCT. _____

MISCELLANEOUS COPY & TAPE FEES 4611 _____

6410 RESEARCH FEES _____

6485 MISC. REVENUE (IDENTIFY) _____

TC183 DEPOSIT LIAB. (IDENTIFY) _____

6240 EXTENSION OF TERM _____

WATER RIGHTS _____

6201 SURFACE WATER _____ 6202 _____

6203 GROUND WATER _____ 6204 _____

6205 TRANSFER _____

WELL CONSTRUCTION _____

6218 WELL DRILL CONSTRUCTION _____ 6219 _____

LANDOWNER'S PERMIT _____ 6220 _____

6200 OTHER (IDENTIFY) COBU _____

6207 TREASURY _____ 6207 HYDROELECTRIC _____

6213 POWER LICENSE FEE (FORMER) _____

6214 HYDRO LICENSE FEE (FORMER) _____

HYDRO APPLICATION _____

SPECIAL INSTRUCTIONS:

Report Review:

- On form provided by the Department (OAR 690-014-0100(1))
- Application & permit #; or transfer # (OAR 690-014)
- Ownership information (OAR 690-014)
- Date of survey (OAR 690-014)
- Person interviewed (OAR 690-014)
- County (OAR 690-014)
- CWRE stamp and signature (OAR 690-014-0100)
- Signature(s) of all permittee of transfer holder (OAR 690-014-0100)

RETURN TO APPLICANT - LETTER ATTACHED

Groundwater File Review:

- Pump Test not required (Priority Date prior to December 20, 1988) *If no, include pump test flyer w/acknowledgment letter
- Pump Test required (Priority Date on or after December 20, 1988)
- Pump Test submitted
- Pump Test not submitted

MONEY SLIP

DATE: <u>10-11-2022</u>	RECEIPT #: <u>139327</u>
-------------------------	--------------------------

RECEIVED FROM: <u>Little Prince of Oregon Nursery Inc</u>	APPLICATION
	PERMIT
	TRANSFER <u>T-14107</u>

CASH <input type="checkbox"/>	CHECK # <u>28392</u> <input checked="" type="checkbox"/>	OTHER (IDENTIFY) <input type="checkbox"/>
		TOTAL REC'D \$ <u>2,660.00</u>

1083 TREASURY	4170 MISC CASH ACCT.	
---------------	----------------------	--

0407 COPIES		\$
_____ OTHER: (IDENTIFY) _____		\$

0243 Instream Lease _____ 0244 Muni-Water Mgmt. Plan _____ 0245 Cons. Water _____

1083 TREASURY	4270 WRD OPERATING ACCT.	
---------------	--------------------------	--

MISCELLANEOUS		
0407 COPY & TAPE FEES		\$
0410 RESEARCH FEES		\$
0408 MISC REVENUE (IDENTIFY) _____		\$
TC162 DEPOSIT LIAB. (IDENTIFY) _____		\$
0240 EXTENSION OF TIME _____		\$

46110

WATER RIGHTS		
0201 SURFACE WATER	EXAM FEE	
0203 GROUND WATER	\$	0202 RECORD FEE
0205 TRANSFER	\$ <u>2,160.00</u>	0204 RECORD FEE

WELL CONSTRUCTION		
0218 WELL DRILL CONSTRUCTOR	EXAM FEE	
_____ LANDOWNER'S PERMIT	\$	0219 RECORD FEE
_____ OTHER (IDENTIFY) _____		0220 RECORD FEE

0607 TREASURY	0467 HYDROELECTRIC	
---------------	--------------------	--

0233 POWER LICENSE FEE (FW/WRD)	LIC NUMBER	
0231 HYDRO LICENSE FEE (FW/WRD)	\$	\$
_____ HYDRO APPLICATION		\$

SPECIAL INSTRUCTIONS:

RETURN TO APPLICANT -- LETTER ATTACHED

MONEY SLIP

DATE: 10-21-2022 RECEIPT #: 139389

RECEIVED FROM: Hamilton Farms, LLC

APPLICATION	T-12149
PERMIT	
TRANSFER	

CASH CHECK # 2112 OTHER (IDENTIFY)

TOTAL REC'D \$ 230.00

1083 TREASURY 4170 MISC CASH ACCT.

0407 COPIES \$
OTHER: (IDENTIFY) \$

0243 Instream Lease _____ 0244 Muni Water Mgmt. Plan _____ 0245 Cons. Water _____

1083 TREASURY 4270 WRD OPERATING ACCT.

MISCELLANEOUS

0407 COPY & TAPE FEES \$
0410 RESEARCH FEES \$
0408 MISC REVENUE (IDENTIFY) \$
TC162 DEPOSIT LIAB. (IDENTIFY) \$
0240 EXTENSION OF TIME \$

46111

WATER RIGHTS

	EXAM FEE		RECORD FEE
0201 SURFACE WATER	\$	0202	\$
0203 GROUND WATER	\$	0204	\$
0205 TRANSFER	\$		

WELL CONSTRUCTION

	EXAM FEE		RECORD FEE
0218 WELL DRILL CONSTRUCTOR	\$	0219	\$
LANDOWNER'S PERMIT		0220	\$
OTHER (IDENTIFY)			\$ 230.00

COBU

0607 TREASURY 0467 HYDROELECTRIC

	LIC NUMBER	
0233 POWER LICENSE FEE (FW/WRD)		\$
0231 HYDRO LICENSE FEE (FW/WRD)		\$
HYDRO APPLICATION		\$

SPECIAL INSTRUCTIONS:

RETURN TO APPLICANT-- LETTER ATTACHED

RECEIVED

RECEIVED

OCT 21 2022

OCT 21 2022

OWRD

OWRD



Google earth

feet 1000
 meters 500

Date of Photograph: 7-14-2014

T 12149

RECEIVED

AUG 31 2015

WATER RESOURCES DEPT
SALEM, OREGON

T9S & T10S, R5W, WM

POLK COUNTY

RECEIVED

RECEIVED

OCT 21 2022

OWRD

Please see
Waiver approval
for existing
RECEIVED
Survey map.
OCT 21 2022
OWRD

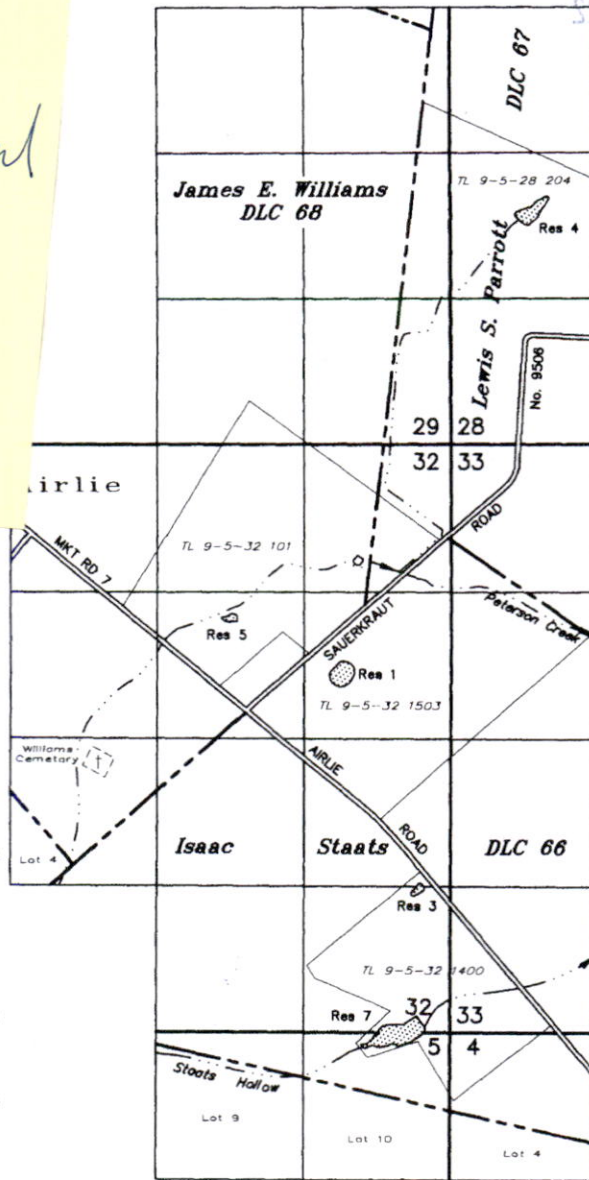

POD's

- RES 1:
1145' S & 855' W
N'y COR STAATS DLC 66
- RES 3:
1320' N & 240' W
SE COR SEC 32
- RES 4:
2860' N & 660' E
N'y COR STAATS DLC 66
- RES 5:
735' S & 1880' W
N'y COR STAATS DLC 66
- RES 7:
90' N & 255' W
SE COR SEC 32

CERTIFICATES DO NOT
LIST POD'S, ONLY
RESERVOIR LOCATIONS

APPLICATION TO TRANSFER WATER RIGHT
CHARACTER OF USE

IN THE NAME OF

RECEIVED Hamilton Farms, LLC

AUG 31 2015

WATER RESOURCES DEPT
SALEM, OREGON

Certificate No. 41746
41747
81452 Transfer No. T-

August 8, 2015

SCALE: 1" = 1320'

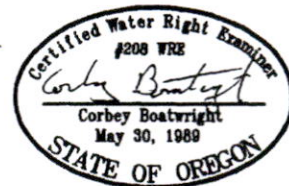

NOTE: This map is not intended to
provide legal dimensions or locations
of property ownership lines.

1 12149

EXPIRES 12-31-15