

**T28S R13E &  
T29S R13E WM,  
LAKE COUNTY, OR**

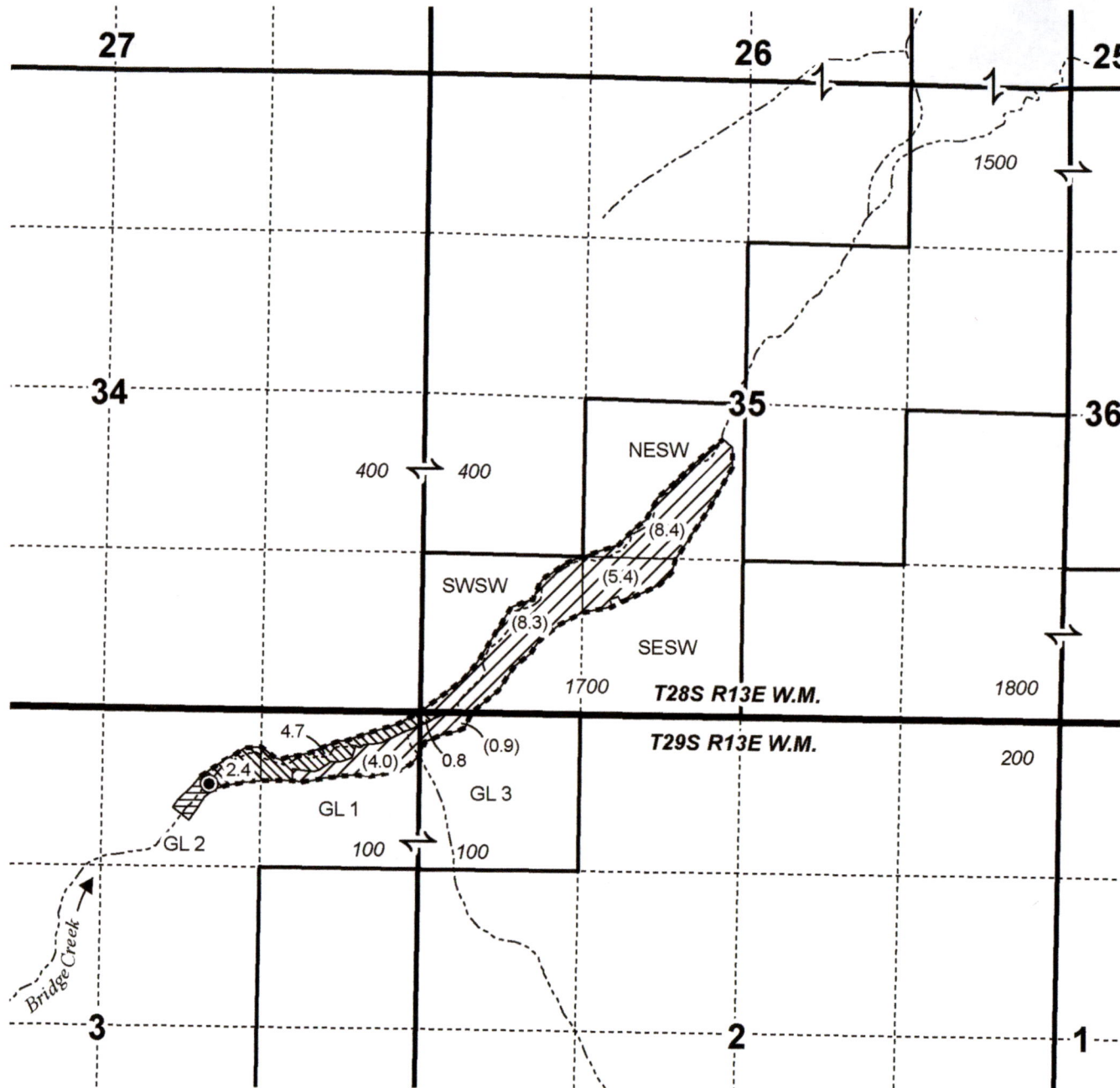
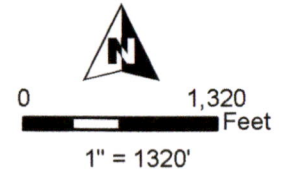

- POD
- - - - - Creek
- · · · · Ditch
- Reservoir (C-91939 Stored Water)
- POU IR
- POU (IS)
- Township
- Section
- - - - - Quarter Quarter
- Tax Lot

**RECEIVED**

**OCT 21 2022**

**OWRD**

POD Location:

680' S, 1900' W of NE Cor Sec 3



**SURFACE WATER APPLICATION  
BELL "A" LAND AND CATTLE COMPANY**

Date: 7/29/2022

This map is not intended  
to provide legal dimensions  
or locations of property  
ownership lines.

**WATER RIGHT SERVICES, LLC**

PO BOX 1830, BEND, OR 97709

**WWW.OREGONWATER.US 541-389-2837**

johnshort@usa.com

CCB # 197121