

RECEIVED

NOV 21 2022

OWRD

T8S R46E WM

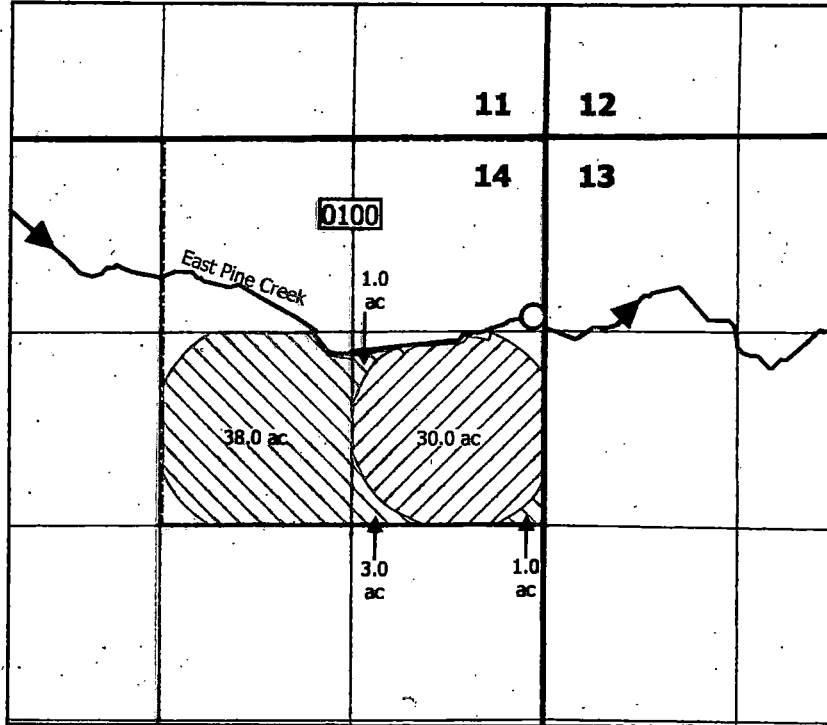

LEGEND

- Additional Point of Diversion (Armocost Pump POD)
- ▨ Place of Use (priority date 12/31/1877)
- ▧ (Place of Use priority date 12/31/1879)
- Baker County Taxlot Boundary 0100

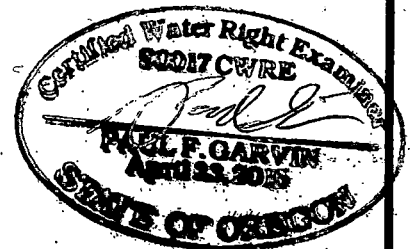

Claim of Beneficial Use Map
Additional POD
Transfer T-12861
Baker County, OR

Prepared on behalf of Armocost Investments LLP

1 inch = 1,320 feet



Date: 10/25/22
Drawn by: Paul F. Garvin

Note:

This map is not intended to provide legal dimensions or locations of property ownership lines.

Armocost Pump POD: 1,240 ft S and 94 ft W from the NE corner of Section 14

Approved fish screening is located at the Armocost Pump POD

Flow measurement device is located within a 20 ft radius of the Armocost Pump POD

