

RECEIVED

DEC 15 2022

OWRD

Rhurr Investments, LLC
Application for Supplemental
Water Right from
Lost Creek Reservoir

T 36 S, R 6 W
Sec 15, SWSW

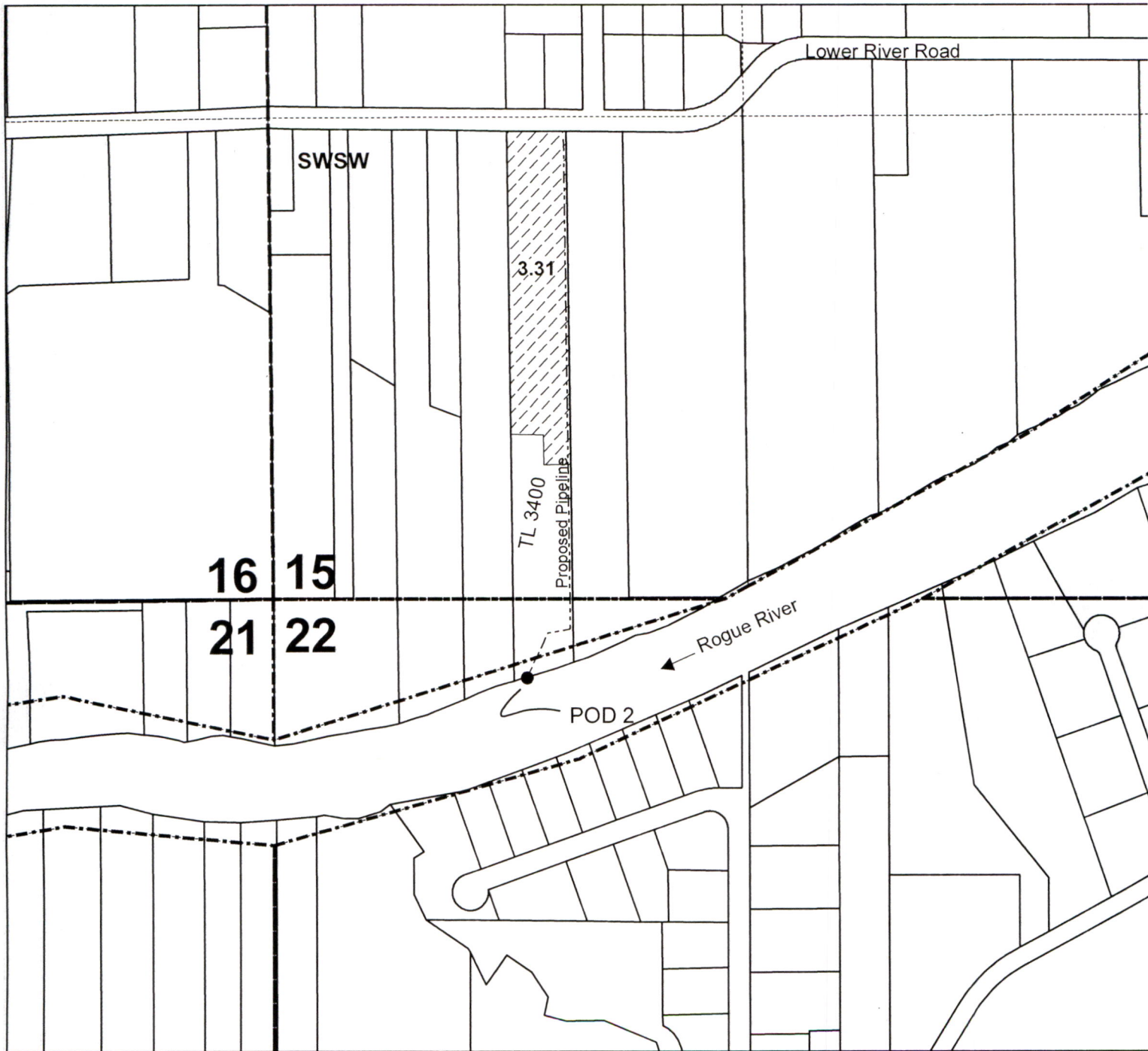

Page 2 of 2



1 inch = 400 feet

POD #2 is the location where
water released from Lost Creek
Reservoir is re-diverted for
supplemental irrigation
Located in the NW NW of Sec 22
244.2 ft South and 694.5 ft East
From the NW Cor. Sec 22
T 36 S, R 6 W, WM

Legend

-  Supplemental Irrigation 3.31 ac
-  POD 2 re-diversion
-  Proposed Pipeline