

T9S R5W, WM
T9S R6W, WM
POLK COUNTY

REC 15 2022

(11)

TAX LOT:
9.5.18 202

- DIV PT
- HOME & FARM BLDGS
- TAX LOT LINE

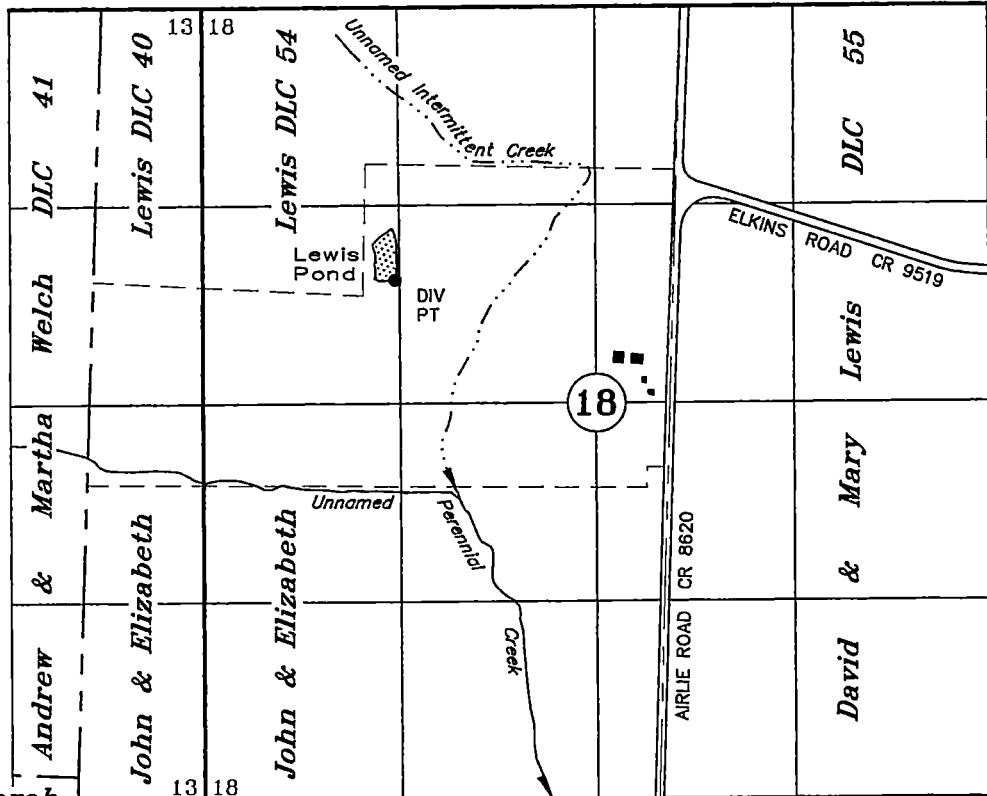

Ira & Sarah
Hooker DLC 48

POD - 1935' SOUTH & 1350' EAST OF NW COR SEC 18
(per record documents)

Claim of Beneficial Use
(Change of Character of Use)

Permit No. R-1515 Transfer No. T-12531

Lewis DLC Farm, LLC

December 1, 2022
SCALE: 1" = 1320'

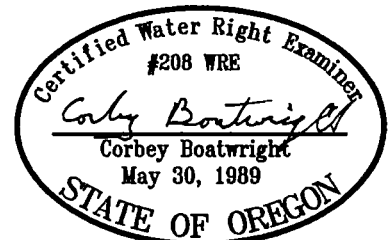

NOTE: This map is for the purpose of identifying the location of water rights and has no intent to dimension or locate property ownership lines.

Renews: December 31, 2023