

Application for a Permit to Use
Groundwater

RECEIVED
DEC 19 2022
OWRD
SALEM, OREGON



Oregon Water Resources Department
 725 Summer Street NE, Suite A
 Salem, Oregon 97301-1266
 503-986-0900
 www.oregon.gov/OWRD

SECTION 1: APPLICANT INFORMATION AND SIGNATURE

Applicant

NAME		PHONE (HM)	
PHONE (WK)	CELL		FAX
ADDRESS			
CITY	STATE	ZIP	E-MAIL*

Organization

NAME AVION WATER COMPANY, INC., ATTN: ADAM JACKSON		PHONE (541) 382-5342	FAX
ADDRESS 60813 PARRELL RD.			CELL
CITY BEND	STATE OR	ZIP 97702	E-MAIL* ADAM@AVIONWATER.COM

Agent – The agent is authorized to represent the applicant in all matters relating to this application.

AGENT / BUSINESS NAME GSI WATER SOLUTIONS, ATTN: TREVOR GRANDY		PHONE (971) 200-8545	FAX
ADDRESS 147 SW SHEVLIN HIXON DR. SUITE 201			CELL
CITY BEND	STATE OR	ZIP 97702	E-MAIL* TGRANDY@GSIWS.COM

Note: Attach multiple copies as needed

* By providing an e-mail address, consent is given to receive all correspondence from the Department electronically. (Paper copies of the proposed and final order documents will also be mailed.)

By my signature below I confirm that I understand:

- I am asking to use water specifically as described in this application.
- Evaluation of this application will be based on information provided in the application.
- I cannot use water legally until the Water Resources Department issues a permit.
- Oregon law requires that a permit be issued before beginning construction of any proposed well, unless the use is exempt. Acceptance of this application does not guarantee a permit will be issued.
- If I get a permit, I must not waste water.
- If development of the water use is not according to the terms of the permit, the permit can be cancelled.
- The water use must be compatible with local comprehensive land-use plans.
- Even if the Department issues a permit, I may have to stop using water to allow senior water-right holders to get water to which they are entitled.

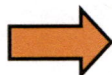

I (we) affirm that the information contained in this application is true and accurate.

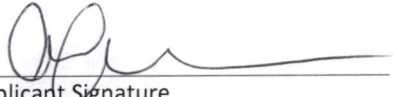
 Applicant Signature	Adam Jackson, Engineer Print Name and Title if applicable	12/5/22 Date
------------------------------------------------------------------------------------------------------------	---------------------------------------------------------------------	------------------------

SECTION 2: PROPERTY OWNERSHIP

Please indicate if you own all the lands associated with the project from which the water is to be diverted, conveyed, and used.

- YES, there are no encumbrances.
- YES, the land is encumbered by easements, rights of way, roads or other encumbrances.
- NO, the Applicant meets the definition of a municipality as described in ORS 540.510(3)(b).**
- NO, I have a recorded easement or written authorization permitting access.
- NO, I do not currently have written authorization or easement permitting access.
- NO, written authorization or an easement is not necessary, because the only affected lands I do not own are state-owned submersible lands, and this application is for irrigation and/or domestic use only (ORS 274.040).
- NO, because water is to be diverted, conveyed, and/or used only on federal lands.

Affected Landowners: List the names and mailing addresses of all owners of any lands that are not owned by the applicant and that are crossed by the proposed ditch, canal or other work, even if the applicant has obtained written authorization or an easement from the owner. *(Attach additional sheets if necessary).*

N/A – The Applicant meets the definition of a municipality as described in ORS 540.510(3)(b).

Legal Description: You must provide the legal description of: 1. The property from which the water is to be diverted, 2. Any property crossed by the proposed ditch, canal or other work, and 3. Any property on which the water is to be used as depicted on the map.

See [Attachment C](#) for a legal description of the property where the proposed point of appropriation is located.

SECTION 3: WELL DEVELOPMENT

WELL NO.	NAME OF NEAREST SURFACE WATER	IF LESS THAN 1 MILE:	
		DISTANCE TO NEAREST SURFACE WATER	ELEVATION CHANGE BETWEEN NEAREST SURFACE WATER AND WELL HEAD
TURNER WELL 1	UNNAMED EPHEMERAL STREAM	2,350 FEET	-50 FEET

Please provide any information for your existing or proposed well(s) that you believe may be helpful in evaluating your application. For existing wells, describe any previous alteration(s) or repair(s) not documented in the attached well log or other materials *(attach additional sheets if necessary).*

See [Attachment D – Turner Well 1 Log](#)

RECEIVED
DEC 19 2022
OWRD
SALEM, OREGON

SECTION 3: WELL DEVELOPMENT, continued

Total maximum rate requested: **50 GPM** (each well will be evaluated at the maximum rate unless you indicate well-specific rates and annual volumes in the table below).

The table below must be completed for each source to be evaluated or the application will be returned. If this is an existing well, the information may be found on the applicable well log. *(If a well log is available, please submit it in addition to completing the table.)* If this is a proposed well, or well-modification, consider consulting with a licensed well driller, geologist, or certified water right examiner to obtain the necessary information.

OWNER'S WELL NAME OR NO.	PROPOSED	EXISTING	WELL ID (WELL TAG) NO.* OR WELL LOG ID**	FLOWING ARTESIAN	CASING DIAMETER	CASING INTERVALS (IN FEET)	PERFORATED OR SCREENED INTERVALS (IN FEET)	SEAL INTERVALS (IN FEET)	MOST RECENT STATIC WATER LEVEL & DATE (IN FEET)	PROPOSED USE			
										SOURCE AQUIFER***	TOTAL WELL DEPTH	WELL-SPECIFIC RATE (GPM)	ANNUAL VOLUME (ACRE-FEET)
TURNER WELL 1	<input type="checkbox"/>	<input checked="" type="checkbox"/>	DESC 5603	<input type="checkbox"/>	8-INCH	+2'-25'	N/A	0-25'	716' (11/1980)	BASALT	785'	50	
	<input type="checkbox"/>	<input type="checkbox"/>		<input type="checkbox"/>									

* Licensed drillers are required to attach a Department-supplied Well Tag, with a unique Well ID or Well Tag Number to all new or newly altered wells. Landowners can request a Well ID for existing wells that do not have one. The Well ID is intended to serve as a unique identification number for each well.
 ** A well log ID (e.g. MARI 1234) is assigned by the Department to each log in the agency's well log database. A separate well log is required for each subsequent alteration of the well.
 *** Source aquifer examples: Troutdale Formation, gravel and sand, alluvium, basalt, bedrock, etc.

RECEIVED
DEC 19 2022
 OWRD
 SALEM, OREGON

SECTION 4: SENSITIVE, THREATENED OR ENDANGERED FISH SPECIES PUBLIC INTEREST INFORMATION

This information must be provided for your application to be accepted as complete. The Water Resources Department will determine whether the proposed use will impair or be detrimental to the public interest with regard to sensitive, threatened or endangered fish species if your proposed groundwater use is determined to have the potential for substantial interference with nearby surface waters.

To answer the following questions, use the map provided in [Attachment 3](#) or the link below to determine whether the proposed point of appropriation (POA) is located in an area where the Upper Columbia, the Lower Columbia, and/or the Statewide public interest rules apply.

For more detailed information, click on the following link and enter the TRSQQ or the Lat/Long of a POA and click on "Submit" to retrieve a report that will show which section, if any, of the rules apply:

https://apps.wrd.state.or.us/apps/misc/lkp_trsqq_features/

If you need help to determine in which area the proposed POA is located, please call the customer service desk at (503) 986-0801.

Upper Columbia - OAR 690-033-0115 thru -0130

Is the well or proposed well located in an area where the Upper Columbia Rules apply?

Yes No

If yes, you are notified that the Water Resources Department will consult with numerous federal, state, local and tribal governmental entities so it may determine whether the proposed use is consistent with the "Columbia River Basin Fish and Wildlife Program" adopted by the Northwest Power Planning Council in 1994 for the protection and recovery of listed fish species. The application may be denied, heavily conditioned, or if appropriate, mitigation for impacts may be needed to obtain approval for the proposed use.

If yes, and if the Department determines that proposed groundwater use has the potential for substantial interference with nearby surface waters:

- I understand that the permit, if issued, will not allow use during the time period April 15 to September 30, except as provided in OAR 690-033-0140.
- I understand that the Department of Environmental Quality will review my application to determine if the proposed use complies with existing state and federal water quality standards.
- I understand that I will install and maintain water use measurement and recording devices as required by the Water Resources Department, and comply with recording and reporting permit condition requirements.

Lower Columbia - OAR 690-033-0220 thru -0230

Is the well or proposed well located in an area where the Lower Columbia rules apply?

Yes No

If yes, and the proposed groundwater use is determined to have the potential for substantial interference with nearby surface waters you are notified that the Water Resources Department will determine, by reviewing

RECEIVED

DEC 19 2022

OWRD
SALEM, OREGON

recovery plans, the Columbia River Basin Fish and Wildlife Program, and regional restoration programs applicable to threatened or endangered fish species, in coordination with state and federal agencies, as appropriate, whether the proposed use is detrimental to the protection or recovery of a threatened or endangered fish species and whether the use can be conditioned or mitigated to avoid the detriment.

If a permit is issued, it will likely contain conditions to ensure the water use complies with existing state and federal water quality standards; and water use measurement, recording and reporting required by the Water Resources Department. The application may be denied, or if appropriate, mitigation for impacts may be needed to obtain approval of the proposed use.

If yes, you will be required to provide the following information, if applicable. N/A

Yes No The proposed use is for more than one cubic foot per second (448.8 gpm) and is not subject to the requirements of OAR 690, Division 86 (Water Management and Conservation Plans).

If yes, provide a description of the measures to be taken to assure reasonably efficient water use:

Statewide - OAR 690-033-0330 thru -0340

Is the well or proposed well located in an area where the Statewide rules apply?

Yes No

RECEIVED
DEC 19 2022
OWRD
SALEM, OREGON

If yes, and the proposed groundwater use is determined to have the potential for substantial interference with nearby surface waters you are notified that the Water Resources Department will determine whether the proposed use will occur in an area where endangered, threatened or sensitive fish species are located. If so, the Water Resources Department, Department of Fish and Wildlife, Department of Environmental Quality, and the Department of Agriculture will recommend conditions required to achieve "no loss of essential habitat of threatened and endangered (T&E) fish species," or "no net loss of essential habitat of sensitive (S) fish species." If conditions cannot be identified that meet the standards of no loss of essential T E fish habitat or no net loss of essential S fish habitat, the agencies will recommend denial of the application unless they conclude that the proposed use would not harm the species.

SECTION 5: WATER USE

USE	PERIOD OF USE	ANNUAL VOLUME (ACRE-FEET)
Quasi-municipal	Year-round	40

For irrigation use only: N/A

Please indicate the number of primary, supplemental and/or nursery acres to be irrigated (must match map).

Primary: Acres Supplemental: Acres Nursery Use: Acres

If you listed supplemental acres, list the Permit or Certificate number of the underlying primary water right(s):

Indicate the maximum total number of acre-feet you expect to use in an irrigation season:

- If the use is **municipal or quasi-municipal**, attach **Form M** [See Attachment E](#)
- If the use is **domestic**, indicate the number of households: **N/A** (**Exempt Uses:** Please note that 15,000 gallons per day for single or group **domestic** purposes and 5,000 gallons per day for a single **industrial or commercial** purpose are exempt from permitting requirements.)
- If the use is **mining**, describe what is being mined and the method(s) of extraction (*attach additional sheets if necessary*): **N/A**

SECTION 6: WATER MANAGEMENT

A. Diversion and Conveyance

What equipment will you use to pump water from your well(s)?

- Pump (give horsepower and type): **15 HP Gould Submersible Pump**
- Other means (describe):

Provide a description of the proposed means of diversion, construction, and operation of the diversion works and conveyance of water. **Water flows from the well into a concrete reservoir, and is then sent out to the customers. It is not treated. It is transported through a PVC pipe network.**

B. Application Method

What equipment and method of application will be used? (e.g., drip, wheel line, high-pressure sprinkler) (*attach additional sheets if necessary*) **N/A**

C. Conservation

Please describe why the amount of water requested is needed and measures you propose to: prevent waste; measure the amount of water diverted; prevent damage to aquatic life and riparian habitat; prevent the discharge of contaminated water to a surface stream; prevent adverse impact to public uses of affected surface waters (*attach additional sheets if necessary*).

Water use will be quasi-municipal under this permit. Customers are charged according to their water usage, which is a known deterrent of water waste.

SECTION 7: PROJECT SCHEDULE

- a) Date construction will begin: **Within 5 years of permit issuance.**
- b) Date construction will be completed: **Within 5 years of permit issuance.**
- c) Date beneficial water use will begin: **Within 5 years of permit issuance.**

RECEIVED

DEC 19 2022

OWRD
SALEM, OREGON

SECTION 8: RESOURCE PROTECTION

In granting permission to use water the state encourages, and in some instances requires, careful control of activities that may affect adjacent waterway or streamside area. See instruction guide for a list of possible permit requirements from other agencies. Please indicate any of the practices you plan to undertake to protect water resources.

- Water quality will be protected by preventing erosion and run-off of waste or chemical products. Describe: **Water appropriated under this permit will be for quasi-municipal use. Following municipal use, water is treated via domestic septic systems throughout POU. Water use will not result in erosion or run-off.**
- Excavation or clearing of banks will be kept to a minimum to protect riparian or streamside areas.

Note: If disturbed area is greater than one acre, applicant should contact the Oregon Department of Environmental Quality to determine if a 1200C permit is required.

Describe planned actions and additional permits required for project implementation: **N/A – No excavation or clearing of banks is necessary for this project.**

- Other state and federal permits or contracts required and to be obtained, if a water right permit is granted:
List: **N/A**

SECTION 9: WITHIN A DISTRICT

- Check here if the point of appropriation (POA) or place of use (POU) are located within or served by an irrigation or other water district.

Irrigation District Name Arnold Irrigation District	Address 19604 Buck Canyon Rd	
City Bend	State OR	Zip 97702

SECTION 10: REMARKS

Use this space to clarify any information you have provided in the application (*attach additional sheets if necessary*).

The applicant understands that mitigation is required for new groundwater permits within the Deschutes Basin Study Area. Consistent with OAR 690-505-0625, the applicant intends to submit an incremental development plan to the Department as part of the response to a notice of mitigation obligation. The applicant holds sufficient mitigation credits to provide for current and anticipated mitigation needs under this permit.

RECEIVED
DEC 19 2022
OWRD
SALEM, OREGON

RECEIVED

DEC 19 2022

OWRD
SALEM, OREGON

Attachment A

Permit Application Map

Application for Groundwater Permit – Avion Water Company

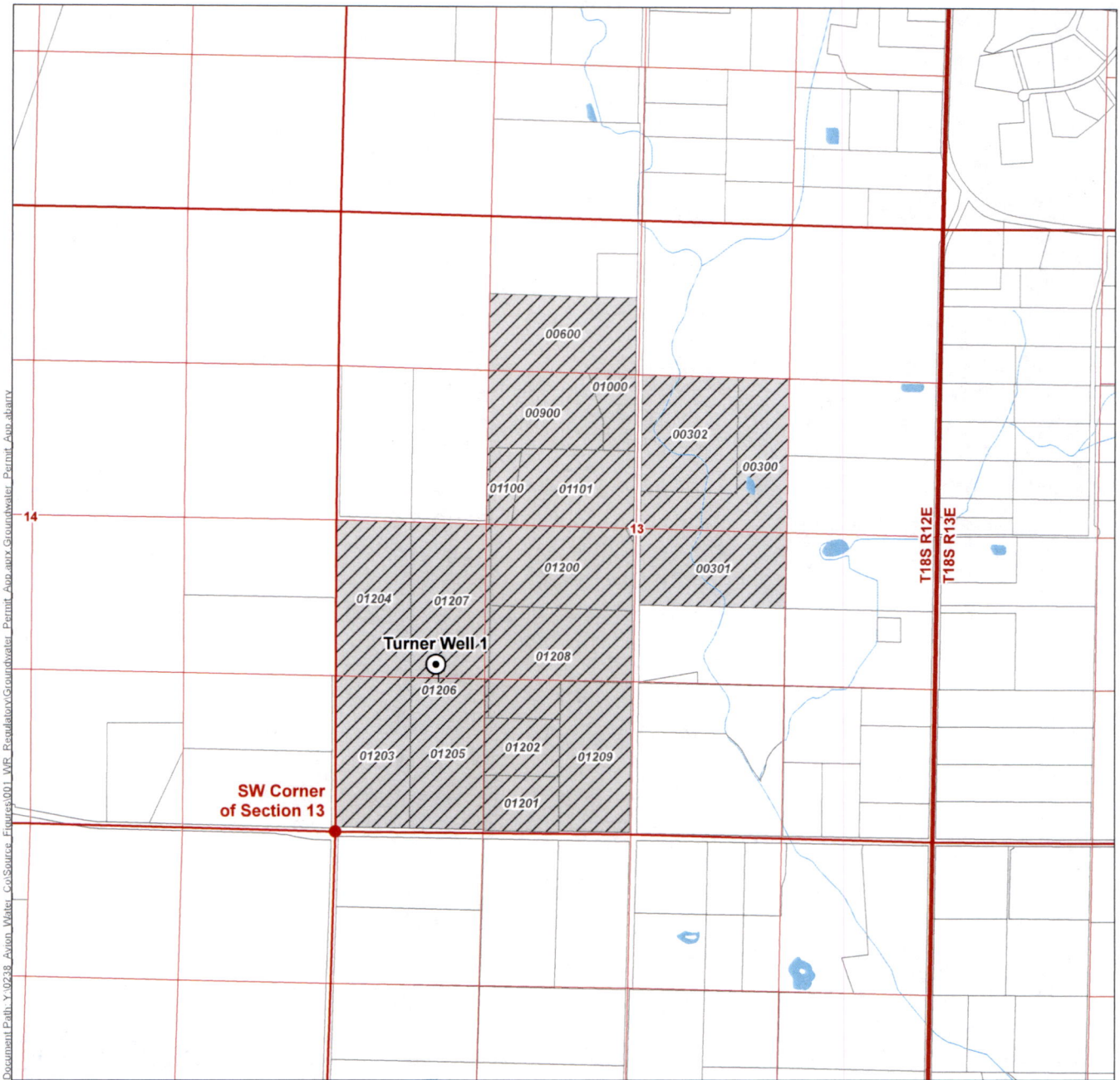

LEGEND

- Proposed Point of Appropriation (POA)
- Tax Lot
- Proposed Place of Use (POU)
- Watercourse
- Waterbody

**Application for a Groundwater Permit
in the Name of Avion Water Co., Inc**

**Proposed Place of Use and
Point of Appropriation Map**

Deschutes County
Township 18 South, Range 12 East (W.M.)

RECEIVED
DEC 19 2022
OWRD
SALEM, OREGON

DISCLAIMER

This map was prepared for the purpose of identifying the location of a water right only and it is not intended to provide legal dimensions or location of property ownership lines.

Date: August 29, 2022

Data Sources: BLM, ESRI, OWRD, USGS, Deschutes Co.

LOCATION DESCRIPTION

Turner Well 1

Located 1465 feet North and 879 feet East from the SW corner of Section 13, Township 18 South, Range 12 East (W.M.)

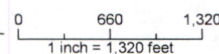

RECEIVED

DEC 19 2022

OWRD
SALEM, OREGON

Attachment B

Land Use Information Form

Application for Groundwater Permit – Avion Water Company

Land Use Information Form



Oregon Water Resources Department
725 Summer Street NE, Suite A
Salem, Oregon 97301-1266
(503) 986-0900
www.oregon.gov/OWRD

NOTE TO APPLICANTS

In order for your application to be processed by the Water Resources Department (WRD), this Land Use Information Form must be completed by a local government planning official in the jurisdiction(s) where your water right will be used and developed. The planning official may choose to complete the form while you wait, or return the receipt stub to you. Applications received by WRD without the Land Use Form or the receipt stub will be returned to you. Please be aware that your application will not be approved without land use approval.

This form is NOT required if:

- 1) Water is to be diverted, conveyed, and/or used only on federal lands; **OR**
- 2) The application is for a water right transfer, allocation of conserved water, exchange, permit amendment, or ground water registration modification, and **all** of the following apply:
 - a) The existing and proposed water use is located entirely within lands zoned for exclusive farm-use or within an irrigation district;
 - b) The application involves a change in place of use only;
 - c) The change does not involve the placement or modification of structures, including but not limited to water diversion, impoundment, distribution facilities, water wells and well houses; and
 - d) The application involves irrigation water uses only.

NOTE TO LOCAL GOVERNMENTS

The person presenting the attached Land Use Information Form is applying for or modifying a water right. The Water Resources Department (WRD) requires its applicants to obtain land-use information to be sure the water rights do not result in land uses that are incompatible with your comprehensive plan. Please complete the form or detach the receipt stub and return it to the applicant for inclusion in their water right application. You will receive notice once the applicant formally submits his or her request to the WRD. The notice will give more information about WRD's water rights process and provide additional comment opportunities. You will have 30 days from the date of the notice to complete the land-use form and return it to the WRD. If no land-use information is received from you within that 30-day period, the WRD may presume the land use associated with the proposed water right is compatible with your comprehensive plan. Your attention to this request for information is greatly appreciated by the Water Resources Department. If you have any questions concerning this form, please contact the WRD's Customer Service Group at 503-986-0801.

RECEIVED

DEC 19 2022

OWRD
SALEM, OREGON

Land Use Information Form

Applicant(s): Avion Water Company, Inc.

Mailing Address: 60813 Parrell Rd.

City: Bend

State: OR

Zip Code: 97702

Daytime Phone: (541) 382-5342

A. Land and Location

Please include the following information for all tax lots where water will be diverted (taken from its source), conveyed (transported), and/or used or developed. Applicants for municipal use, or irrigation uses within irrigation districts may substitute existing and proposed service-area boundaries for the tax-lot information requested below.

Township	Range	Section	¼ ¼	Tax Lot #	Plan Designation (e.g., Rural Residential/RR-5)	Water to be:			Proposed Land Use:
<u>18 S</u>	<u>12 E</u>	<u>13</u>	<u>NW SW</u>	<u>1206</u>	<u>Exclusive Farm Use – Tumalo/Redmond/Bend Subzone (EFUTRB)</u>	<input checked="" type="checkbox"/> Diverted	<input checked="" type="checkbox"/> Conveyed	<input type="checkbox"/> Used	<u>Quasi-Municipal</u>
<u>See map of Turner Service Area</u>						<input checked="" type="checkbox"/> Diverted	<input checked="" type="checkbox"/> Conveyed	<input checked="" type="checkbox"/> Used	

List all counties and cities where water is proposed to be diverted, conveyed, and/or used or developed:

Deschutes County

B. Description of Proposed Use

Type of application to be filed with the Water Resources Department:

- Permit to Use or Store Water
 Water Right Transfer
 Permit Amendment or Ground Water Registration Modification
 Limited Water Use License
 Allocation of Conserved Water
 Exchange of Water

Source of water: Reservoir/Pond Ground Water Surface Water (name) _____

Estimated quantity of water needed: 50 cubic feet per second gallons per minute acre-feet

Intended use of water: Irrigation Commercial Industrial Domestic for _____ household(s)
 Municipal Quasi-Municipal Instream Other _____

Briefly describe:

The applicant currently operates an existing water system for the Turner subdivision diverting less than 15,000 gallons per day (gpd), the State's groundwater exempt allowance for group domestic use. Due to increased demand, the applicant is applying for a groundwater permit to authorize use above 15,000 gpd.

Note to applicant: If the Land Use Information Form cannot be completed while you wait, please have a local government representative sign the receipt at the bottom of the next page and include it with the application filed with the Water Resources Department.

See bottom of Page 3. →

RECEIVED

DEC 19 2022

OWRD
SALEM, OREGON

For Local Government Use Only

The following section must be completed by a planning official from each county and city listed unless the project will be located entirely within the city limits. In that case, only the city planning agency must complete this form. This deals only with the local land-use plan. Do not include approval for activities such as building or grading permits.

Please check the appropriate box below and provide the requested information

Land uses to be served by the proposed water uses (including proposed construction) are allowed outright or are not regulated by your comprehensive plan. Cite applicable ordinance section(s):

Land uses to be served by the proposed water uses (including proposed construction) involve discretionary land-use approvals as listed in the table below. (Please attach documentation of applicable land-use approvals which have already been obtained. Record of Action/land-use decision and accompanying findings are sufficient.) **If approvals have been obtained but all appeal periods have not ended, check "Being pursued."**

Type of Land-Use Approval Needed (e.g., plan amendments, rezones, conditional-use permits, etc.)	Cite Most Significant, Applicable Plan Policies & Ordinance Section References	Land-Use Approval:	
		<input type="checkbox"/> Obtained <input type="checkbox"/> Denied	<input type="checkbox"/> Being Pursued <input type="checkbox"/> Not Being Pursued
		<input type="checkbox"/> Obtained <input type="checkbox"/> Denied	<input type="checkbox"/> Being Pursued <input type="checkbox"/> Not Being Pursued
		<input type="checkbox"/> Obtained <input type="checkbox"/> Denied	<input type="checkbox"/> Being Pursued <input type="checkbox"/> Not Being Pursued
		<input type="checkbox"/> Obtained <input type="checkbox"/> Denied	<input type="checkbox"/> Being Pursued <input type="checkbox"/> Not Being Pursued
		<input type="checkbox"/> Obtained <input type="checkbox"/> Denied	<input type="checkbox"/> Being Pursued <input type="checkbox"/> Not Being Pursued

Local governments are invited to express special land-use concerns or make recommendations to the Water Resources Department regarding this proposed use of water below, or on a separate sheet.

Name: _____ Title: _____

Signature: _____ Phone: _____ Date: _____

Government Entity: _____

Note to local government representative: Please complete this form or sign the receipt below and return it to the applicant. If you sign the receipt, you will have 30 days from the Water Resources Department's notice date to return the completed Land Use Information Form or WRD may presume the land use associated with the proposed use of water is compatible with local comprehensive plans.



Receipt for Request for Land Use Information

Applicant name: _____

City or County: _____ Staff contact: _____

Signature: _____ Phone: _____ Date: _____

For Local Government Use Only

The following section must be completed by a planning official from each county and city listed unless the project will be located entirely within the city limits. In that case, only the city planning agency must complete this form. This deals only with the local land-use plan. Do not include approval for activities such as building or grading permits.

Please check the appropriate box below and provide the requested information

- Land uses to be served by the proposed water uses (including proposed construction) are allowed outright or are not regulated by your comprehensive plan. Cite applicable ordinance section(s):
- Land uses to be served by the proposed water uses (including proposed construction) involve discretionary land-use approvals as listed in the table below. (Please attach documentation of applicable land-use approvals which have already been obtained. Record of Action/land-use decision and accompanying findings are sufficient.) **If approvals have been obtained but all appeal periods have not ended, check "Being pursued."**

Type of Land-Use Approval Needed (e.g., plan amendments, rezones, conditional-use permits, etc.)	Cite Most Significant, Applicable Plan Policies & Ordinance Section References	Land-Use Approval:	
		<input type="checkbox"/> Obtained <input type="checkbox"/> Denied	<input type="checkbox"/> Being Pursued <input type="checkbox"/> Not Being Pursued
		<input type="checkbox"/> Obtained <input type="checkbox"/> Denied	<input type="checkbox"/> Being Pursued <input type="checkbox"/> Not Being Pursued
		<input type="checkbox"/> Obtained <input type="checkbox"/> Denied	<input type="checkbox"/> Being Pursued <input type="checkbox"/> Not Being Pursued
		<input type="checkbox"/> Obtained <input type="checkbox"/> Denied	<input type="checkbox"/> Being Pursued <input type="checkbox"/> Not Being Pursued
		<input type="checkbox"/> Obtained <input type="checkbox"/> Denied	<input type="checkbox"/> Being Pursued <input type="checkbox"/> Not Being Pursued
		<input type="checkbox"/> Obtained <input type="checkbox"/> Denied	<input type="checkbox"/> Being Pursued <input type="checkbox"/> Not Being Pursued

Local governments are invited to express special land-use concerns or make recommendations to the Water Resources Department regarding this proposed use of water below, or on a separate sheet.

Name: _____ Title: _____

Signature: _____ Phone: _____ Date: _____

Government Entity: _____

Note to local government representative: Please complete this form or sign the receipt below and return it to the applicant. If you sign the receipt, you will have 30 days from the Water Resources Department's notice date to return the completed Land Use Information Form or WRD may presume the land use associated with the proposed use of water is compatible with local comprehensive plans.



Receipt for Request for Land Use Information

Applicant name: Avian Water

City or County: Deschutes Staff contact: Ben Wilson

Signature: [Signature] Phone: 541-285-1713 Date: 12/8/22

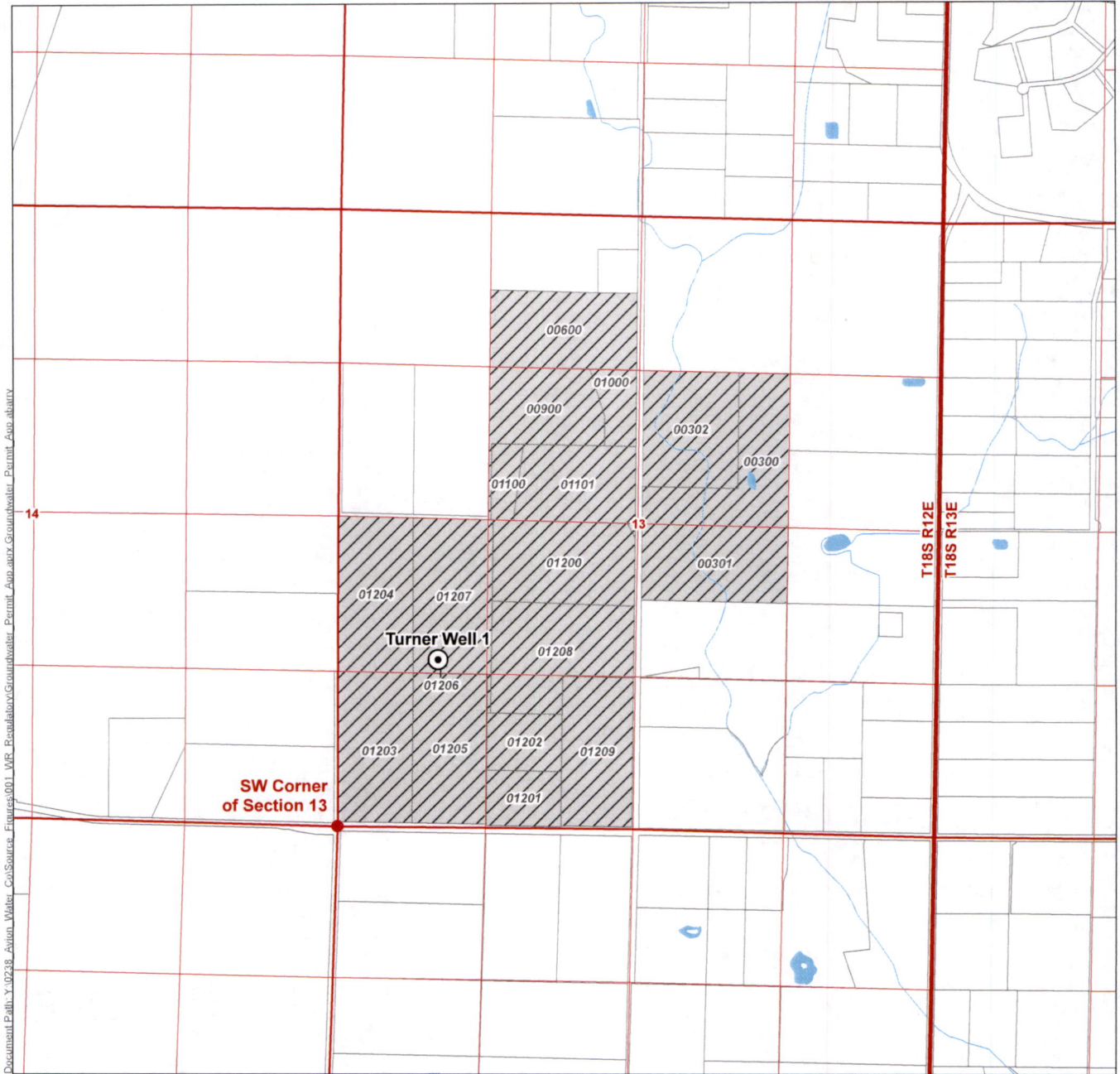

LEGEND

- Proposed Point of Appropriation (POA)
- Proposed Place of Use (POU)
- Tax Lot
- Watercourse
- Waterbody

**Application for a Groundwater Permit
in the Name of Avion Water Co., Inc**

**Proposed Place of Use and
Point of Appropriation Map**

Deschutes County
Township 18 South, Range 12 East (W.M.)

RECEIVED

DEC 19 2022

OWRD
SALEM, OREGON

DISCLAIMER

This map was prepared for the purpose of identifying the location of a water right only and it is not intended to provide legal dimensions or location of property ownership lines.

Date: August 29, 2022

Data Sources: BLM, ESRI, OWRD, USGS, Deschutes Co.

LOCATION DESCRIPTION

Turner Well 1

Located 1465 feet North and 879 feet East from the SW corner of Section 13, Township 18 South, Range 12 East (W.M.)

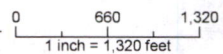

Document Path: Y:\0238_Avion_Water_Co\Source_Figures\001_WR_Regulatory\Groundwater_Permit_App.dwg

RECEIVED

DEC 19 2022

OWRD
SALEM, OREGON

Attachment C

Legal Description

Application for Groundwater Permit – Avion Water Company

RECEIVED

DEC 19 2022

OWRD
SALEM, OREGON

PROPERTY DESCRIPTION

EXHIBIT "A"
Legal Description

For **APN/Parcel ID(s): 164722**
For **Tax Map ID(s): 1812130001206**

A tract of land in Section 13, Township 18 South, Range 12, East of the Willamette Meridian, Deschutes County, Oregon, being more particularly described as follows:

Commencing at the Southeast corner of the Northwest Quarter of the Southwest Quarter of said Section 13; thence Westerly 360 feet along property lines; thence North 81 feet, also being the True Point of Beginning; thence Westerly parallel to property line 100 feet; thence North 88 feet; thence Easterly 100 feet; thence South 88 feet to the Point of Beginning.

RECEIVED

DEC 19 2022

OWRD
SALEM, OREGON

Attachment D

Well Logs

Application for Groundwater Permit – Avion Water Company

WATER WELL REPORT
STATE OF OREGON

RECEIVED

DEC 4 1980

WATER RESOURCES DEPT
SALEM, OREGON

Pg. 1 Of 2

Revised to show

State Well No. cemented areas

185/12E-13cb

State Permit No.

DESC
55603
5803

(1) OWNER:

Name Al Turner, Margret Turner
Address 61061 Larson Road
City Bend State Ore. 97701

(2) TYPE OF WORK (check):

New Well Deepening Reconditioning Abandon

If abandonment, describe material and procedure in Item 12.

(3) TYPE OF WELL:

Air Driven
Mud Dug
Cable Bored

(4) PROPOSED USE (check):

Domestic Industrial Municipal
Irrigation Test Well Other
Thermal: Withdrawal Reinjection

(5) CASING INSTALLED:

Steel Plastic
Threaded Welded

" Diam. from +2 ft. to 25 ft. Gauge .250
" Diam. from _____ ft. to _____ ft. Gauge _____

LINER INSTALLED:

" Diam. from _____ ft. to _____ ft. Gauge _____

(6) PERFORATIONS:

Perforated? Yes No

Type of perforator used _____

Size of perforations _____ in. by _____ in.

_____ perforations from _____ ft. to _____ ft.

_____ perforations from _____ ft. to _____ ft.

_____ perforations from _____ ft. to _____ ft.

(7) SCREENS:

Well screen installed? Yes No

Manufacturer's Name _____

Type _____ Model No. _____

Diam. _____ Slot Size _____ Set from _____ ft. to _____ ft.

Diam. _____ Slot Size _____ Set from _____ ft. to _____ ft.

WELL TESTS:

Drawdown is amount water level is lowered below static level

Was a pump test made? Yes No If yes, by whom?

Yield: 52.4 gal./min. with 0 ft. drawdown after 24 hrs.

_____ gal./min. with drill stem at _____ ft. _____ hrs.

_____ gal./min. with _____ ft. drawdown after _____ hrs.

Artesian flow _____ g.p.m.

Temperature of water 53* Depth artesian flow encountered _____ ft.

(9) CONSTRUCTION:

Special standards: Yes No

Well seal—Material used Cement

Well sealed from land surface to 25 ft.

Diameter of well bore to bottom of seal 12 in.

Diameter of well bore below seal 8 in.

Number of sacks of cement used in well seal 13 sacks

How was cement grout placed? Pressure Grouted

Was pump installed? yes Type SubmHP .15 Depth 748 ft.

Was a drive shoe used? Yes No Plugs _____ Size: location _____ ft.

Did any strata contain unusable water? Yes No

Type of Water? _____ depth of strata _____

Method of sealing strata off _____

Was well gravel packed? Yes No Size of gravel: _____

Gravel placed from _____ ft. to _____ ft.

(10) LOCATION OF WELL:

County Deschutes Driller's well number _____
NW 1/4 SW 1/4 Section 13 T. 18S R. 12E W.M. _____
Tax Lot # _____ Lot _____ Blk _____ Subdivision _____

Address at well location: _____

(11) WATER LEVEL: Completed well.

Depth at which water was first found 770 ft.

Static level 786 716 ft. below land surface. Date 11-13-80

Artesian pressure _____ lbs. per square inch. Date _____

(12) WELL LOG:

Diameter of well below casing 8"

Depth drilled 785 ft. Depth of completed well 770 ft.

Formation: Describe color, texture, grain size and structure of materials; and show thickness and nature of each stratum and aquifer penetrated, with at least one entry for each change of formation. Report each change in position of Static Water Level and indicate principal water-bearing strata.

MATERIAL	From	To	SWL
Sandy Top-Soil	0	4	
Lava	4	67	
Red Cinder Conglomerate	67	71	
Brown Conglomerate	71	80	
Lava	80	100	
Brown Conglomerate	100	144	
Broken Lava	144	159	
Brown Conglomerate	159	165	
Lava	165	167	
Brown Conglomerate, Caving	167	183	
Lava	183	205	
Broken Lava & Crevices	205	208	
Lava	208	246	
Broken Lava & Crevices	246	251	
Soft	251	255	
Lava	255	260	
Broken Lava	260	280	
Lava	280	355	
Broken Lava & Crevices	355	410	
Lava	410	490	
Brown Conglomerate	490	515	

Work started 8-28 19 80 Completed 10-28 1980

Date well drilling machine moved off of well 10-28 1980

Drilling Machine Operator's Certification:

This well was constructed under my direct supervision. Materials used and information reported above are true to my best knowledge and belief.

[Signed] Tommy Shaw Date 11-17, 19 80

(Drilling Machine Operator)

Drilling Machine Operator's License No. 558

Water Well Contractor's Certification:

This well was drilled under my jurisdiction and this report is true to the best of my knowledge and belief.

Name Orvail Buckner Well Drilling, Inc.

(Person, firm or corporation)

(Type or print)

Address 1686 N.E. Negus Way, Redmond, Ore. 97756

[Signed] Orvail Buckner

(Water Well Contractor)

Contractor's License No. 608 Date 11-17, 19 80

NOTICE TO WATER WELL CONTRACTOR
The original and first copy of this report are to be filed with the

WATER RESOURCES DEPARTMENT,
SALEM, OREGON 97310
within 30 days from the date of well completion.

SP*12658-690

RECEIVED

DEC 19 2022

OWRD
SALEM, OREGON

Attachment E

Form M

Application for Groundwater Permit – Avion Water Company

Oregon Water Resources Department

FORM M

FOR MUNICIPAL AND QUASI-MUNICIPAL WATER SUPPLIES

[Information needed to make findings related to ORS 537.153(3)(c)]

RECEIVED

DEC 19 2022

OWRD
SALEM, OREGON

- Please supply the required information in the spaces provided below. If any section of this form is not applicable, please write N/A and provide an explanation why it does not apply.
- Do not attach reference documents. If there is a need, the Department will request them.
- Your signature is certification that identified information is contained in the reference document(s).
- If adequate space is not available on this form to describe and justify your request for additional water, attach additional pages as necessary.

Water Supplier Information

Please provide the following information related to the water supplier requesting additional water. It should be noted that the name of a water supplier is often different than the service area (e.g., *City of ABC and XYZ Urban Growth Boundary*).

Cities are not the only municipal corporation; many kinds of special districts are also allowed to purvey water. Applications requesting to use water for Quasi-Municipal use may be submitted by entities including, but not limited to, the following types of governance: a water association; private water company; or (if under the articles of incorporation) a broader corporation such as a destination resort. Please attach a copy of the article of incorporation related to your distribution of water.

Name of Water Supplier/Entity	Name of Service Area	Governance	Contact Person
Avion Water Company	Turner	Private company	Adam Jackson
List any water suppliers within the same service area and/or any self-supplied industrial user. (Attach an extra sheet, if necessary.)			
N/A			

Request for Additional Water

Briefly explain the reason(s) for your request for additional water (e.g. *loss of current supply, backup, emergency supply, peak demand, growth, or other*). Much of the information needed may be contained in your Water Management and Conservation Plan, Water System Master Plan, or Capital Improvement Plan (as applicable).

Reason(s) for the Request for Additional Water	Time Table for Development of the Additional Water	Justification for Water Source & Amount Requested
The applicant currently operates an existing water system for the Turner subdivision diverting less than 15,000 gallons per day (gpd), the State's groundwater exempt allowance for group domestic use. Due to increased demand, the applicant is applying for a groundwater permit to authorize use above 15,000 gpd.	5 years	The system is served by one groundwater well, Turner Well 1. The rate and volume of water requested is based on the operating parameters of the well.

Water Management and Conservation

- Do you have an approved Water Management and Conservation Plan? Yes No

Avion recently submitted an updated WMCP for other water rights and systems. The Turner Well is on a closed system and not currently authorized on any of those water rights.

- List the “In-Effect” date of your most recently approved Water Management and Conservation Plan: N/A

- Is your system fully metered? Yes No
- Do you perform annual water audits? Yes No

- Annual amount of water produced (MG): 4.31 • Annual amount of water billed for (MG): 4.31
(diverted or appropriated) *(metered consumption)*

- Identify your system’s current annual water loss: 0%
(difference between the amount of water produced and the water billed for)

- Describe your rate structure and billing schedule: **Uniform block rate structure. Avion’s rate structure is determined by the Oregon Public Utility Commission.**
[e.g., commodity rate (uniform rate, declining or inverted block rate); fixed charge with a commodity rate; or a fixed charge and commodity rate using a seasonal differential.]

Population

A supplier’s population includes both permanent residential and transient populations. Residential population should be from census data or, if estimated, the method of estimation must be documented. Adopted comprehensive land use plans, water system master plans, or water management and conservation plans are examples of acceptable documentation. Transient populations are routine users of water by employers (*such as manufacturing or call center type facilities*) that increase the demand within a supplier’s service area. Resort areas, regional airports, sea ports, areas with seasonally variable populations, and colleges/universities are also subject to this transient population test. Special events which are rare occasions (*such as parades, rodeos, festivals, etc.*) are not reasons to apply the transient population test.

Below, please indicate the current population to which you serve water, and cite the source of that information. Please also provide the historic population growth rate over the past 10 years and the projected population you anticipate serving in 20 years.

Present Population being Served:	Source of Information
40	16 household connections X 2.47 people per household, the average number of people per household in Deschutes County according to the U.S. Census Bureau.
Historic population growth rate over the past 10 years:	Source of Information
0	No connections have been added to the Turner water system in the past 10 years.
Projected Population to be Served in 20 Years:	Source of Estimate/Method Used
70	Several potential customers from existing dwellings in the area currently served by individual domestic wells have inquired about hooking up to the Turner water system but were declined because the Turner Well is not currently on a water right and additional pumping could cause the system to exceed the exempt groundwater allowance of 15,000 gpd for group domestic use.

RECEIVED

DEC 19 2022

OWRD
SALEM, OREGON

Current Water Supply

In the table below, please describe all of the sources of your current water supply inventory (*both active and inactive*). Identify those sources and associated water rights that are currently in use. Additionally, please identify any water sources/water rights that are not currently used, or used only on a seasonal or emergency basis, and describe the reason(s) why. If any portion of your water supply is being purchased, identify the supplying entity and, if possible, indicate the water source.

Water Source (Include any wholesale purchases of water)	Water Right Numbers (Permit and/or Certificate)	Priority Date	Amount of Water Allowed	Actively Used? (Yes or No) If "No," explain.
Turner Well	N/A	N/A	N/A	Yes*

Is this application for a new water use permit intended to be used as a primary or backup source? Explain how this right will be used to meet current demand and/or how it will be used to increase reliability and resiliency?

This permit application is intended to be used as the primary source for the Turner water system. The Turner system currently operates on one well, which does not exceed 15,000 gpd, the State's exempt use allowance for group domestic use. Several potential customers from existing dwellings in the area currently served by domestic wells have inquired about hooking up to the Turner system. If approved, this groundwater permit application would authorize the system to exceed 15,000 gpd and reliably supply water to the households connected to the system currently as well as future connections.

Current Water Use

Describe the nature of your current demands for water, as well as the water sources used to meet those needs.

Current Demands for Water (Year: 2021/2022)

Water Source (Including wholesale water purchases)	Water Right Numbers (Permit and/or Certificate)	Peak or Maximum Demand		Average Demand	
		Maximum Instantaneous Rate (in cfs or gpm)	Maximum Daily Demand (MG)	Average Daily Demand (MG)	Average Annual Demand (MG)
Turner Well	N/A	25 gpm	0.032 MG	0.012 MG	4.31 MG

- Per-capita daily demand (in gallons): **300 gal**
(Divide average annual water sales by population to arrive at consumption, and then divide by 365 to get daily values.)
- Peak season (by month/day): **July 1** to **September 30**
- Peak Season number of hours diverted/pumped (if available): **N/A**
- Peak season per-capita daily consumption (in gallons): **800 gal**
(Divide total peak season demand by population and the number of days during the peak.)
- Peaking Factor (ratio between max day demand and average day demand): **2.67**

RECEIVED

DEC 19 2022

OWRD
SALEM, OREGON

Projected Water Use

Describe your anticipated water demands for the next 20 years, and identify the sources of water (*existing and/or new*) that will be used to meet those demands. Please also describe the methodology and/or information source used to make the projected water demand estimates.

Projected Demands for Water in 20 Years (Year: 2042)

- Current average per capita demand (in gallons): 300 gal
- Projected population served in year (2042): 70
- Projected average annual demand (MG): 7.54 MG
- Projected average daily demand (MG): 0.021 MG
- Current peaking value: 2.67
- Projected maximum daily demand (MG): 0.056 MG

Water Source (Including wholesale water purchases)	Water Right Numbers (Permit and/or Certificate) If a new water source, indicate so.	Projected Peak Daily Demand		Projected Average Daily Demand	
		Maximum Instantaneous Rate (in cfs or gpm)	Maximum Daily Demand (MG)	Average Daily Demand (MG)	Average Annual Demand (MG)
Turner Well	N/A	50 gpm	0.056 MG	0.021 MG	7.54 MG

Source or Methodology Used for Demand Projections:

Population growth was estimated based on recent inquiries from existing households currently using domestic wells wanting to hook up to the Turner system. All demand calculations are based on the increase in population from 40 to 70.

Describe any issues, deficiencies or limitations associated with your current water supply inventory contributing to the need to acquire additional water in order to satisfy your current and/or projected 20-year demands:

The pump currently used at the Turner Well may not produce the amount of water necessary to meet the maximum daily demand in 20 years. The applicant intends to upgrade the capacity of the pump to meet the projected demands.

Annual Water Use by Type

In the table below, list the quantity of water diverted for each type of water use and the percentage of the total diversion associated with that use type:

Type	Current Use		Use In 20 Years	
	Quantity Diverted:	Percentage of Total Diversion:	Projected Quantity to be Diverted:	Percentage of Total Diversion:
Residential:	4.31 MG	100%	7.54 MG	100%
Commercial:				
Institutional¹:				
Agricultural²:				
Industrial:				
Other: (specify use)				
System Water Loss:	0	0%	0	0%
Total Diverted:	4.31 MG		7.54 MG	

¹: Institution use includes water served to hospitals, federal, state, or municipal connections, and school districts.

²: Agricultural use includes any type of customer with a service connection dedicated for the raising of livestock or edible or non-edible crops.

Last revision: May 1, 2018/WRSD

RECEIVED
DEC 19 2022
OWRD
SALEM, OREGON

Minimum Requirements Checklist

Minimum Requirements (OAR 690-310-0040, OAR 690-310-0050 & ORS 537.140)

Include this checklist with the application

Check that each of the following items is included. The application will be returned if all required items are not included. If you have questions, please call the Water Rights Customer Service Group at (503) 986-0900.

Please submit the original application and signatures to the Water Resources Department. Applicants are encouraged to keep a copy of the completed application.

- SECTION 1: Applicant Information and Signature
- SECTION 2: Property Ownership
- SECTION 3: Well Development
- SECTION 4: Sensitive, Threatened or Endangered Fish Species Public Interest Information
- SECTION 5: Water Use
- SECTION 6: Water Management
- SECTION 7: Project Schedule
- SECTION 8: Resource Protection
- SECTION 9: Within a District
- SECTION 10: Remarks

Include the following additional items:

- Land Use Information Form with approval and signature of local planning department (*must be an original*) or signed receipt. [Attachment B](#)
- Provide the legal description of: (1) the property from which the water is to be diverted, (2) any property crossed by the proposed ditch, canal or other work, and (3) any property on which the water is to be used as depicted on the map. [Attachment C](#)
- Fees - Amount enclosed: \$ **\$2,590**
See the Department's Fee Schedule at www.oregon.gov/owrd or call (503) 986-0900.
- Map that includes the following items: [Attachment A](#)
 - Permanent quality and drawn in ink
 - Even map scale not less than 4" = 1 mile (example: 1" = 400 ft, 1" = 1320 ft, etc.)
 - North Directional Symbol
 - Township, Range, Section, Quarter/Quarter, Tax Lots
 - Reference corner on map
 - Location of each diversion, by reference to a recognized public land survey corner (distances north/south and east/west)
 - Indicate the area of use by Quarter/Quarter and tax lot identified clearly.
 - Number of acres per Quarter/Quarter and hatching to indicate area of use if for primary irrigation, supplemental irrigation, or nursery
 - Location of main canals, ditches, pipelines or flumes (if well is outside of the area of use)

RECEIVED

DEC 19 2022

OWRD
SALEM, OREGON



December 15, 2022

Katie Ratcliffe
Oregon Water Resources Department
725 Summer Street NE, Suite A
Salem, OR 97301

Re: Application for a Permit to Appropriate Groundwater in the name of Avion Water Company, Inc.

Dear Katie,

Please find enclosed a permit application submitted on behalf of Avion Water Company, Inc. to appropriate groundwater from one well for quasi-municipal use for the Turner Water System. The applicant is requesting to appropriate groundwater at a rate of up to 50 gpm and an annual volume of up to 40acre-feet. Also enclosed is the required fee of \$2,590, which was calculated as follows:

\$1,570 - Base Fee
\$410 - Rate Fee of \$410 for a rate of less than 1 cfs
\$610 - Permit Recording Fee
\$2,590

Please contact me at 971-200-8545 if you have any questions or need additional information.

Sincerely,
GSI Water Solutions, Inc.

A handwritten signature in blue ink, appearing to read "T. Grandy", is written over a light blue circular stamp.

Trevor Grandy
Water Resources Consultant

Cc: Jason Wick, Avion Water Company

Enclosures: Groundwater Permit Application
\$2,590 check for application fees