

# CLAIM OF BENEFICIAL USE BSA CAMP BAKER

NW 1/4, SEC 26, T19S, R12W, W.M.  
TM 19-12-26-20, TL 101  
SE & SW 1/4, SEC 26, T19S, R12W, W.M.  
TM 19-12-26-30, TL 100  
NE 1/4, SEC 35, T19S, R12W, W.M.  
TM 19-12-35-10, TL 400, 401, 601

AUGUST 5, 2022

## LEGEND

- SECTION LINE
- 1/4 SECTION LINE
- TAX LOT LINE
- 1" PVC WATER (DIST)
- 2" OR 4" PVC WATER DISTRIBUTION MAIN
- 2" PVC WATER SUPPLY
- EXISTING STRUCTURE
- EXISTING CAMPSITE WITH WATER SERVICE

NOTE: ALL NAMED STRUCTURES HAVE WATER SERVICE FROM THIS SYSTEM  
PUMPHOUSE ALSO CONTAINS 3 - 1500 GAL STORAGE TANKS AS WELL AS PRESSURE TANKS & WATER TREATMENT EQUIPMENT.

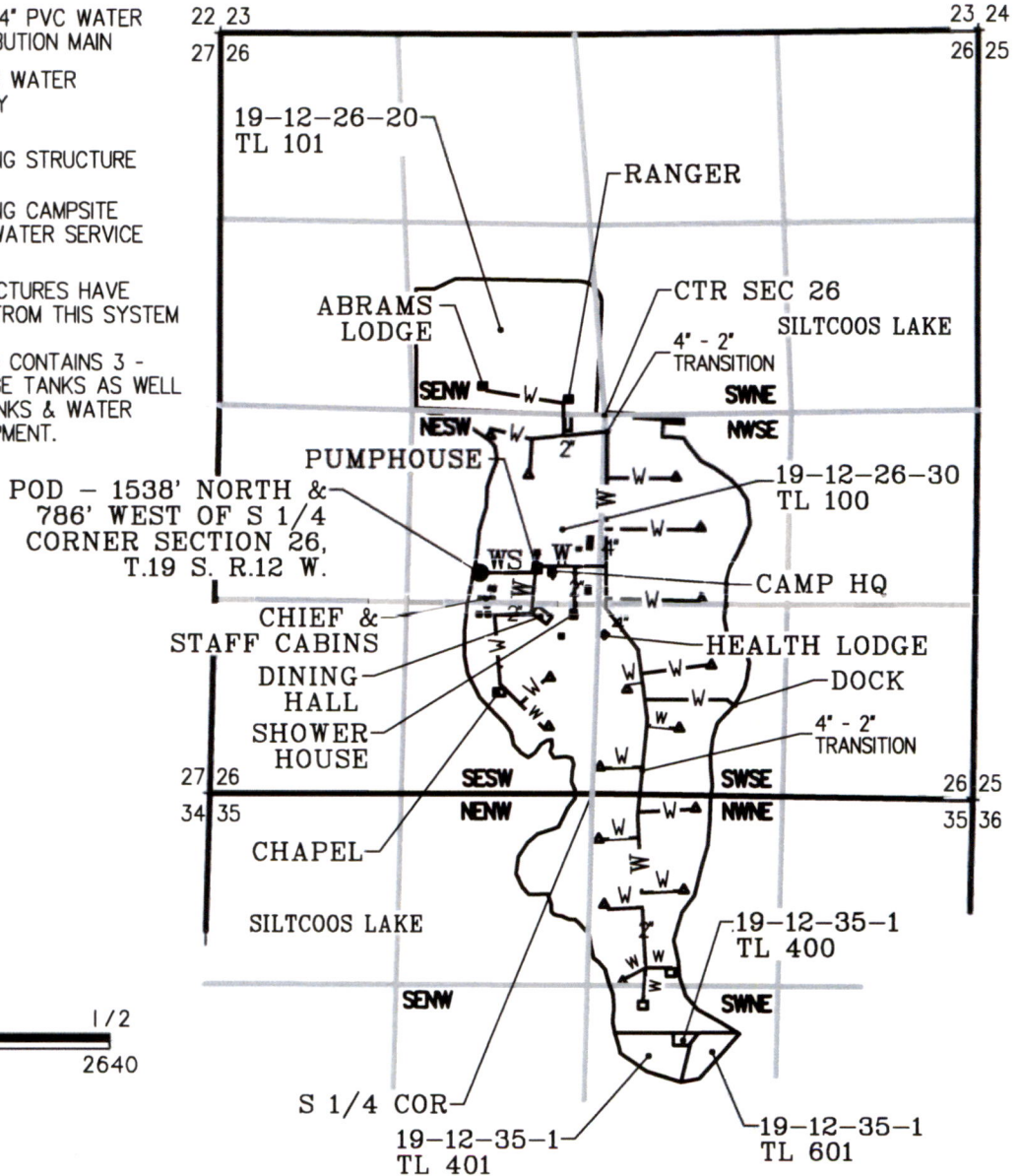

SCALE: 1" = 1320'



PERMIT # S-54677  
APPLICATION # S-87581  
OWNER: OREGON TRAIL COUNCIL INC  
PERMIT HOLDER: OREGON TRAIL COUNCIL INC

### Boeger & Associates LLC

1011 S. Bertelsen Rd  
Eugene, OR 97402  
Ph: 541.302.4996  
Fax: 541.302.4968  
dboeger@boegerassociates.com  
JOB No.: 393

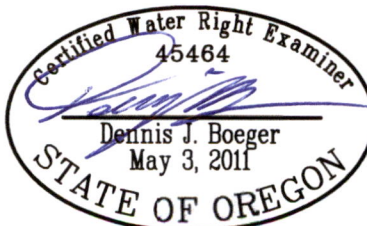

EXPIRES: 12/31/2023

### DISCLAIMER

THIS MAP IS NOT INTENDED TO PROVIDE LEGAL DIMENSIONS OR LOCATIONS OF PROPERTY OWNERSHIP LINES.