



Alternate Reservoir Application Map  
Smith Family Trust  
T.25S. R.4W. Section 16  
Douglas County

RECEIVED

JAN 23 2023

OWRD

Scale: 1" = 800'

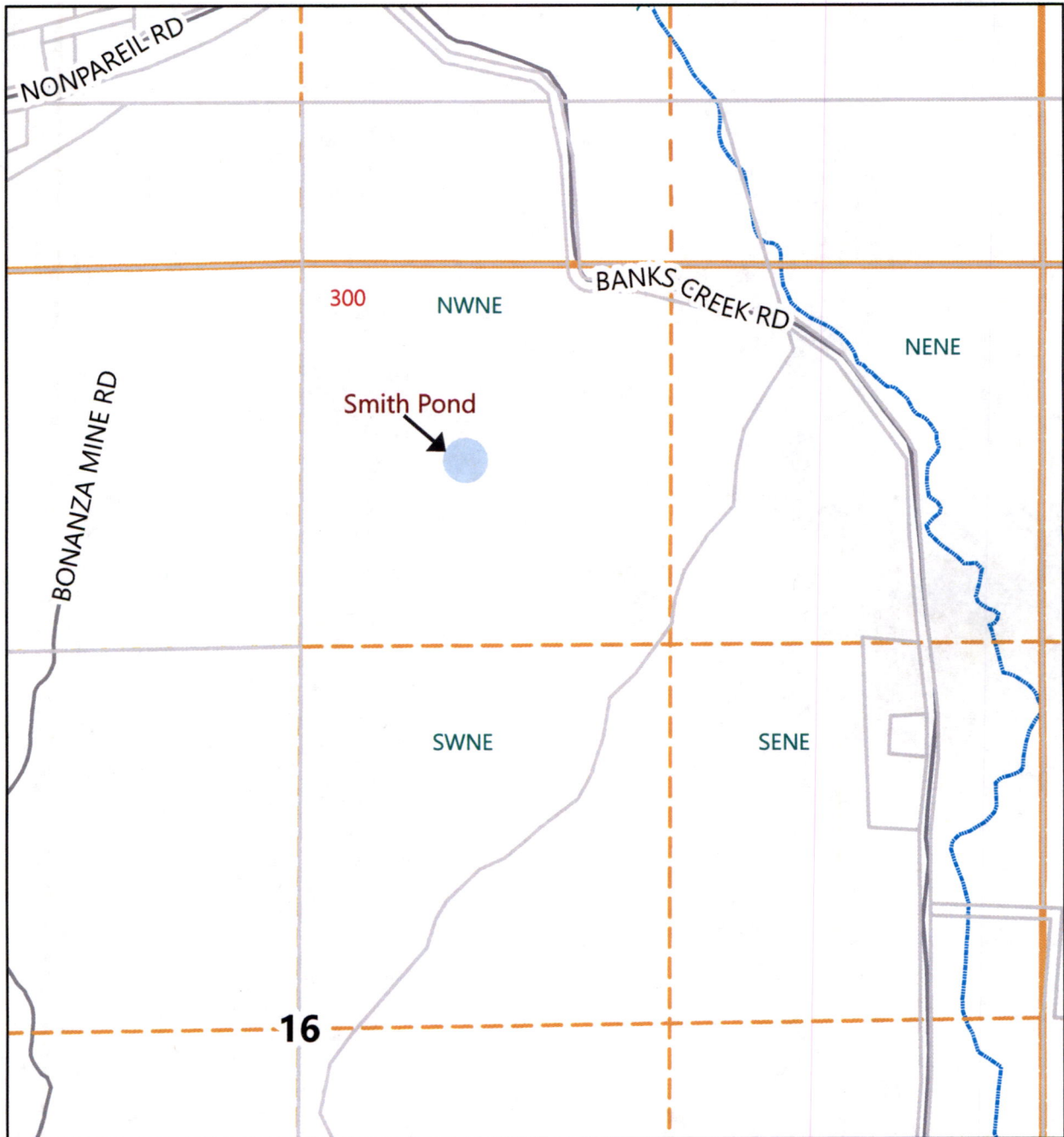

Smith Pond is 965 ft South and 2825 ft West  
from the NE Section Corner 16

The purpose of this map is to identify  
the location of a Water Right.  
Not intended to show property ownership.