

T.4S. R.4W. Sec. 11 & 12, W.M.

RECEIVED

JAN 26 2023

OWRD

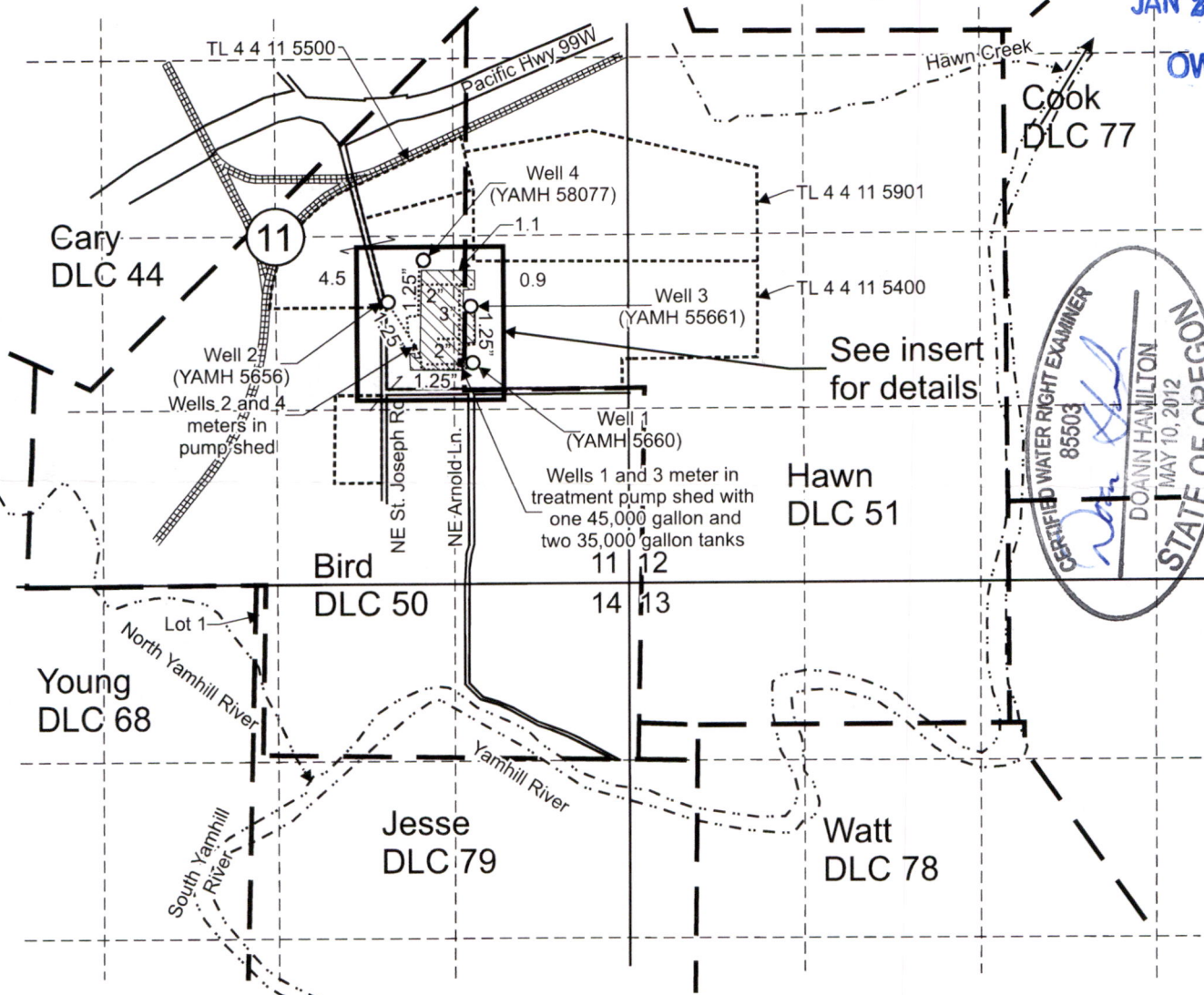

See insert for details

CERTIFIED WATER RIGHT EXAMINER
85503
DOANN HAMILTON
MAY 10, 2012
STATE OF OREGON
EXPIRES: June 30, 2023

- Well 1 (YAMH 5660) is located 960 feet south and 1,475 feet east from the Center corner, Section 11.
- Well 2 (YAMH 5656) is located 500 feet south and 840 feet east from the Center corner, Section 11.
- Well 3 (YAMH 55661) is located 535 feet south and 1,460 feet east from the Center corner, Section 11.
- Well 4 (YAMH 58077) is located 185 feet south and 1,110 feet east from the Center corner, Section 11.

 Area (6.5 Acres) irrigated under Application G-15543, Permit G-18158, T-12590.

 Tax lot boundary

 Water main line

 Donation Land Claim boundary

Scale: 1" = 1,320'



This map was prepared for the purpose of identifying the location of a water right only and is not intended to provide legal dimensions or location of property ownership lines.



Claim of Beneficial Use Map
Application G-15543, Permit G-18158

North American Plants, Inc., c/o Yongjian Chang
T.4S. R.4W. Sec. 11 & 12, W.M.

Pacific Hydro-Geology Inc.

12/2022

T.4S. R.4W. Sec. 11 & 12, W.M.

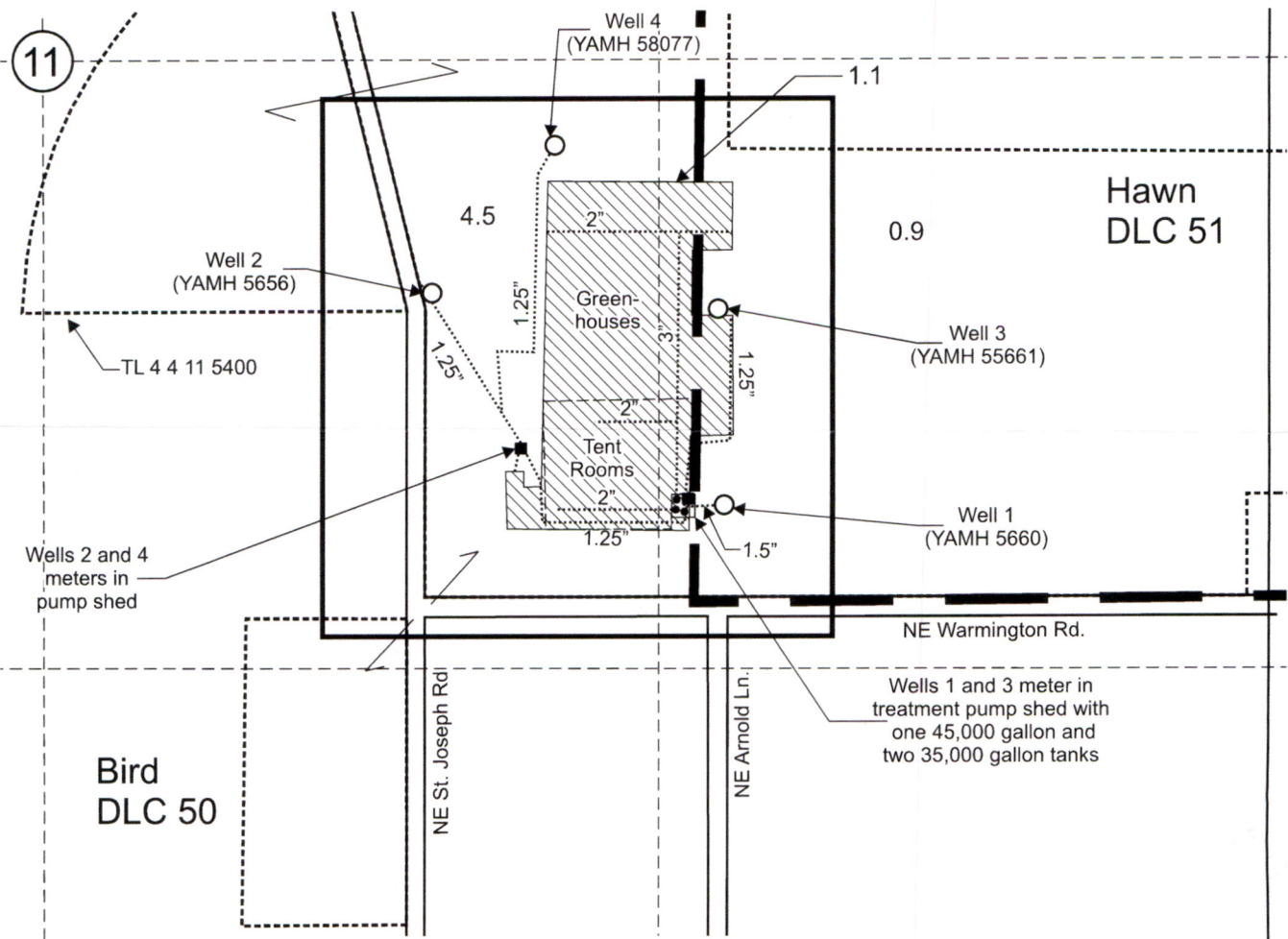

Well 1 (YAMH 5660) is located 960 feet south and 1,475 feet east from the Center corner, Section 11.
 Well 2 (YAMH 5656) is located 500 feet south and 840 feet east from the Center corner, Section 11.
 Well 3 (YAMH 55661) is located 535 feet south and 1,460 feet east from the Center corner, Section 11.
 Well 4 (YAMH 58077) is located 185 feet south and 1,110 feet east from the Center corner, Section 11.

Area (6.5 Acres) irrigated under Application G-15543, Permit G-18158, T-12590.

Tax lot boundary

Water main line

Donation Land Claim boundary

Scale: 1" = 400'

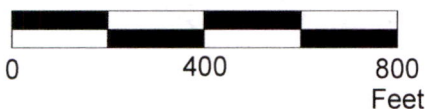

EXPIRES: *July 30 2023*

This map was prepared for the purpose of identifying the location of a water right only and is not intended to provide legal dimensions or location of property ownership lines.

