

Name Pete Cowan
 By _____
 Address P.O. Box 2331
Harbor, OR 97415

 Date filed June 7, 1976
 Priority June 7, 1976
 Action suspended until OK cert

 Return to applicant _____
 Date of approval MAR 21 1977

CONSTRUCTION
 Date for beginning MAR 21 1978
 Date for completion OCT 1 1978
 Extended to _____
 Date for application of water OCT 1 1979
 Extended to _____

PROSECUTION OF WORK
 Form "A" filed _____
 Form "B" filed _____
 Form "C" filed completed

FINAL PROOF
 Blank mailed APR 12 1989
 Proof received _____
 Date certificate issued JUN 27 1989

Application No. G 7402
 Permit No. G G 7085
 Certificate No. 61656
 See Files 54341 and 54342
 Stream Index, Page No. 15-106
No log; Who-When?

FEES PAID		
Date	Amount	Receipt No.
6-7-76	25.00	53132
9-30-76	(1.20)	53133
5-2-77	6.20	60150
Cert. Fee		
FEES REFUNDED		
Date	Amount	Check No.

ASSIGNMENTS				
Date	To Whom	Address	Volume	Page

REMARKS

Holt - 4/28/54

Well in proposed Brookings-Bluffs. Critical ground water area.
He should be advised that the well in this area presently
under investigation. It is recommended that well not be
constructed at this time until final determination of the
critical area.

WJG

STATE OF OREGON

COUNTY OF CURRY

PROPOSED CERTIFICATE OF WATER RIGHT

THIS CERTIFICATE ISSUED TO

PETE COWAN
P.O. BOX 2970
HARBOR, OREGON 97415

confirms the right to use the waters of A WELL in the CHETCO RIVER BASIN for the purpose of IRRIGATING 5.8 ACRES.

The right has been perfected under Permit G-7085. The date of priority is JUNE 7, 1976. The right is limited to not more than 0.07 CUBIC FOOT PER SECOND or its equivalent in case of rotation, measured at the well.

The well is located as follows:

SE 1/4 SW 1/4, AS PROJECTED WITHIN DLC 41, SECTION 9, T 41 S, R 13 W, W.M.; 420 FEET SOUTH AND 650 FEET WEST FROM SE CORNER DLC 40.

The amount of water used for irrigation, together with the amount secured under any other right existing for the same lands, shall be limited to ONE-EIGHTIETH of one cubic foot per second per acre, or its equivalent for each acre irrigated and shall be further limited to a diversion of not to exceed 2.5 acre-feet per acre for each acre irrigated during the irrigation season of each year.

The right shall conform to such reasonable rotation system as may be ordered by the proper state officer.

A description of the place of use under the right, and to which such right is appurtenant, is as follows:

SE 1/4 SW 1/4 5.8 ACRES
AS PROJECTED WITHIN DLC 41
SECTION 9
TOWNSHIP 41 SOUTH, RANGE 13 WEST, W.M.

The right to the use of the water for the above purpose is restricted to beneficial use on the lands or place of use described.

G-7402.TES

RECEIVED

FEB 4 1988

CURRY
Abstract of Permit No. G-7085

WATER RESOURCES DEPT
SALEM, OREGON

Application No. G-7402

Certificate No.

Name Pete Cowan
P. O. Box ~~2831~~ 2970
Address Harbor, OR 97415

H69-3404

Source of water supply A well Chetco River Basin

Use Irrigation of 5.8 acres
Taggart DLC 40

Point of diversion 415' S. & 625' W. SE from SE cor., sec. 9, being within SE $\frac{1}{4}$ SW $\frac{1}{4}$ sec. 9, being within SE $\frac{1}{4}$ SW $\frac{1}{4}$ sec. 9, T.41S., R.13W., W.M.; Gurry County

Number of acres 6.0

after Sharp DLC 41

DESCRIPTION OF LAND TO BE IRRIGATED OR PLACE OF USE

Twp.	Range	Sec.	NE $\frac{1}{4}$				NW $\frac{1}{4}$				SW $\frac{1}{4}$				SE $\frac{1}{4}$			
			NE $\frac{1}{4}$	NW $\frac{1}{4}$	SW $\frac{1}{4}$	SE $\frac{1}{4}$	NE $\frac{1}{4}$	NW $\frac{1}{4}$	SW $\frac{1}{4}$	SE $\frac{1}{4}$	NE $\frac{1}{4}$	NW $\frac{1}{4}$	SW $\frac{1}{4}$	SE $\frac{1}{4}$	NE $\frac{1}{4}$	NW $\frac{1}{4}$	SW $\frac{1}{4}$	SE $\frac{1}{4}$
41 S	13 W	9																

SE $\frac{1}{4}$ SW $\frac{1}{4}$ after Sharp DLC 41

5.8

Priority date June 7, 1976

Amount of water ~~0.08 c.f.s.~~ *0.07 c.f.s.*

Time limit to begin construction 3-21-78

Time limit to complete construction 10-1-78 extended to extended to

Time limit to completely apply water 10-1-79 extended to extended to

Remarks: Limitations: 1/80th c.f.s., 2 $\frac{1}{2}$ a.f.

N.C.R. Jr

*41011-180-143D
4-70-85 LEC*

cgm

Basin 15 Hills

Basin 15, Volume 7

RECEIVED

FEB 4 1988

WATER RESOURCES DEPT.
SALEM, OREGON

Well
O 950' N. 7' From SW 1/4 cor
230' WJ Sec. 9

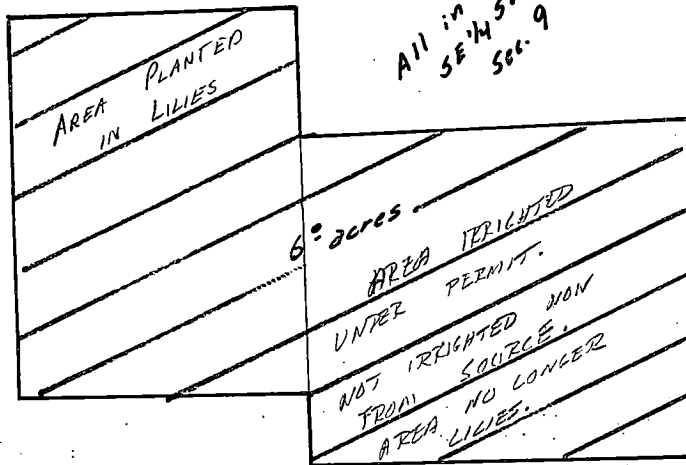

All in
SE 1/4 SW 1/4
Sec. 9

Application No. G-7402
Permit No. G 7085

Tp. 41 So. R13 W.
Sec. 9
1" = 200'

9

16

RECEIVED

JUN - 7 1976

WATER RESOURCES DEPT
SALEM, OREGON

THIS MAP PREPARED BY: _____
FROM INFORMATION FURNISHED BY THE
APPLICANT

m/a

A# G 7402
P# G-7085

INFO: Pete Cowan indicates well location, fields and explains water use.

USE: irrigation of lilies and ground cover (rotated w/ lilies)

SOURCE: a well (see G-1177 also)

DIV. PT: 8" ϕ ~~stl~~ steel casing extends 12" above ground
Cowan states well is ~26' deep
SWL: 11' below top of casing

PUMP: 0.4 HP electric motor
"Red Jacket" submersible pump 2" discharge
Pump = $\frac{(6.60 \times 10)}{127 + 11} = \frac{66}{138} = 0.48 \text{ cfs @ } 50 \text{ psi}$

PIPE: 4" E 3" ϕ alum 7800'
2" ϕ alum 1200'
~~4" ϕ wood~~

HEADS: 10 RB max @ one time from well
counted 85 RB "30" E "40" with various
sizes of double ports @ 50 PSI
10.4 = 2.2 $\frac{3}{16}$ " X $\frac{1}{8}$ "^{3.2}
8.2 = 5.0 $\frac{5}{32}$ " X $\frac{1}{8}$ "^{3.2} Sprinkler = $\frac{(10 \times 7.7)}{450} = \frac{77}{450} = 0.17 \text{ cfs}$
54.2 = 7.7
7
9.2 = 6.0 $\frac{1}{16}$ " X $\frac{1}{8}$ "^{3.2}
5.0 = 1.8 $\frac{3}{16}$ " X $\frac{1}{8}$ "^{3.2}
7.8 = 6.0 $\frac{1}{16}$ " X $\frac{3}{32}$ "^{1.8}
6.8 = 5.0 $\frac{5}{32}$ " X $\frac{3}{32}$ "^{1.8}
counted 60 RB "30" E "40" $\frac{5}{32}$ " X $\frac{3}{32}$ "
5.0 1.8 = 6.8

PHOTO: 41011 180 143 B entire area irrigated by Cowan is
cross-hatched - check for old rights

LIFT: 0-5'
 $Q = \frac{6}{80} = 0.08 \text{ cfs}$ $Q = \frac{55}{460} = 0.07 \text{ cfs}$

REMARKS: one field was irrigated w/in terms of permit,
but is now being converted to a trailer park.
see app map.

see also A# 54341

Dyann Cashion

WRE

4/10/85

Pete Cowan
P.O. Box 2331
Harbor, OR 97415

May 24, 1977

G-7402

G-7085 with map.

378-3066

May 23, 1977

File G-7402

Pete Cowan
P.O. Box 2331
Harbor, OR 97415

Dear Mr. Cowan:

Thank you for the additional fee of \$6.20.

Your permit will be promptly issued.

Sincerely,

Vestal R. Garner 
Water Rights Engineer

VRG:lds
Encl: Receipt No. 60150

378-3066

G 7402

April 8, 1977

Pete Cowan
P.O. Box 2331
Harbor, Oregon 97415

Dear Mr. Cowan:

During the correspondence regarding your application G 7402 for a permit to appropriate water from a well for irrigation of 6 acres the computation of fees was overlooked. The application requires fees of \$30.00. You submitted \$85.00 with three applications. The two for which permits were issued required \$61.20, leaving \$23.80 for application G 7402. If you will send the balance of \$6.20 the permit will be promptly issued.

Sincerely,

Trevor Jones

TJ:whh



STATE OF OREGON

INTEROFFICE MEMO

TO: Files No. 54342 and G-7402

DATE: March 7, 1977

FROM: Ves Garner

SUBJECT: Harbor Bench Critical Ground Water Area

Since the determination of the proposed critical ground water area for the Harbor Bench has now been made, and it has been concluded that no critical ground water area exists. A permit can be issued in approval of application No. G-7402.

Application No. G-7402 was originally intended to be primary and application No. 54342 was intended to be supplemental. Both applications were filed on the same date.

Since a permit could not be issued in approval of application No. G-7402 until such time as the critical ground water determination was made. A permit was issued in approval of application No. 54342 as primary irrigation.

In accordance with my letter of August 3, 1976 to Pete Cowan, permit issued in approval of application No. 54342 is to be considered supplemental at such time as a permit is issued in approval of G-7402.

A permit will now be issued in approval of application No. G-7402. Therefore, permit No. 40797 is to be considered supplemental.

378-3066

March 7, 1977

File G-7402
54342

Pete Cowan
P.O. Box 2331
Harbor, OR 97415

Dear Mr. Cowan:

It has been determined that a critical ground water area does not exist at the present time at Harbor Bench. Permits can now be issued for use of ground water in the Harbor Bench area.

We have been holding your application No. G-7402 pending final determination. You may recall, this application requests primary irrigation of six acres from a well. You also have application No. 54342 which was intended in part to be supplemental to your ground water filing. We have now amended permit No. 40797 which was issued in approval of your application No. 54342 to be entirely supplemental, and a permit will be issued in approval of your application No. G-7402 for the primary irrigation.

The permit should be issued in 30 to 60 days.

Sincerely,

Vestal R. Garner
Water Rights Engineer

VRG:lds



STATE OF OREGON

INTEROFFICE MEMO

TO: Ves Garner

DATE: March 1, 1977

FROM: Fred Lissner *[Signature]*

SUBJECT: Harbor Bench Status

Annual ground water level declines on the Harbor Bench average approximately 4.6 inches. This decline appears at this time to be attributable to the occurrence of less than average rainfall over the last five years. It is anticipated that a return to average precipitation will result in termination of the water level decline. No critical ground water area is currently being proposed for the Harbor Bench. As a result, there need be no further delay in issuing ground water permits on the bench.

54341, 54342, G-7402

3 August 1976

Pete Cowan
P.O. Box 2331
Harbor, Oregon 97415

Dear Mr. Cowan:

This will acknowledge your maps, fees of \$85.00 and applications for permits to appropriate 0.32 cubic foot per second of water from Johnson Creek for irrigation of 25.75 acres; the appropriation of 0.42 cubic foot per second of water, being 0.21 cfs from an unnamed stream and 0.21 cfs from a spring for irrigation of 21.5 acres and supplemental irrigation of 12 acres; also to appropriate 0.075 cfs of water from a well for irrigation of 6 acres. These applications have been filed as No. 54341, No. 54342, and No. G-7402, respectively.

Your applications to appropriate water from Johnson Creek, the unnamed stream and the spring are in satisfactory form for approval by issuance of permits.

Permits will be issued for use of water from Johnson Creek and its tributaries with the understanding that water may not be available during the dry periods of the irrigation season. The available water may be needed to satisfy existing rights or meet minimum flow standards established.

Your proposed well would be located within the proposed Brookings-Harbor Critical Ground Water Area currently under investigation. It is recommended that this well not be constructed until such time as a final determination has been made regarding the ground water in this vicinity.

A permit in approval of your application No. G-7402 will not be issued until such time as the final determination has been made.

Pete Cowan

54341, 54342, G-7402

- 2 -

Your application No. 54342, which requests a permit, in part, for supplemental irrigation of the land described by your application No. G-7402, has been amended to request a permit for primary irrigation of the 6 acres described by this well and supplemental irrigation of 6 acres described by previous rights.

If, at a later date, a permit is issued in approval of your application No. G-7402 for primary irrigation, the permit issued in approval of application No. 54342 can be amended so as to describe supplemental irrigation of the entire 12 acre parcel.

If you should have questions regarding this matter, please do not hesitate to contact this office.

Sincerely,

Vestal R. Garner
Water Rights Engineer

VRG:lcm

ENCL: Receipts No. 53132, 53133, 53134