

RECEIVED

FEB 15 2023



Oregon Water Resources Department
725 Summer Street NE, Suite A
Salem, Oregon 97301
(503) 986-0900
www.oregon.gov/OWRD

OWRD

Ownership Update
for Certificated Rights Only

NO FEES ARE REQUIRED TO SUBMIT THIS FORM

NOTICE: A certificate of water right typically stays with the land. To track water right ownership, the Department requests that this form be submitted to the Department. To update multiple rights, a separate form is required for each right. If you have any questions about this form, please contact your local watermaster, or call the Water Resources Department at (503) 986-0900.

Note: Use the assignment form to change ownership on pending applications, permits, transfers, groundwater registrations, or limited licenses.

Current Landowner Information
Name: Don Chitwood
Mailing Address: 19742 Olmstead Rd NE
City: Aurora State: OR Zip: 97002
Phone: 503-805-1188 Email: donch47@gmail.com

Property Information
County: Marion Township: 4S Range: 1W Section: 19C
Tax Lot #: 1600
Street Address of Water Right: 19742 Olmstead Rd NE
Water Right Information
Application: G-7242
Permit: G-6647
Certificate: 56530
Are all the lands associated with this water right owned by the requestor? [] Yes [X] No
(If no, include a map showing the portion of the water right involved)

Signature and Date
Name of individual completing form: Don Chitwood (Don Chitwood)
Phone or email: 503-805-1188 Date: 11/14/22
Signature of requestor: Don Chitwood

The Department does not change names on water right certificates. This form will be placed in the file for future reference only. If mailed, the Department will not provide acknowledgment of receipt.

This form can be mailed to the address above or sent by email to wrd_dl_customerservice@water.oregon.gov

T.4S. R.1W. Section 19, W.M.

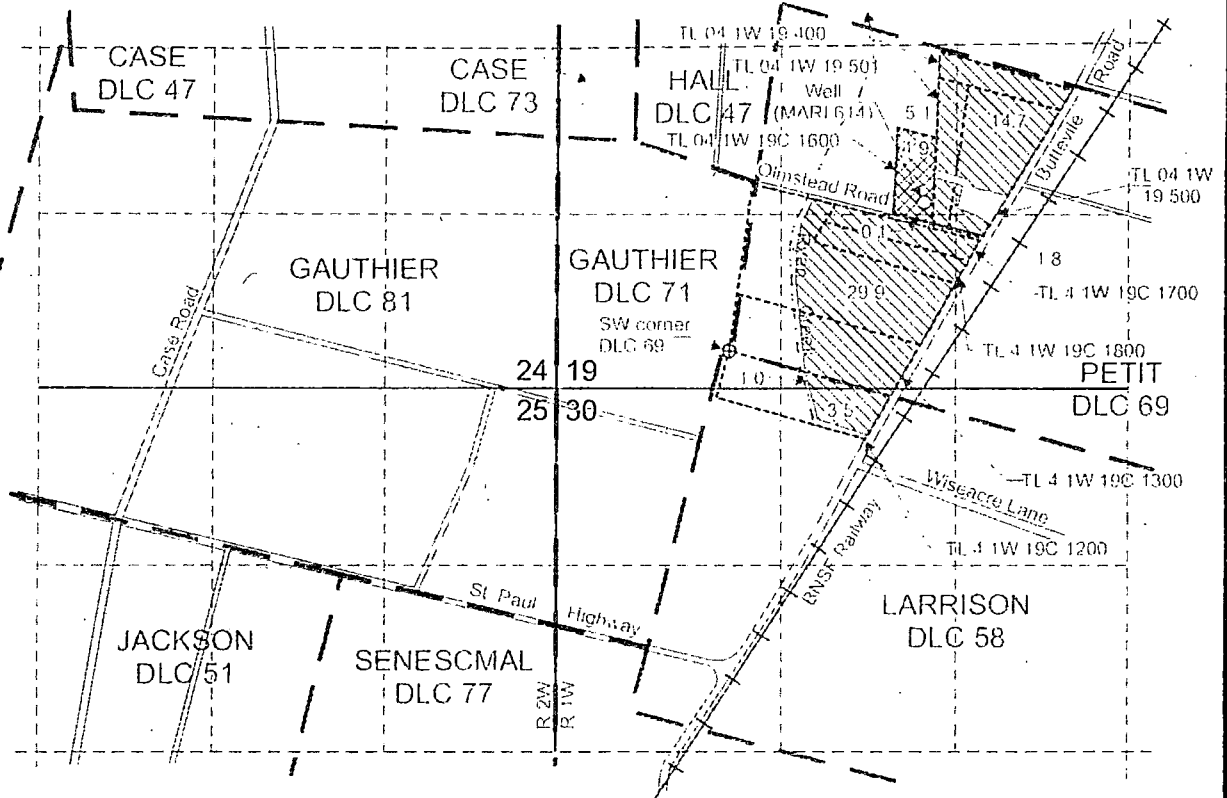

Well (MARI 614) is located 1,100 feet north and 1,520 feet west from the SW corner, DLC 69.



Portion (5.0 acres) of Certificate 56530 updated to ownership of Don Chitwood.



Portion (56.0 acres) of Certificate 56530 to remain under ownership of Norbert H. Gilles

— • — Donation Land Claim boundary

----- Tax lot boundary

Scale: 1" = 1,320'

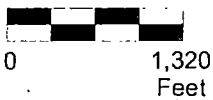

This map was prepared for the purpose of identifying the location of a water right only and is not intended to provide legal dimensions or location of property ownership lines



Pacific Hydro-Geology Inc.

Partial Ownership Update Map
Certificate 56530

Don Chitwood
T.4S. R.1W. Section 19 W.M

11/2022

ChitwoodCor: 56530OwnerupdateMap.cdr