



Application No. 5634  
Permit No. 42745

**LEGEND - WATER SOURCES**

- ① 700 FT. W. & 1300 FT. S. OF N.W CORNER OF SECTION 29
- ② 200 FT. W. & 500 FT. S. OF N.W CORNER OF SECTION 29
- ③ 300 FT. E. & 700 FT. S. OF N.W CORNER OF SECTION 29
- ④ 900 FT. E. & 700 FT. S. OF N.W CORNER OF SECTION 29
- ⑤ 1200 FT. E. & 1200 FT. S. OF N.W CORNER OF SECTION 29
- ⑥ 1500 FT. E. & 700 FT. S. OF N.W CORNER OF SECTION 29
- ⑦ 1600 FT. E. & 100 FT. S. OF N.W CORNER OF SECTION 29



AREA TO BE IRRIGATED BY SOURCE NUMBERS 2, 4, 6



AREA TO BE IRRIGATED BY SOURCE NUMBERS 1, 3, 5

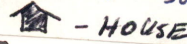

NOTE: SOURCE 7 IS FOR DOMESTIC USE & 100 FT X 100 FT GARDEN. SOURCES 1-6 FOR IRRIGATION.

**LEGEND**

--- ROAD  
~ STREAM

**RECEIVED**

FEB 17 1978

WATER RESOURCES DEPT.  
SALEM, OREGON

**RECEIVED**

FEB 17 1978

WATER RESOURCES DEPT.  
SALEM, OREGON

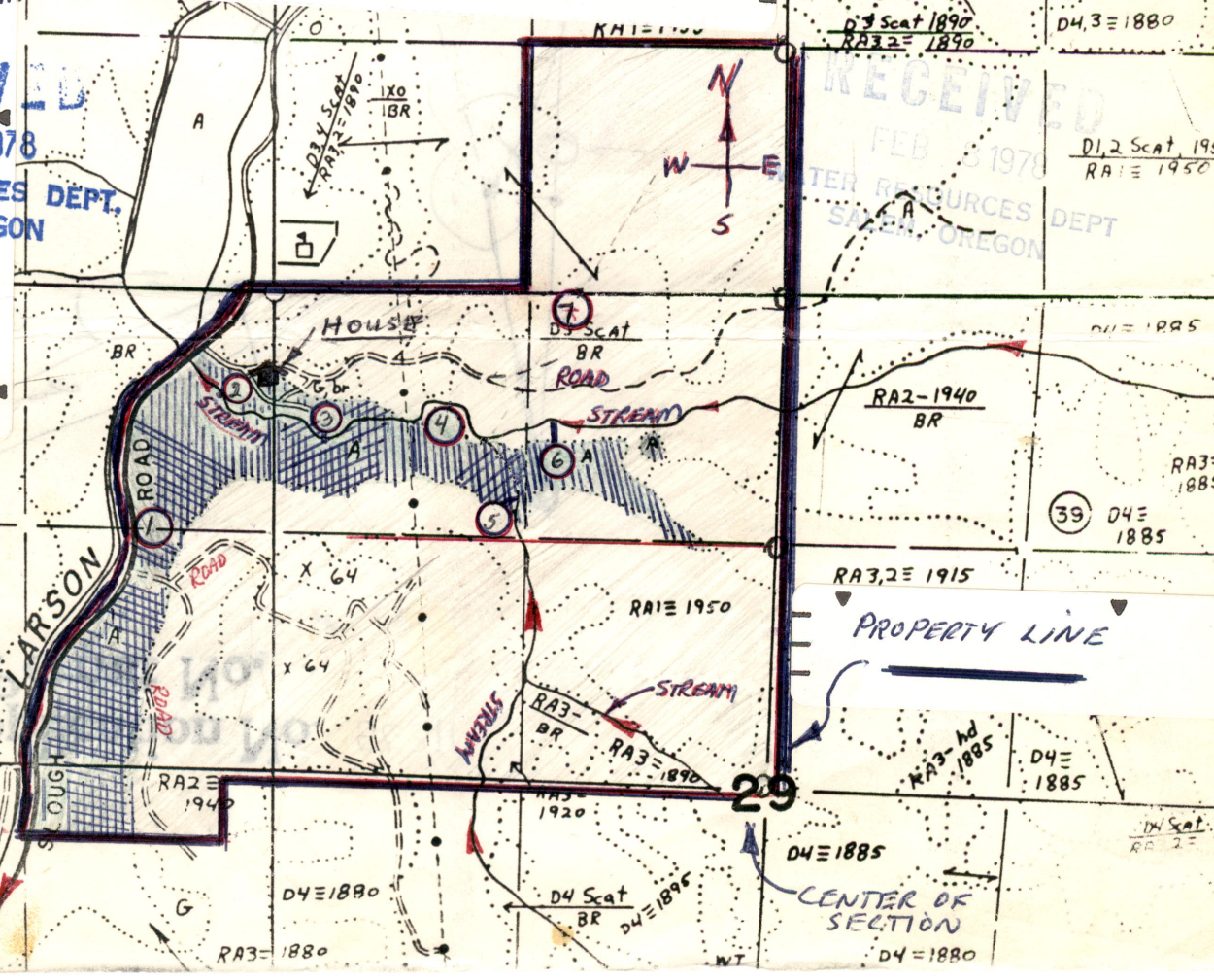

Application No. 56311  
Permit No.



VI  
3 DELI  
8

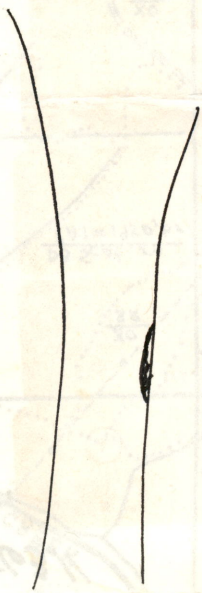
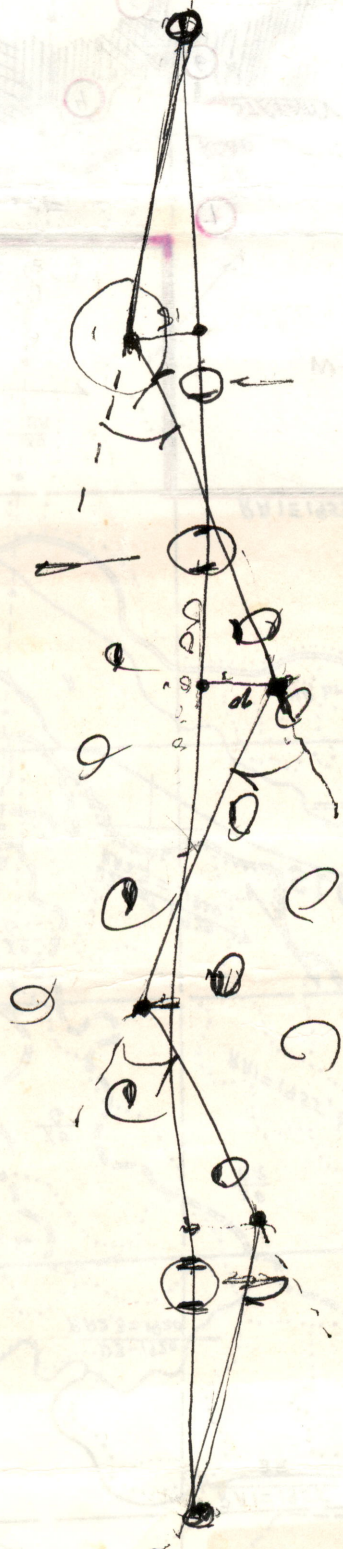
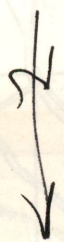

**UNITED STATES POSTAL SERVICE**  
**OFFICIAL BUSINESS**

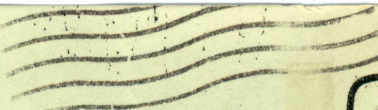
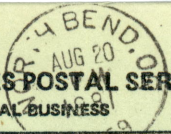

PENALTY FOR PRIVATE  
USE TO AVOID PAYMENT  
OF POSTAGE, \$300

**SENDER INSTRUCTIONS**

Print your name, address, and ZIP Code in the space below.

- Complete items 1, 2, and 3 on the reverse.
- Attach to front of article if space permits, otherwise affix to back of article.
- Endorse article "Return Receipt Requested" adjacent to number.

**RECEIVED**

AUG 21 1981

**WATER RESOURCES DEPT**  
**SALEM, OREGON**

**RETURN  
TO**



WATER RESOURCES DEPT.  
MILL CREEK OFFICE PARK  
555 13th ST. N.E.  
SALEM, OREGON 97310

\_\_\_\_\_  
(Name of Sender)

\_\_\_\_\_  
(Street or P.O. Box)

\_\_\_\_\_  
(City, State, and ZIP Code)

PS Form 3811, Jan. 1979

RETURN RECEIPT, REGISTERED, INSURED AND CERTIFIED MAIL

SENDER: Complete items 1, 2, and 3.  
Add your address in the "RETURN TO" space on reverse.

1. The following service is requested (check one.) 60  
 Show to whom and date delivered.....¢  
 Show to whom, date and address of delivery.....¢  
 RESTRICTED DELIVERY  
           Show to whom and date delivered.....¢  
 RESTRICTED DELIVERY.  
           Show to whom, date, and address of delivery.\$\_\_\_\_  
  
 (CONSULT POSTMASTER FOR FEES)

2. ARTICLE ADDRESSED TO:  
 Dennis C. Beetham  
 560 Larson Way  
 North Bend, OR 97459

3. ARTICLE DESCRIPTION:  

REGISTERED NO.	CERTIFIED NO.	INSURED NO.
	56638	

(Always obtain signature of addressee or agent)

I have received the article described above.  
SIGNATURE  Addressee  Authorized agent  
Art Durb

4. DATE OF DELIVERY      POSTMARK  
8-20-81
P

5. ADDRESS (Complete only if requested)

6. UNABLE TO DELIVER BECAUSE:      CLERK'S INITIALS  
K



56311 JW

AUG 19 1981

378-8508 or  
1-800-452-7813

Dennis C. Beetham  
560 Larson Way  
North Bend, OR 97459

REFERENCE: 56311

According to the terms of your Permit 42745 for which to use 0.70 cfs from Larson Slough, unnamed stream #1, unnamed stream #2 and spring for domestic use for one family including the irrigation of lawn and garden not to exceed  $\frac{1}{2}$  acre in area, and irrigation. complete application of water was to have been made by October 1, 1980

Complete application of water means the application of water to a beneficial use under the permit to the full extent intended. In the case of irrigation, it means beneficial irrigation of all the lands the permittee intends to cover under the terms of the permit. If the water has been used, you should promptly submit notice describing the extent of completion as set forth in the letter accompanying your permit and also in our postal card of

ORS 537.260 provides that: "Whenever the time within which any appropriation under a permit should have been perfected has expired and the owner of the permit fails or refuses within three months thereafter to submit to the Water Resources Director proof of completion of the appropriation as required by ORS 537.230 and 537.250, the Water Resources Director may, after 60 days notice by registered mail, order the cancellation of the permit..."

In accordance with the provisions of ORS 537.260, you are hereby notified that unless proof of beneficial use is received within 60 days from the date of this letter, the permit(s) may be canceled without further notice.

If, for any reason, you are no longer interested in the project described by the permit, we would appreciate it if you would so advise. If the property involved has changed hands and any part of the project has been completed, you should immediately assign the permit to the new owner and advise us of his name and address. An assignment form will be furnished upon request.

Sincerely,

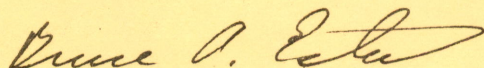

Bruce A. Estes, Supervisor  
Survey-Certificate Section

PHONE 378-8508

March 10, 1981

Dennis C. Beetham  
560 Larson Way  
North Bend, OR 97859

File No. 56311

Dear Mr. Beetham:

I am enclosing a form for use in making application for an extension of time limits under permit number 42745.

The Water Resources Director is permitted by law to extend the time for completion of a project only upon a showing of reasonable diligence by the permittee. Therefore, you should fill out this application carefully and completely describing what has been accomplished.

The application must be executed before a notary public and submitted to this office with the statutory filing fee in the amount of \$10.00 for each permit.

Sincerely,

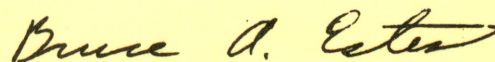

Bruce A. Estes, Supervisor  
Certificate-Survey Section

Form 115

BAE:1rs  
Enclosure

Dear Sis :

Please extend our  
time extension to Oct 1981  
to complete the installation  
and application.

Thank You  
Dennis Beetha

WATER RESOURCES DEPT  
SALEM, OREGON

MAR 9 1981

RECEIVED



**D. C. WESTERN** Engineering • Process Design & Equipment  
560 Larson Way • North Bend, Oregon 97459

Water Resources Dept.  
Mill Creek Office Park  
555 13<sup>th</sup> ST. N.E.  
Salem Oregon 97310



WATER RESOURCES DEPT.  
MILL CREEK OFFICE PARK  
555 13th ST. N.E.  
SALEM, OREGON 97310



**RECEIVED**  
MAR 09 1981  
WATER RESOURCES DEPT  
SALEM, OREGON

Wennis C. Beetham  
560 Hanson Way  
North Bend, Or.  
97459

56311

C

**STATE OF OREGON**  
**Office of the Water Resources Director**  
**Salem, Oregon 97310**

According to the terms of Permit No. 42745, the water should have been completely applied to the proposed use on or before October 1, 1980. A blank (Form C) upon which to notify this office of the complete application of water to the proposed use is attached to your permit. If the water was so applied, or all you intend to develop, you should promptly fill out and file this notice. If all the water has not been applied and you intend to fully utilize the same, an application for extension of time should be made. If you have abandoned the development, notice to this effect with authority to cancel the permit would be greatly appreciated.

378-8508

November 20, 1979

56311

Dennis C. Beetham  
560 Larson Way  
North Bend, Oregon 97459

Dear Mr. Beetham,

I have received your letter concerning your water right permit 42745. Under the terms of your permit the following time limits were set-up:

- A) March 10, 1979      Date to begin construction
- B) October 1, 1979      Date to complete construction
- C) October 1, 1980      Date to complete application of water.

Enclosed are forms A, B and C. Please complete the form A with what work was completed prior to March 10, 1979.

From your letter, you have not completed the construction phase at this time. You need to request an extension of the time limit to complete construction. This extension would allow you to complete construction within the terms of the permit.

Enclosed is the form for this purpose. Please go into some detail because an extension can be granted only if due diligence is shown.

Sincerely,

LARRY M. TOLL  
Water Rights Engineer

LMT:kas

Enclosures

TO: WATER Resources Department

Subject: WATER Rights Permit No. 42745

RECEIVED

NOV 13 1979

WATER RESOURCES DEPT  
SALEM, OREGON

Dear: Mr. SLEXSON : Director

C.C. LARRY Toll

We have not completed the complete scope of our proposed project. When trying to build a ranch from scratch and hold down a full time job, it's hard to project a completion date - but I feel I can finish by the summer of 1980 (Oct 80'). I have installed about 600 FT of PVC pipe and a new 1200 GALLON FRP tank for both domestic and irrigation. Also I've started excavation of our 1500-2000 FT<sup>3</sup> lake to collect the water for pump irrigation. Most the materials for the irrigation project are in hand (2000 FT 4" pipe and pump) but developing the pumping stations are taking more time than expected. Also I will have to redue about 3000 FT of 1" PVC domestic water line because of prior owner did not install correctly and it has failed.

I'm working as hard as I can to complete this project and much appreciate your cooperative efforts  
OVER

to date.

Thank You

Dennis Betman

Dennis C. Beetham  
560 Larson Way  
North Bend, OR 97459

March 15, 1978

56311

42745

February 22, 1978

Dennis C. Beetham  
560 Larson Way  
North Bend, Oregon 97459

Dear Mr. Beetham:

We have received your spring description sheet, your application, and accompanying map.

Application numbered 56311 is now satisfactory for the issuance of a permit.

Sincerely,

Larry Toll  
Water Rights Engineer

LT:slk



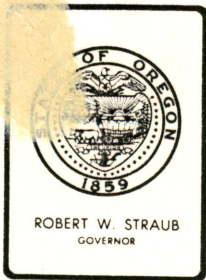

## Water Resources Department

MILL CREEK OFFICE PARK

555 13th STREET N.E., SALEM, OREGON 97310

PHONE 378-3066

56311

February 9, 1978

Dennis C. Beetham  
560 Larson Way  
N. Bend, OR 97459

Dear Mr. Beetham:

Thank you for returning your application numbered 56311 and the map along with the additional fees of \$32.50.

Your application was endorsed so that in order to retain its priority date, it should have been received in this office on or before December 19, 1977. It was received on February 3, 1978, and therefore, February 3, 1978 is your new priority date.

Your application is now for a permit to use:

- a) 204 gallons of water per minute from Larson Slough for the irrigation of 28.5 acres.
- b) 132 gallons of water per minute from unnamed stream #1 (Diversion #2, 3, 4, & 5.) for the irrigation of 20.0 acres.
- c) 35 gallons of water per minute from unnamed stream #2 (Diversion #6) for the irrigation of 6.0 acres.
- d) 5.0 gallons of water per minute from a spring for the domestic use for one family including lawn and garden irrigation.

On your application map, please show the location of your house. This must be in agreement with Item #3 of your application.

Since your diversion #7 is a spring, please complete the enclosed spring description sheet and return it with your application.

Your application map states that the domestic use will include irrigation of a garden. Therefore, please amend Item #5 of your application to read "Domestic including irrigation of lawn and garden not exceeding  $\frac{1}{2}$  acre and agricultural irrigation."

I am returning your map and application for completion. It is endorsed so that in order to retain its priority date, it must be received in this office on or before April 10, 1978.

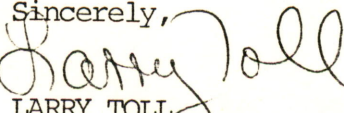
Sincerely,  
  
LARRY TOLL  
Water Rights Engineer

LMT:tld

ENCL: Receipt No. 955

WATER RESOURCES DEPARTMENT  
MILL CREEK OFFICE PARK  
565 13<sup>TH</sup> STREET N.E.  
SALEM, OREGON 97310

RECEIVED

FEB 8 1978

WATER RESOURCES DEPT  
SALEM, OREGON

ATTN: LARRY TOLL

REF: WATER RIGHTS - YOUR #56311

Enclosed is a revised PRINT LOCATING ITEM you  
OUTLINED IN your LETTER OF OCT 18, 1977. I've discussed  
this with MR. Wayne Overcash in order to clarify what I  
was supposed to provide over and above that which was  
already provided. I hope this supplies you with the info.  
in the correct form which you required. Also enclosed  
is a check for \$32.50.

Thank You

Dennis Beetham

Feb. 1, 1978

Mr. Beeham called  
Ph: 756-2110

(upset over our requirements)

he will try to complete his  
appl- and map and return  
it.



January 24, 1978

Dennis C. Beetham  
560 Larson Way  
North Bend, OR. 97459

Dear Mr. Beetham:

Since you have not returned your application numbered 56311 or replied to correspondence regarding it, I assume you have re-considered the matter of your proposed use of water and have decided not to resubmit your application.

If I do not hear from you within thirty days from the date of this letter, your application will be rejected without further notice. The \$20.00 examination fee is required by law to be paid into the General Fund of the State and it is not refundable.

Sincerely,

LARRY TOLL  
Water Rights Engineer

IMT:tld

378-3066

56311

December 20, 1977

Dennis C. Beetham  
560 Larson Way  
North Bend, OR. 97459

Dear Mr. Beetham:

Your application numbered 56311 which was returned to you for completion has not been received. It was endorsed so that in order to retain its priority date, it should have been received in this office on or before December 19, 1977.

It has, therefore, lost its priority, but may be reinstated and given a new priority date as of the date it is again received in this office.

Sincerely,

LARRY TOLL  
Water Rights Engineer

LMT:tld

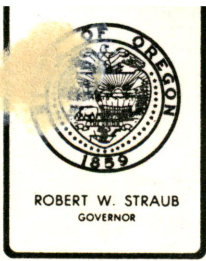

## Water Resources Department

MILL CREEK OFFICE PARK

555 13th STREET N.E., SALEM, OREGON 97310

PHONE 378-3066

56311

October 18, 1977

Dennis C. Beetham  
560 Larson Way  
N. Bend, OR. 97459

Dear Mr. Beetham:

Your application numbered 56311 which is for a permit to appropriate water from Larson slough, unnamed streams and springs for irrigation and domestic use has been examined.

Your application includes irrigation from three different sources of water (Larson slough-Diversion #1, unnamed stream 1-Diversion #2, #3, #4, #5, unnamed stream 2-Diversion # 5). Your map and application must show the area to be irrigated from each source.

Your application map must identify the township and range, location of diversion points by co-ordinates, acreage by quarter-quarter section and location of domestic use. The map must be completed in dark ink.

The required fees for your application include a \$20.00 examination fee, a \$15.00 recording fee for domestic and a \$17.50 recording fee for irrigation. Therefore, an additional fee of \$32.50 is required.

I am returning the map and application for completion. It is endorsed so that in order to retain its priority date, it must be received in this office on or before December 19, 1977.

Sincerely,

LARRY TOLL  
Water Rights Engineer

LMT:TD

56311

12 September 1977

Dennis C. Beetham  
560 Larson Way  
North Bend, Oregon 97459

Dear Mr. Beetham:

We have received your application for domestic & agriculture along with the supporting data and fees. Our receipt number 62841 is enclosed. Your application has been filed and assigned number 56311 .

Because of the many applications which have been filed in recent months, we are temporarily behind in our processing. Your application will be examined in detail as soon as possible. We will contact you if we need any additional information.

The permit approving your application will be issued without further correspondence if no additional information is required. Thank you for your patience.

Sincerely,

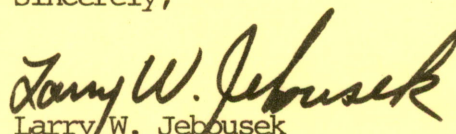

Larry W. Jebousek  
Administrator  
Water Rights Division

LJW: clh

Enclosure: Receipt No. 62841

Sur  
7/29/77

R  
Application No. 56311  
Permit No. 42745

Name Dennis C. Beetham  
Address 560 Larson Way N. Bend, OR. 97459

Assigned  
Address

Beginning construction MAR 10 1979

Completion of construction OCT 1 1979

Extended to

Complete application of water OCT 1 1980

Extended to



Application No. 56311

DESCRIPTION OF SPRING

1. Is spring on property of applicant? Yes
2. If not, give name and address of legal owner. \_\_\_\_\_  
\_\_\_\_\_
3. Have you secured consent of owner to appropriate water from this spring and for construction of pipeline or other works? \_\_\_\_\_
4. If you do not have such consent, do you expect to secure right of way through condemnation? \_\_\_\_\_
5. What is the maximum flow from spring? 3 GPM  
(Gallons per minute or  
cubic feet per second)

What is the minimum flow? 2 GPM

Is flow measured or estimated? ESTIMATED

6. Does the stream flowing from spring form a well defined natural channel? Yes
7. Does the water flow off the lands on which it first arises? ~~No~~ yes
8. Give the name of the stream or other body of water into which water from the spring flows. LARSON SLOUGH
9. If the water from the spring sinks or evaporates before reaching other water, give distance water flows from spring before vanishing.  
\_\_\_\_\_

10. Remarks Currently I have tapped spring directly. Then

flows thru 1" PLASTIC LINE TO 1000 GAL Fiberglass tank, then

to house via 2,000 FT OF PIPE. OVER FLOW GOES TO STREAM SHOWN

to (C), then to LARSON SLOUGH

*Don C. Patton*  
Signature of Applicant

**RECEIVED**

FEB 17 1978

WATER RESOURCES DEPT.  
SALEM, OREGON

Until a change is requested, all tax statements shall be sent to the following address: 100 Marine Way  
North Bend, Oregon 97459

DEED OF PERSONAL REPRESENTATIVE

CAMERON C. THOM, the duly appointed, qualified and acting Personal Representative of the Estate of Sophia Weir, deceased, conveys to DENNIS C. BEETHAM and SUE A. BEETHAM, husband and wife, as tenants by the entirety, the heirs of the survivor and their assigns, all of the interest of said estate in that real property situated in Coos County, Oregon, described as follows, to-wit:

The S 1/2 of the SW 1/4 of Section 20, Township 24 South, Range 12 West of the Willamette Meridian, Coos County, Oregon; EXCEPT: Beginning at a point on the Section line common to Sections 19 and 20, Township 24 South, Range 12 West of the Willamette Meridian, Coos County, Oregon, said point being North 3° 42' East 925.51 feet of the Section corner common to Sections 19, 20, 29 and 30, said Township and Range; thence South 86° 18' East, at right angles to the Section line, 350.00 feet; thence North 3° 42' East parallel with the Section line, 445.00 feet, more or less, to the North line of the SW 1/4 of the SW 1/4 of Section 20, said Township and Range; thence Westerly along this line 350.00 feet, more or less, to the South 1/16th corner common to Sections 19 and 20, said Township and Range; thence South 3° 42' West 445.00 feet along the Section line to the point of beginning.

The NW 1/4 of Section 29, Township 24 South, Range 12 West of the Willamette Meridian, Coos County, Oregon, and Lots 8 and 9 of Section 30, Township 24 South, Range 12 West of the Willamette Meridian, Coos County, Oregon; EXCEPT: That portion of Lot 8 lying West of Larson Creek Road.

ALSO: Begin on left bank of Larson Slough at quarter section line running East and West through Section 30, Township 24 South, Range 12 West of the Willamette Meridian, Coos County, Oregon, running thence East along quarter section line 980 feet; thence South 376 feet; thence West 980 feet parallel with the quarter Section line to left bank of Slough; thence North 376 feet to the beginning.

EXCEPT any portion that may be embraced in the following described property: Beginning at an iron pipe in Lot 6 of Section 30, Township 24 South, Range 12 West of the Willamette Meridian, Coos County, Oregon, from which point the iron pipe at the Northeast corner of the said Section 30 bears North 33° 06' East a distance of 2944.2 feet; and running thence South 79° 32' East for a distance of 99.14 feet to an iron pipe; thence continuing South 79° 32' East for a distance of 13 feet to a point

**Application No. 56311**  
**Permit No.**

on the approximate high water line of Larson Slough; thence South 5° 12' West along the said high water line for a distance of 225.08 feet; thence South 15° 06' West along the said high water line for a distance of 150.70 feet; thence South 20° 26' West along the said high water line for a distance of 152.50 feet; thence North 64° 13' West for a distance of 10 feet to an iron pipe; thence continuing North 64° 13' West for a distance of 246.60 feet to an iron pipe; thence North 29° East for a distance of 481.77 feet to the point of beginning.

ALSO EXCEPT that portion of the Southwest quarter of the Southwest quarter in Section 20, Township 24 South, Range 12 West of the Willamette Meridian, Coos County, Oregon purchased by Mr. Doyle Williams, and containing approximately 36 acres, more or less.

SUBJECT TO:

(1) The assessment roll and the tax roll disclose that the within described premises were specially assessed as Forestland. If the land has become or becomes disqualified for the special assessment under the statute, an additional tax may be levied for the period for which the land was subject to the special assessment.

(2) The rights of the public in and to that portion of the above property lying within the limits of roads and streets.

(3) The right of the public and of governmental bodies in and to any portion of the above property lying below high water mark of Larson Slough, and in and to said water.

(4) These presmies are within the boundaries of the Larson Slough Drainage District, and are subject to the levies, assessments and easements thereof, if any.

(5) Easement conveyed to United States of America in that certain instrument recorded in Book 270, Page 43, Deed Records of Coos County, Oregon.

(6) Easement, conveyed to West Coast Power Company in that certain instrument recorded in Book 136, Page 13, Deed Records of Coos County, Oregon.

(7) Transmission line Easement, conveyed to United States of America by instrument recorded in Book 196, Page 474, Deed Records of Coos County, Oregon.

(8) Access Road Easement, conveyed to United States of America, by instrument recorded in Book 213, Page 576, Deed Records of Coos County, Oregon.

(9) Easement, conveyed to Larson Slough Drainage District by instrument recorded in Book 286, Page 404, Deed Records of Coos County, Oregon.

**Application No.** 56311  
**Permit No.**