

T. 7 S., R. 45 E., W. M.

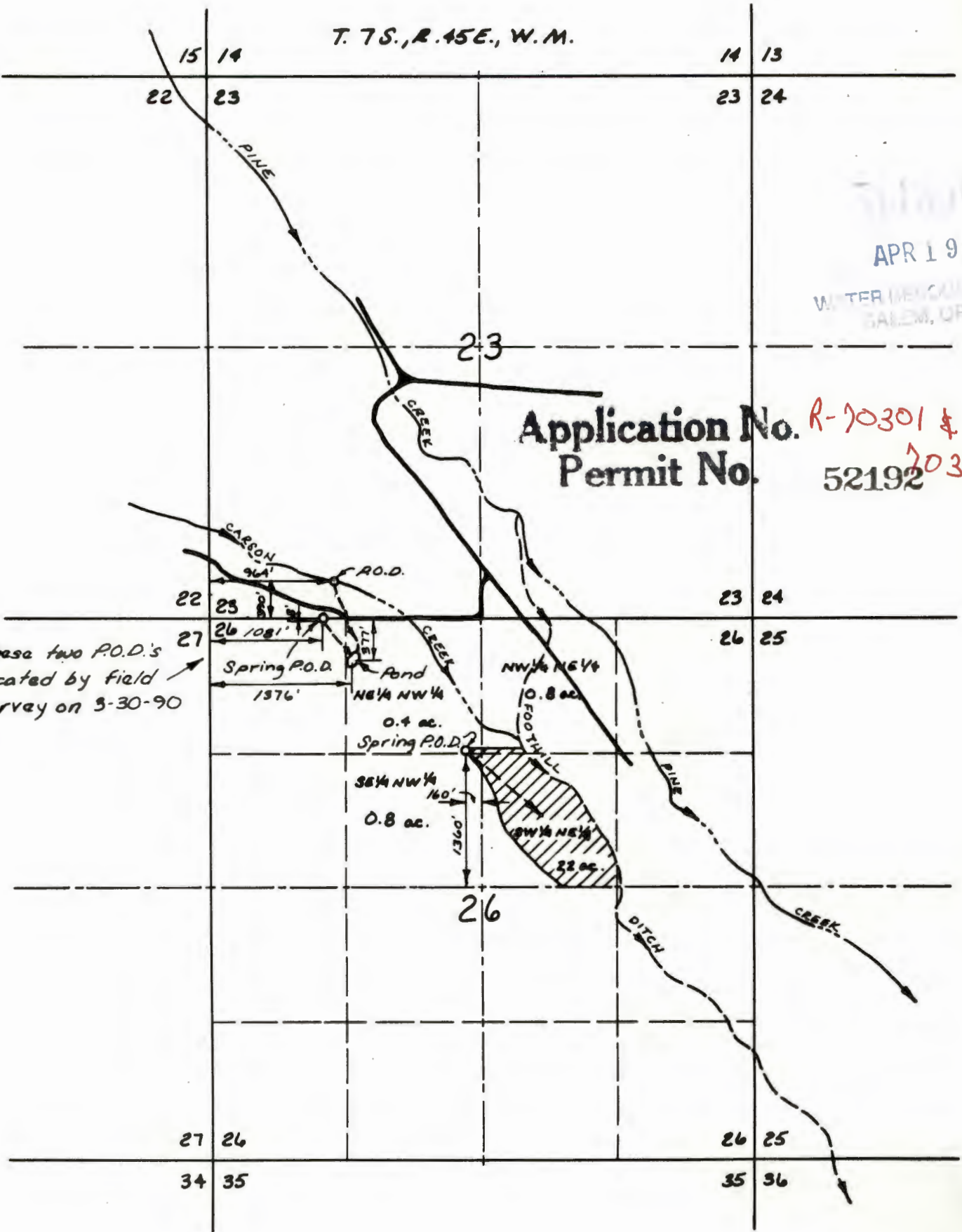

These two P.O.D.'s located by field survey on 3-30-90

Application No. R-70301 & 70302  
Permit No. 52192

APR 19 1990  
WATER RESOURCES DEPT  
SALEM, OREGON

MAP TO ACCOMPANY  
APPLICATION FOR A PERMIT