



Suite 2400  
1300 SW Fifth Avenue  
Portland, OR 97201-5610

Merissa A. Moeller  
503-778-5358 tel  
503-276-5758 fax

merissamoeller@dwt.com

October 24, 2017

Kelly Starnes  
Transfer and Conservation Section  
Oregon Water Resources Department  
725 Summer Street NE, Suite A  
Salem, OR 97301

Re: Notification of Specific-to-General Industrial Water Use Change  
for Certificate 48886

Dear Mr. Starnes;

Collins Timber Company, LLC (Collins) is the holder of Certificate 48886, which authorizes the use of up to 0.45 cfs of water from the Klamath River for "log deck sprinkling." A copy of Certificate 48886 is enclosed.

On behalf of Collins, I am requesting that the Oregon Water Resources Department (OWRD) accept this notification of a change from specific industrial use to general industrial use under certificate 48886, as provided under ORS 540.520(9) and OAR 690-380-2340. Based on this notification, Collins intends to use up to 0.45 cfs for general industrial purposes within the current facility owned by Collins Timber Company. Please find below the information required by this statute and rule.

a) *Name and address of the person (entity) using water under the water right:*

Collins Timber Company, LLC  
6410 Highway 66  
Klamath Falls, OR 97601

b) *The certificate number:* Certificate 48886

RECEIVED

OCT 27 2017

OWRD

4845-8139-9378v.1 0051858-000005

Anchorage  
Bellevue  
Los Angeles

New York  
Portland  
San Francisco

Seattle  
Shanghai  
Washington, D.C.

www.dwt.com

Kelly Starnes  
Oregon Water Resources Department  
October 24, 2017  
Page 2

*c) A description of the location of the industrial facility owned by the holder of the original water right at the time the water right permit was issued:*

Weyerhaeuser Company was the holder of the original permit (Permit S-41423) at the time it was issued (April 4, 1977). At that time, Weyerhaeuser owned the property that is located in tax lot 4300, Sections 13 and 24, Township 39 South, Range 8 East, and tax lot 1000, Section 18, Township 39 South, Range 9 East. (See enclosed map.) Weyerhaeuser sold its interest in the property to Collins Products LLC, now Collins Timber Company LLC, on August 31, 1996. Collins has continued to own and operate the mill facilities in the same location.

*d) The quantity of water diverted to satisfy the authorized specific use under the original water right:*

The quantity of water diverted to satisfy the authorized specific use under Certificate 48887 (log deck sprinkling) was 0.45 cfs.

*e) A description of the general industrial use to be made of the water after the change:*

Collins will use water for general industrial purposes at the mill facilities located within tax lot 4300, Sections 13 and 24, Township 39 South, Range 8 East and tax lot 1000, Section 18, Township 39 South, Range 9 East. The intended general industrial uses may include, but are not limited to construction, operation and maintenance of the industrial site, charging the fire suppression system, and product processing. The quantity of water to be used for the general industrial use under water right certificate 48886 will not exceed 0.45 cfs.

If you have any questions about this specific to general water use change, please contact me at 503-778-5358 or Adam Sussman at GSI Water Solutions, Inc. at 541-257-9001.

Very truly yours,

Davis Wright Tremaine LLP



Merissa A. Moeller

Enc.

4845-8139-9378v.1 0051858-000005

RECEIVED

OCT 27 2017

OWRD

STATE OF OREGON

COUNTY OF KLAMATH

CERTIFICATE OF WATER RIGHT

This Is to Certify, That WEYERHAEUSER COMPANY

of P. O. Box 9, Klamath Falls, State of Oregon, 97601, has made proof to the satisfaction of the Water Resources Director, of a right to the use of the waters of Klamath River

a tributary of Pacific Ocean for the purpose of log deck sprinkling

under Permit No. 41423 and that said right to the use of said waters has been perfected in accordance with the laws of Oregon; that the priority of the right hereby confirmed dates from February 17, 1977 that the amount of water to which such right is entitled and hereby confirmed, for the purposes aforesaid, is limited to an amount actually beneficially used for said purposes, and shall not exceed 0.45 cubic foot per second

or its equivalent in case of rotation, measured at the point of diversion from the stream. The point of diversion is located in the Lot 6 (SW 1/4 SW 1/4), Section 18, T. 39 S., R. 9 E., W.M., 40 feet North and 220 feet East from the SW Corner, Section 18

The amount of water used for irrigation, together with the amount secured under any other right existing for the same lands, shall be limited to ----- of one cubic foot per second per acre,

and shall conform to such reasonable rotation system as may be ordered by the proper state officer.

A description of the place of use under the right hereby confirmed, and to which such right is appurtenant, is as follows:

Lot 1 (SE 1/4 SE 1/4) Section 13 T. 39 S., R. 8 E., W. M.

RECEIVED

OCT 27 2017

OWRD

The right to the use of the water for the purposes aforesaid is restricted to the lands or place of use herein described and is subject to the existing minimum flow policies established by the Water Policy Review Board.

WITNESS the signature of the Water Resources Director, affixed

this date. January 21, 1980

James E. Peterson Water Resources Director

41423  
48886

# T.39S. R.8&9E., W.M.

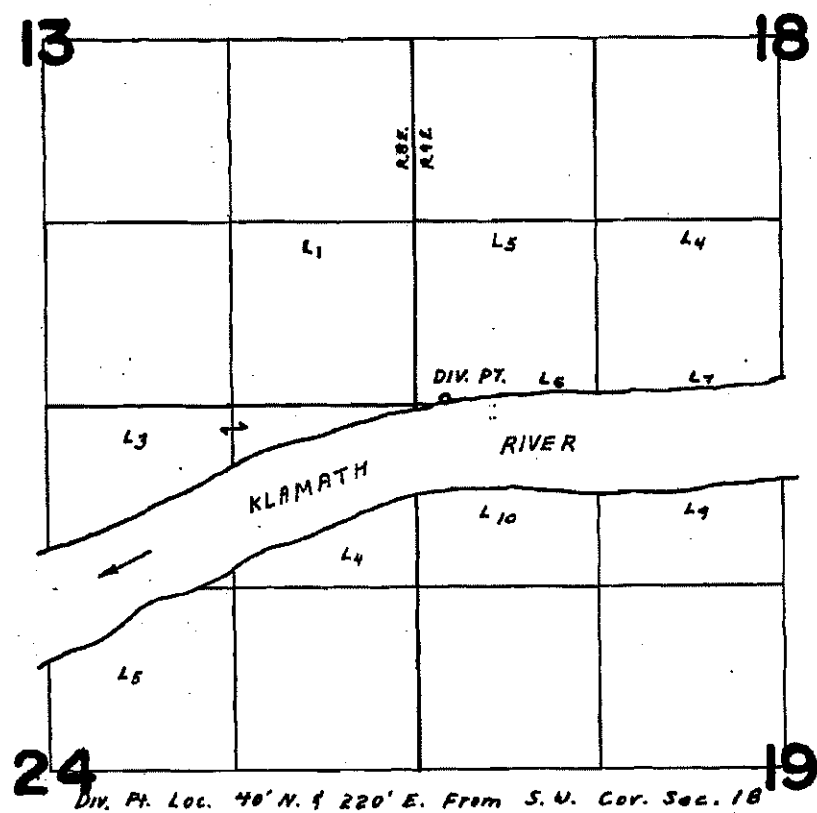

Klamath River

## FINAL PROOF SURVEY UNDER

Application No. 55267 55912 Permit No. 41423 42358  
IN NAME OF

WEYERHAEUSER CO.

Surveyed JUL 27 1978, by S. P. APPLIGATE

RECEIVED

OCT 27 2017

OWRD

