

Oregon Water Resources Department

Municipal Reclaimed Water Registration Form

A water use permit may not be required if the water being used is reclaimed water as defined in ORS 537.131 **and** the reclaimed water use is both authorized by the Oregon Department of Environmental Quality (DEQ) **and registered** with Oregon Water Resources Department (WRD)(ORS 537.132). Currently there is no fee for registering.

Complete and send this Registration Form **to the DEQ permit writer** managing the wastewater treatment facility discharge permit. DEQ will review and sign this Registration Form prior to sending it on to WRD in Salem. A response letter will be sent by WRD to all parties within 60 days of receipt.

Instructions are available to guide you. If you need assistance, please call 503-986-0900 and ask for the "Water Reuse Coordinator" or contact the local watermaster in your county. Insert "N/A" if the requested information does not apply to your situation.

1. Name of "Registrant". Who will use the reclaimed water?

Name of Reclaimed Water User: City of Prairie City

County where reclaimed water use will occur: Grant

Mail Address: PO Box 870 Prairie City OR 97869
Street/P.O. Box City State Zip

Daytime Telephone: (541) 820-3636 E-mail: pworks@ortelco.net

2. Does the reclaimed water user own the land where the use will occur?

YES NO If no, provide the landowner's name and contact information.

Landowner Name: _____

Mail Address: _____
Street/P.O. Box City State Zip

Daytime Telephone: _____ E-mail: _____

3. Are there existing water rights on the same land where the use will occur?

YES (provide information below) NO

Application No. _____ Permit No. _____

Certificate No. _____ Decree vol. & pg. _____

Will the reclaimed water be used **instead of** existing water rights OR used to **supplement** the continued use of the existing water rights? No

4. Has DEQ issued a Municipal Wastewater Treatment Facility Discharge Permit authorizing the use of reclaimed water? (If yes, provide permit number)

YES NPDES Permit No. _____ or WPCF Permit No. 101930

Permit Effective Date: July 30, 2020 Permit Expiration Date: July 30, 2030

DEQ Region: (Check one) Northwest Region Eastern Region Western Region

NO Permit application was submitted to DEQ, but not yet issued.

NO Permit application has not been submitted to DEQ.

5. Who is treating and supplying the reclaimed water to the user?

Name of Supplier: City of Prairie City Telephone No. (541) 820-3636

Treatment Facility Name: The Prairie City Lagoons Telephone No. (541) 820-3636

Mail Address: PO Box 870 Prairie City OR 97869
Street/P.O. Box City State Zip

6. Which water provider supplies potable municipal water to the city/community that produces the sewage entering the treatment facility?

Municipal Water Provider: City of Prairie City Telephone No. (541) 820-3636

Source(s) of Municipal Water: Infiltration Galleries and Groundwater Wells
(stream name, groundwater, and/or reservoir name)

7. Will the use of reclaimed water occur inside or outside the water service boundaries of the potable municipal water provider identified above in Question 6?

INSIDE OUTSIDE

8. What is the length in years of the agreement/contract between the reclaimed water user and the reclaimed water supplier? 100

Describe any conditions in the agreement that limit use of the reclaimed water.

9. Please describe the transmission system that delivers reclaimed water from the wastewater treatment facility to the place of reclaimed water use.

Wastewater flows by gravity from the Lagoons to the irrigation pump house, and then is pumped to the Center Pivots.

(Include type of construction of diversion works/pump capacity, length and dimensions of supply ditches/ pipelines)

10. What is the Intended Use(s) of Reclaimed Water?

Pasture/spring Grazing

(irrigation, aquifer recharge, wetlands, industrial, cooling, aquifer storage & recovery, etc.)

Irrigation Total Acres: 51 What type of crop? grasses/legumes
(hay, pasture, golf course, wood fiber, etc.)

What is the irrigation application system? center pivots (identified as 'A' & 'B')
(flood, center pivot, wheel line, drip, micro-sprinklers)

How much Reclaimed Water will be used? 250 gpm
(cubic feet per second, OR gallons per minute)

Date use began or will begin: April Period of use (month/day): from 4/15 to 10/15

11. What are the water user's motivations to use reclaimed water?

- My existing water rights are "junior" and not always reliable.
- Another water source is available, but reclaimed water is less expensive.
- Reclaimed water is the only source available and enables the use listed in Question 10.
- Reclaimed water allows a WRD transfer of existing water rights to a different location.
- Reclaimed water use reduces demand on the local municipal water supply.
- To assist the treatment facility in meeting DEQ regulatory permit requirements.
- To recharge the aquifer or store water in the aquifer for future recovery.
- Other (describe): _____

12. Describe the historic reclaimed water disposal method.

A) Into which stream was the reclaimed water discharged? none

B) Has the reclaimed water been discharged into the stream for 5 or more years?

YES NO

C) Where did the treated wastewater historically enter the stream?

n/a
(Township, Range and Section, or distance from landmark, or river mile, or Lat/Long)

D) Does the amount (rate in gpm or cfs) of reclaimed water proposed for use under this registration represent more than 50% of the total average annual flow of the stream?

YES NO UNKNOWN

Source of information used to answer this? never discharged into stream for this facility

13. Is the required map attached showing the reclaimed water transmission system and place of use? YES NO (If No, please prepare and attach map).

The Registration Form is not complete without an adequate map.
See map requirement explanation on page 4.

14. MAP REQUIREMENTS:

This registration must be accompanied by a map, or maps, to show the location of the wastewater treatment facility, location of reclaimed water transmission system (pipelines, canals, etc.) and the place of reclaimed water use. Features of the map(s) should include the following:

- A north arrow.
- Drawn to scale at not less than 4" = 1 mile, with the scale identified.
- Township, Range, Section, Quarter-Quarters, and tax lot number(s).
- Place of use shown by Quarter-Quarter section with shading or diagonal lines.
- Acres, if land application, per Quarter-Quarter section (approximate if not certain).
- Location of main canals or pipelines to and within the reclaimed water use area.
- Streams and roads identified if they cross through the map.
- Other obvious features that would help someone in the field locate the place of use.
- A legend.

**A map showing the wastewater treatment facility, transmission system, and place of use at a scale of 4" = >1 mile is fine only if a second map is provided showing the place of use at not less than 4" = 1 mile.*

15. ADDITIONAL COMMENTS: Provide additional information here or attach additional pages.

16. Signatures of Registrant and Reclaimed Water Supplier:

I/We certify that the information provided in this Registration Form is an accurate representation of the proposed reclaimed water use to the best of my knowledge:

Registrant Printed Name: CHARL CARANEA Title: DIRECTOR OF PUBLIC WORKS

Registrant Signature: [Signature] Date: 10/27/22

Supplier Printed Name: CHARL CARANEA Title: DIRECTOR OF PUBLIC WORKS

Supplier Signature: [Signature] Date: 10/27/22

NOTE: Once completed and signed, keep a copy and send this form to the DEQ permit writer responsible for the wastewater treatment facility permit. DEQ will sign and forward the form to WRD in Salem. A response letter will be sent by WRD to all parties within 60 days.

This section is to be completed by DEQ

17. Signature of DEQ Water Quality Manager:

Date registration form received at DEQ: 10/28/2022

Pursuant to ORS 537.132 DEQ has:

- a) Authorized the use of reclaimed water (referred to by DEQ regulations as "recycled water") as evidenced by the NPDES or WPCF permit issued and described below.

Permit Number: 101930 DEQ File Number: 71909

Printed DEQ Permit Writer's Name: Justin Starger

Mail Address: 475 NE Bellevue Dr Bend OR 97701
Street/P.O. Box City State Zip

Telephone: 541-633-2016 E-mail: justin.starger@deq.oregon.gov

- b) Consulted with State Department of Fish and Wildlife and determined this use of reclaimed water shall not have a significant negative impact on fish or wildlife.

ODFW contact name: Brent Smith

ODFW contact phone number: 541-575-1167

- c) Determined the use of reclaimed water is intended to improve the water quality of the receiving stream. N/A

The reclaimed water is (e.g. too warm for salmonids): _____

I certify the provisions of ORS 537.132(1)(a)(b) and (c) for this application are satisfied.

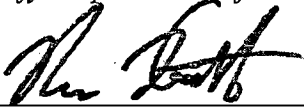

Date 11/28/2022

DEQ Water Quality Manager Signature

Mike Hiatt

DEQ Water Quality Manager's printed name

Once signed by DEQ, this completed form is to be sent to:

Oregon Water Resources Department
C/O Water Reuse Coordinator
725 Summer St. NE, Suite A
Salem, OR 97301-1266

**Oregon Department of Environmental Quality
RECYCLED WATER USE PLAN SUMMARY**



Directions: Check (✓) appropriate boxes for tables and provide brief narrative where necessary. Submit with Recycled Water Use Plan to DEQ.

APPLICANT INFORMATION

Facility Name: Prairie City Lagoons
Address: The site does not have an physical address, site access road is at MP 172.2 on Highway 26, 3 miles west of Prairie City. The mailing address is PO Box 870, Prairie City, OR 97869
Contact Name/Phone Number: Chris Camarena, 541-820-3636 or 541-620-3100

TYPE OF WASTEWATER TREATMENT PLANT

<input type="checkbox"/> Activated Sludge	<input type="checkbox"/> Re-circulating Gravel/Sand Filter
<input type="checkbox"/> Mechanically Aerated Lagoon	<input type="checkbox"/> Rotating Biological Filter
<input type="checkbox"/> Aerated Lagoon	<input checked="" type="checkbox"/> Other (Specify): Anaerobic & Aerobic

Average Dry Weather Flow, million gallons per day (MGD): 0.23 MGD

TREATMENT CLASS IN ACCORDANCE WITH OAR 340-055-0012

<input type="checkbox"/> Class A	<input type="checkbox"/> Class C
<input type="checkbox"/> Class B	<input type="checkbox"/> Class D
<input checked="" type="checkbox"/> Non-Disinfected water	

TREATMENT EFFICIENCY CAPABILITY DURING REUSE

<input type="checkbox"/> Tertiary Treatment	<input type="checkbox"/> 85% or more BOD/TSS removal
<input type="checkbox"/> 95% or more BOD/TSS removal	<input type="checkbox"/> Rotating Biological Filter
<input checked="" type="checkbox"/> 90% or more BOD/TSS removal	<input type="checkbox"/> Other (Specify):

DISINFECTION METHOD

<input type="checkbox"/> Chlorine injection just prior to irrigation
<input type="checkbox"/> Chlorine injection with storage of recycled water
<input type="checkbox"/> Chlorine injection after storage just prior to irrigation
<input type="checkbox"/> UV exposure just prior to irrigation
<input type="checkbox"/> UV exposure with storage of recycled water
<input type="checkbox"/> UV exposure after storage just prior to irrigation
<input checked="" type="checkbox"/> Other (specify): None

STORAGE IMPOUNDMENT

	Y	N
Is there a storage facility proposed for this project?	<input checked="" type="checkbox"/>	<input type="checkbox"/>
If yes, at the WWTP	<input checked="" type="checkbox"/>	<input type="checkbox"/>
If yes, located at a location other than the WWTP	<input type="checkbox"/>	<input type="checkbox"/>
If yes to either of the above, specify the location and length of time the storage facility will be used: City of Prairie City Lagoon Site, Wastewater is stored approximately 6 months average.		

Recycled Water Use Plan Summary

ARE THERE ALARMS FOR VARIOUS UNIT PROCESSES?

	Y	N
Are alarms independent of the normal power supply of the plant?	<input type="checkbox"/>	<input checked="" type="checkbox"/>
Failure of a disinfection treatment process?	<input type="checkbox"/>	<input checked="" type="checkbox"/>
Failure of a clarification process?	<input type="checkbox"/>	<input checked="" type="checkbox"/>
Failure of a coagulation process?	<input type="checkbox"/>	<input checked="" type="checkbox"/>
Failure of a filtration process?	<input type="checkbox"/>	<input checked="" type="checkbox"/>
Are the alarms on separate circuit breakers from the reuse pumps?	<input type="checkbox"/>	<input checked="" type="checkbox"/>
Is the Recycled Water back-up generator tested regularly?	<input type="checkbox"/>	<input checked="" type="checkbox"/>

IN THE EVENT OF POWER LOSS:

	Y	N
Can the plant continue to discharge?	<input type="checkbox"/>	<input checked="" type="checkbox"/>
Can there be any irrigation of non-disinfected water?	<input type="checkbox"/>	<input checked="" type="checkbox"/>
If no to either of the above, specify control measures that will be in place to stop the irrigation as soon as possible.		
<p>The City's System has backup power for the booster stations moving wastewater to the lagoons. There is no backup power source that allows the operator to irrigate when there is a power outage. If irrigation is needed during an extended power outage a portable unit must be moved to the site.</p>		

RECYCLED WATER WILL BE BENEFICIALLY USED FOR THE FOLLOWING (CHECK ALL THAT APPLY):

✓	Beneficial Purpose	Class				
		A	B	C	D	ND
	Irrigation					
<input checked="" type="checkbox"/>	Fodder, fiber, seed crops not intended for human ingestion, commercial timber	Y	Y	Y	Y	Y
<input type="checkbox"/>	Firewood, ornamental nursery stock, Christmas trees	Y	Y	Y	Y	N
<input type="checkbox"/>	Sod	Y	Y	Y	Y	N
<input type="checkbox"/>	Pasture for animals	Y	Y	Y	Y	N
<input type="checkbox"/>	Processed food crops	Y	Y	Y	N	N
<input type="checkbox"/>	Orchards or vineyards if an irrigation method is used to apply recycled water directly to the soil	Y	Y	Y	N	N
<input type="checkbox"/>	Golf courses, cemeteries, highway medians, industrial or business campuses	Y	Y	Y	N	N
<input type="checkbox"/>	Any agricultural or horticultural use	Y	N	N	N	N
<input type="checkbox"/>	Parks, playgrounds, school yards, residential landscapes, other landscapes accessible to the public	Y	N	N	N	N
	Industrial, Commercial, or Construction					
<input type="checkbox"/>	Industrial cooling	Y	Y	Y	N	N
<input type="checkbox"/>	Rock crushing, aggregate washing, mixing concrete	Y	Y	Y	N	N
<input type="checkbox"/>	Dust control	Y	Y	Y	N	N
<input type="checkbox"/>	Nonstructural fire fighting using aircraft	Y	Y	Y	N	N
<input type="checkbox"/>	Street sweeping or sanitary sewer flushing	Y	Y	Y	N	N
<input type="checkbox"/>	Stand alone fire suppression systems in commercial and residential buildings	Y	Y	N	N	N
<input type="checkbox"/>	Non-residential toilet or urinal flushing, floor drain trap priming	Y	Y	N	N	N
<input type="checkbox"/>	Commercial car washing	Y	N	N	N	N
<input type="checkbox"/>	Fountains when the water is not intended for human consumption	Y	N	N	N	N

Recycled Water Use Plan Summary

✓	Beneficial Purpose	Class				
		A	B	C	D	ND
<input type="checkbox"/>	Impoundments or Artificial Groundwater Recharge					
<input type="checkbox"/>	Water supply for landscape impoundments including, but not limited to, golf course water ponds and non-residential landscape ponds	Y	Y	Y	N	N
<input type="checkbox"/>	Restricted recreational impoundments	Y	Y	N	N	N
<input type="checkbox"/>	Nonrestricted recreational impoundments including, but not limited to, recreational lakes, water features accessible to the public, and public fishing ponds	Y	N	N	N	N
<input type="checkbox"/>	Artificial groundwater recharge	Y	N	N	N	N
<input type="checkbox"/>	Other (describe):					

Recycled Water Use Plan Summary

PAGES 4 & 5 REQUIRED FOR IRRIGATION ONLY

THE IRRIGATION AREA WILL BE USED FOR THE FOLLOWING (CHECK ALL THAT APPLY):

<input type="checkbox"/>	Crops (specify types):
<input type="checkbox"/>	Pasture
<input type="checkbox"/>	Forest
<input type="checkbox"/>	Public access areas (specify types):
<input checked="" type="checkbox"/>	Natural areas (specify species or mix): Tall Fescue, Orchard Grass, Reed Canary, Triticale, Clover, & Brassicas
<input checked="" type="checkbox"/>	Other (specify): fodder (listed above)

APPLICATION RATE

	Y	N
Will irrigation be controlled not to exceed the water consumption rate of the crop being grown?	<input checked="" type="checkbox"/>	<input type="checkbox"/>
Will irrigation be controlled not to exceed the nutrient requirements of the crop being grown?	<input checked="" type="checkbox"/>	<input type="checkbox"/>

What is the proposed application rate of the recycled water? 0.27 in/day

Acreage of irrigation site 51 acres

The months that irrigation will be permitted April - October

If irrigation occurs with Class C recycled water at nighttime, will the public access be restricted to allow for sunlight contact on irrigated water? Yes No

If so, specify length of time _____

TRANSMISSION & DISTRIBUTION LINES/PIPES

	Y	N
At the end of the irrigation day, will the transport lines/pipes be drained back to the wastewater treatment facility?	<input type="checkbox"/>	<input checked="" type="checkbox"/>
Is there a gate/ball shut off valve at the irrigation pump?	<input checked="" type="checkbox"/>	<input type="checkbox"/>
Is there an in line pressure relief valve to by-pass reuse water back into the source basin if there is a line transmission plug?	<input type="checkbox"/>	<input checked="" type="checkbox"/>
At the cessation of the irrigation season, will the transport lines/pipes be flushed and cleaned?	<input checked="" type="checkbox"/>	<input type="checkbox"/>
Is there a gate/ball shut off valve at the irrigation field, or at each irrigation zone?	<input checked="" type="checkbox"/>	<input type="checkbox"/>

ZONED LAND USE OF IRRIGATION SITE (CHECK ALL THAT APPLY)

<input checked="" type="checkbox"/>	Exclusive Farm Use (EFU)	<input type="checkbox"/>	Industrial
<input type="checkbox"/>	Forestry	<input type="checkbox"/>	State/Federal lands
<input type="checkbox"/>	Rural Residential	<input type="checkbox"/>	Other (Specify):

ZONED LAND USE OF AREA AROUND IRRIGATION SITE (CHECK ALL THAT APPLY)

<input checked="" type="checkbox"/>	Exclusive Farm Use (EFU)	<input type="checkbox"/>	Industrial
<input type="checkbox"/>	Forestry	<input type="checkbox"/>	State/Federal lands
<input type="checkbox"/>	Rural Residential	<input type="checkbox"/>	Other (Specify):

Prevailing wind direction during irrigation season (specify): West

Will irrigation be restricted when winds exceed 10 MPH?: Yes

THE NEAREST DEVELOPED PROPERTY FROM IRRIGATION SITE (ft):

North boundary: none (no development north of the site - range land and USFS)
South boundary: 3600 ft (+/-) to highway 26
East boundary: 13000 ft (+/-) to residents in Prairie City
West boundary: 500 ft (+/-) to County Rd. / Keeney Forks Rd.
What is the nearest developed property downwind of irrigation site (specify type and distance): 13000 ft (+/-) Residential/City limits of Prairie City
Are there any playgrounds, schools, or public parks within 1/2 mile of irrigation site? (specify): No

Recycled Water Use Plan Summary

DOMESTIC WELLS

	Y	N
Are there any domestic wells or other domestic water sources located within the irrigation site?	<input type="checkbox"/>	<input checked="" type="checkbox"/>
Are there any domestic wells or other domestic water sources located within 150', 100, or 50' of the irrigation site?	<input type="checkbox"/>	<input checked="" type="checkbox"/>
<i>If yes to either of the above, identify the number of wells or sources and identify their location on the attached site plan.</i>		

POTENTIAL RUN-OFF POINTS ARE LOCATED AT THE (CHECK ALL THAT APPLY):

<input type="checkbox"/>	North boundary (specify):
<input checked="" type="checkbox"/>	South boundary (specify): Natural Drainage Swale through the site drains south
<input type="checkbox"/>	East boundary (specify):
<input checked="" type="checkbox"/>	West boundary (specify): Small portion Pivot A area slopes to the West / Cut off ditch is installed to divert to lagoons

PUBLIC ACCESS WILL BE CONTROLLED BY THE FOLLOWING (CHECK ALL THAT APPLY):

<input checked="" type="checkbox"/>	No trespassing or warning signs (specify spacing): 150 ft avg.
<input checked="" type="checkbox"/>	Fencing (specify type): Barbed
<input type="checkbox"/>	Other (specify):

BARRIERS ON BOUNDARIES THAT MAY MITIGATE AEROSOL DRIFT (CHECK ALL THAT APPLY)

<input type="checkbox"/>	Natural vegetation (specify height and width):
<input type="checkbox"/>	Natural topography (specify):
<input type="checkbox"/>	Tree or fence row (specify height):
<input type="checkbox"/>	Other (specify):
<input checked="" type="checkbox"/>	None:

IRRIGATION METHOD (CHECK ALL THAT APPLY)

<input type="checkbox"/>	Set sprinkler heads with spray height of _____ and spray diameter of _____
<input type="checkbox"/>	Wheel irrigation line with spray height of _____ and spray diameter of _____
<input type="checkbox"/>	Big gun irrigation with spray height of _____ and spray diameter of _____
<input checked="" type="checkbox"/>	Other (specify): Center Pivot

IRRIGATION EQUIPMENT SPECIFICATIONS (insert more rows as needed)

Sprinkler head types (brand and model)	Irrigation zones/cells	PSI operating ranges
Nelson Trashbuster	Pivot A	25
Nelson Trashbuster	Pivot B	25

Recycled Water Use Plan Summary

REQUIRED ATTACHEMENTS:

1. Overhead scale diagram/plan view of the wastewater treatment plant that identifies the treatment and disinfection components of the plant.
2. Overhead scale diagram/plan view of the transport line from wastewater treatment plant to the reuse area.
3. Overhead scale diagram/plan of the irrigation site showing surrounding properties and irrigation system layout.
4. A full copy of the Recycled Water Use Plan.

HEALTH DIVISION REVIEW COMMENTS:

Print Form

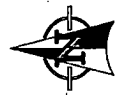
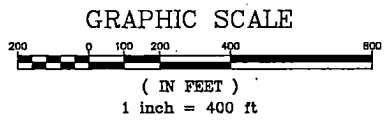
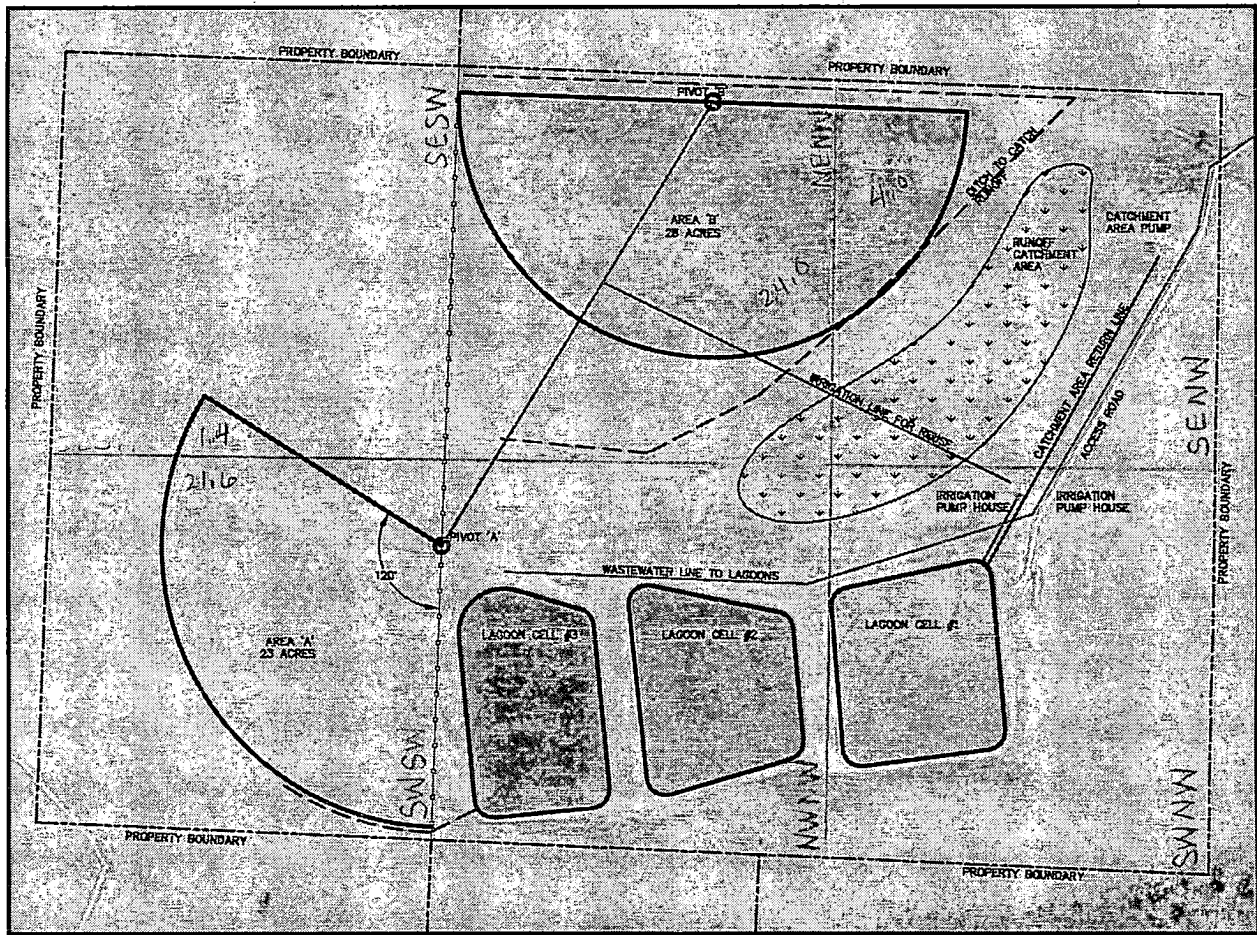

SISUL ENGINEERING 153 E MAIN STREET JOHN DAY, OREGON 97848 (541) 876-3777	DATE	OCT 2020
	SCALE	NOTED
	DRAWN	GR
	JOB	XX-1000
LAGOON SITE		
DRAWING:		

T-13 South R-33 East WM Section 8

Draft RECLAIMED WATER REGISTRATION CHECKLIST

RM (assigned by Kerri): 237 County: Grant Registrant (User of Water): City of Prairie City

Place of Use: see back ->

Twp	Rng	Mer	Sec	Q-Q	Glot	Acres	Location Description	Contract Years in Length
		WM						2020-2030
		WM						10 years

Amount: 250 gpm Use: irrigation # of Acres (if for IR): 51 WM Dist #: 4 4/15-10/15

Supplier of the Reclaimed Water: City of Prairie City DEQ Muni WW Permit #: WPEF-101930

Source of Reclaimed Water (Wastewater treatment plant): Prairie City lagoons

Point of Diversion:

Twp	Rng	Mer	Sec	Q-Q

Agent (if any): Justin Stergen

Property Ownership: Does Registrant own all land for the proposed project? Yes No

If No: The affected landowner's name and mailing address is listed. Notes:

The map must meet the following minimum requirements.

- Township, Range, Section
- Streams and roads identified as they cross through the map
- Place of use, Q-Qs, and tax lot clearly identified
- Even map scale of not less than 4" = 1 mile (1" = 1320 ft.)
- Location of each diversion point (WW Treatment Plant)
- North Directional Symbol
- Number of acres per Q-Q if for irrigation, nursery, or agriculture
- Legend

0.557 cfs

* A map showing the wastewater treatment facility, transmission system and place of use at a scale of 4" = 1 mile is fine, **only if** a second map is provided showing the place of use at not less than 4" = 1 mile.

- Signature of **all** Registrants and Reclaimed Water Supplier
- DEQ section (17) is completely filled out and signed
- Existing Water Rights: 0

DO NOT send registration back to applicant if it is not complete. **ALL** registrations go to Kerri Cope.

Reviewed by: Joan Smith

Date: 3/14/23

*Remember there is no fee for Reclaimed Water Registrations

TWP	Rng	Mer	Sec.	QQ	Plot	Acres	Descrpt	Contract # Years
13S	33E	WM	5	SWSW	-	1.4	Lagoon	10.0
13S	33E	WM	5	SESW	-	21.6	Site	10.0
13S	33E	WM	8	NENW	-	24.0		10.0
13S	33E	WM	8	SENW	-	4.0		10.0
total Acres						50.1		