

Application for a Permit to
Store Water in a Reservoir
 Alternate Review (ORS 537.409)



Oregon Water Resources Department
 725 Summer Street NE, Suite A
 Salem, Oregon 97301-1266
 (503) 986-0900
 www.oregon.gov/OWRD

RECEIVED
MAR 15 2023
OWRD

You may use this form for any reservoir storing less than 9.2 acre-feet or with a dam less than 10 feet high.

Use a separate form for each reservoir

SECTION 1: APPLICANT INFORMATION AND SIGNATURE

Applicant

NAME JOHN GUILLIAMS			PHONE (HM)		
PHONE (WK) 707-495-4257		CELL		FAX	
MAILING ADDRESS 21838 NW GERRISH VALLEY ROAD					
CITY YAMHILL	STATE OR	ZIP 97148	E-MAIL * JOHN@GUILLIAMS.COM		

Organization

NAME			PHONE		FAX
MAILING ADDRESS				CELL	
CITY	STATE	ZIP	E-MAIL *		

Agent – The agent is authorized to represent the applicant in all matters relating to this application.

AGENT / BUSINESS NAME GSI WATER SOLUTIONS, INC. ATTN: KIMBERLY GRIGSBY			PHONE 541-257-9004		FAX
MAILING ADDRESS 1600 SW WESTERN BOULEVARD, SUITE 240				CELL	
CITY CORVALLIS	STATE OR	ZIP 97333	E-MAIL * KGRIGSBY@GSIWS.COM		

Note: Attach multiple copies as needed

* By providing an e-mail address, consent is given to receive all correspondence from the department electronically. (paper copies of the final order documents will also be mailed.)

By my signature below I confirm that I understand:

- I am asking to use water specifically as described in this application.
- Evaluation of this application will be based on information provided in the application.
- I cannot legally store water until the Water Resources Department issues a permit.
- Oregon law requires that a permit be issued before beginning construction. Acceptance of this application does not guarantee a permit will be issued.
- If I get a permit, I must not waste water.
- If development of the water use is not according to the terms of the permit, the permit can be cancelled.
- The water use must be compatible with local comprehensive land use plans.
- Even if the Department issues a permit, I may have to stop using water to allow senior water right holders to get water to which they are entitled.

I (we) affirm that the information contained in this application is true and accurate.



	JOHN GUILLIAMS, OWNER	1/20/23
Applicant Signature	Print Name and Title if applicable	Date
Applicant Signature	Print Name and Title if applicable	Date

SECTION 2: SOURCE OF WATER AND LOCATION OF RESERVOIR

Reservoir name:	Guilliams Reservoir		
Source*:	Run-off	Tributary:	Salt Creek
County:	Yamhill		

SECTION 2: SOURCE OF WATER AND LOCATION OF RESERVOIR

OWRD

Reservoir name:	Guilliams Reservoir				
Source*:	Run-off	Tributary:	Salt Creek		
County:	Yamhill				
Quantity:	11.3 Acre-Feet [length x width x depth / 43,560]				
Reservoir Location:	Township (N or S)	Range (E or W)	Section	Quarter-Quarter	Tax Lot #
	2S	4W	29	NWNW	1101
Maximum Height of Dam:	Less than 10.0 feet. If excavated write "zero feet."				

* Provide the name of the water body or other source from which water will be diverted, and the name of the stream or lake it flows into. Indicate if source is run-off, seepage, an unnamed stream, or spring.

SECTION 3: WATER USE

Indicate the proposed use(s) of the stored water: Multipurpose use

NOTE: You may wish to consider filing for "Multipurpose use" for your reservoir. Multipurpose use does not limit the types of future uses for the stored water. Multipurpose covers all uses including: stock water, fish and wildlife, aesthetics, domestic, irrigation, agriculture, fire protection and pollution abatement.

SECTION 4: PROPERTY OWNERSHIP

Do you own all the land where you propose to divert, transport, and use water?

- Yes (please check appropriate box below then skip to section 5)
 - There are no encumbrances
 - This land is encumbered by easements, right of way, roads of way, roads or other encumbrances
- No (Please check the appropriate box below)
 - I have a recorded easement or written authorization permitting access.
 - I do not currently have written authorization or easement permitting access.
 - Written authorization or an easement is not necessary, because the only affected lands I do not own are state-owned submersible lands, and this application is for irrigated and/or domestic use only (ORS 274.040). (Do not check this box if you described your use as "Multipurpose" in #3 above.)

List the names and mailing addresses of all affected landowners:

SECTION 5: ENVIRONMENTAL IMPACT

Channel: Is the Reservoir: in-stream or off channel?

Wetland: Is the project in a wetland? YES NO unknown

Existing: Is this an existing reservoir? YES NO The existing pond is authorized by Certificate 91198, however, this application proposes to expand the reservoir as shown in Attachment E to store up to a total of 15 acre-feet.

If YES, how long has it been in place? years.

Fish Habitat: Is there a fish habitat upstream of the proposed structure? YES NO unknown

If YES, how much? miles.

Existing: Have you been working with other agencies? YES NO

Indicate agency, staff and phone numbers of those involved. Also indicate any agencies that are cost sharing in this project.

SECTION 6: WITHIN A DISTRICT

Check here if the point of diversion or place of use are located within or served by an irrigation or other water district.

Irrigation District Name: <i>N/A</i>		Address:	
City:	State:	Zip:	

SECTION 7: DESCRIPTION

Provide a short description of the design and operation of the proposed diversion, including a description of how live flow will be passed outside the authorized storage season. Use this space for narrative. You may also provide narrative and sketches on separate pages.

An existing reservoir that is currently authorized by Certificate 91198 will be expanded. The resulting off-channel reservoir will store up to a total of 15 acre-feet (3.7 acre-feet under Certificate 91198 and up to 11.3 acre-feet under the requested permit), and will be filled entirely with surface water runoff. Any water entering the reservoir outside of the storage season will be passed through an outlet pipe. Please see Attachment A for the location of the reservoir and outlet. When necessary, the reservoir can be entirely emptied using a submersible pump.

If the diversion involves a dam, use this space below for sketches of the diversion (e.g. cross-section of the dam with its dimensions, dimension and placement of outlet pipe, means of passing live flow outside of the authorized storage season, and means for providing fish passage).

The proposed off-channel reservoir will have an earthen dam (berm) with a maximum height of less than 10 feet. Any excess water will be drained through the outlet pipe at the east end of the reservoir. Please see Attachment E for a rendering.

RECEIVED

MAR 15 2023

OWRD

Attachment A

Application Map

Application for a Permit to Store Water in a Reservoir - John Guilliams

RECEIVED

MAR 15 2023

OWRD

Attachment B

Water Master Review Sheet

Application for a Permit to Store Water in a Reservoir - John Guilliams

Watermaster Alternate Reservoir Application Review Sheet

OWRD

In lieu of the water right application process set forth in ORS 537.140 to 537.211, an owner of a reservoir may submit an alternate reservoir application for a reservoir that has a storage capacity less than 9.2 acre-feet or a dam or impoundment structure less than 10 feet in height. ORS 537.409 describes the criteria used to evaluate alternate reservoir applications.

The review shall be limited to issues pertaining to: a) water availability, b) potential detrimental impact to existing fishery resources; and c) potential injury to existing water rights. (ORS 537.409 (6))

Within 60 days after the Water Resources Department provides public notice, any person may submit detailed, legally obtained information in writing, requesting the Department to deny the application for a permit on the basis that the reservoir: (a) Would result in injury to an existing water right; or (b) Would pose a significant detrimental impact to existing fishery resources. (ORS 537.409 (5))

Applicant's Name JOHN GUILLIAMS 2S, 4W, Sec 29, TL 1101, NWNW		
1. Does the proposed reservoir have the potential to injure existing water rights? <input type="checkbox"/> YES <input checked="" type="checkbox"/> NO Explain:		
2. Can conditions be applied to mitigate the potential injury to existing water rights? <input type="checkbox"/> YES <input type="checkbox"/> NO Explain: NA		
3. Is water available for the proposed reservoir? <input checked="" type="checkbox"/> YES <input type="checkbox"/> NO		
4. If yes, during what period? Beginning: October 1 End: July 31 Attach a WARS printout at 50% exceedance. If WARS does not cover the proposed location, make a recommendation for a storage season based upon regulation history and your knowledge of the location. (Water Availability for Reservoir Policy found under OAR 690-410-0070(2)(c))		
5. Did you meet with staff from another agency to discuss this application? <input type="checkbox"/> YES <input checked="" type="checkbox"/> NO		
Who:	Agency:	Date:
Who:	Agency:	Date:

Watermaster Name: Joel Plahn

Watermaster Signature: Joel Plahn 2023.01.23 07:53:00-08:00 Date: 1/23/2023

NOTE: This completed form must be returned to the applicant

RECEIVED

MAR 15 2023

OWRD

Attachment C

ODFW Review Sheet

Application for a Permit to Store Water in a Reservoir - John Guilliams

ODFW Alternate Reservoir Application Review Sheet

RECEIVED

MAR 15 2023

OWRD

This portion to be completed by the applicant.

Applicant Name: John Guilliams

Address: 21838 NW Gerrish Valley Road

Phone/Email: 707-495-4257 / john@guilliams.com

Reservoir Name: Guilliams Reservoir

Volume (AF): 11.3

Source: Run-off

Basin Name: Salt Creek > N Yamhill R.

in-channel

Twp Rng Sec QQ: 2S 4W 29 NWNW

off-channel

Note: It is unlikely that ODFW will be able to complete this form while you wait, nevertheless we recommend making an appointment to submit the form so as to provide any necessary clarifications. See pg. 6 of Instructions for contact information.

This portion to be completed by Oregon Department of Fish and Wildlife (ODFW) staff.

1) Is the proposed project and AO¹ off channel?..... YES* NO
(if yes then proceed to #4; if no then proceed to #2)

**Based on available information, the proposed use does not appear to involve instream structures that would create or maintain an artificial obstruction. However, if the applicant creates or maintains an artificial obstruction to fish passage for the proposed use, the applicant will need to address Oregon's fish passage laws.*

2) Is the proposed project or AO located where NMF² are or were historically present?..... YES NO
(if yes then proceed to #3; if no then proceed to #4)

3) If NMF are or were historically present:

a. Is there an ODFW-approved fish-passage plan?..... YES NO

b. Is there an ODFW-approved fish-passage waiver or exemption?..... YES NO

If fish passage is required under ORS 509.580 through .910, then either 3(a) or 3(b) must be "Yes" to move forward with the application. If responses to 3(a) and 3(b) are "No", then the proposed reservoir does not meet the requirements of Oregon Fish Passage Law and shall not be constructed as proposed.

4) Would the proposed project pose any other significant detrimental impact to an existing fishery resource locally or downstream?..... YES NO

Explain below (for example, list STE species or other existing fishery resources that would be impacted negatively.)

Any diversion or appropriation of water for storage during the period May.1 through November.30 poses a significant detrimental impact to existing fishery resources. (For example, if diversion of water for storage during a certain time period would cause a significant detrimental impact to an existing fishery resource, then ODFW should recommend conditions or limitations.) If NMF fish are present at the project site or point

¹ AO = Artificial Obstruction means any dam, diversion, culvert or other human-made device placed in waters of this state that precludes or prevents the migration of native migratory fish. ORS 509.580 (1)

² NMF = Native Migratory Fish Species in Oregon as defined by OAR 635 - 412 - 0005 (32)

of water diversion then the applicant should be advised that a fish screen consistent with screening criteria will be required.

- This proposed pond or reservoir contemplates impounding water in the Columbia Basin above Bonneville Dam. ODFW has determined that additional diversions of water in this area pose a significant detrimental impact to existing fishery resources during the period April 15 through September 30.

ESA-listed fish (spring Chinook Salmon and winter steelhead) and state sensitive species (Coastal Cutthroat Trout and Pacific Lamprey) are present in the North Yamhill River during the period of impact. Instream flows to fulfill C72586 for aquatic life are not being met partially or wholly during the period of impact. Based on parameters assessed by ODFW, instream flows are currently below those essential to support the biological needs of an existing fishery resource during June.1st-November.30th. In addition, ODFW reviewed available information regarding water quality impairment and determined that a TMDL exists for the Yamhill Watershed for phosphorus and an instream water right for pollution abatement is established. Consequently, ODFW recommends that because the proposed use would impair water quality that supports existing fishery resources (e.g., habitat) at or downstream of the Point of Diversion that the water use be restricted to the period of December.1st – April.30th.

The proposed use will diminish physical habitat and alter the flow regime to which fish are naturally adapted, negatively affecting their distribution, productivity, and abundance. Therefore, a further reduction in flow or alteration of habitat from the proposed use would impair or be detrimental to an existing fishery resource and/or their habitat without appropriate conditions and/or mitigation.

Impairment to Fishery Resource	Jan	Feb	Mar	Apr	May	Jun	Jul	Aug	Sep	Oct	Nov	Dec
Water Quantity												
Water Quality												

If YES, can conditions be applied to mitigate the significant detrimental impact to an existing fishery resource?

- NO (explain) YES (select from Menu of Conditions on next page)

See applicable conditions selected from “Menu of Conditions” on next page

Without appropriate conditions and/or mitigation, a further reduction in flow or alteration of habitat from the proposed water use will impair or be detrimental to an existing fishery resource. Water is only available to support biologically necessary flows at the POD and/or downstream during December.1 – April.30. ODFW recommends the season of use be restricted to coincide with this period or the proposed use be mitigated prior to issuance of a Proposed Final Order for any use outside of this period. ODFW recommends the applicant submit to the application caseworker at WRD, a Mitigation Proposal that fulfills the Mitigation Obligation consistent with the goals and standards of OAR 635-415-0025 (ODFW Habitat Mitigation Recommendations), as outlined below, to compensate for any potential impact from the proposed use.

Janna L
Stevens

Digitally signed by Janna L Stevens
Date: 2023.03.03 13:40:41 -08'00'

ODFW Signature: _____

Print Name: Janna Stevens

ODFW Title: Water Planning Coordinator

Date: 3/3/2023

RECEIVED

MAR 15 2023

OWRD

NOTE: This completed form must be returned to the applicant.

Applicant Name: John Williams

RECEIVED
ODFW Review
MAR 15 2023
OWRD

MENU OF CONDITIONS FOR WRD, ODFW, DEQ AND ODA
Revised May 12, 2020, March 25, 2021

Use this menu to identify appropriate conditions to be included in the permit:

- Agricultural Water Quality Management Area Rules:** The permittee shall comply with basin-specific Agricultural Water Quality Management Area Rules described in Oregon Administrative Rule Chapter 603-095. The permittee shall protect riparian areas, including through irrigation practices and the management of any livestock, allowing site capable vegetation to establish and grow along streams, while providing the following functions: shade (on perennial and some intermittent streams), bank stability, and infiltration or filtration of overland runoff.
- b52** Water may be diverted only when Department of Environmental Quality sediment standards are being met.
- b5** The water user shall install and maintain adequate treatment facilities meeting current DEQ requirements to remove sediment before returning the water to the stream.
- b51a** The period of use has been limited to **December 1 through April 30.**
- b57** Before water use may begin under this permit, a totalizing flow meter must be installed at each diversion point.
- b58** Before water use may begin under this permit, a staff gage that measures the entire range and stage between full reservoir level and dead-pool storage must be installed in the reservoir. The staff gage shall be United States Geological Survey style porcelain enamel iron staff gage style A, C, E or I.
- b1v:** Water must be diverted to a trough or tank through an enclosed water delivery system. The delivery system must be equipped with an automatic shutoff or limiting flow control mechanism or include a means for returning water to the stream source through an enclosed delivery system. The use of water shall not exceed 0.10 cubic feet per second per 1000 head of livestock.
- Bypass Flows:** Per 690-410-0070 (2)(c), the following flows shall be bypassed or passed through the reservoir during the filling season:
- 1) When the biologically necessary flows identified below are not available immediately upstream of the impacted area, the permittee shall pass all live flow downstream at a rate equal to the inflow, minus the amount of mitigation water provided upstream, if applicable, and
 - 2) When the biologically necessary flows identified below are available immediately upstream of the impacted area, the permittee shall pass flow downstream at a rate equal to or greater than the biologically necessary flows.
- Once the reservoir has reached the permitted volume, all live flow shall be passed downstream at a rate equal to the inflow.
- The permittee shall quantify and document inflow and outflow and maintain the bypass flows for the life of the permit and subsequent certificate per the approved Bypass Plan. The bypass flow data shall be available upon request by the Oregon Water Resources Department, Oregon Department of Fish and Wildlife, Oregon Department of Environmental Quality, or Oregon Department of Agriculture.
- Construction Activities:** For construction activities (clearing, grading, excavation, staging, and stockpiling) that will disturb one or more acres and may discharge to state waters, the permittee is required to obtain from DEQ a 1200-C NPDES Stormwater Construction Permit prior to project construction.
- fence:** The stream and its adjacent riparian area shall be fenced to exclude livestock.
- fishapprove:** The permittee shall install, maintain, and operate fish screening and by-pass devices consistent with current Oregon Department of Fish and Wildlife (ODFW) standards. Fish screening is to prevent fish from entering the proposed diversion while by-pass devices provide adequate upstream and downstream passage for fish. The required screen and by-pass devices are to be in place and functional, and approved in writing by ODFW prior to diversion of any water. The permittee may submit evidence in writing that ODFW has determined screens and/or by-pass devices are not necessary.
- fishdiv33:** If the riparian area is disturbed in the process of developing a point of diversion, the permittee shall be responsible for restoration and enhancement of such riparian area in accordance with ODFW's Fish and Wildlife Habitat Mitigation Policy OAR 635-415. For purposes of mitigation, the ODFW Fish and Wildlife Habitat Mitigation Goals and Standards, OAR 635-415, shall be followed.
- The use may be restricted if the quality of the source stream or downstream waters decrease to the point that those waters no longer meet existing state or federal water quality standards due to reduced flows.
- The permittee shall install, maintain, and operate fish screening and by-pass devices consistent with current Oregon Department of Fish and Wildlife (ODFW) standards. Fish screening is to prevent fish from entering the proposed diversion while by-pass devices provide adequate upstream and downstream passage for fish. The required screen and by-pass devices are to be in place and functional, and approved in writing by ODFW prior to diversion of any water. The permittee may submit evidence in writing that ODFW has determined screens and/or by-pass devices are not necessary.
- fishmay:** Notwithstanding that ODFW has made a determination that fish screens and/or by-pass devices are not necessary at the time of permit issuance, the permittee may be required in the future to install, maintain, and operate fish screening and by-pass devices to prevent fish from entering the proposed diversion and to provide adequate upstream and downstream passage for fish.

- fishpass:** As required by ORS 509.585, a person owning or operating an artificial obstruction (AO) may not construct or maintain any AO across any waters of this state that are inhabited, or historically inhabited, by native migratory fish (NMF) without providing passage for NMF. A person owning or operating an AO shall, prior to construction, fundamental change in permit status or abandonment of the AO in any waters of this state, obtain a determination from ODFW as to whether NMF are or historically have been present in the waters. If ODFW determines that NMF are or historically have been present in the waters, the person owning or operating the AO shall either submit a proposal for fish passage to ODFW or apply for a waiver or exemption. Approval of the proposed fish-passage facility, waiver, or exemption must be obtained from the department prior to construction, permit modification or abandonment of the AO. Approved fish-passage plans, waivers, and exemptions shall maintain adequate passage of NMF at all times (ORS 509.601) as per the approved plan, waiver or exemption.
- fishself:** The permittee shall install, maintain, and operate fish screening and by-pass devices consistent with current Oregon Department of Fish and Wildlife (ODFW) standards. Fish screening is to prevent fish from entering the proposed diversion while by-pass devices provide adequate upstream and downstream passage for fish. The required screen and by-pass devices are to be in place and functional prior to diversion of any water. Permittee shall obtain written approval from ODFW that the installation of the required screen and by-pass devices meets the state's criteria or the permittee shall submit documentation that ODFW has determined screens and/or by-pass devices are not necessary.
- Fish Stocking:** Per ORS 498.222 and OAR 635-007-0600, all persons transporting fish in Oregon need to have a fish transport permit issued by the Oregon Department of Fish and Wildlife (ODFW). The permittee shall not stock fish in the reservoir without a fish transport permit approved by ODFW. As part of the permitting process, the permittee must also screen the inlet and outlet of their pond to insure that fish cannot escape into public waters and/or to keep wild fish from entering the pond.
- futile call:** The use of water allowed herein may be made only at times when waters from the (NAME OF SURFACE WATER) would not otherwise flow into a tributary of the type here River or sufficient water is available to satisfy all prior rights, including rights for maintaining instream flows.
- In-Water or Riparian Construction:** For in-water or riparian construction, permittee may be required to obtain additional permits from the Oregon Department of State Lands, the U.S. Army Corps of Engineers, and the DEQ Section 401 certification program prior to construction. The applicant must contact these agencies to confirm requirements.
- In-Water Work:** Any in-water work related to construction, development, or maintenance of the proposed use shall be conducted during the preferred work period of type here unless an alternate time period is approved by the Oregon Department of Fish and Wildlife.
- Live Flow:** Once the allocated volume has been stored, permittee shall pass all live flow downstream at a rate equal to inflow, using methods that protect instream water quality.
- Off-Channel Stored Water Releases:** The permittee shall not release polluted water from this off-channel reservoir into waters of the state except when the release is directed by the State Engineer to prevent dam failure.
- On-Channel Reservoir:** The permittee shall design and operate the water storage facility such that all waters within and below the reservoir meet water quality criteria. The permittee shall develop a reservoir operations plan that details how water quality criteria and standards will be met. A Certified Water Rights Examiner shall verify that the reservoir operations are consistent with the plan before a certificate is issued. The reservoir operator shall maintain a copy of the plan and make it available for review upon request.
- riparian:** If the riparian area is disturbed in the process of developing a point of diversion, the permittee shall be responsible for restoration and enhancement of such riparian area in accordance with ODFW's Fish and Wildlife Habitat Mitigation Policy OAR 635-415. For purposes of mitigation, the ODFW Fish and Wildlife Habitat Mitigation Goals and Standards, OAR 635-415, shall be followed.
- Water Quality:** All water use under this permit shall comply with state and federal water quality laws. The permittee shall not violate any state and federal water quality standards, shall not cause pollution of any waters of the state, and shall not place or cause to be placed any wastes in a location where such wastes are likely to escape or be carried into the waters of the state by any means. The use may be restricted if the quality of source stream or downstream waters decrease to the point that those waters no longer meet existing state or federal water quality standards.
- wetland:** The permittee must submit an offsite determination request to the Oregon Department of State Lands (DSL) to determine the need for a wetland delineation prior to disturbance or development of the point of diversion and/or diversion of water.
- wq:** The use may be restricted if the quality of the source stream or downstream waters decrease to the point that those waters no longer meet existing state or federal water quality standards due to reduced flows.

RECEIVED

MAR 15 2023

OWRD

RECEIVED
MAR 15 2023
OWRD

Attachment D

Land Use Information Form

Application for a Permit to Store Water in a Reservoir - John Guilliams

2429-1101

Land Use Information Form

pd 1-13-23



Oregon Water Resources Department
725 Summer Street NE, Suite A
Salem, Oregon 97301-1266503-986-0900
www.oregon.gov/OWRD

NAME JOHN GUILLIAMS			PHONE (HM)		
PHONE (WK) 707-495-4257		CELL		FAX	
MAILING ADDRESS 21838 NW GERRISH VALLEY ROAD					
CITY YAMHILL		STATE OR	ZIP 97148	E-MAIL* JOHN@GUILLIAMS.COM	

A. Land and Location

Please include the following information for all tax lots where water will be diverted (taken from its source), conveyed (transported), and/or used or developed. Applicants for municipal use, or irrigation uses within irrigation districts may substitute existing and proposed service-area boundaries for the tax-lot information requested below.

Township	Range	Section	¼ ¼	Tax Lot #	Plan Designation (e.g., Rural Residential/RR-5)	Water to be:	Proposed Land Use:
2S	4W	29	NWNW	1101	EF-80	<input checked="" type="checkbox"/> Diverted <input type="checkbox"/> Conveyed <input checked="" type="checkbox"/> Used	Multipurpose Storage

List all counties and cities where water is proposed to be diverted, conveyed, and/or used or developed:

Yamhill

B. Description of Proposed Use

Type of application to be filed with the Water Resources Department:

- Permit to Use or Store Water
 Water Right Transfer
 Permit Amendment or Ground Water Registration Modification
 Limited Water Use License
 Allocation of Conserved Water
 Exchange of Water

Source of water: Reservoir/Pond Ground Water Surface Water (name) Run-off

Estimated quantity of water needed: 11.3 cubic feet per second gallons per minute acre-feet

Intended use of water: Irrigation Commercial Industrial Domestic for _____ household(s)
 Municipal Quasi-Municipal Instream Other Multipurpose Storage

Briefly describe:

The Applicant is proposing to expand an existing reservoir and store water in the resulting pond for multipurpose use. The pond will be filled with surface water runoff.

Note to applicant: If the Land Use Information Form cannot be completed while you wait, please have a local government representative sign the receipt at the bottom of the next page and include it with the application filed with the Water Resources Department.

RECEIVED

MAR 15 2023

OWRD

RECEIVED

MAR 15 2023

OWRD

For Local Government Use Only

The following section must be completed by a planning official from each county and city listed unless the project will be located entirely within the city limits. In that case, only the city planning agency must complete this form. This deals only with the local land-use plan. Do not include approval for activities such as building or grading permits.

Please check the appropriate box below and provide the requested information

- Land uses to be served by the proposed water uses (including proposed construction) are allowed outright or are not regulated by your comprehensive plan. Cite applicable ordinance section(s): *Section 402.02(A) of the YCZO*
- Land uses to be served by the proposed water uses (including proposed construction) involve discretionary land-use approvals as listed in the table below. (Please attach documentation of applicable land-use approvals which have already been obtained. Record of Action/land-use decision and accompanying findings are sufficient.) If approvals have been obtained but all appeal periods have not ended, check "Being pursued."

Type of Land-Use Approval Needed (e.g., plan amendments, rezones, conditional-use permits, etc.)	Cite Most Significant, Applicable Plan Policies & Ordinance Section References	Land-Use Approval:	
		<input type="checkbox"/> Obtained <input type="checkbox"/> Denied	<input type="checkbox"/> Being Pursued <input type="checkbox"/> Not Being Pursued
		<input type="checkbox"/> Obtained <input type="checkbox"/> Denied	<input type="checkbox"/> Being Pursued <input type="checkbox"/> Not Being Pursued
		<input type="checkbox"/> Obtained <input type="checkbox"/> Denied	<input type="checkbox"/> Being Pursued <input type="checkbox"/> Not Being Pursued
		<input type="checkbox"/> Obtained <input type="checkbox"/> Denied	<input type="checkbox"/> Being Pursued <input type="checkbox"/> Not Being Pursued
		<input type="checkbox"/> Obtained <input type="checkbox"/> Denied	<input type="checkbox"/> Being Pursued <input type="checkbox"/> Not Being Pursued

Local governments are invited to express special land-use concerns or make recommendations to the Water Resources Department regarding this proposed use of water below, or on a separate sheet.

Name: LANCE Woods Title: ASSOCIATE PLANNER
 Signature: [Signature] Phone: (503) 434-7516 Date: 1/18/2023
 Government Entity: TAMMILL COUNTY PLANNING

Note to local government representative: Please complete this form or sign the receipt below and return it to the applicant. If you sign the receipt, you will have 30 days from the Water Resources Department's notice date to return the completed Land Use Information Form or WRD may presume the land use associated with the proposed use of water is compatible with local comprehensive plans.



Receipt for Request for Land Use Information

Applicant name: _____
 City or County: _____ Staff contact: _____
 Signature: _____ Phone: _____ Date: _____

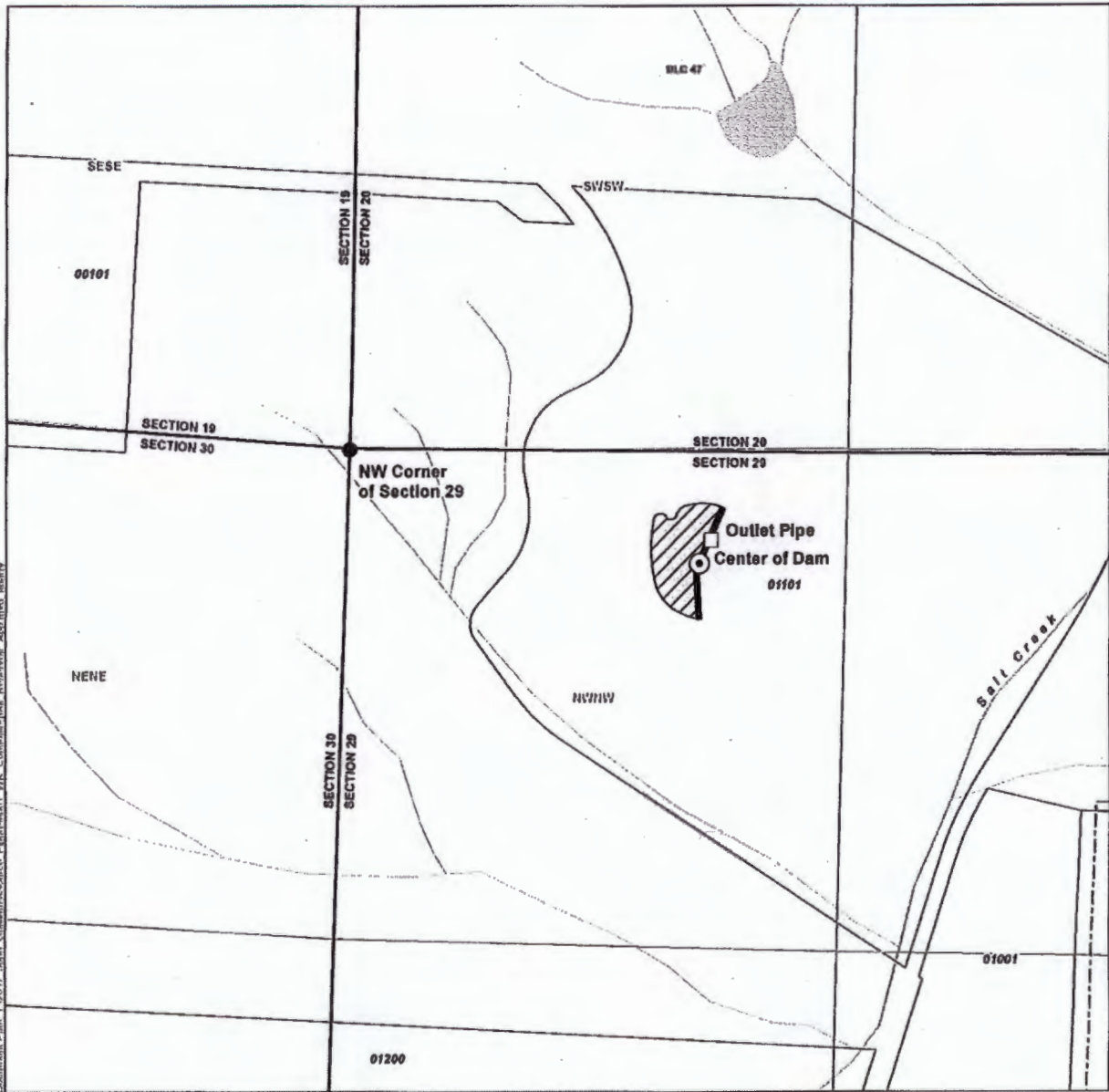

Document Path: Y:\2007 - John Guilliams\Source - E:\2007\001 - W.R. Consultants\138 - Reservoir - John Guilliams - 01001.dwg

- LEGEND**
- Center of Dam
 - Outlet Pipe
 - Dam
 - Reservoir Footprint
 - Donation Land Claims (DLC)
 - Watercourse
 - Waterbody

**Alternate Reservoir Application
in the Name of John Guilliams**

Yamhill County
Township 2 South, Range 4 West (W.M.)

RECEIVED
MAR 15 2023
OWRD

DISCLAIMER
This map was prepared for the purpose of identifying the location of a water right only and it is not intended to provide legal dimensions or location of property ownership lines.

Date: December 27, 2022
Data Sources: BLM, ESRI, OWRD, USGS, Yamhill County

LOCATION DESCRIPTION
Center of Dam
Located 280 feet South and 930 feet East from the NW corner of Section 29, Township 2 South, Range 4 West (W.M.)

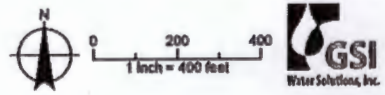

RECEIVED
MAR 15 2023
OWRD

Attachment E

Reservoir Renderings

Application for a Permit to Store Water in a Reservoir - John Guilliams

12/1/22
GUILLIAMS
21838 GERLISH VALLEY RD.
YAMHILL, OREGON

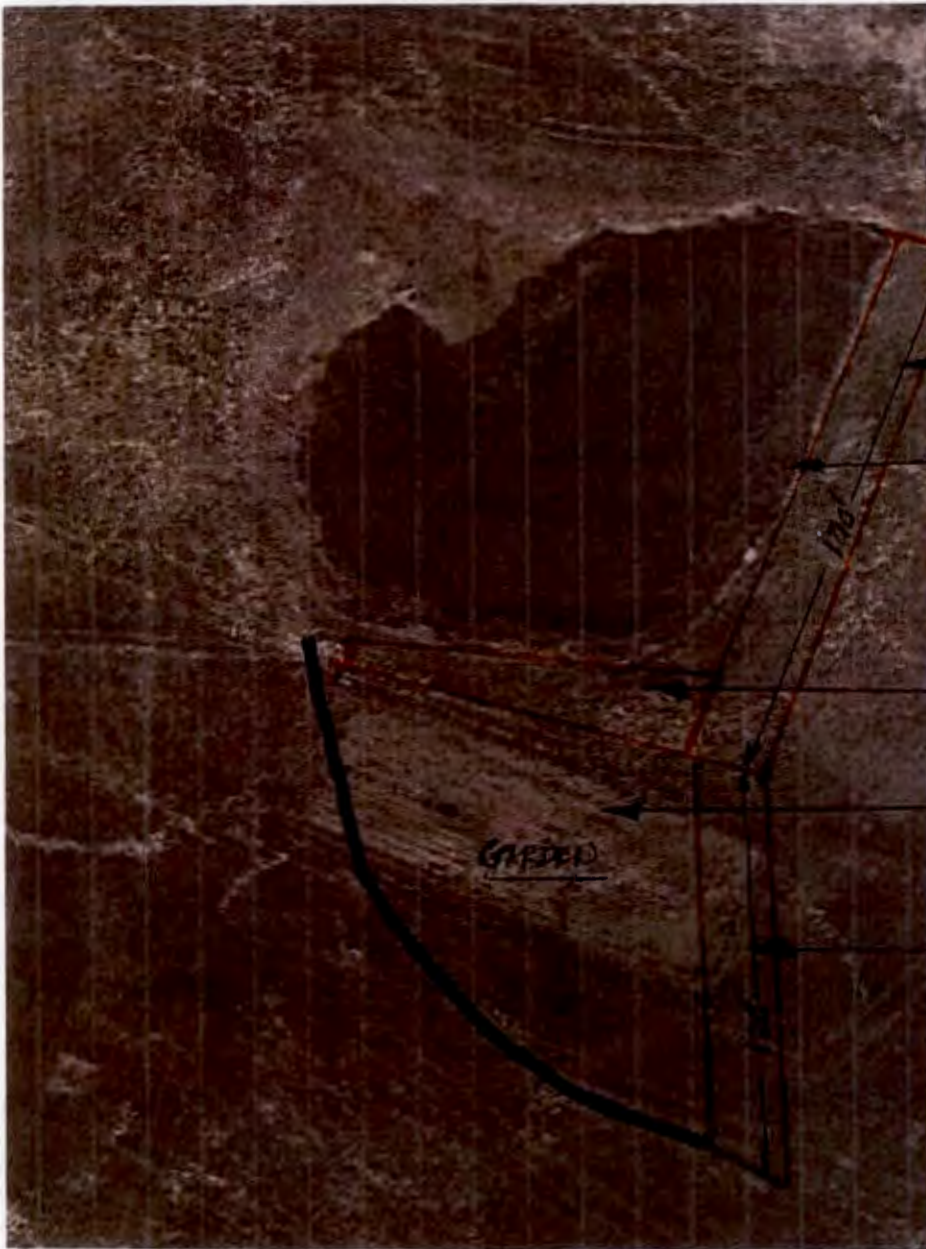

EXISTING DAM TO REMAIN

OVERFLOW DRAIN 17 1/2" ID.

EXISTING DAM TO REMOVE

NEW RESERVOIR CAPACITY

NEW DAM TO CONSTRUCT
(MAXIMUM HEIGHT 110 FEET)

RECEIVED

MAR 15 2023

OWRD

RECEIVED

MAR 15 2023

OWRD

Attachment F

Legal Description of Property

Application for a Permit to Store Water in a Reservoir - John Guilliams

Exhibit "A"

Real property in the County of Yamhill, State of Oregon, described as follows:

A portion of the James Laughlin Donation Land Claim No. 47 in Sections 20 and 29, Township 2 South, Range 4 West of the Willamette Meridian in Yamhill County, Oregon, and being more particularly described as follows:

Beginning at an iron rod at the intersection of the South line of that tract of land conveyed to Hilda A. Eidsmoe et vir, by deed recorded April 17, 1942 in Book 119, Page 450, Deed Records of Yamhill county, Oregon, and the centerline of Market Road No. 7 (Gerrish Valley Road as traveled) which iron rod bears North 0°47'40" East 2193.22 feet and South 89°07'40" East 2163.89 feet from an iron pipe at the Southwest corner of said Laughlin Donation Land Claim No. 47, and running thence South 89°07'40" East along the Southerly line of said Eidsmoe tract 692.33 feet to an iron rod at the true Westerly corner of tract of land as described in instrument recorded January 13, 1975 in Film Volume 103, Page 1736, Deed and Mortgage Records of Yamhill county, Oregon; thence South 63°13'25" East along the Southerly line of that tract of land as described in Film Volume 103, Page 1736, Deed and Mortgage Records, 1079.0 feet to an iron rod in the center of County Road No. 253 (as traveled); thence Southwesterly along the said centerline of County Road No. 253 (as traveled) 1662.4 feet, more or less, to the intersection with Market Road No. 7 (Gerrish Valley Road as traveled); thence Northwesterly along said centerline of Market Road No. 7 (Gerrish Valley Road as traveled) 2885 feet, more or less, to the point of beginning.

NOTE: This Legal Description was created prior to January 01, 2008.

RECEIVED

MAR 15 2023

OWRD

AFTER RECORDING RETURN TO: Stephen L. Lawhead
21838 Gerrish Valley Road
Yamhill, OR 97148

WATER LINE EASEMENT

KNOW ALL PEOPLE BY THESE PRESENTS, THAT Janice K. Belt, Edwin Gieszler, Marjory R. Gieszler, Thomas R. Both, Patsy L. Both, Edward Walters and Alta F. Walters

GRANTOR, FOR AND IN CONSIDERATION OF THE SUM OF -0- DOLLARS AND OTHER VALUABLE CONSIDERATION PAID TO THEM BY Stephen L. Lawhead, GRANTEE, DO HEREBY GRANT UNTO SAID GRANTEE A PERMANENT AND PERPETUAL EASEMENT AND RIGHT TO LAY DOWN, CONSTRUCT, RECONSTRUCT, INSPECT AND MAINTAIN A WATER WELL, WATER LINE OR LINES, ELECTRICAL LINES AND A TEMPORARY EASEMENT TO PROVIDE ROOM FOR PEOPLE AND EQUIPMENT IN THE WORK OF CONSTRUCTING AND INSTALLING SAID LINES, WHICH EASEMENTS ARE MORE PARTICULARLY DESCRIBED AS FOLLOWS:

PERMANENT EASEMENT: A TWENTY FOOT WIDE STRIP OF LAND BEING TEN FEET ON EACH SIDE OF THE FOLLOWING DESCRIBED CENTERLINE IN THE NORTHWEST QUARTER OF SECTION 29, TOWNSHIP 2 SOUTH, RANGE 4 WEST, WILLAMETTE MERIDIAN, YAMHILL COUNTY, OREGON BEING FURTHER DESCRIBED AS FOLLOWS:

COMMENCING AT AN IRON ROD AT THE INTERSECTION OF THE CENTERLINE OF GARRISH VALLEY ROAD WITH THE NORTH LINE OF THAT PROPERTY DESCRIBED IN DEED RECORDED IN VOLUME 189 PAGE 582; THENCE ON THE CENTERLINE OF SAID ROAD ALONG THE ARC OF A CURVE TO THE RIGHT, SAID CURVE HAVING A RADIUS OF 600.00 FEET, ARC LENGTH OF 328.18 FEET, CENTRAL ANGLE OF 031°20'20", A CHORD BEARING OF S33°16'10"E, AND A CHORD LENGTH OF 324.10 FEET; THENCE ALONG THE ARC OF A CURVE TO THE RIGHT, SAID CURVE HAVING A RADIUS OF 175.00 FEET, ARC LENGTH OF 244.86 FEET, CENTRAL ANGLE OF 080°10'00", A CHORD BEARING OF S22°29'00"W, AND A CHORD LENGTH OF 225.37 FEET; THENCE S62°34'00"W, A DISTANCE OF 58.12 FEET; THENCE ALONG THE ARC OF A CURVE TO THE LEFT, SAID CURVE HAVING A RADIUS OF 225.00 FEET, ARC LENGTH OF 291.97 FEET, CENTRAL ANGLE OF 074°21'00", A CHORD BEARING OF S25°23'30"W, AND A CHORD LENGTH OF 271.91 FEET; THENCE S11°47'00"E, A DISTANCE OF 63.12 FEET; THENCE ALONG THE ARC OF A CURVE TO THE RIGHT, SAID CURVE HAVING A RADIUS OF 200.00 FEET, ARC LENGTH OF 74.74 FEET, CENTRAL ANGLE OF 021°24'41", A CHORD BEARING OF S01°04'40"E, AND A CHORD LENGTH OF 74.31 FEET TO THE TRUE POINT OF BEGINNING; THENCE LEAVING SAID ROAD CENTERLINE N81°57'32"W, A DISTANCE OF 113.86 FEET TO THE WELL SITE AND THE TERMINUS OF THIS CENTERLINE; ALSO INCLUDING A PERMANENT EASEMENT FOR A RADIUS OF 20.00 FEET AROUND THE TERMINUS POINT.

IN THE EVENT THAT WELL WATER IS NOT AVAILABLE AT THE ABOVE DESCRIBED TERMINUS POINT THE GRANTOR AGREES TO GRANT AN EASEMENT EXTENSION TO A NEW LOCATION WITHIN 200 FEET OF THE ABOVE TERMINUS POINT PROVIDED THE GRANTEE PROVIDE A REVISED LEGAL DESCRIPTION.

PAGE ONE - WATER LINE EASEMENT

RECEIVED

MAR 15 2023

OWRD

1993 JUN -7 PM 2:31

F 287P2079

101-2892
LS080-12

1993 JUN -7 PM 2:32

F287P2000

TEMPORARY EASEMENT: A 30.00 FEET WIDE EASEMENT CENTERED ON THE ABOVE DESCRIBED CENTERLINE AND A 50.00 FOOT RADIUS AROUND THE ABOVE DESCRIBED TERMINUS.

TO HAVE AND TO HOLD THE ABOVE DESCRIBED AND GRANTED EASEMENTS UNTO THE SAID GRANTEE'S AND THEIR SUCCESSORS IN INTEREST FOREVER.

THE TEMPORARY EASEMENT DESCRIBED AND GRANTED HEREIN SHALL CEASE WHEN SAID WELL AND WATER LINE OR LINES ARE COMPLETED, AT WHICH TIME A RELEASE WILL BE ISSUED BY THE GRANTEE. SHOULD IT BE NECESSARY FOR THE GRANTEE TO RECONSTRUCT THE WELL OR WATER LINE, THE TEMPORARY EASEMENT CAN BE RE-ACTIVATED PROVIDED THE GRANTEE PAY THE GRANTOR FOR DAMAGES TO CROPS AND/OR IMPROVEMENTS OR A MINIMUM OF \$ -0-

TO ACCESS THE WELL SITE/WATER LINE EASEMENT, THE GRANTOR DOES GRANT TO THE GRANTEE THE FOLLOWING INGRESS-EGRESS EASEMENT:

A 15 FOOT WIDE STRIP OF LAND BEING 7.5 FEET OF EACH SIDE OF THE FOLLOWING DESCRIBED CENTERLINE LOCATED IN THE SOUTHWEST QUARTER OF SECTION 20 AND THE NORTHWEST QUARTER OF SECTION 29, TOWNSHIP 2 SOUTH RANGE 4 WEST, WILLAMETTE MERIDIAN, YAMHILL COUNTY, OREGON BEING FURTHER DESCRIBED AS FOLLOWS:

COMMENCING AT AN IRON ROD AT THE INTERSECTION OF THE CENTERLINE OF GARRISH VALLEY ROAD WITH THE NORTH LINE OF THAT TRACT DESCRIBED IN DEED RECORDED IN VOLUME 189 PAGE 562; THENCE ALONG THE ARC OF A CURVE TO THE RIGHT, SAID CURVE HAVING A RADIUS OF 600.00 FEET, ARC LENGTH OF 328.18 FEET, CENTRAL ANGLE OF 031°20'20", A CHORD BEARING OF S33°16'10"E, AND A CHORD LENGTH OF 324.10 FEET; THENCE ALONG THE ARC OF A CURVE TO THE RIGHT, SAID CURVE HAVING A RADIUS OF 175.00 FEET, ARC LENGTH OF 6.78 FEET, CENTRAL ANGLE OF 002°13'10", A CHORD BEARING OF S16°29'25"E, AND A CHORD LENGTH OF 6.78 FEET TO THE TRUE POINT OF BEGINNING; THENCE S89°31'58"W, A DISTANCE OF 181.96 FEET; THENCE N81°14'53"W, A DISTANCE OF 184.68 FEET; THENCE S80°57'02"W, A DISTANCE OF 150.14 FEET; THENCE S24°04'10"W, A DISTANCE OF 248.99 FEET; THENCE S27°43'43"E, A DISTANCE OF 59.76 FEET; THENCE S53°27'15"E, A DISTANCE OF 184.74 FEET; THENCE S34°45'18"E, A DISTANCE OF 126.82 FEET; THENCE S17°53'47"E, A DISTANCE OF 69.95 FEET; THENCE S00°44'00"E, A DISTANCE OF 37.35 FEET; TO THE TERMINUS OF THIS CENTERLINE.

IN THE EVENT THAT WATER IS NOT AVAILABLE AT THE ABOVE DESCRIBED WELL SITE THIS INGRESS-EGRESS EASEMENT WILL BE MODIFIED TO ACCESS THE NEW WELL SITE AS ABOVE REFERENCED.

SHOULD IT BE NECESSARY TO CUT AND REMOVE ANY BRUSH, TREES OR OTHER MATTER OR MATERIALS FROM THE EASEMENT AREA, SAID BRUSH, TREES OR OTHER MATTER AND MATERIALS SHALL BECOME THE PROPERTY OF THE GRANTEE AND THE GRANTEE SHALL REMOVE THE SAME AND LEAVE THE EASEMENT AREA IN A NEAT AND WORKMAN LIKE CONDITION.

THIS INSTRUMENT DOES NOT GRANT OR CONVEY UNTO THE GRANTEE ANY RIGHT OR TITLE TO THE SURFACE OF THE SOIL ALONG THE ROUTE OF SAID WATER LINE OR LINES EXCEPT FOR THE PURPOSE OF LAYING DOWN, CONSTRUCTING, RECONSTRUCTING, INSPECTING AND MAINTAINING THE SAME AND THE GRANTORS, THEIR HEIRS AND ASSIGNS SHALL ALWAYS HAVE THE RIGHT TO REASONABLE USE OF SAID EASEMENT AREA FOR ANY AND ALL PURPOSES WHICH DO NOT INTERFERE WITH OR ADVERSELY AFFECT THE USE

PAGE TWO - WATER LINE EASEMENT

RECEIVED

MAR 15 2023

OWRD

1993 JUN -7 PM 2:32

F287P2081

BY THE GRANTEE FOR THE PURPOSES CONVEYED. THE GRANTEE AGREES THAT IN CASE IT IS NECESSARY TO ENTER UPON THE BASEMENT AREA AT A LATER DATE TO INSPECT, REPAIR, MAINTAIN OR REPLACE SAID WATER LINE, THE GRANTEE WILL PAY FOR ANY ADDITIONAL DAMAGE DONE TO THE PROPERTY AND WILL LEAVE THE PREMISES IN A NEAT AND WORKMAN LIKE CONDITION AND AS NEARLY IN THE ORIGINAL CONDITION AS PRACTICABLE.

THE GRANTORS DO HEREBY WARRANT THAT THEY ARE OWNER IN FEE SIMPLE AND HAVE THE RIGHT TO GRANT THE ABOVE DESCRIBED EASEMENTS. WITNESS OUR HANDS AND SEALS THIS 4th DAY OF June, 1993.

Janice K. Belt
Janice K. Belt
Margaret R. Gieszler
Margaret R. Gieszler
Edwin Gieszler
Edwin Gieszler
Alta F. Walters
Alta F. Walters

Edwin Gieszler
Edwin Gieszler
Thomas R. Roth
Thomas R. Roth
Edward Walters
Edward Walters

STATE OF Oregon)
COUNTY OF Clatsop) SS.

June 4, 1993

PERSONALLY APPEARED Janice K. Belt
AND ACKNOWLEDGED THE FOREGOING INSTRUMENT TO BE THEIR VOLUNTARY ACT AND DEED.

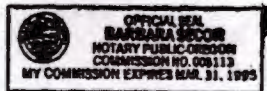

BEFORE ME:

Barbara Secor
NOTARY PUBLIC FOR OREGON.
MY COMMISSION EXPIRES:

STATE OF Oregon)
COUNTY OF Clatsop) SS.

June 4, 1993

PERSONALLY APPEARED Edwin Gieszler and Margaret R. Gieszler
AND ACKNOWLEDGED THE FOREGOING INSTRUMENT TO BE THEIR VOLUNTARY ACT AND DEED.

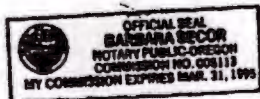

BEFORE ME:

Barbara Secor
NOTARY PUBLIC FOR OREGON.
MY COMMISSION EXPIRES:

RECEIVED

MAR 15 2023

OWRD

1993 JUN -7 11 2:32

F207P2082

STATE OF Oregon
COUNTY OF Washington) SS.

PERSONALLY APPEARED Thomas R. Roth and Patsy L. Roth
AND ACKNOWLEDGED THE FOREGOING INSTRUMENT TO BE THEIR VOLUNTARY
ACT AND DEED. June 4, 1995

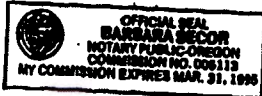

BEFORE ME:

Barbara Secor
NOTARY PUBLIC FOR OREGON.
MY COMMISSION EXPIRES:

STATE OF Oregon
COUNTY OF Washington) SS.

PERSONALLY APPEARED Edward Walters and Alta F. Walters
AND ACKNOWLEDGED THE FOREGOING INSTRUMENT TO BE THEIR VOLUNTARY
ACT AND DEED. June 4, 1995

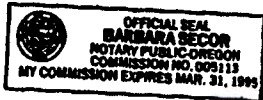

BEFORE ME:

Barbara Secor
NOTARY PUBLIC FOR OREGON.
MY COMMISSION EXPIRES:

PAGE FOUR - WATER LINE EASEMENT

RECEIVED

MAR 15 2023

OWRD

1993 JUN -7 PM 2:32

F287P2083

EASEMENT SITE PLAN
FOR ED WALTERS
IN THE SW1/4, SECTION 20 &
NW1/4 SECTION 28, T2S, R4W, N.H.
YAMHILL COUNTY, OREGON
SCALE: 1"=100' MAY 11, 1993



SEC 19 | SEC 20
SEC 30 | SEC 29



CLAYNE CASWELL
REGISTERED LAND SURVEYOR
6120 S.W. LONGHARD AVE.
BEAVERTON, OREGON 97008

REGISTERED
PROFESSIONAL
LAND SURVEYOR
Albert Herold
OREGON
ALL COUNTY REGISTER
1999

STATE OF OREGON
COUNTY CLERK
Charles Stumba
CHARLES STUMBA
COUNTY CLERK

WATER
LINE
EASEMENT

PROPOSED
WELL

700 517

007411
7/20/03

RECEIVED

MAR 15 2023

OWRD



Water Solutions, Inc.

Via electronic mail

March 6, 2023

Katie Ratcliffe
Oregon Water Resources Department
725 Summer Street NE, Suite A
Salem, OR 97301

RE: Application for a Permit to Store Water in a Reservoir – John Guilliams

Dear Ms. Ratcliffe:

On behalf of John Guilliams, GSI Water Solutions, Inc. is submitting the enclosed application under the Alternate Review process for a permit to store up to 11.3 acre-feet of water in a reservoir for multipurpose use. The source of water for storage is surface water runoff. The proposed reservoir will expand an existing reservoir that is currently authorized by Certificate 91198.

The permit application fee will be mailed to OWRD after we receive the temporary number for this application. The fee was calculated as follows:

\$480 – Base application fee (Alternate Reservoir process)
\$492 – \$41 per AF or fraction thereof x 12.0 AF = \$492
\$610 – Permit recording fee

Total = \$1,582

If you have any questions regarding this application, please contact me at 541-753-0933

Sincerely,

A handwritten signature in blue ink that reads "Kimberly Grigsby". The signature is written in a cursive style and is positioned to the left of a vertical line.

Kimberly Grigsby
Principal Water Resource Consultant

CC: John Guilliams

Enclosures: Application for a permit to store water in a reservoir

RECEIVED

MAR 15 2023

OWRD

RECEIVED
MAR 15 2023
OWRD
SALEM, OREGON

From: Zach Pike-Urlacher
To: Molly Monroe
Cc: Kim Grigsby
Subject: FW: John Guilliams Alternate Reservoir Application
Date: Monday, March 13, 2023 1:34:52 PM
Attachments: image001.png

Hi Molly,

Can you print out this email, package it up with the check for John Guilliams, and send to OWRD.

Thanks,
Zach

Zach Pike-Urlacher
Water Resources Consultant
direct: 541.753.0933 | mobile: 360.739.2303
1600 SW Western Boulevard, Suite 240, Corvallis, OR 97333
GSI Water Solutions, Inc. | www.gsiws.com
pronouns: he, him

RECEIVED
MAR 15 2023
OWRD
SALEM, OREGON

From: REECE Nick A * WRD <Nick.A.REECE@water.oregon.gov>
Sent: Monday, March 13, 2023 1:12 PM
To: Zach Pike-Urlacher <zpikurlacher@gsiws.com>
Subject: RE: John Guilliams Alternate Reservoir Application

Hi Zach,

I apologize for the delay.

OWRD has received and accepted the Alternative Reservoir e-application for **John Guilliams**. The temporary application number is: **NR-2**

Please print this email and include a copy of it when mailing in the payment. The fees due for this application are: **\$ 972.00 (if opting to include recording fee: \$1582.00)**

A copy of the fee calculator is included for your reference

Oregon Water Resources Department Alternate Reservoir Application		Mail	Return
For impoundments less than 10 feet in height or storage less than 9.2 acre feet of water			
Today's Date: Monday, March 13, 2023			
Basic Application Fee			\$400.00
Proposed Dam Height in feet	9.5		
Proposed Reservoir volume in Acre Feet	11.3		\$482.00
		Subtotal	\$882.00
Permit Recording Fee ***			\$610.00
*** the Permit Recording Fee is not required when the application is submitted but, must be paid before a permit will be issued. It is fully refundable if a permit is not issued. If the recording fee is not paid prior to issuance of the Final Order, permit issuance will be delayed.			
Estimated cost of Permit Application			\$1,582.00

Thank you,

Nick Reece
Public Service Representative 4
725 Summer Street NE, Suite A, Salem, OR 97301 | Phone: 503-986-0810



Integrity | Service | Technical Excellence | Teamwork | Forward-Looking

From: Zach Pike-Urlacher <zpikurlacher@gsiws.com>
Sent: Monday, March 13, 2023 12:37 PM
To: WRD_DL_customerservice <WRD_DL_customerservice@water.oregon.gov>
Cc: Kim Grigsby <kgrigsby@gsiws.com>; Molly Monroe <mmonroe@gsiws.com>
Subject: RE: John Guilliams Alternate Reservoir Application

Good afternoon,

We are writing to confirm that you received the below electronic submission on behalf of John Guilliams. We will mail the \$1,582 permit application fee once we receive the temporary number for this application.

Thank you,
Zach

Zach Pike-Urlacher