

Application No. G 8664
 Permit No. G 8044
 Certificate No. 62335
 Stream Index, Page No. 7 - 84

24 short

Name Orville Humphreys
 By _____
 Address Box 447
Pilot Rock, OR 97868

Date filed 24 Feb 78
 Priority Feb. 24, 1978
 Action suspended until OK cert.

Return to applicant _____
 Date of approval MAY 11 1978

CONSTRUCTION

Date for beginning MAY 11 1979
 Date for completion OCT 1 1979
 Extended to _____
 Date for application of water OCT 1 1980
 Extended to _____

PROSECUTION OF WORK

Form "A" filed Started
 Form "B" filed 10-4-78
 Form "C" filed ~~10-4-78~~ Sept 17, 1980

FINAL PROOF

Blank mailed JUL 28 1989
 Proof received _____
 Date certificate issued SEP 29 1989

FEES PAID		
Date	Amount	Receipt No.
<u>2-24-78</u>	<u>59.67</u>	<u>1278</u>
		Cert. Fee
FEES REFUNDED		
Date	Amount	Check No.

ASSIGNMENTS				
Date	To Whom	Address	Volume	Page

REMARKS

IMPORTANT—This form is a notice to the Water Resources Director that permittee is ready to make final proof to the extent to which the water has actually been applied to the intended use under the terms of the permit. Permittee is cautioned that Certificate of Water Right will be issued based on the extent of the quantity and use as determined by the final proof inspection and survey which will be made in response to the filing of this Form C.

NOTE: In the case of an irrigation permit, this Form C should not be mailed to the Water Resources Department until all of the land described in the permit, which it is intended to irrigate under this permit at any time, has actually been irrigated.

Fill out, detach and mail to the Water Resources Department, Salem, OR 97310, when all of the water has been applied.

Application No. G8664

NOTICE OF COMPLETE APPLICATION OF WATER TO A BENEFICIAL USE

I, Orville Humphreys, the holder of Permit No. G8044

do appropriate the public waters of the state of Oregon, completely applied the waters to a beneficial use in accordance with the terms of said permit, on the 15 day of August, 1978

Remarks:

IN WITNESS WHEREOF, I have hereunto set my hand this 29 day of September, 1978

Orville Humphreys (Signature of Applicant)

Box 447 Pilot Rock Oregon - 97868 (Address)

RECEIVED

OCT 4 1978

WATER RESOURCES DEPT. SALEM, OREGON

OK LMT

Application No. G8664

NOTICE OF COMPLETION OF CONSTRUCTION

I, Orville Humphreys, the holder of Permit No. G8664

do appropriate the public waters of the state of Oregon, completed the construction of the works described thereon on the 1 day of August, 1978

Remarks:

If the works have less capacity than described in the permit, or you have definitely abandoned part of the proposed development, you should so state in order that our records may not be unnecessarily encumbered.

IN WITNESS WHEREOF, I have hereunto set my hand this 29 day of September, 1978

Orville Humphreys (Signature of Applicant)

Box 447 Pilot Rock Oregon - 97868 (Address)

Fill out, detach and mail to the Water Resources Department, Salem, OR 97310, when construction work is completed.

RECEIVED

OCT 4 1978

WATER RESOURCES DEPT. SALEM, OREGON

OK LMT

IMPORTANT—This form is a notice to the Water Resources Director that permittee is ready to make final proof to the extent to which the water has actually been applied to the intended use under the terms of the permit. Permittee is cautioned that Certificate of Water Right will be issued based on the extent of the quantity and use as determined by the final proof inspection and survey which will be made in response to the filing of this Form C.

NOTE: In the case of an irrigation permit, this Form C should not be mailed to the Water Resources Department until all of the land described in the permit, which it is intended to irrigate under this permit at any time, has actually been irrigated.

Fill out, detach and mail to the Water Resources Department, Salem, OR 97310, when all of the water has been applied.

Application No. D-8664

NOTICE OF COMPLETE APPLICATION OF WATER TO A BENEFICIAL USE

I, Orville Humphreys, the holder of Permit No. B-8044

do appropriate the public waters of the state of Oregon, completely applied the waters to a beneficial use in accordance with the terms of said permit, on the 1 day of September, 1980

Remarks:

IN WITNESS WHEREOF, I have hereunto set my hand this 12 day of September, 1980

Orville Humphreys (Signature of Applicant)

Box 447 Pilot Rock Ore 97868 (Address)

RECEIVED

SEP 17 1980

WATER RESOURCES DEPT SALEM OREGON

OK 229

Well log on file indicates basalt at 4 feet
below L.S. Water bearing zone, in basalt,
occurs at a depth of 109 feet
below L.S. Well is probably not hydraulically
connected with the stream. Should
be distributed as groundwater.

RBA 2/28/78

STATE OF OREGON WATER RESOURCES DEPARTMENT

Application for a Permit to Appropriate Ground Water

RECEIVED
FEB 24 1978
WATER RESOURCES DEPT.
SALEM, OREGON

I, Orville Humphreys (Name of Applicant)

of Box 447 (Mailing Address) Pilot Rock (City)

State of Oregon, 97868 (Zip Code) Phone No. 443-6293 do hereby

make application for a permit to appropriate the following described ground waters of the State of Oregon:

1. The development will consist of Two Wells trib' Birch Creek (Give number of wells, tile lines, infiltration galleries, etc.)

having a diameter of #1 - 8" and an estimated depth of 253' feet.

2. The well or other source is to be located #2 - 10" #1 1,050 1180 S 10-90 W E and 275 220 ft. S W (N. or S.) (E. or W.)

from the Center corner of Section 33 (Public Land Survey Corner)

(If there is more than one well, each must be described)

being within the NE SE SW 1/4 of the 1/4 of

Sec. 33 Tp. 1S R. 32E, W. M., in the county of Umatilla

3. Location of area to be irrigated, or, place of use if use other than irrigation.

Township	Range	Section	List 1/4 1/4 of Section	List use and/or number of acres to be irrigated
			Primary Irrigation	
1S	32E	33	NE 1/4 SW 1/4	1.7 0
1S	32E	33	NW 1/4 NW 1/4	27.5 0
1S	32E	33	SE 1/4 NW 1/4	39.5 2.2
1S	32E	33	SE 1/4 SW 1/4	10.5 9.7
1S	32E	33	NE 1/4 SW 1/4	31.2 33.1
			Supplemental Irrigation	TOTAL 45.0
1S	32E	33	NE 1/4 SW 1/4	2.5 2.5
1S	32E	33	NW 1/4 SE 1/4	6.0 3.4
1S	32E	33	SW 1/4 SE 1/4	10.0

4. It is estimated that #1 20 #2 20 feet of the well will require Steel casing. (Kind)

5. Depth to water table is estimated 8 (Feet) Well drilled by #1 Rudy Davis #2 Larry Byrd

ISA-7 JC
6-30-86
PRE-C
2/15/79 RFB

Application No. G 8664

G 8044

Permit No. PC

Permit to Appropriate the Public Waters of the State of Oregon

This is to certify that I have examined the foregoing application and do hereby grant the same, SUBJECT TO EXISTING RIGHTS INCLUDING THE EXISTING MINIMUM FLOW POLICIES ESTABLISHED BY THE WATER POLICY REVIEW BOARD and the following limitations and conditions:

The right herein granted is limited to the amount of water which can be applied to beneficial use and shall not exceed 1.61 ^{0.76} ~~0.75~~ cubic feet per second measured at the point of diversion from the well or source of appropriation, or its equivalent in case of rotation with other water users, from two wells.

trib. East Birch Basin
The use to which this water is to be applied is irrigation and supplemental irrigation. ^{of 430 acres} ~~159~~

If for irrigation, this appropriation shall be limited to 1/80th of one cubic foot per second or its equivalent for each acre irrigated and shall be further limited to a diversion of not to exceed 3 acre feet per acre for each acre irrigated during the irrigation season of each year; provided further that the right allowed herein shall be limited to any deficiency in the available supply of any prior right existing for the same land and shall not exceed the limitation allowed herein,

and shall be subject to such reasonable rotation system as may be ordered by the proper state officer.
The well shall be constructed in accordance with the General Standards for the Construction and Maintenance of Water Wells in Oregon.
The works constructed shall include an air line and pressure gauge or an access port for measuring line, adequate to determine water level elevation in the well at all times.
The permittee shall install and maintain a weir, meter, or other suitable measuring device, and shall keep a complete record of the amount of ground water withdrawn.

The priority date of this permit is February 24, 1978

Actual construction work shall begin on or before May 11, 1979 and shall thereafter be prosecuted with reasonable diligence and be completed on or before October 1, 1979

Complete application of the water to the proposed use shall be made on or before October 1, 1980

WITNESS my hand this 11th day of May, 1978

James E. Saxon
Water Resources Director

INFO: ORVILLE HUMPHREYS. MR. HUMPHREYS HAS
DRILLED BOTH WELLS. HE IRRIGATES BOTTOM
LAND WITH HAND LINE AND LAND ABOVE
ROAD WITH $\frac{1}{4}$ MILE 5" ALUM WHEEL LINE.
HE RUNS 4" ALUM THROUGH A CULVERT
BENEATH ROAD TO TIE WELLS TOGETHER.
HE HAS NOT APPLIED WATER TO NW $\frac{1}{4}$ NW $\frac{1}{4}$,
SW $\frac{1}{4}$ NW $\frac{1}{4}$, AND SE $\frac{1}{4}$ NW $\frac{1}{4}$ SEC 33, AND IS
NOT SURE HE HAS PUMP CAPACITY TO DO SO.
HE MAY INSTEAD IRRIGATE SE $\frac{1}{4}$ SW $\frac{1}{4}$ SEC 33.
OTHERWISE, ALL LAND IS IRRIGATED AS
STATED. LEFT A "C" FORM.

FEBRUARY 15 1979

~~Walt Brown~~
FIELD ENGINEER

2983.39
 - 2153.40
 739.99

INFO: ORVILLE HUMPHRIES BOX 447 PILOT ROCK OR 97868 443-6293

STILL HAS NOT IRR. NW NW, SW NW, SE NW THESE LANDS GOING INTO ~~THE~~ SOIL BANK FOR 10 YEARS. INSTEAD HAS IRR. SOME IN SE NW, NE SW, SE, SW. SUPPLEMENTAL LANDS ALONG CREEK

HAVE BEEN BENEFICIAIALLY IRRIGATED UNDER TERMS AND EVERY YEAR TO DATE.

CAN. PERMIT BE ALLOWED FOR LANDS IN SW 1/4 INSTEAD ^{VERN SAYS OK. A LITTLE IN SE SW.} HE OWNS ALL LAND. WAS UNABLE TO PUMP ECONOMICALLY TO NW 1/4. BOTH WELLS TIED TOGETHER.

SUPPLEMENTAL TO EAST BIRCH CR. USES EAST BIRCH EVERY YEAR.

WELL 1. HERLEY F.M. 6029729 @ 00121.200 GROUND. NO A.L. OR H.P.
 DEPTH 80' 8" DIA.

WELL 2. MURKIN F.M. 810670 @ 4189.49X.001 ACRES
~~NO A.L. OR H.P.~~ H.P. YES.
 DEPTH 253' 10" DIA. 4" OISH.

S.W.L. ARTESIAN O.D. 16'

S.W.L. 49'

PUMP & MOTOR 3HP. SUB. SET @ 60'

PUMP & MOTOR 30HP. SUB. @ 130' APPROX.

MAIN LINE 4" PVC BURIED 1450'

3" ALUM BETWEEN WELLS 350'

3" ALUM. PORTABLE MAIN 800'

PIPE: 2 WHEEL LINES @ 1/4 MILE 4" @ 56PM F.C. NELSON. F44

HANDLINE 3" ALUM. 75 @ 56PM FLOOD CONTRACT NELSON.

2" ALUM - 15'

WELL 1 - 11 HEADS MAX.

WELL 2 - 2 WHEEL LINES + 20 MORE HEADS = 86 MAX.

CROP. ALFALFA, BARLEY.

TIE: 15A-7

LIFT. 0 TO +20

$Q_{\text{WELL 1}} = \frac{60.9}{80} = 0.76 \text{ CFS}$
 $Q_{\text{PUMP}} = \frac{(7.04)(133)}{130 + 127} = 0.90 \text{ CFS}$
 $Q_{\text{WELL 2}} = 0.76 \text{ CFS}$
 $720.$

$Q_{\text{ACRES}} = \frac{60.9}{80} = 0.75$

$Q_{\text{PUMP}} = \frac{(33)(7.05)}{180 + (1.1)(2.3)(80)} = 0.76$

$Q_{\text{HEAD}} = \frac{(97)(5)}{450} = 1.1$

$Q_{\text{ALLOWED}} = 0.75$

V.L. CHURCH By A.H. Smith
 W.P.E 6-30-86 SNG. TECH.

2983.39
 - 2153.40
 739.99

INFO: ORVILLE HUMPHRIES BOX 447 PILOT ROCK OR 97868 443-6293

STILL HAS NOT IRR. NW NW, SW NW, SE NW THESE LANDS GOING INTO ~~THE~~ SOIL BANK FOR 10 YEARS. INSTEAD HAS IRR. SOME IN SE NW, NE SW, SE, SW. SUPPLEMENTAL LANDS ALONG CREEK HAVE BEEN BENEFICIAALLY IRRIGATED UNDER TERMS AND EVERY YEAR TO DATE.

CAN. PERMIT BE ALLOWED FOR LANDS IN SW 1/4 INSTEAD. <sup>VERN SAYS
 OK. A LITTLE IN SE SW.</sup> HE OWNS ALL LAND. WAS UNABLE TO PUMP ECONOMICALLY TO NW 1/4. BOTH WELLS TIED TOGETHER. SUPPLEMENTAL TO EAST BIRCH CR. USES EAST BIRCH EVERY YEAR.

WELL 1. HERLEY F.M. 6029729 @ 00121.200 6 WHEELS
 NO A.L. OR H.P.
 DEPTH 80' 8" DIA.

WELL 2. MURDO F.M. 810670 @ 4189.49 X.001 ACRES
~~NO A.L. OR H.P.~~ H.P. YES.
 DEPTH 253' 10" DIA. 4" DISH.

S.W.L. ARTESIAN O.D. 16'

S.W.L. 49'

PUMP & MOTOR 3 HP. SUB. SET @ 60'

PUMP & MOTOR 30 HP. SUB. @ 130' APPROX.

MAIN LINE 4" PVC BURIED 1450'

3" ALUM BETWEEN WELLS 350'

3" ALUM. PORTABLE MAIN 800'

PIPE: 2 WHEEL LINES @ 1/4 MILE 4" @ 56 PM F.L. NELSON

HANDLINE 3" ALUM. 75 @ 56 PM FLOW CONTROL NE

2" ALUM - 15

WELL 1 - 11 HEADS MAX.

WELL 2 - 2 WHEEL LINES ± 20 MORE HEADS = 86 MAX.

COOP. ALFALFA, BARLEY.

TIE: 15A-7

LIFT. 0 TO +20

$$Q_{MIN} = \frac{60.9}{80} = 0.76 \text{ CFS}$$

$$Q_{PUMP} = \frac{(7.04)(33)}{130 + 127} = 0.90 \text{ CFS}$$

$$Q_{ALLOW} = 0.76 \text{ CFS} \text{ } \pm W.$$

$$Q_{ACRES} = \frac{60.9}{80} = 0.75$$

$$Q_{PUMP} = \frac{(33)(7.05)}{180 + (1.1)(2.3)(50)} = 0.76$$

$$Q_{HEAD} = \frac{(97)(5)}{450} = 1.1$$

$$Q_{ALLOWED} = 0.75$$

V.L. Church By P.K. Smith
 W.P.E 6-30-86 SNG. TECH.

T. 1 S., R. 32 E. W. M.

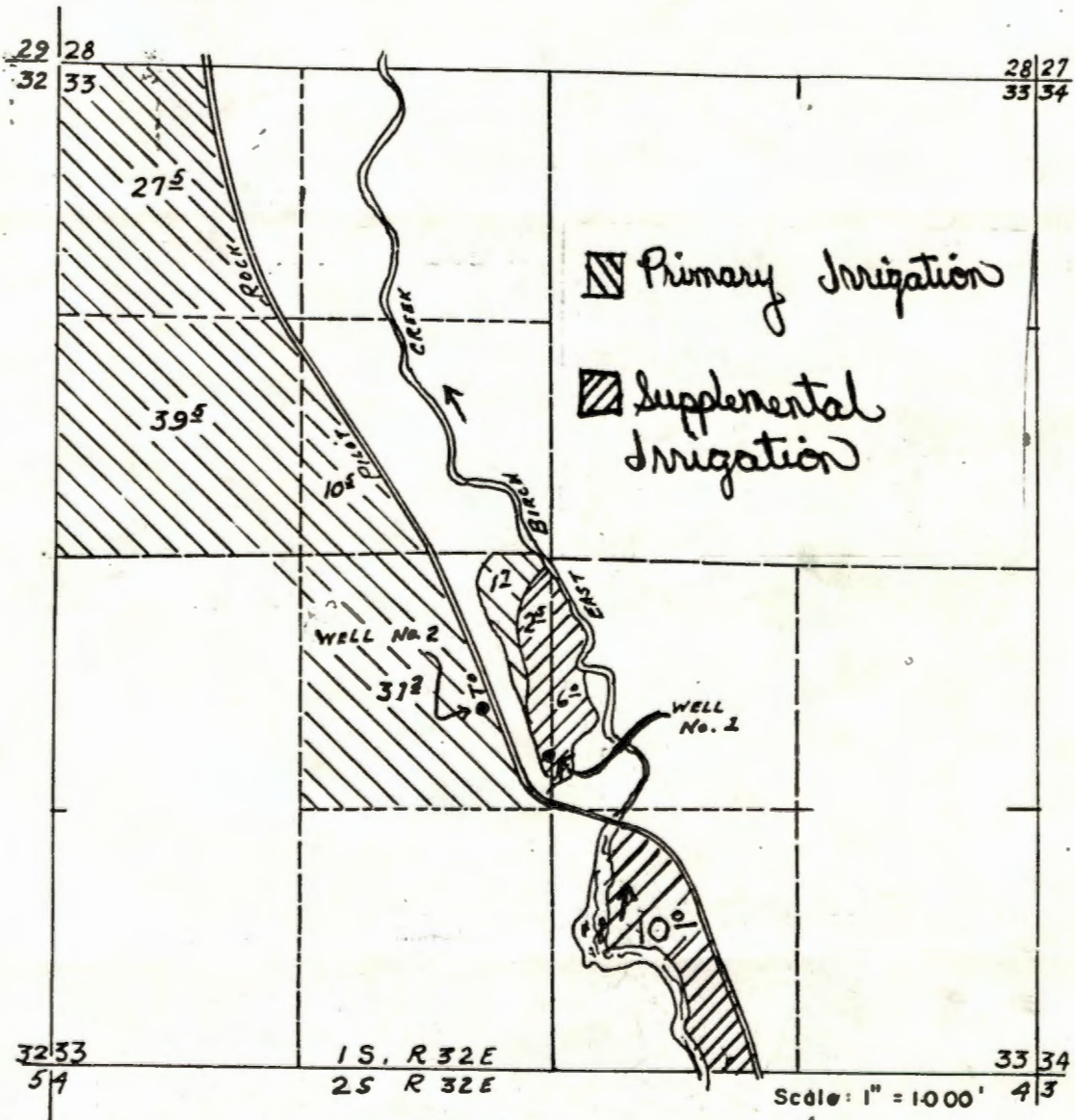

5.12 11
1.34 22

Application No. G 8664
Permit No. G 8044

RECEIVED
FEB 24 1978
WATER RESOURCES DEPT.
SALEM, OREGON

T. 1 S. R. 32 E. W.M.



Scale 1"=1320'

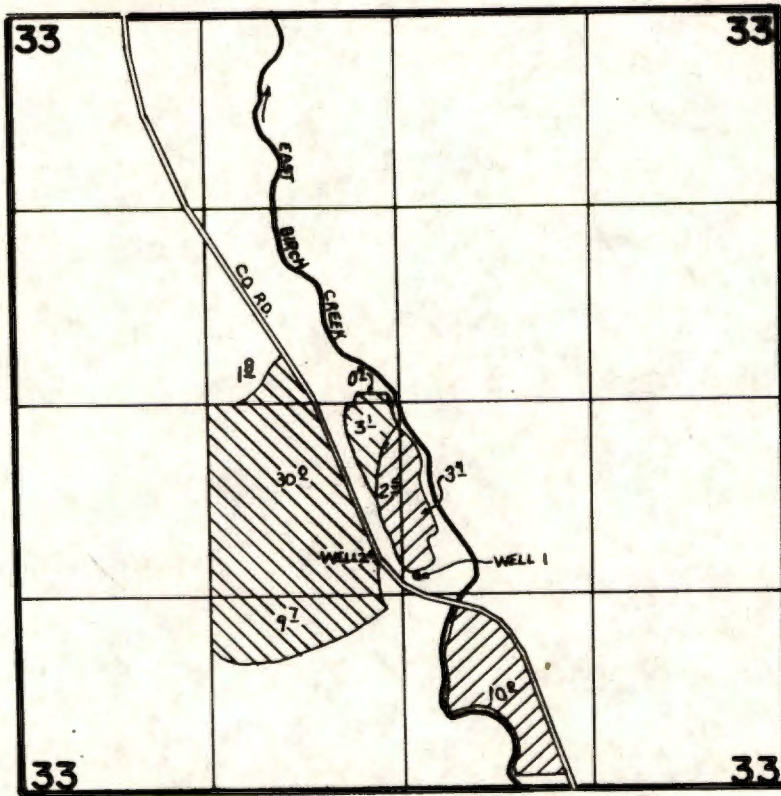

6.2

WELL 1 LOC. 1180' S. & 90' E. FROM CENTER SEC. 33
WELL 2 LOC. 1030' S. & 220' W. FROM CENTER SEC. 33



PRIMARY



SUPPLEMENTAL

FINAL PROOF SURVEY UNDER

Application No. G.8664. Permit No. G.8044.....
IN NAME OF

.....ORVILLE HUMPHREYS.....

Surveyed June. 30. 1986., by J. Sauter.....

T.1S., R.32E.W.M

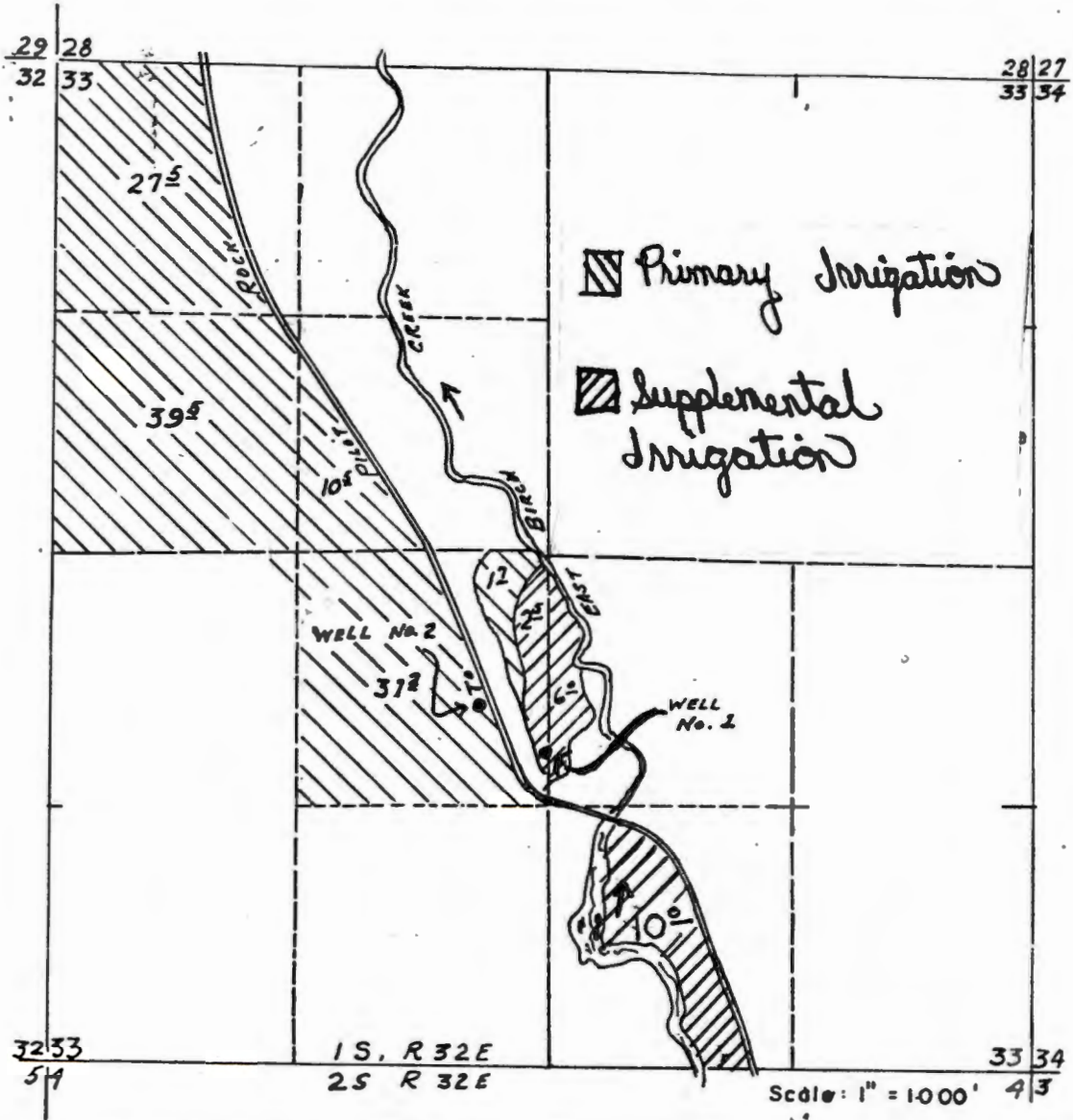

Application No. G 8664
Permit No. G 8044

RECEIVED
FEB 24 1978
WATER RESOURCES DEPT.
SALEM, OREGON

STATE OF OREGON
COUNTY OF UMATILLA
PROPOSED CERTIFICATE OF WATER RIGHT

THIS CERTIFICATE ISSUED TO

ORVILLE HUMPHREYS
BOX 447
PILOT ROCK, OREGON 97868

confirms the right to use the waters of TWO WELLS in the EAST BIRCH CREEK BASIN for the purpose of PRIMARY IRRIGATION OF 45.0 ACRES AND SUPPLEMENTAL IRRIGATION OF 15.9 ACRES.

The right has been perfected under Permit G-8044. The date of priority is FEBRUARY 24, 1978. The right is limited to not more than 0.76 CUBIC FOOT PER SECOND or its equivalent in case of rotation, measured at the well.

The wells are located as follows:

NW 1/4 SE 1/4, NE 1/4 SW 1/4, SECTION 33, T 1 S, R 32 E, W.M.; WELL 1 - 1180 FEET SOUTH AND 90 FEET EAST, WELL 2 - 1030 FEET SOUTH AND 220 FEET WEST, BOTH FROM THE CENTER 1/4 CORNER, SECTION 33.

The amount of water used for irrigation, together with the amount secured under any other right existing for the same lands, shall be limited to ONE-EIGHTIETH of one cubic foot per second per acre, or its equivalent for each acre irrigated and shall be further limited to a diversion of not to exceed 3.0 acre-feet per acre for each acre irrigated during the irrigation season of each year.

The right shall conform to such reasonable rotation system as may be ordered by the proper state officer.

A description of the place of use under the right, and to which such right is appurtenant, is as follows:

	PRIMARY	SUPPLEMENTAL
SE 1/4 NW 1/4	2.2 ACRES	
NE 1/4 SW 1/4	33.1 ACRES	2.5 ACRES
SE 1/4 SW 1/4	9.7 ACRES	
NW 1/4 SE 1/4		3.4 ACRES
SW 1/4 SE 1/4		10.0 ACRES
SECTION 33		
TOWNSHIP 1 SOUTH, RANGE 32 EAST, W.M.		

The right to the use of the water for the above purpose is restricted to beneficial use on the lands or place of use described.

FINAL PROOF CHECK LIST

FILES

- Plat Cards
- Conflicts?
- Comparisons

DRAFTING

- GLO's (Layout, Lots, DLC's)
- Quads
- Legal Description *NO LEGAL*
- Section Breakdown
- Diversion Point Dimensions
- Acreages
- Township, Range, Section
- Physical Features
- Survey ID Info

FIELD FORM

- Name, Address, County
- Source
- Tributary
- Use
- Priority Date
- POD
- Time Limits, Survey Reg?
- POU
- Q-Calculations
- Rate/Duty

ASSOCIATED RIGHTS

0.76 Total Q from Div. Point
WALS Primary Source Used

Reviewer JW Date 7/6/89

Remarks NO LEGAL, B&T F.E. REPORT

STATES OWNS ALL LANDS. PRIMARY FROM
E. BIRCH CK. GEOLOGIST SAYS NO HYDRAULIC CONNECTION.
NO ACTION NECESSARY



WATER RESOURCES DEPARTMENT

1178 CHEMEKETA STREET N.E. • SALEM, OREGON • 97310 • Phone 378-3066

ROBERT W. STRAUB
GOVERNOR

NOTICE OF FILING APPLICATION FOR A PERMIT TO APPROPRIATE WATER

File No. G-8664

Name Orville Humphreys
 Address Box 447 Pilot Rock, OR. 97868
 Water source 2 wells
 Use primary and supplemental irrigation
 Point of diversion NE $\frac{1}{4}$ SW $\frac{1}{4}$, Sec. 33, T. 1 S., R. 32 E., W.M.
 Amount of water 723 GPM

DESCRIPTION OF LAND TO BE IRRIGATED OR PLACE OF USE

Twp.	Range	Sec.	NE $\frac{1}{4}$				NW $\frac{1}{4}$				SW $\frac{1}{4}$				SE $\frac{1}{4}$				
			NE $\frac{1}{4}$	NW $\frac{1}{4}$	SW $\frac{1}{4}$	SE $\frac{1}{4}$	NE $\frac{1}{4}$	NW $\frac{1}{4}$	SW $\frac{1}{4}$	SE $\frac{1}{4}$	NE $\frac{1}{4}$	NW $\frac{1}{4}$	SW $\frac{1}{4}$	SE $\frac{1}{4}$	NE $\frac{1}{4}$	NW $\frac{1}{4}$	SW $\frac{1}{4}$	SE $\frac{1}{4}$	
1S	32E	33						PRI	PRI	PRI	PRI								
								27.5	39.5	10.5	32.9								
											SUPP								
											2.5								

Any person desiring to protest the approval of this application shall file a written protest in the office of the Director of the Water Resources Department at Salem, Oregon, within thirty days from the date of this notice.

A copy of the Rules for Administrative Procedures in Contested Cases Before the Director of the Water Resources Department of Oregon will be supplied free upon request.

Dated at Salem, Oregon, this 31st day of March, 19 78.

James E. Sexson
Water Resources Director

378-8508

February 22, 1979

Orville Humphreys
Box 447
Pilot Rock, OR 97868

RE: File No. G-8664

Dear Mr. Humphreys:

According to the report submitted by our field engineer, you have not made use of water to the extent intended within the limits of your permit No. G-8044, although the notice of complete application of water was submitted.

Under the terms of your permit, the date for complete application of water is October 1, 1980; therefore, you have more time to irrigate the balance of the land. We will mark the notice previously submitted as premature.

I am enclosing another form "C" for your use in reporting the completion of your project when applicable.

Sincerely,

Larry M. Toll
Water Rights Engineer

LMT:jfv
enclosure

May 17, 1978

Orville Humphreys
Box 447
Pilot Rock, OR 97868

G 8664

G 8044

Water Resources Department

MILL CREEK OFFICE PARK

555 13th STREET N.E., SALEM, OREGON 97310

PHONE 378-3066

G-8664.

March 31, 1978

Orville Humphreys
Box 447
Pilot Rock, OR. 97868

Dear Mr. Humphreys:

We have received your application for a permit to use 723 gallons of water per minute from a well for the primary irrigation of 110.4 acres and the supplemental irrigation of 18.5 acres. Your application has been filed and for reference is No. G-8664. We have also received your maps and fees of \$59.67.

Your application is in satisfactory form, and a permit will be issued in 30 to 60 days.

Sincerely,

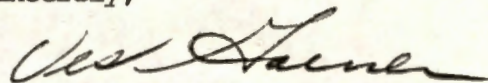

VESTAL GARNER
Water Rights Engineer

VG:tld
Enclosed: Receipt No. 1278