



Oregon Water Resources Department  
 725 Summer Street NE, Suite A  
 Salem, Oregon 97301  
 (503) 986-0900  
 www.oregon.gov/OWRD

# Ownership Update for Certificated Rights Only

## NO FEES ARE REQUIRED TO SUBMIT THIS FORM

**NOTICE:** A certificate of water right typically stays with the land. To track water right ownership, the Department requests that this form be submitted to the Department. **To update multiple rights, a separate form is required for each right.** If you have any questions about this form, please contact your local watermaster, or call the Water Resources Department at (503) 986-0900.

Note: Use the [assignment](#) form to change ownership on pending applications, permits, transfers, groundwater registrations, or limited licenses.

Current Landowner Information					
Name:	WFRP LLC				
Mailing Address:	PO Box 668				
City:	Wilbur	State:	OR	Zip:	97494
Phone:	541-673-1166	Email:	brett@whitlogtrailers.com		

Property Information					
County:	Coos	Township:	24 S	Range:	13 W, WM
Tax Lot #:	500	Section:	10		
Street Address of Water Right:	69255 Houser Depot Rd, North Bend, OR 97459				
<b>Water Right Information</b>					
Application:	14424	RECEIVED APR 03 2023 OWRD			
Permit:	10441				
Certificate:	C-11894				
Are all the lands associated with this water right owned by the requestor? <input checked="" type="checkbox"/> Yes <input type="checkbox"/> No					
(If no, include a map showing the portion of the water right involved)					

Signature and Date			
Name of individual completing form:	Brett Whitaker		
Phone or email:	brett@whitlogtrailers.com	Date:	3/30/23
Signature of requestor:			

The Department does not change names on water right certificates. This form will be placed in the file for future reference only. If mailed, the Department will not provide acknowledgment of receipt.

This form can be mailed to the address above or sent by email to [wrd\\_dl\\_customerservice@water.oregon.gov](mailto:wrd_dl_customerservice@water.oregon.gov)



# Oregon

Tina Kotek, Governor

## Oregon Water Resources Department

District 14 Watermaster's Office

700 NW Dimmick Street

Grants Pass, OR 97526

541-476-1288

OWRD.District14@water.oregon.gov

RECEIVED

APR 03 2023

OWRD

March 6, 2023

69255 Houser Depot Road  
North Bend, OR 97459

RE: Map Identification: Township 24.00S, Range 13.00W, Section 10 NWSE, Tax Lot 500

To Whom It May Concern:

A water right research was conducted for the above stated parcel(s) per your request. Findings indicate the following water rights of record are pertinent to the tax lot(s) as described in the table below:

Tax Lot	Certificate	Priority Date	Use	Rate
500	C-11894	November 18, 1931	Irrigation	7 acre feet per acre throughout the year not to exceed .75 acre foot per acre in a month
<b>Primary Source:</b> Beale Lake				
<b>Point of Diversion</b> NW 1/4 SE 1/4, Section 10, Township 24 South, Range 13 West, W.M.				
<b>Place of Use:</b> 5 acres, NW 1/4 SE 1/4, Section 10, Township 24 South, Range 13 West, W.M.				

Tax Lot	Certificate	Priority Date	Use	Rate
500	C-11457	March 2, 1932	A right to store water for the purpose of irrigation under permit No. 10549 (C-11472)	Max storage under C-11457 is 66 acre feet
<b>Primary Source:</b> Eagle Lake Creek				
<b>Point of Diversion</b> SE 1/4 SW 1/4, Section 10, Township 24 South, Range 13 West, W.M. (See water right map)				
<b>Place of Use:</b> Section 10, Township 24 South, Range 13 West, W.M. (Reservoir appears to be associated with more than one parcel)				

STATE OF OREGON  
COUNTY OF COOS  
**CERTIFICATE OF WATER RIGHT**

**This Is to Certify, That** CHAS. A. and VERA S. WICKS  
of Hauser, State of Oregon, has made proof  
to the satisfaction of the STATE ENGINEER of Oregon, of a right to the use of the waters of  
Seale Lake  
a tributary of \_\_\_\_\_ for the purpose of  
Irrigation  
under Permit No. 10441 of the State Engineer, and that said right to the use of said waters  
has been perfected in accordance with the laws of Oregon; that the priority of the right hereby  
confirmed dates from November 18, 1931;

that the amount of water to which such right is entitled and hereby confirmed, for the purposes  
aforesaid, is limited to an amount actually beneficially used for said purposes, and shall not exceed  
7 acre-feet per acre throughout the year, measured at the point of diversion,  
and shall be further limited to not to exceed 0.75 acre-foot per acre in any one  
calendar month,

or its equivalent in case of rotation.

The point of diversion is located in the NW $\frac{1}{4}$ SE $\frac{1}{4}$ , Section 10, Township 24 South, Range  
13 West, W. M.

The amount of water used for irrigation, together with the amount secured under any other  
right existing for the same lands, shall be limited to \_\_\_\_\_ of one cubic foot per second  
per acre,

and shall  
conform to such reasonable rotation system as may be ordered by the proper state officer.

A description of the place of use under the right hereby confirmed, and to which such right  
is appurtenant, is as follows:

5 acres in the NW $\frac{1}{4}$ SE $\frac{1}{4}$ ,  
Section 10,  
Township 24 South, Range 13 West, W. M.

The right to the use of the water for the purposes aforesaid is restricted to the lands or place of  
use herein described.

After the expiration of fifty years from the date of this certificate or on the expiration of any  
federal power license issued in connection with this right, and after not less than two years' notice in  
writing to the holder hereof, the State of Oregon, or any municipality thereof, shall have the right to  
take over the dams, plants and other structures and all appurtenances thereto which have been con-  
structed for the purpose of devoting to beneficial use the water rights specified herein, upon condition  
that before taking possession the State or municipality shall pay not to exceed the fair value of the  
property taken, plus such reasonable damages, if any, to valuable, serviceable and dependable prop-  
erty of the holder of this certificate, not taken over, as may be caused by the severance therefrom of  
the property taken in accordance with the provisions of section 47-508, Oregon Code 1930.

WITNESS the signature of the State Engineer, affixed

this 16th day of December, 1937.

CHAS. E. STRICKLIN  
State Engineer

Recorded in State Record of Water Right Certificates, Volume 11, page 11894

RECEIVED

APR 03 2023

OWRD

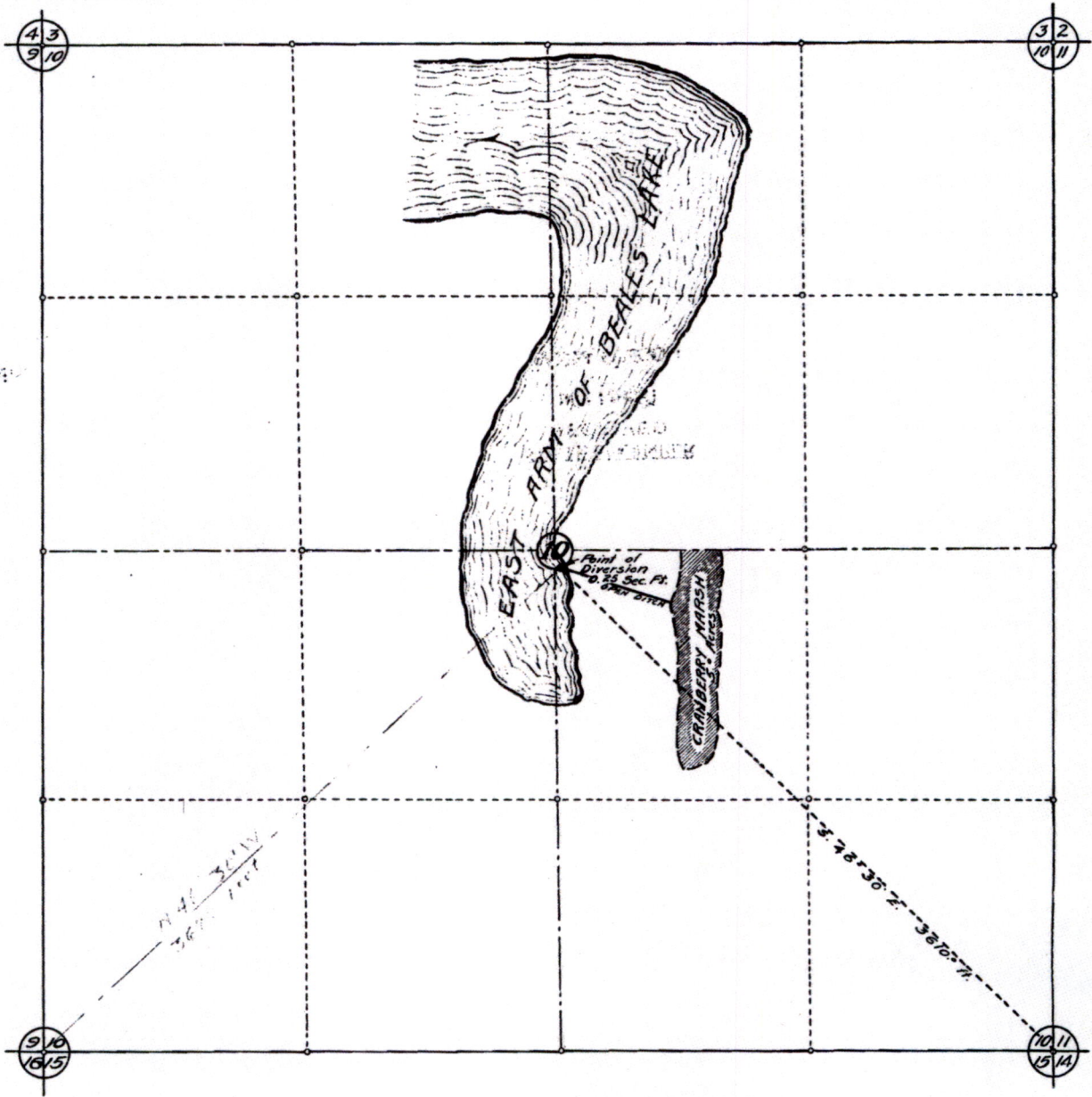
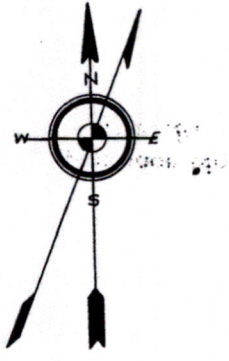

Application No. 14424  
Permit No. 10441

STATE ENGINEER  
RECEIVED  
NOV 1 1931  
EAST OREGON

I, C. F. Bessee, of Marshfield, Oregon, do hereby certify that this map was made from notes taken during an actual survey made by me on the 14<sup>th</sup> day of November, 1931, and that it correctly represents the point of diversion and the approximate shore line of the East arm of Beale's Lake.

C. F. Bessee.

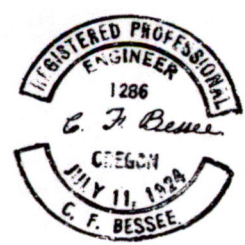

PLAN ACCOMPANYING APPLICATION OF  
THOS S. SMALL  
FOR RIGHT TO APPROPRIATE WATER  
FROM BEALE LAKE  
IN NW 1/4 SE 1/4 SECTION 10, TP. 24 S., R. 6.13 W., WM.  
SCALE: 1 INCH = 500 FEET.

RECEIVED  
APR 08 2023  
OWRD