

RECEIVED

MAY 08 2023

OWRD

RECEIVED

DEC 21 2020

OWRD



Reservoir Application
Glover
T.26S R.7W Section 13
Douglas County
Scale: 1"=400'

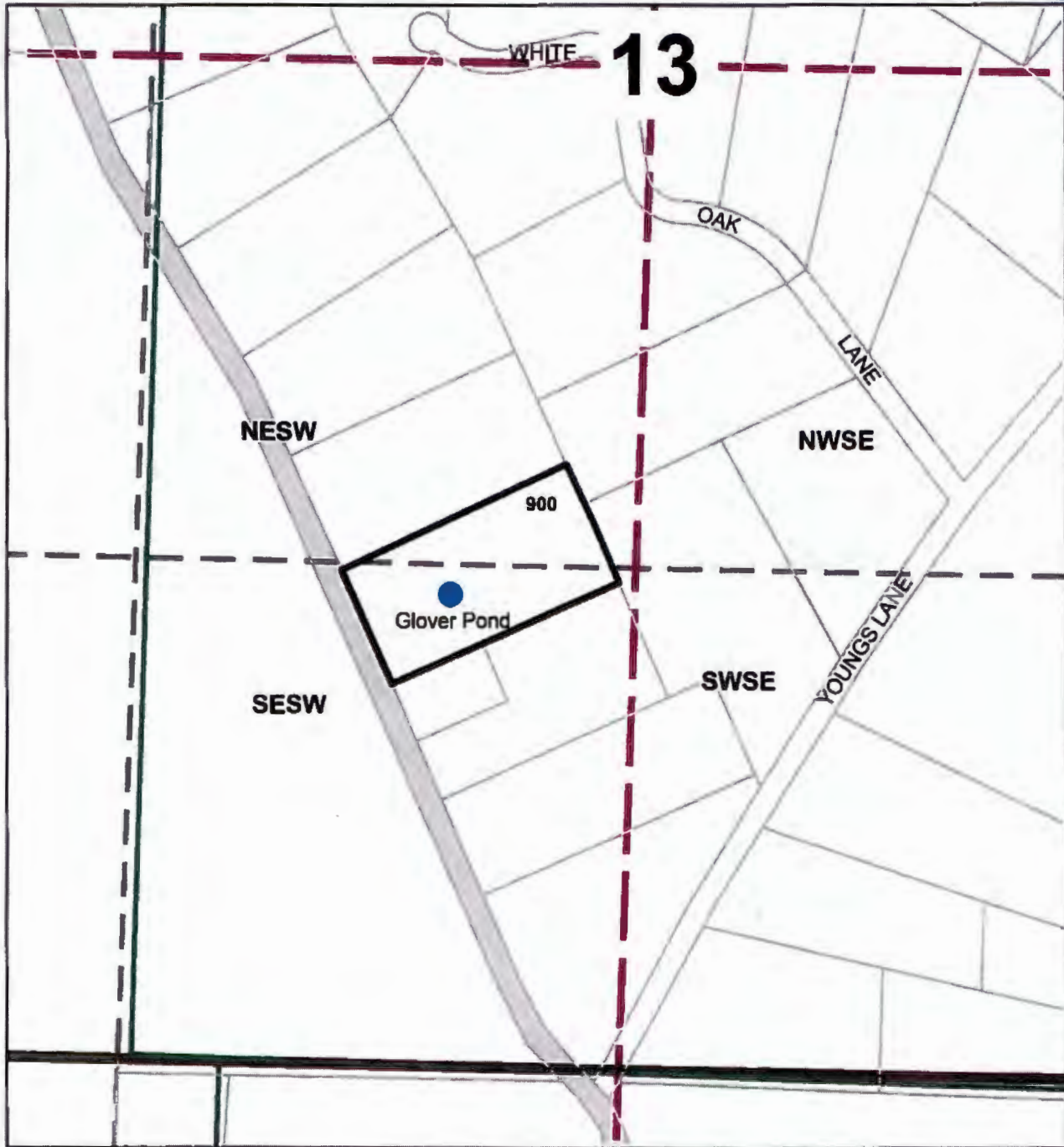

Pond is located 1416 ft South and 472 ft West of the Center of Section 13

The purpose of this map is to identify
the location of a water right.
Not intended to show property ownership.