

ASSIGNED

Name Ralph J. Lane
By P.O. Box 268
Address Shady Cove, Oregon

Application No. R-22412
Permit No. R-879
Certificate No. 29363

Stream Index, Page No. 15-78F

FEEES PAID

Date	Amount	Receipt No.
4/9/47	6.50	2778
"	0.10	2778
1/12/62	\$1 Cert. Fee	32368

Date filed April 7, 1947
Priority April 7, 1947
Action suspended until OK List

See Application No. 22413

FEEES REFUNDED

Date	Amount	Check No.

Returned to applicant
Date of approval July 3, 1947

ASSIGNMENTS

Date	To Whom	Address	Volume	Page
6-24-52	ASSIGNED Thomas N. Hanson	General Delivery, Shady Cove, Ore	3	652
5-31-61	HAROLD BIDDLE	P.O. BOX 236 SHADY COVE, ORE.	4	348

CONSTRUCTION

Date for beginning July 3, 1948
Date for completion October 1, 1949
Extended to
Date for application of water October 1, 1950
Extended to 10-1-55

REMARKS

The right herein granted is limited to the construction of Lane and Shepherd Reservoirs and the storage of (No. 1-8.4, No. 2-8.8) a. f. of water from East Branch of Long Branch to be appropriated under App No. 22413, Permit No. 17905 for irrigation.

JUL 6 1948 CARD FOR A

OCT 4 1949 CARD FOR B

OCT 3 1955 CARD FOR B

PROSECUTION OF WORK

Form "A" filed Oct 2, 1949
Form "B" filed October 21, 1949
Form "C" filed

FINAL PROOF

Blank mailed AUGUST 31 1961
Proof received
Date certificate issued JANUARY 31 1962

W.R.I.S.	
Assembled	<u>9.3.85</u> by <u>JG</u>
Entered	_____ by _____
Verified	_____ by _____

NOTICE OF BEGINNING OF CONSTRUCTION

I, Ralph J. Lane, the holder of Permit No. R-879 to appropriate the public waters of the state of Oregon, began the actual construction of the works described therein on the 1st day of August, 1947.

Remarks: 2 men, D7 Catterpillar Dozer. The appropriator should state the manner of beginning construction work, number of men employed, the amount of work completed

up to the date of this statement, and any additional information which may tend to show the beginning of work in good faith.

IN WITNESS WHEREOF, I have hereunto set my hand this 20 day of October, 1949

Ralph J. Lane (Signature of Applicant)

Shady Cove, Oregon (Address)

Fill out, detach, and mail to the State Engineer, Salem, Oregon, when construction work is begun.

STATE PRINTING DEPT.

NOTICE OF COMPLETION OF CONSTRUCTION

I, Ralph J. Lane, the holder of Permit No. R-879 to appropriate the public waters of the state of Oregon, completed the construction of the works described therein on the 1st day of October, 1947.

Remarks: Porous bottom, to be sealed with clay. If the works have less capacity than described in the permit, or you have definitely abandoned part of the proposed development, you

should so state in order that our records may not be unnecessarily encumbered.

IN WITNESS WHEREOF, I have hereunto set my hand this 20 day of October, 1949

Ralph J. Lane (Signature of Applicant)

Shady Cove, Oregon (Address)

Fill out, detach, and mail to the State Engineer, Salem, Oregon, when construction work is completed.

T.34 S.R.1 & 2 W.W.M.

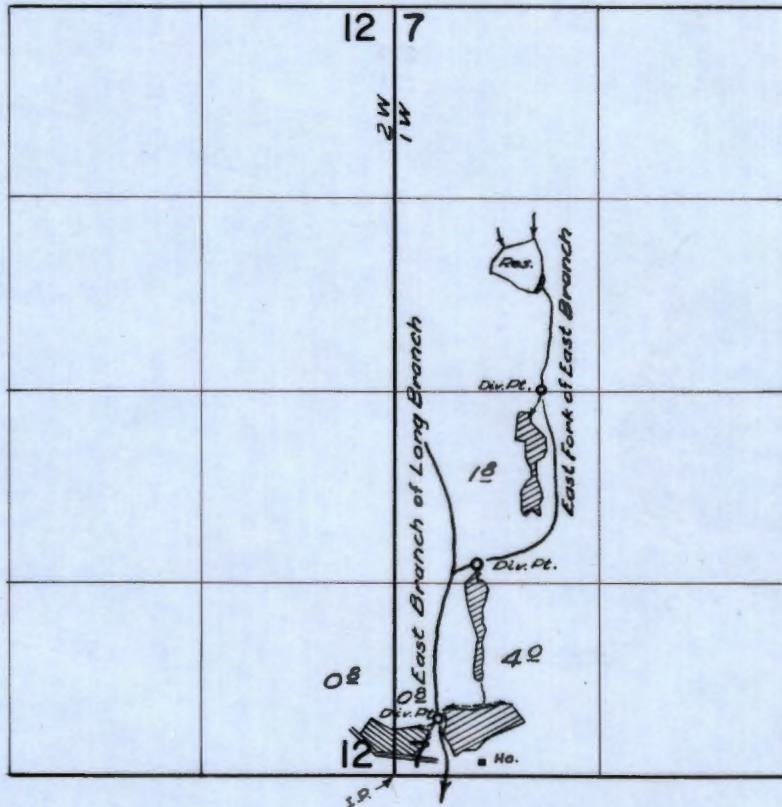

FINAL PROOF SURVEY
UNDER

Application No. 22413 Permit No. 17705
R-22412 R-879
IN NAME OF

.....
Surveyed 14 APRIL 1960, by McBish

January 9, 1962

David C. Hendrix
Watermaster, District 13
County Courthouse
Medford, Oregon

Dear Mr. Hendrix:

On behalf of Harold Biddle, you submitted an assignment of Permits numbered R-879 and 17705, which we acknowledged June 16, 1961. On August 31, 1961 we sent him copies of the drafts of the proposed certificates for signature which were not returned, and on October 2, 1961 we mailed a reminder letter. On November 2, I sent a certified letter stating that the permits would be cancelled unless the proofs were submitted within 60 days from the date of this letter. This was returned by the Post Office marked "Unclaimed."

Would you please check the county records for ownership? If Mr. Biddle still owns property, we will cancel the permits. If this property has changed hands, I probably will write to the new owner.

You will probably recall making an inspection of this to determine whether or not water was used for domestic and stock purposes after Myron Bish made the final proof survey. I am enclosing a print of the final proof survey map for location.

Very truly yours,

LEWIS A. STANLEY
State Engineer

By
Trevor Jones, Assistant

TJ:jh
Enc.

516 Public Service Building
November 2, 1961

Harold Biddle
P. O. Box 236
Shady Cove, Oregon

Dear Mr. Biddle:

According to the terms of your Permit No. R-879 which is for the appropriation of 5.0 acre feet per second from East Fork of the East Branch of Long Branch for irrigation and Permit No. 17705 which is for the appropriation of 0.09 cubic foot per second of water from East Branch of Long Branch and East Fork of East Branch and reservoir for irrigation, complete use of water was to have been made on or before October 1, 1955.

On August 31, 1961 the draft copies of the proposed certificates in connection with Permit Nos. R-879 and 17705 were mailed to you together with the instructions to sign the certificates under "Final Proof" and return them to this office together with the statutory fee of \$1 each.

On October 2, 1961 a reminder letter calling this to your attention was mailed. To date, we have not received either the drafts or any correspondence regarding them.

ORS 537.260 provides: "Whenever the time within which any appropriation under a permit should have been perfected has expired and the owner of the permit fails or refuses within three months thereafter to submit to the State Engineer proof of completion of the appropriation as required by ORS 537.230 and 537.250, the State Engineer may, after 60 days' notice by registered mail, order the cancellation of the permit.---"

In accordance with the provisions of ORS 537.260, you are hereby notified that unless we receive the signed drafts of the certificates and the recording fees within 60 days from the date of this letter, your permits will be cancelled without further notice.

Very truly yours,

LEWIS A. STANLEY
State Engineer

By
Trevor Jones, Assistant

TJ:jh
CERTIFIED - RETURN RECEIPT
REQUESTED

October 2, 1961

Harold Biddle
P.O. Box 236
Shady Cove, Oregon

Dear Mr. Biddle:

On August 31, 1961, we mailed you copies of drafts of the certificates in connection with the incomplete water rights represented by Permits numbered R-879 and 17705 together with the instructions that the statement at the bottom of each page under "Final Proof" be signed and the copies returned to this office accompanied by the certificate recording fees, in the amount of \$2.

To date these forms have not been received nor has any correspondence regarding reasons for not returning them been received. This is to notify you that unless we receive the signed final proof forms and the certificate recording fees or a request for additional time within thirty days from the date of this letter, we will be required to take steps toward the cancellation of these permits.

Very truly yours

LEWIS A. STANLEY
State Engineer

By Trevor Jones, Assistant

TJ:jh

June 16, 1961

Mr. David C. Hendrix
Watermaster District No. 15
Courthouse
Medford, Oregon

Dear Mr. Hendrix:

The assignment of permits Nos. R-879 and 17705 from Thomas N. Hanson to Harold Biddle has been recorded in the records of this office and is enclosed, together with our receipt No. 29866 covering the statutory fee you submitted in the amount of \$1.

Very truly yours,

LEWIS A. STANLEY
State Engineer

By
Trevor Jones, Assistant

eh

enclosures

May 26, 1961

Mr. Harold Biddle
P. O. Box 236
Shady Cove, Oregon

Dear Mr. Biddle:

On February 16 and on March 23, 1961, I wrote you regarding the advisability of obtaining an assignment of permits numbered 17705 and R-879 from Thomas H. Hanson to you if you desire to retain the right. This has not yet been submitted, so we are preparing the proof forms and will mail them to Mr. Hanson for signature. Failure on his part to return them will result in the loss of the right.

Very truly yours,

LEWIS A. STANLEY
State Engineer

By
Trevor Jones, Assistant

TJ:kr

March 23, 1961

Mr. Harold Biddle
P. O. Box 236
Shady Cove, Oregon

Dear Mr. Biddle:

On February 16, 1961 we wrote you regarding the necessity of obtaining an assignment of permits numbered R-879 and 17705 if you wished to retain the water rights described. To date the assignments have not been submitted nor any correspondence regarding them. If you wish to retain the rights and are not able to locate Mr. Thomas N. Hanson you should so notify us.

If further information is required you could contact Mr. David C. Hendrix, Water Master, Dist. No. 15, at the Court House in Medford.

Very truly yours,

LEWIS A. STANLEY
State Engineer

By
Trevor Jones, Assistant

TJ:kr

February 16, 1961

Mr. Harold Biddle
P. O. Box 236
Shady Cove, Oregon

Dear Mr. Biddle:

Permit Number R-879 describes the construction of two reservoirs and storage of water from East Branch of Long Branch and Permit Number 17705 describes the appropriation of water from East Branch of Long Branch for irrigation. These permits are in the name of Thomas N. Hanson.

We understand that Mr. Hanson deeded the property to Troy and Ann Haynie and Mr. Haynie deeded the property to you. If this is true and Mr. Hanson has no interest in the property you should obtain an assignment of the permits and submit it to this office for recording, if you wish to retain the rights represented by the permits.

I believe Mr. Hanson's address is 355 Garfield Street, Ashland, Oregon.

A simple assignment form is enclosed for your use. If you are not able to obtain the assignment and desire to retain the rights you should so notify us.

Very truly yours,

LEWIS A. STANLEY
State Engineer

By
Trevor Jones, Assistant

TJ:vaf

Enclosure

January 22, 1957

Mr. Thomas N. Hanson
General Delivery
Shady Cove, Oregon

Dear Mr. Hanson:

According to the terms of your Permit No. R- 879, which is for the storage of 17.21 acre-feet of water from Lane and Shepherd Reservoirs, completion of construction was to have been made on or before October 1, 1955. It appears from our records that you have failed to submit notice of completion of construction, although a notice, calling this matter to your attention, was mailed to you on October 3, 1955.

ORS 537.260 provides: "Whenever the time within which any appropriation under a permit should have been perfected has expired and the owner of the permit fails or refuses within three months thereafter to submit to the State Engineer proof of completion of the appropriation as required by ORS 537.230 and 537.250, the State Engineer may, after 60 days' notice by registered mail, order the cancelation of the permit.***"

If you have complied with the terms of this permit, you should submit promptly this notice of completion of construction, after which we will take up the matter of final proof. If, however, you have abandoned your plan of development, we would appreciate having you advise to that effect, so that the permit may be canceled without the necessity for following the legal procedure.

In accordance with the provisions of ORS 537.260, you are hereby notified that unless proof of completion of the appropriation is received within 60 days from the date of this letter, your permit will be canceled without further notice.

Very truly yours,

Lewis A. Stanley

LEWIS A. STANLEY
State Engineer

Form 100R
REGISTERED
Return receipt requested

January 20, 1956

Mr. Thomas Hanson
Shady Cove, Oregon

Dear Mr. Hanson:

In response to your letter please be advised that Permit No. R-879 which was assigned to you from Ralph J. Lane granted the right to the construction of Lane and Shepherd Reservoirs and storage therein of 8.4 acre feet from Number 1 and 8.81 acre feet from Number 2 from East Branch of Long Branch. Permit No. 17705 granted the right to appropriate not to exceed 1.0 second foot from East Branch of Long Branch and East Fork of East Branch and reservoir for irrigation of 78 acres of land within Sections 7, 12 and 18, Township 34 South, Ranges 1 and 2 West.

The right was limited to 0.51 second foot from East Branch of Long Branch and 0.49 second foot from East Fork of East Branch and the two reservoirs.

I am enclosing a print of the map filed with the applications. It is not necessary that you have copies of the permits; however, they can be prepared and mailed to you upon receipt of your request and fees in the amount of \$2.

If you have completed the project as set out or completed it insofar as you believe practical, then you should fill out the enclosed Forms B and C and return them to this office so that the matter of final proof may be given consideration.

Very truly yours,

LEWIS A. STANLEY
State Engineer

By
Chris L. Wheeler, Assistant

CLW:ch

enc. 3

R-22,12
& 22,13

February 4, 1954

•Thomas N. Hanson
P. O. Box 31
Shady Cove, Oregon

Dear Mr. Hanson:

This acknowledges receipt of your application for an extension of time for the completion of construction and complete application of water under Permit No. R-879 & 17705 in the name of **Thomas N. Hanson.**

The application indicates that reasonable diligence has been shown in the prosecution of work under this project, and the time limits are being extended to October 1, 19 **55.**

Yours very truly,

Chas. E. Stricklin

CHAS. E. STRICKLIN
State Engineer

Form #122

Enclosed is our Receipt No. 938 covering fees submitted.

RECEIVED
FEB 1 1954
STATE ENGINEER
SALEM, OREGON

Application No. R-22412

Permit No. R-879

Application for Extension of Time

To the State Engineer of Oregon:

I, THOMAS N. HANSON, of P.O. BOX 31 SHADY COVE, state of OREGON, am the owner and holder of Permit No. R-879, to appropriate the public waters of the state of Oregon.

Under the terms and conditions of said permit, construction work is required to be completed on or before OCTOBER 1, 1953, and complete application of water is required to be made on or before OCTOBER 1, 1953

I have heretofore done the following work described under said permit: I have constructed #2 Reservoir - but still intend to do some more work on the fill. #1 Reservoir has been constructed twice but still leaks through bottom. I intend to construct a new cut-off wall on #1 Reservoir when the dam is dry.

costing \$2500⁰⁰_{xx}, and I estimate the cost of completion to be \$1500⁰⁰_{xx}

I have heretofore used water under said permit to the following extent: _____

I am unable to { complete construction work } within the required time, for the following reasons, to wit: because of insufficient time and because #1 Reservoir still leaks through bottom

(Strike out phrase not applicable)

(If additional space is required, attach separate sheet)

(The fee provided by law in the amount of \$2.00 for filing an application for an extension of time should accompany the application for extension.)

(OVER)

Ex. sent to 55 (copy & app)

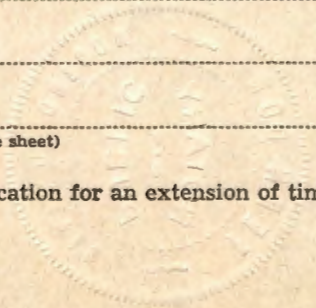

WHEREFORE, I ask that the State Engineer extend the time for the

{ completion of construction work } under said permit to OCTOBER 1, 1955
~~complete application of water~~
(Strike out phrase not applicable)

AFFIDAVIT OF APPLICANT

STATE OF Oregon }
County of Jackson } ss.

I, Thomas N. Hanson, being first duly sworn, depose and say that I have read the above and foregoing application for extension of time; that I know the contents thereof, and the facts stated therein are true.

IN WITNESS WHEREOF, I have hereunto set my hand this 4th day of January, 1954

Thomas N. Hanson

Subscribed and sworn to before me this 4th day of January, 1954.

[Notarial Seal]

Gern Dow
Notary Public for Oregon

My commission expires MY COMMISSION EXPIRES OCT. 7, 1957

November 7, 1952

Mr. Thomas N. Hanson
General Delivery
Shady Cove, Oregon

Dear Mr. Hanson:

This will acknowledge receipt of your letter of October 28, 1952, regarding the completion of the project outlined under permit No. R-879, and No. 17705,

If all of the work under permit No. 17705 has been completed and all of the land set out in the permit irrigated, you should file a notice of that fact by filling out and mailing in the enclosed form C.

If all of the land has not been irrigated you may file an application for an Extension of Time in which to complete application of the water using the enclosed form. The application should be executed before a Notary Public and mailed to this office, together with the statutory fees in the amount of \$2.

Very truly yours,

CHAS. E. STRICKLIN
State Engineer

By
Chris L. Wheeler, Assistant

CLW:mb

Enc.

R-22412
22413

June 25, 1952

Mr. Ralph J. Lane
P. O. Box 268
Shady Cove, Oregon

Dear Mr. Lane:

This will acknowledge receipt of an assignment of the water rights evidenced by Permit No. R-879 and Permit No. 17405 to Thomas N. Hanson by Ralph J. Lane, and currency in the amount of \$1.00, for which our receipt no. 14857 is enclosed.

Pursuant to your request, the assignment has been recorded in the Miscellaneous Records of the State Engineer and is enclosed.

Yours very truly

CHAS. E. STRICKLIN
State Engineer

By
Chris L. Wheeler, Assistant

CLW,ls
Encl.

R-22412

22413

February 5, 1951

Mr. Ralph J. Lane
P. O. Box 268
Shady Cove, Oregon

Dear Mr. Lane:

This acknowledges receipt of your application for an extension of time for the completion of construction and complete application of water under Permit No. 17705 in the name of Ralph J. Lane.

The application indicates that reasonable diligence has been shown in the prosecution of work under this project, and the time limits are being extended to October 1, 1951 .

Very truly yours,

Chas. E. Stricklin

CHAS. E. STRICKLIN
State Engineer

dlh
Form 122

P. S. Our Receipt No. 11553 in the amount of \$2.00 is enclosed to cover the statutory fees.

Enc: Receipt No. 11553

R-22412
22413

January 10, 1951

Mr. Ralph J. Lane
P.O. Box 268
Shady Cove, Oregon

Dear Mr. Lane:

This will acknowledge receipt of a report of completion of construction under your Permit No. 17705.

According to the terms of your permit, all of the land described in the permit which it is intended to irrigate at any time should have been actually irrigated on or before October 1, 1950.

If water was completely applied as above, it should be so reported by filling out and mailing to this office the enclosed Form C.

If water was not completely applied as above, an application for an extension of time should be executed before a notary public on the enclosed form and submitted to this office with the statutory \$2.00 filing fee.

Very truly yours,

CHAS. E. STRICKLIN
State Engineer

Ed K. Humphrey, Assistant

EKH:mrh
Enc. - Form C
Extension Form

October 27, 1949

Mr. Ralph J. Lane
P. O. Box 268
Shady Cove, Oregon

Dear Mr. Lane:

This will acknowledge receipt of reports of beginning of construction and completion of construction under your Permit No. R-879, granting a right to construct a reservoir and store water.

According to the terms of your secondary permit No. 17705, granting a right to appropriate the stored water, construction should have been completed on or before October 1, 1949 and if it was so completed it should be so reported by filling out and mailing to this office the enclosed Form B. If construction preparatory to the use of water as proposed was not completed on or before October 1, 1949, an application for an extension of time executed before a notary public on the enclosed blank should be submitted to the State Engineer with the statutory \$2.00 filing fee.

Very truly yours,

CHAS. E. STRICKLIN
State Engineer

By
Ed K. Humphrey, Assistant

EKH:PN
ENCL.

R-22412

Mr. Ralph J. Lane
P. O. Box 268
Shady Cove, Oregon

July 3, 1947

Dear Mr. Lane:

Herewith you will find Application No. R-22412, Permit
No. R-879, together with blueprint.

R-22412
22413

April 29, 1947

Mr. Ralph J. Lane
P. O. Box 268
Shady Cove, Oregon

Dear Mr. Lane:

This will acknowledge receipt of your letter transmitting check in the amount of \$1.20, to cover the balance due in fees in connection with Applications No. R-22412 and No. 22413. Our Receipt No. 2874 is inclosed.

In answer to your question, fees for the two applications are computed as follows:

Application No. R-22412	
Examination	\$ 5.00
Recording	1.00
Blueprint	.10
Application No. 22413	
Examination	5.00
Recording domestic and stock	5.00
Recording 78 acres at 15 cents	<u>11.70</u>
Total	\$27.80

Very truly yours,

CHAS. E. STRICKLIN
State Engineer

By
E. K. Humphrey, Assistant

EKH:BN

B-22412
22413

April 14, 1947

Mr. Clinton A. Smith, Watermaster
District No. 15
Medford, Oregon

Dear Mr. Smith:

This will acknowledge receipt of your letter of April 4 with which you enclosed an application for a permit to construct reservoirs and store water and your application for a permit to appropriate water, both in the name of Ralph J. Lane, together with fees in the amount of \$26.50 for which our Receipt No. 2778 is enclosed.

The applications have been filed and given No. B-22412 and No. 22413 respectively. They appear to be in order and will be placed in line for approval and issuance of permits upon receipt of the balance due in fees which, as I compute them, amounts to \$1.20.

Yours very truly,

CHAS. E. STRICKLIN
State Engineer

By
Ed K. Humphrey, Assistant

EKH:CI
Enc.

RECEIVED
JAN 15 1962
STATE ENGINEER
SALEM, OREGON

STATE OF OREGON

COUNTY OF JACISON

CERTIFICATE OF WATER RIGHT

This Is to Certify, That **HAROLD BIDDLE**

of **PO. Box 236, Shady Cove**, State of **Oregon**, has made proof

to the satisfaction of the STATE ENGINEER of Oregon, of a right to store the waters of

East Fork of East Branch of Long Branch, tributary of Rogue River, appropriated under Application 22413, Permit 17705

for the purposes of **irrigation**

under Reservoir Permit No. **R-879** of the State Engineer, and that said right to store said waters has been perfected in accordance with the laws of Oregon; that the priority of the right hereby confirmed dates from **April 7, 1947**

that the amount of water entitled to be stored each year under such right, for the purposes aforesaid, shall not exceed **5.0 acre feet**

The reservoir is located in **SW 1/4 NW 1/4, Section 7, T. 34 S., R. 1 W., W. H.**

THIS IS A DRAFT OF A WATER RIGHT CERTIFICATE

See other side for instructions and final proof to be executed by permittee.

STATE OF OREGON
STATE ENGINEER
WATER RESOURCES DEPARTMENT
SALEM

251 FINANCE BUILDING
170 12TH STREET S.E.

REFER TO
FILE No. R-22412

Harold Biddle
P. O. Box 236
Shady Cove, Oregon

Dear Mr. Biddle:

On the reverse side of this paper is a copy of a draft of water right certificate to confirm the right under Permit No. R-879. You are requested to examine this draft and if you find it correctly describes the appropriation of water made, execute the following certificate. You should return this paper, along with a fee of \$1.00 for recording your water right certificate, when issued, in the office of the County Clerk.

Very truly yours,

LEWIS A. STANLEY
State Engineer

FINAL PROOF

I have read the draft of water right certificate shown on the reverse side of this paper and as final proof of appropriation of water I hereby certify that the water has been used as described in said draft.

1-11-62
(Date)

Harold Biddle
(Signature)

SECTION

7

TOWNSHIP 34S, RANGE 1W, W. M.

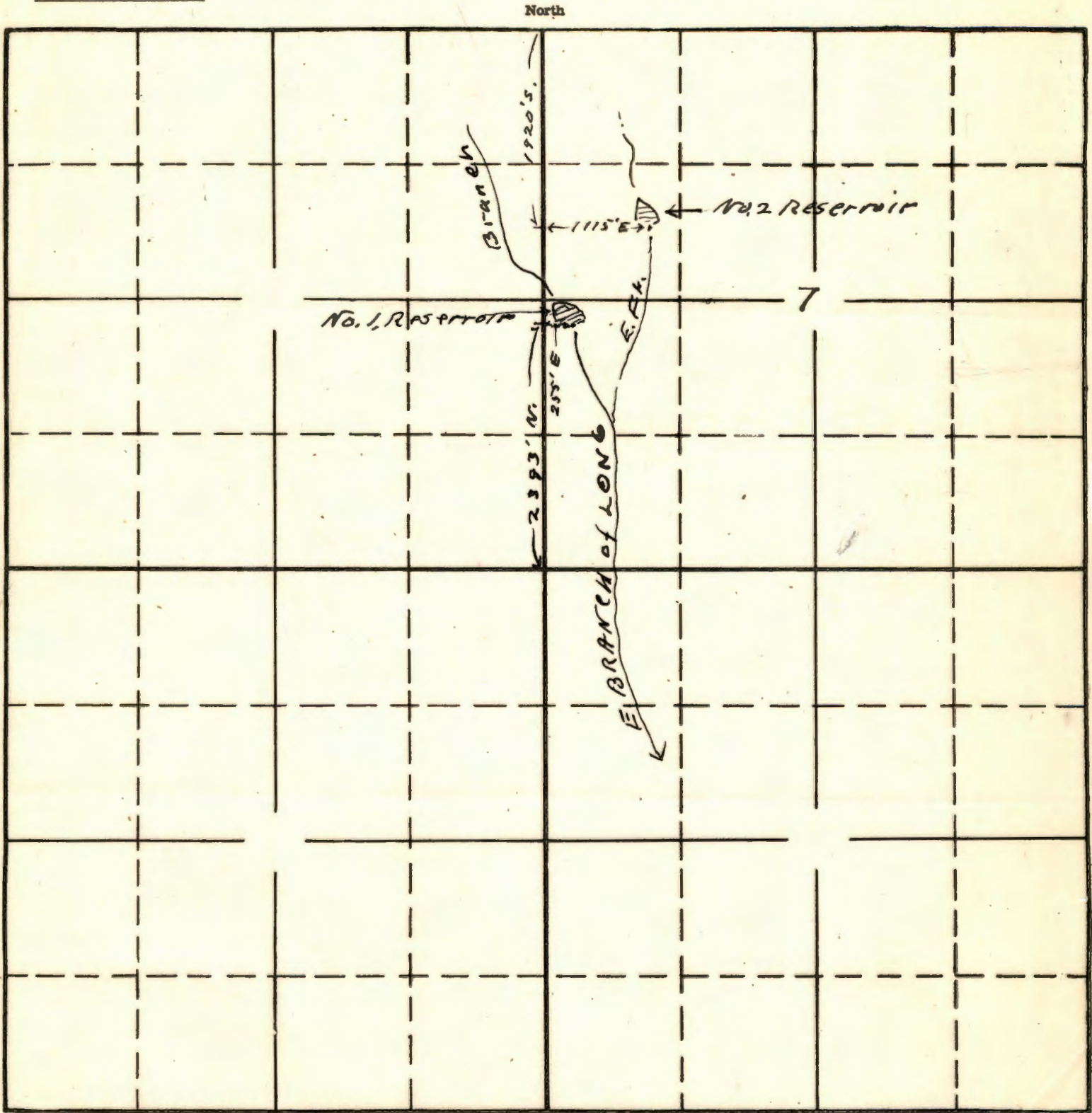

South

R-22412

15-78 F

Map to accompany application of Ralph J. Lane for storage purposes.

APPLICATION No.
PERMIT No.

This office 8/1/47 [Signature]

Permit No. R-879

Application No. R-22412

County Jackson

Proof of Appropriation of Water

Harold Biddle owner ← mail assign

P.O. Box 236
General Delivery

1. Name Thomas N. Hanson 2. Address P.O. Box 236, Shady Cove, Oregon

3. Source of supply East Branch of Long Branch

Tributary of Rogue River

4. Amount of water ~~#1 - 8.4 a.f. #2 - 8.8 a.f.~~ Priority date April 7, 1947

6. Use irrigation - ~~to be~~ appropriated under Application No. 22413, Permit No. 17705

7. Location of ^{dam} point of diversion ~~#1 - NW 1/4 SW 1/4~~ ~~#2 - SW 1/4 NW 1/4~~ Sec. 7, Twp. 34 S, Range 1 W, W. M.
(Legal Subdivision)

8. The description of land given below corresponds to that found in your permit covering land to be irrigated, or, if for other purposes, the place of use.

Township	Range	Section	Legal Subdivision	No. Acres Actually Irrigated
Willamette Meridian				
34S	1W	7	SW 1/4 NW 1/4	Res
			SURVEY REGARDLESS	
			To have been completed by 10-1-56	

1960-A
April 14 1960
M.B.

Not home
if possible will make appt.
April 12, 1960
M.B.

I have read the above and foregoing proof of appropriation of water; I know the contents thereof, and that the facts therein stated are true.

IN WITNESS WHEREOF, I have hereunto set my hand this day of

19.....

SUCCESS BOND
75% ACQUIT

REPORT OF PERSON MAKING INSPECTION

Description of works: Info - Mr. Biddle (owner)

Dam on East Branch of Long Branch is washed out
Dam was washed out previous to last yr. and was
refilled last yr. and washed out again - There was
no outlet pipe to use any stored water - Washed-
out section revealed dam had been built across logs
and limbs -

Res. on East Fork of East Branch of Long Branch
is a natural Pond that has been raised
approx. 4 to 5 ft. by a small earth dam
approx 25 ft long - Conduit size unknown
6 1/2 ft. of stored water can be used
water level 0.5 ft. below top of dam -

Spillway - ditch 1 x 1 x 0.5 deep

2.0 ac. S.A.
25
5 A.F.

~~Appl~~ Appl lists only East Branch
& 2nd lists both East Branch & ~~E.F.F.~~ E.F.F. of
E.Br. Appl map located #2 Res
correctly. Description of #2 Res being
partly natural pond agrees with report.

I, _____, do hereby certify that I have made
an inspection of the works described herein and in Permit No. R-879, on the 14 day
of April, 1960, and found the foregoing statements and descriptions of works to
be accurate. In my opinion the appropriation has been completed to the extent of _____
and I recommend the issuance of water right certificate for this amount. (Quantity of water in second-feet or acre-feet)

NOTICE TO INSPECTORS

If conditions do not justify the above re-
port by you, please return this form without
your signature, with a full report by letter.

Myron Bish
(Name)

(Title)