

**Township 36 S, Range 1 W, Section 30
NWNE & SWNE**

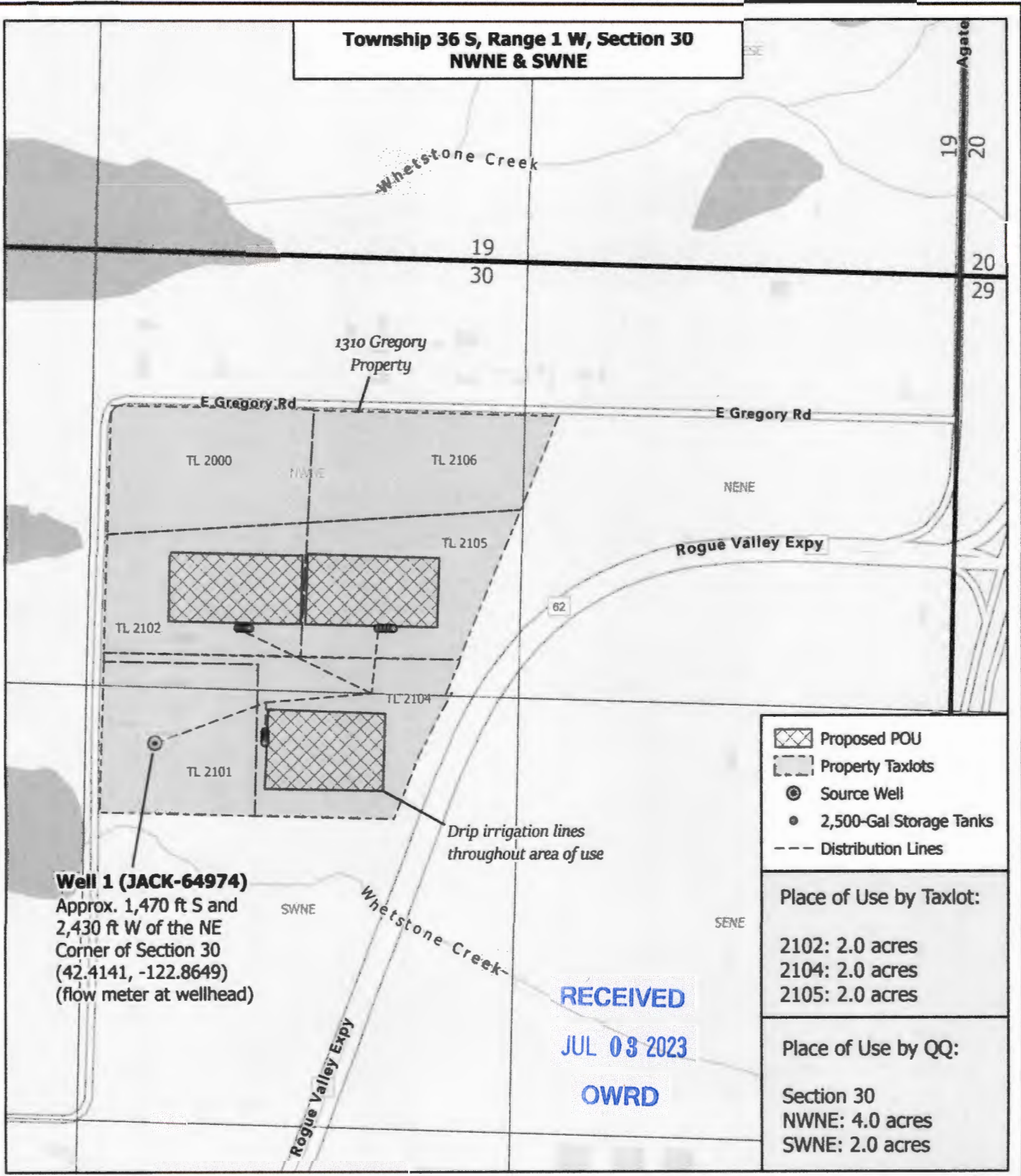

Well 1 (JACK-64974)
 Approx. 1,470 ft S and
 2,430 ft W of the NE
 Corner of Section 30
 (42.4141, -122.8649)
 (flow meter at wellhead)

*Drip irrigation lines
 throughout area of use*

- Proposed POU
- Property Taxlots
- Source Well
- 2,500-Gal Storage Tanks
- Distribution Lines

Place of Use by Taxlot:

2102: 2.0 acres
2104: 2.0 acres
2105: 2.0 acres

Place of Use by QQ:

Section 30
NWNE: 4.0 acres
SWNE: 2.0 acres

RECEIVED
JUL 03 2023
OWRD

CWM-H2O
 Complete Water Management



1319 SE MLK, Jr. Blvd, Suite 204
 Portland, Oregon 97214
 (503) 954-1326

**Application for a 2023 Drought
 Emergency Groundwater Use Permit**

1	DATE	AUTH	DRAFT
No.	Date	By	Revisions

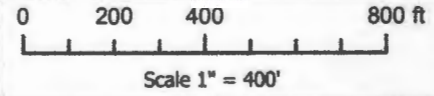

Proj#: 2118001
Sugar Tree Farm
 1310 Gregory, LLC
 1310 E. Gregory Road
 Central Point, OR, 97502

