

# Request for Assignment By Proof of Ownership (If Water Right Holder is Not Available)



Oregon Water Resources Department  
725 Summer Street NE, Suite A  
Salem, Oregon 97301-1266  
(503) 986-0900

If the Department determines that the application is incomplete, fees have not been paid, or the required documents are not acceptable, the application and all fees submitted will be returned to the applicant.

If for multiple rights, a separate form and fee for each right will be required.

RECEIVED  
JUL 03 2023  
OWRD

I, Kelly Farms Inc.

(Name of Party Requesting Assignment)

22111 River Rd NE

(Mailing Address)

Saint Paul, OR 97137

(City) (State) (Zip) (Phone #)

- hereby request assignment of an entire application/permit/transfer order /limited license/groundwater statement;
- hereby request assignment of a portion of application/permit/transfer order/limited license/groundwater statement;  
(You must include a map showing the portion of the application/permit/ transfer order /limited license/groundwater statement to be assigned.)

Application # \_\_\_\_\_; Permit # \_\_\_\_\_; Transfer Order # \_\_\_\_\_;

Limited License # \_\_\_\_\_; Groundwater Statement # GR-3299 ;

Kirk Brothers

(Name of Current Holder of Record)

Star Rt Box 63

(Mailing Address)

Newberg, OR 97132

(City) (State) (Zip) (Phone #)

**Note:** Write the initials (first letters) of your first and last names at the spots indicated below \_\_\_\_.

- 1) LWK I certify that I am the current owner of the property described in this application, permit, transfer order, limited license, or groundwater statement. I have attached proof of ownership that may include but not be limited to: a copy of the deed to the land, a copy of a land sales contract, a court order or decree, documentation of survivorship of property held jointly. The Department cannot accept a copy of a taxstatement.
- 2) LWK I have the legal right to request assignment under OAR 690-310-0280 and 690-320-0060.
- 3) LWK have not been able to contact the owner(s) of record for the above referenced transaction. I have attached proof acceptable to the Department that notice of the assignment has been given or attempted for each identified property owner not a party to the assignment. ORS 537.220(2) Failure to submit this proof will result in the return of your request. (Proof may include but not be limited to: a copy of returned certified mailing, copy of a Death Certificate, or a court order.)
- 4) LWK further certify that the information provided herein is true and correct to the best of my knowledge.

Witness my hand this 5 day of May, 20 23.  
(Day) (Month) (Year)

Signature of Party Requesting Assignment Larry W. Kelly

**Failure to provide any of the required information will result in the return of your application.**

This certifies assignment and record change at Oregon Water Resources Department effective 8:00 a.m. on date of receipt at Salem, Oregon.  
Fee receipt # 141083  
For Director by Mary F. Bjork, Program Analyst in Water Rights Division. MFB

The completed "Request for Assignment" form must be submitted to the Department along with the recording fee of \$120.

Part Assign by Proof - Approve  
LWK 7-7-2023

# T.4S. R.2W. Sec. 17, 18, 19 & 20, W.M.

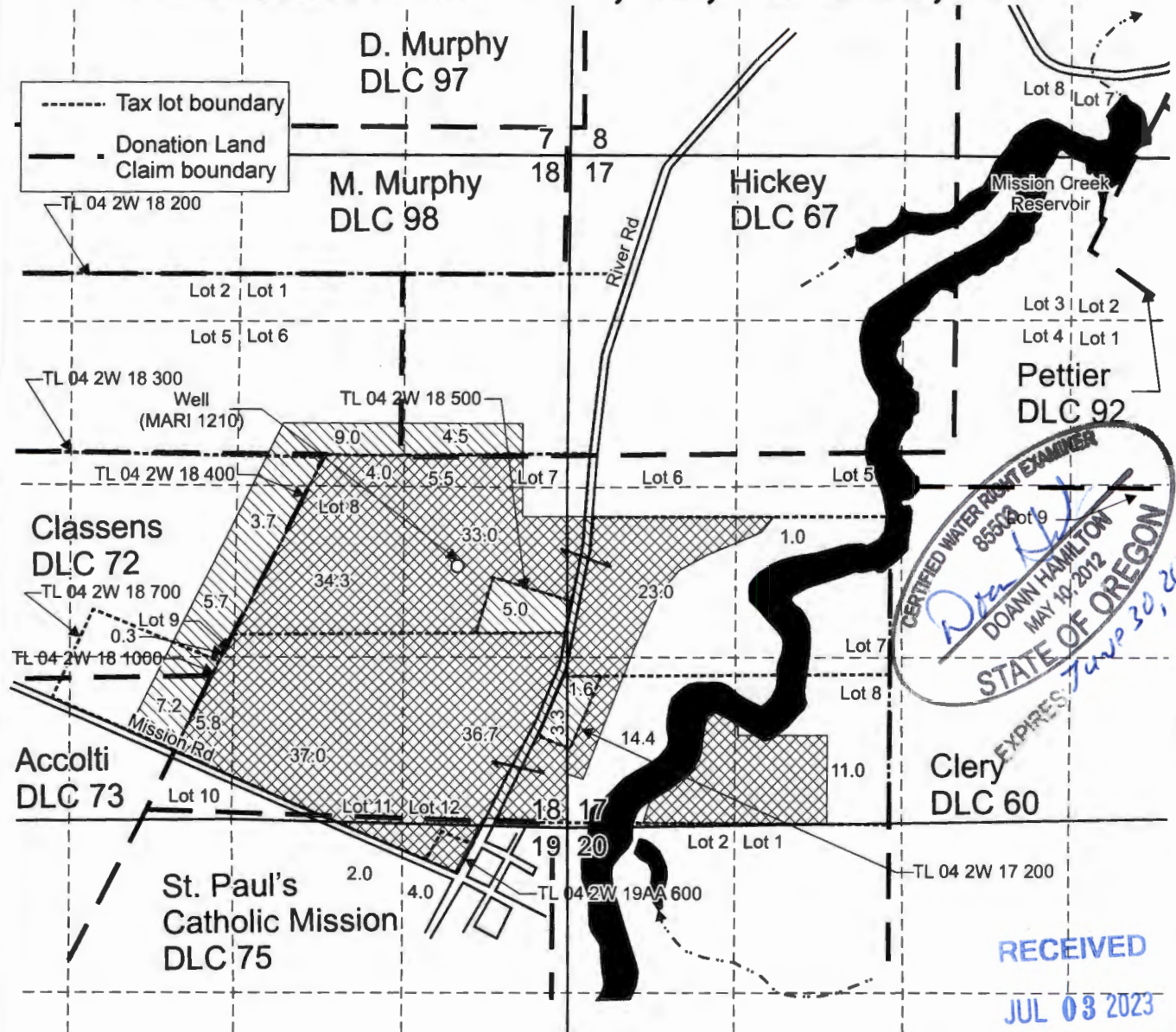

**CERTIFIED WATER RIGHT EXAMINER**  
 8550 of 9  
*Doann Hamilton*  
**DOANN HAMILTON**  
 MAY 19, 2012  
**STATE OF OREGON**  
 EXPIRES: *June 30, 2025*

**RECEIVED**  
**JUL 03 2023**

**OWRD**

Authorized Well (MARI 1210) is located 2,050 feet north and 910 feet west from the SE corner, Section 18.

- ▨ Area (40.0 Acres) primary irrigation under GR-3299, priority date 10-15-1954 to remain under Kirk Brothers.
- ▩ Area (212.0 Acres) primary irrigation under GR-3299, priority date 10-15-1954 to be assigned to Kelly Farms Inc.

----- Tax lot boundary      — Donation Land Claim boundary

This map was prepared for the purpose of identifying the location of a water right only and is not intended to provide legal dimensions or location of property ownership lines.

Pacific Hydro-Geology Inc.

05/2023

**Assignment Map**  
**GR-3299**  
 Kelly Farms, Inc.  
 T.4S. R.2W. Sec. 17, 18, 19, & 20, W.M.

KellyFarmsGR-3299AssignMap.cdr