

# T.2S., R.4E., W.M.

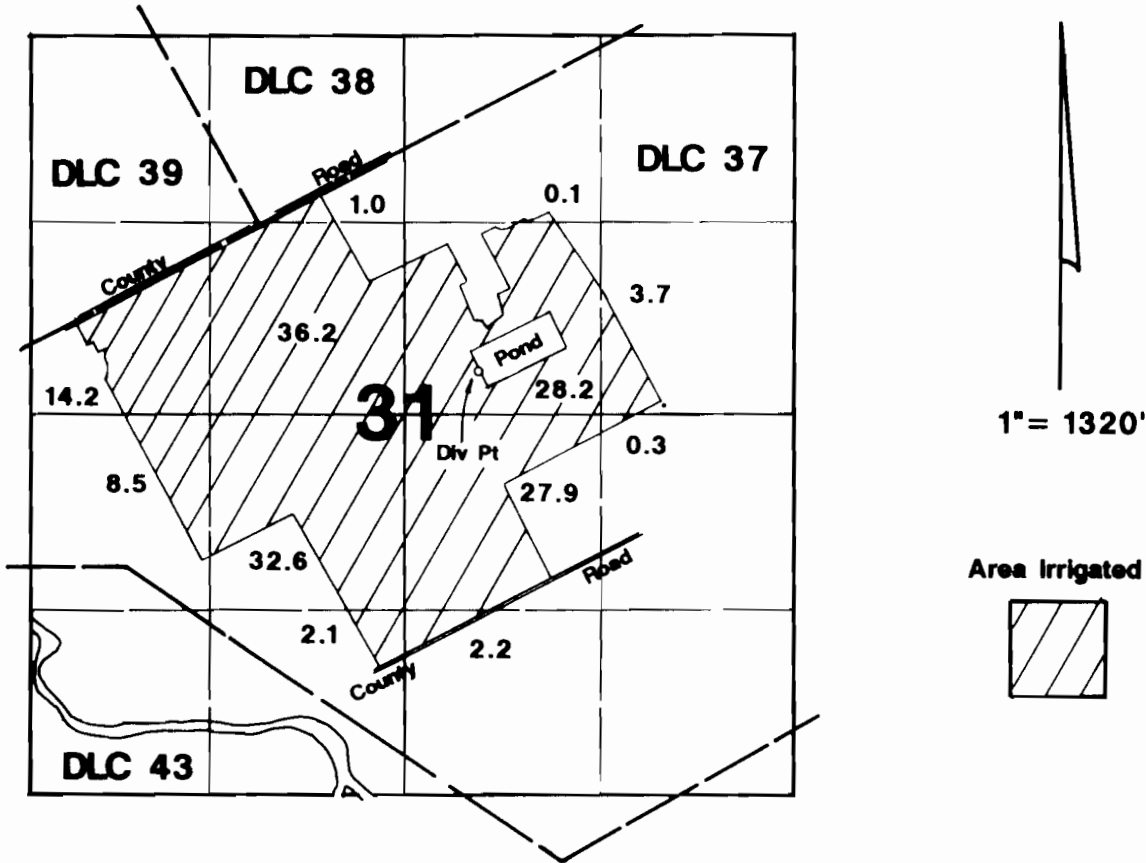

Div Pt (Pond) located 290'N & 500'E from center of Section 31.

## Final Proof Survey

Application: 70578  
70579

Permit: R-11353  
51196

In Name Of

### David Timm

Surveyed November 21, 1992 by Jim Grimm



THIS MAP WAS PREPARED FOR THE PURPOSE OF IDENTIFYING THE LOCATION OF A WATER RIGHT ONLY AND IS NOT INTENDED TO PROVIDE LEGAL DIMENSIONS OR LOCATION OF PROPERTY OWNERSHIP LINES.