

# T.1N. R.2E. Section 14, W.M.

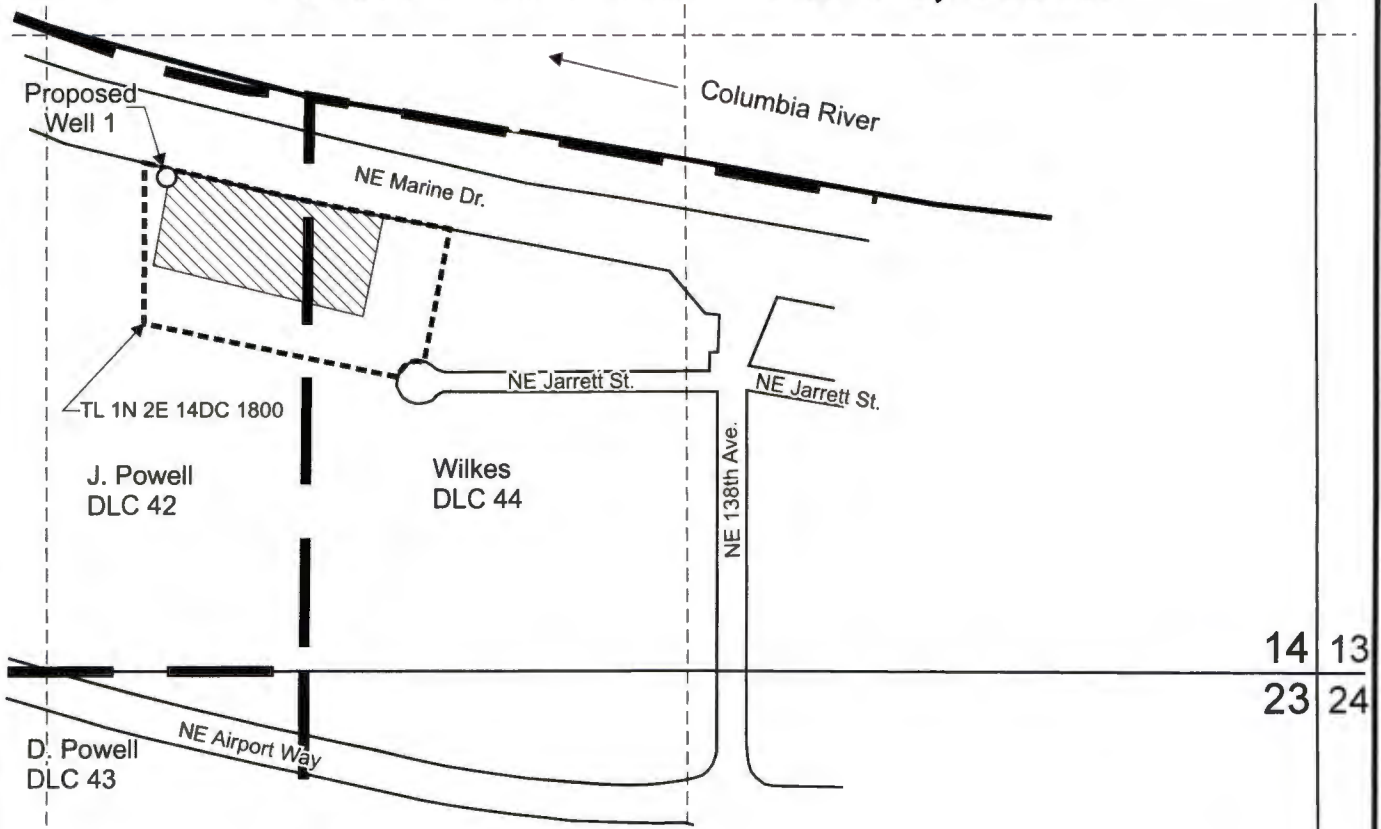

Proposed Well is located 1,025 feet north and 2,400 feet west from the SE corner, Section 14.

 Area proposed for commercial use.

 Tax lot boundary

 Donation Land Claim boundary

**RECEIVED**

**JUL 28 2012**

**OWRD**



EXPIRES: *June 30, 2023*

Scale: 1" = 400'



This map was prepared for the purpose of identifying the location of a water right only and is not intended to provide legal dimensions or location of property ownership lines.



**Water Right Application Map**

Pacific Hydro-Geology Inc.

Primo Water North America  
T.1N. R.2E. Section 14, W.M.

11/2021