

T.6S. R.1E. Section 17, W.M.

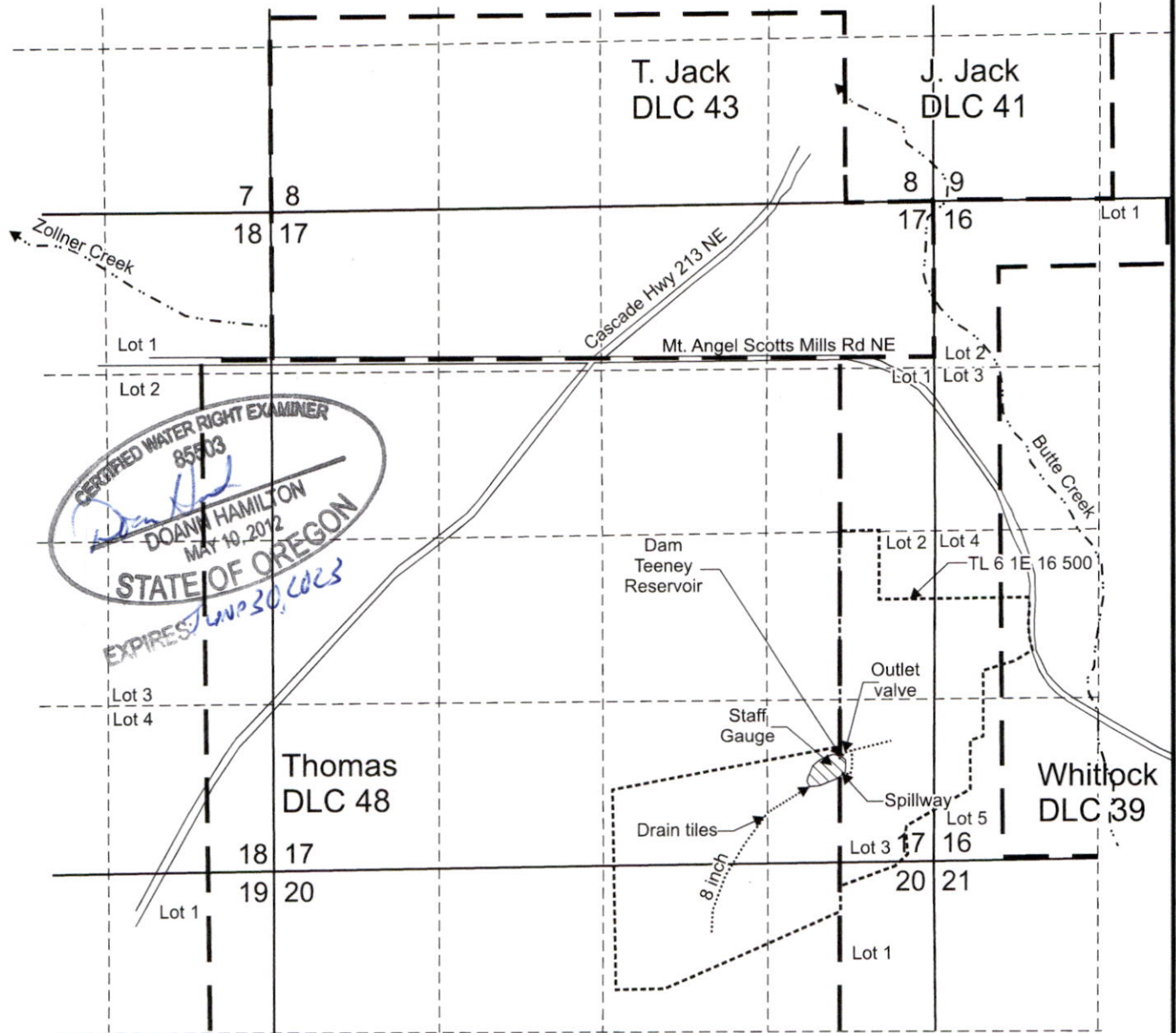

Dam for Teeney Reservoir is located 850 feet north and 720 feet west from the SE corner, Section 17.

 Area (1.3 Acres) covered by Teeney Reservoir, Application R-88416, Permit R-15257.

- Tax lot boundary
- · — Donation Land Claim boundary
- Drain Tiles

Scale: 1" = 1,320'



RECEIVED
AUG 02 2023
OWRD

This map was prepared for the purpose of identifying the location of a water right only and is not intended to provide legal dimensions or location of property ownership lines.



Claim of Beneficial Use Map
Application R-88416, Permit R-15257

Kraemer Farms LLC
 T.6S. R.1E. Section 17, W.M.

Pacific Hydro-Geology Inc.

04/2023