

SECTION 26, T38S, R03W, WM – JACKSON COUNTY

RECEIVED
AUG 14 2023
OWRD

26

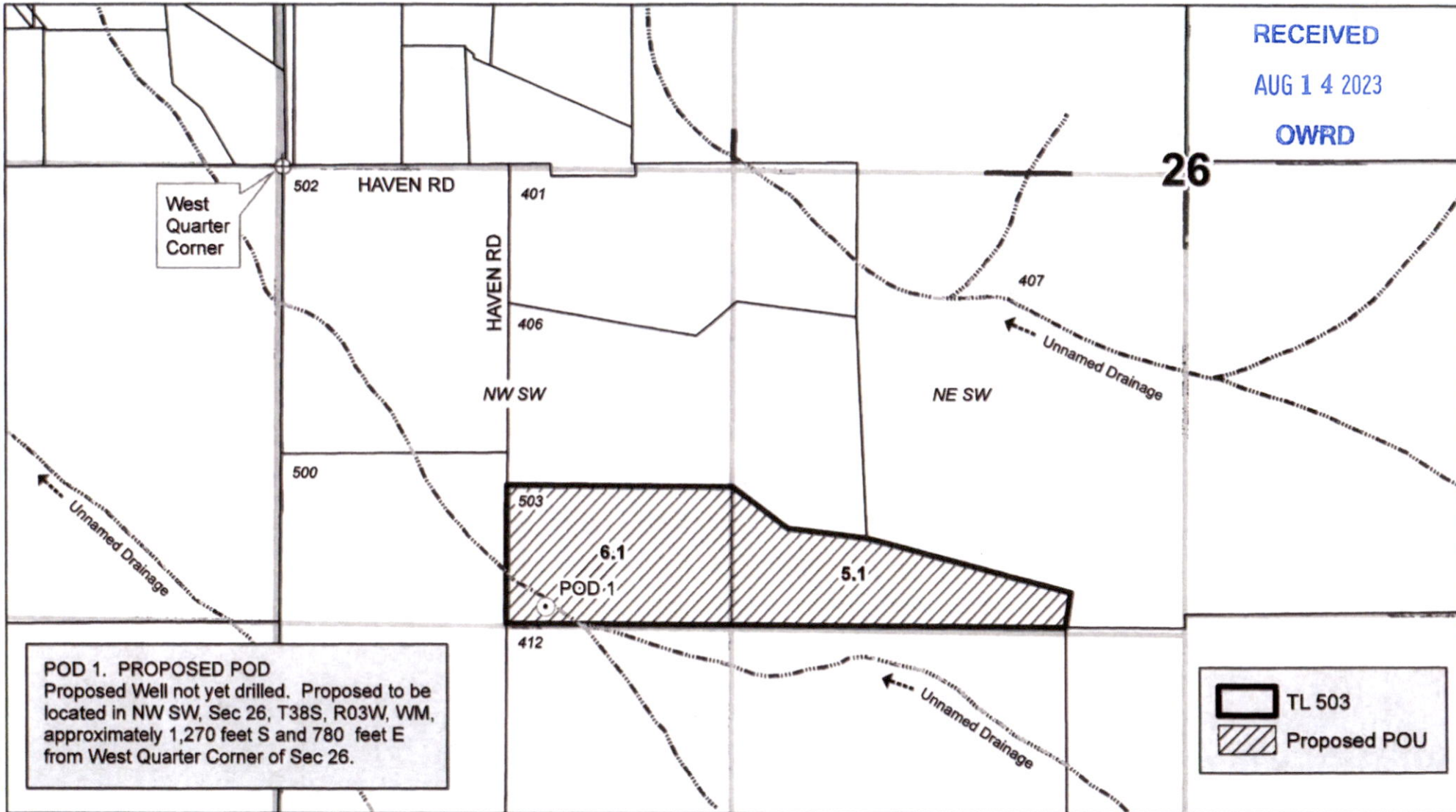

West Quarter Corner

POD 1. PROPOSED POD
Proposed Well not yet drilled. Proposed to be located in NW SW, Sec 26, T38S, R03W, WM, approximately 1,270 feet S and 780 feet E from West Quarter Corner of Sec 26.

TL 503
Proposed POU

DISCLAIMER
This map is not intended to provide legal dimensions or locations of property ownership lines.

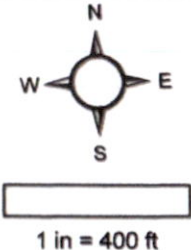

WATERSOLVING, LLC
John Warinner, PE, CWRE
johnw@watersolving.com
541.815.4103 mobile

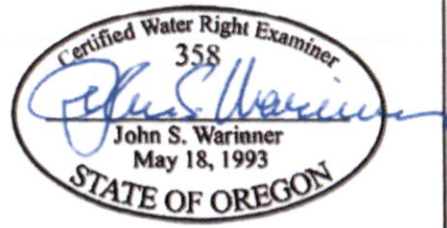

APPLICATION MAP
Application for Permit to Use Groundwater
DERIC CHENAULT
Revised 2023-06-29