

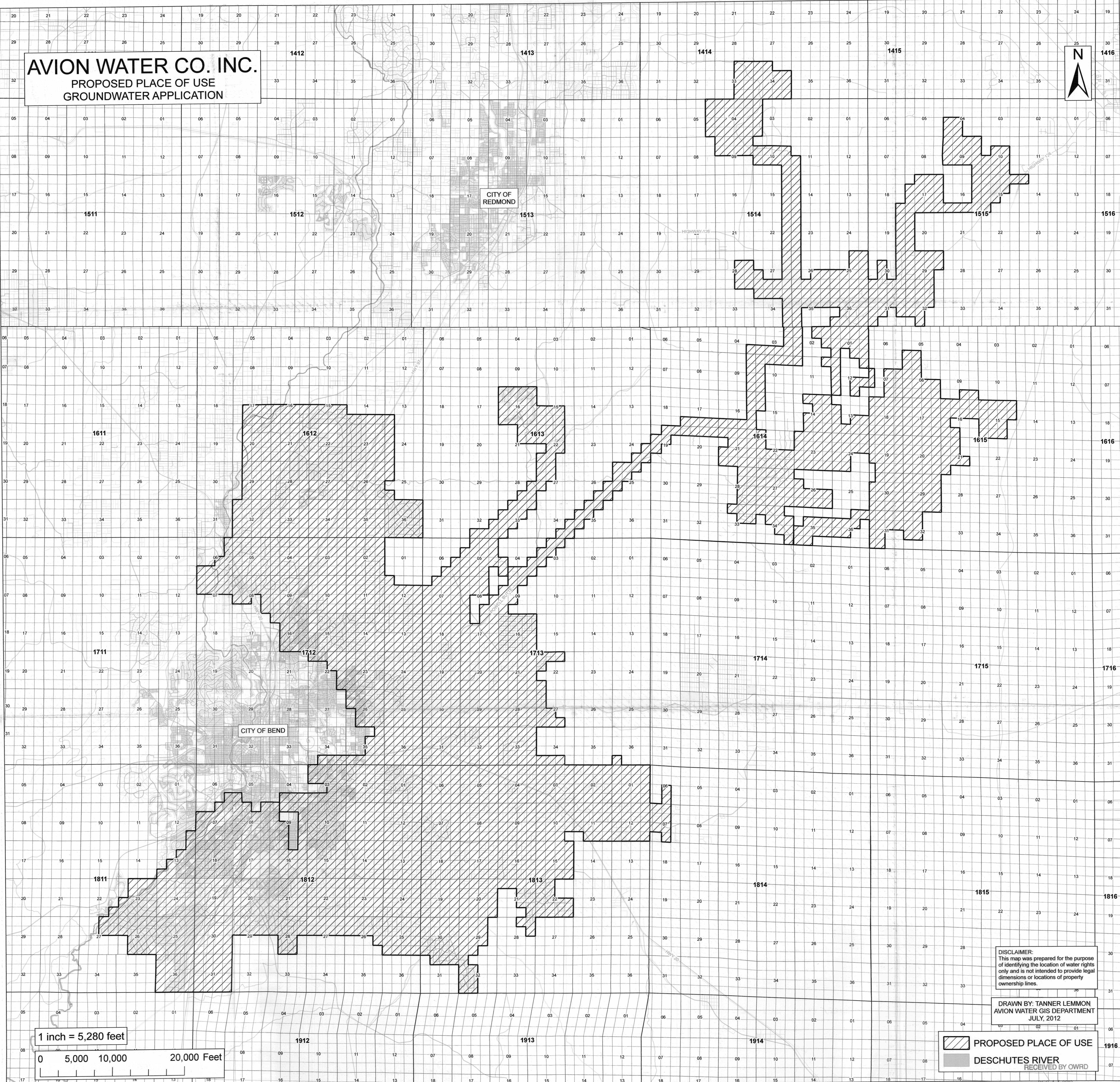

# AVION WATER CO. INC.

PROPOSED PLACE OF USE  
GROUNDWATER APPLICATION



DISCLAIMER:  
This map was prepared for the purpose  
of identifying the location of water rights  
only and is not intended to provide legal  
dimensions or locations of property  
ownership lines.

DRAWN BY: TANNER LEMMON  
AVION WATER GIS DEPARTMENT  
JULY, 2012

 PROPOSED PLACE OF USE  
 DESCHUTES RIVER  
RECEIVED BY OWRD



# AVION WATER CO. INC.

PROPOSED PLACE OF USE  
GROUNDWATER APPLICATION

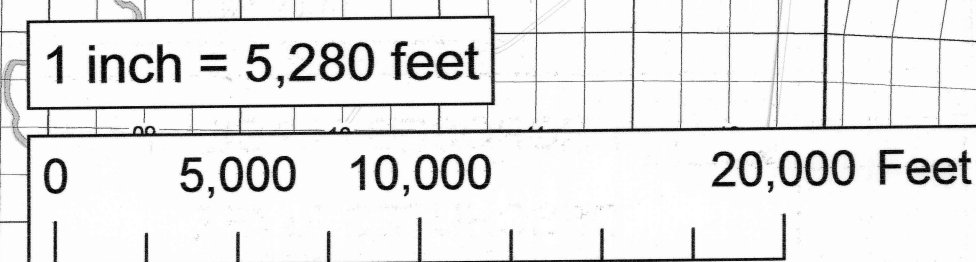
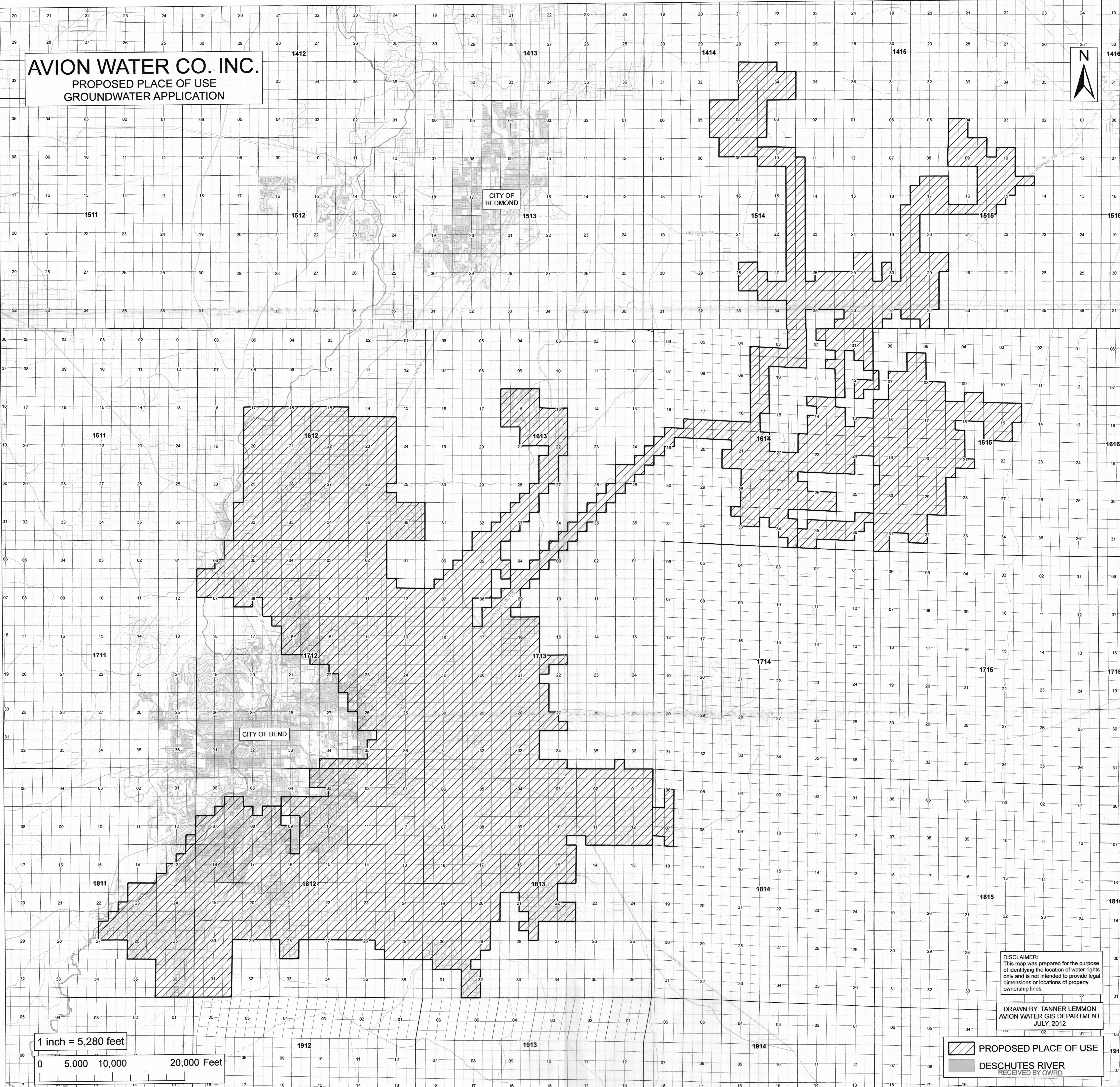
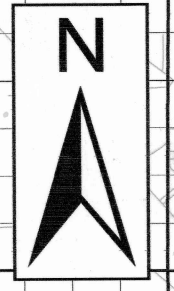

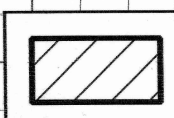
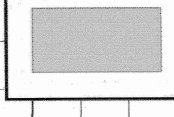
 PROPOSED PLACE OF USE  
 DESCHUTES RIVER  
RECEIVED BY OWRD

DISCLAIMER:  
This map was prepared for the purpose of identifying the location of water rights only and is not intended to provide legal dimensions or locations of property ownership lines.

DRAWN BY: TANNER LEMMON  
AVION WATER GIS DEPARTMENT  
JULY, 2012

DEC 14 2012

SALEM, OR

G-7606