

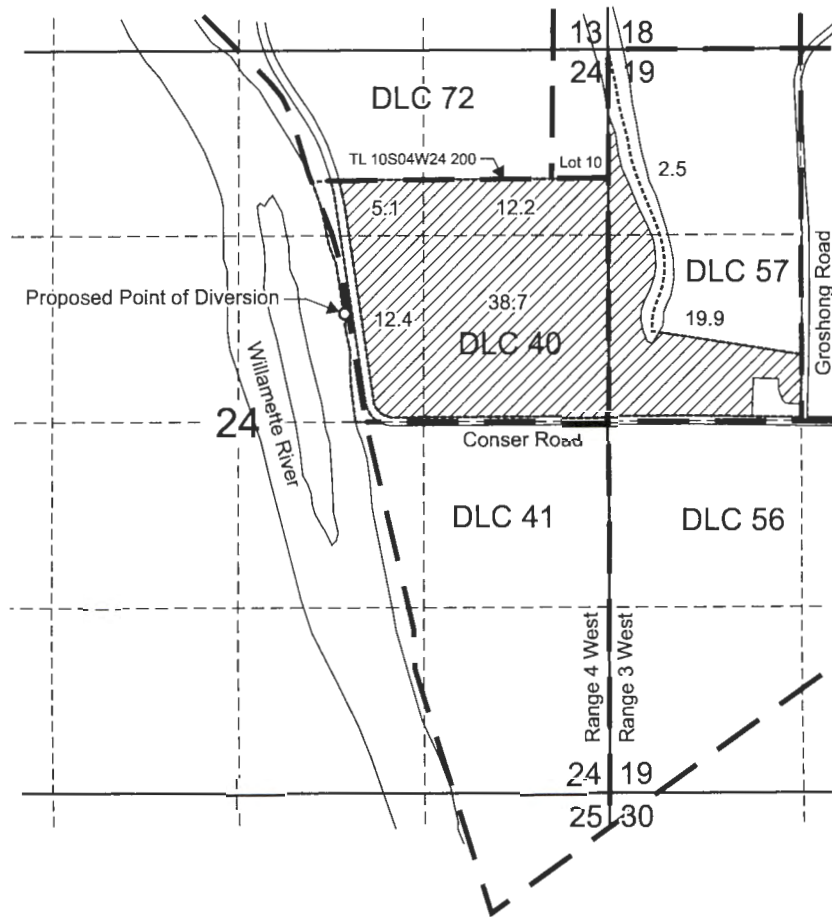



# T.10S. R.3W. Section 19, T.10S. R.4W. Section 24, W.M.



Proposed Point of Diversion is located 1,870 feet south and 1,880 feet west from the NE corner, Section 24.

-  Area (90.8 Acres) to be irrigated.
-  Tax lot boundary
-  Donation Land Claim boundary

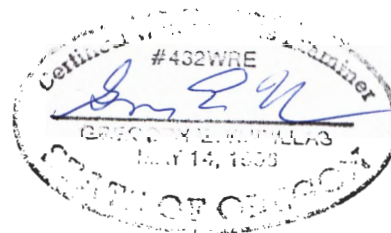

EXPIRATION DATE: 6/30/2025

Scale: 1" = 1,320'



This map was prepared for the purpose of identifying the location of a water right only and is not intended to provide legal dimensions or location of property ownership lines.



## Water Right Permit Application Map

Groshong Farm, LLC  
T.10S. R.3W. Section 19,  
T.10S. R.4W. Section 24, W.M.

Pacific Hydro-Geology Inc.