

**LOCATION DESCRIPTION**

- POD 1 (Reservoir 1)**  
Located 1155 feet South and 870 feet West from the Northerly corner of DLC 66, Township 9 South, Range 5 West (W.M.)
- POD 2 (Reservoir 3)**  
Located 1350 feet North and 220 feet West from the SE corner of Section 32, Township 9 South, Range 5 West (W.M.)
- POD 3 (Reservoir 4)**  
Located 2795 feet North and 720 feet East from the Northerly corner of DLC 66, Township 9 South, Range 5 West (W.M.)
- POD 4 (Reservoir 5)**  
Located 720 feet South and 1900 feet West from the Northerly corner of DLC 66, Township 9 South, Range 5 West (W.M.)
- POD 5 (Reservoir 7)**  
Located 150 feet North and 310 feet West from the SE corner of Section 32, Township 9 South, Range 5 West (W.M.)
- POD 6 (Reservoir 8)**  
Located 270 feet South and 20 feet West from the Northerly corner of DLC 66, Township 9 South, Range 5 West (W.M.)

Document Path: Y:\9504 Hamilton Farms\Source Figures\001 wkr Consulting\COB\ S55129.mxd

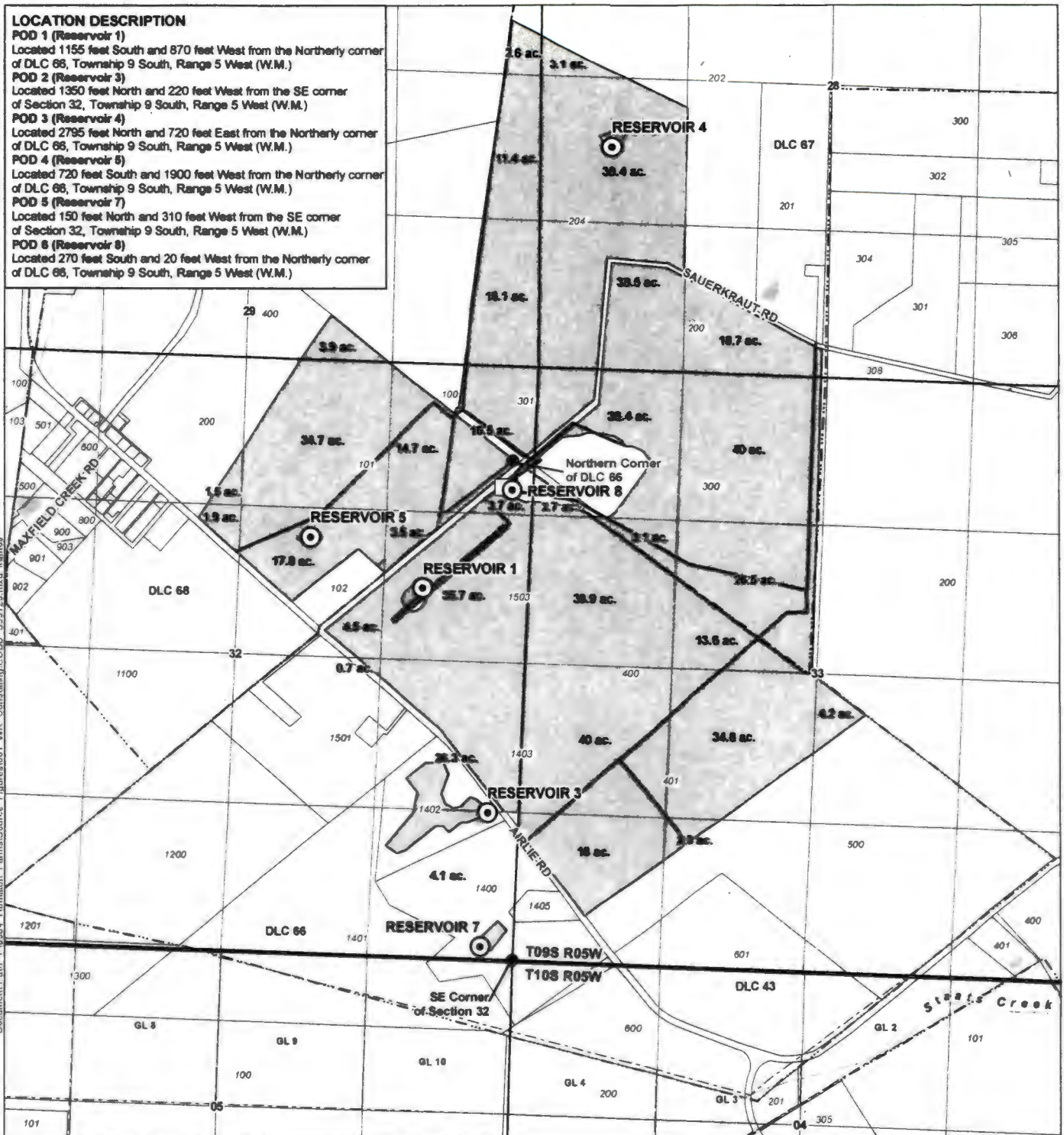

**LEGEND**

- Point of Diversion (POD)
- Tax Lot
- Meter
- Watercourse
- Conveyance
- Waterbody
- Place of Use (POU)
- Government Lot (GL)
- Donation Land Claim (DLC)

**DISCLAIMER**

This map was prepared for the purpose of identifying the location of a water right only and it is not intended to provide legal dimensions or location of property ownership lines.

Date: September 19, 2023  
Data Sources: BLM, ESRI, OWRD, USGS, Polk Co.

**Claim of Beneficial Use  
in the Name of Hamilton Farms, LLC**  
Application S-88482, Permit S-55129

Polk County  
Township 9, 10 South,  
Range 5 West (W.M.)

**CERTIFIED WATER RIGHTS EXAMINER STAMP**

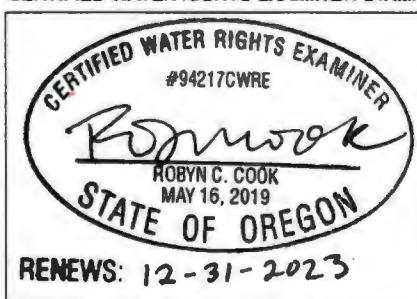

OCT 04 2023  
OUREL

