

Section 11 T.28S. R.13W

Coos County

1" = 400'

SW corner



North

RECEIVED

JUN 26 2023

OWPRD

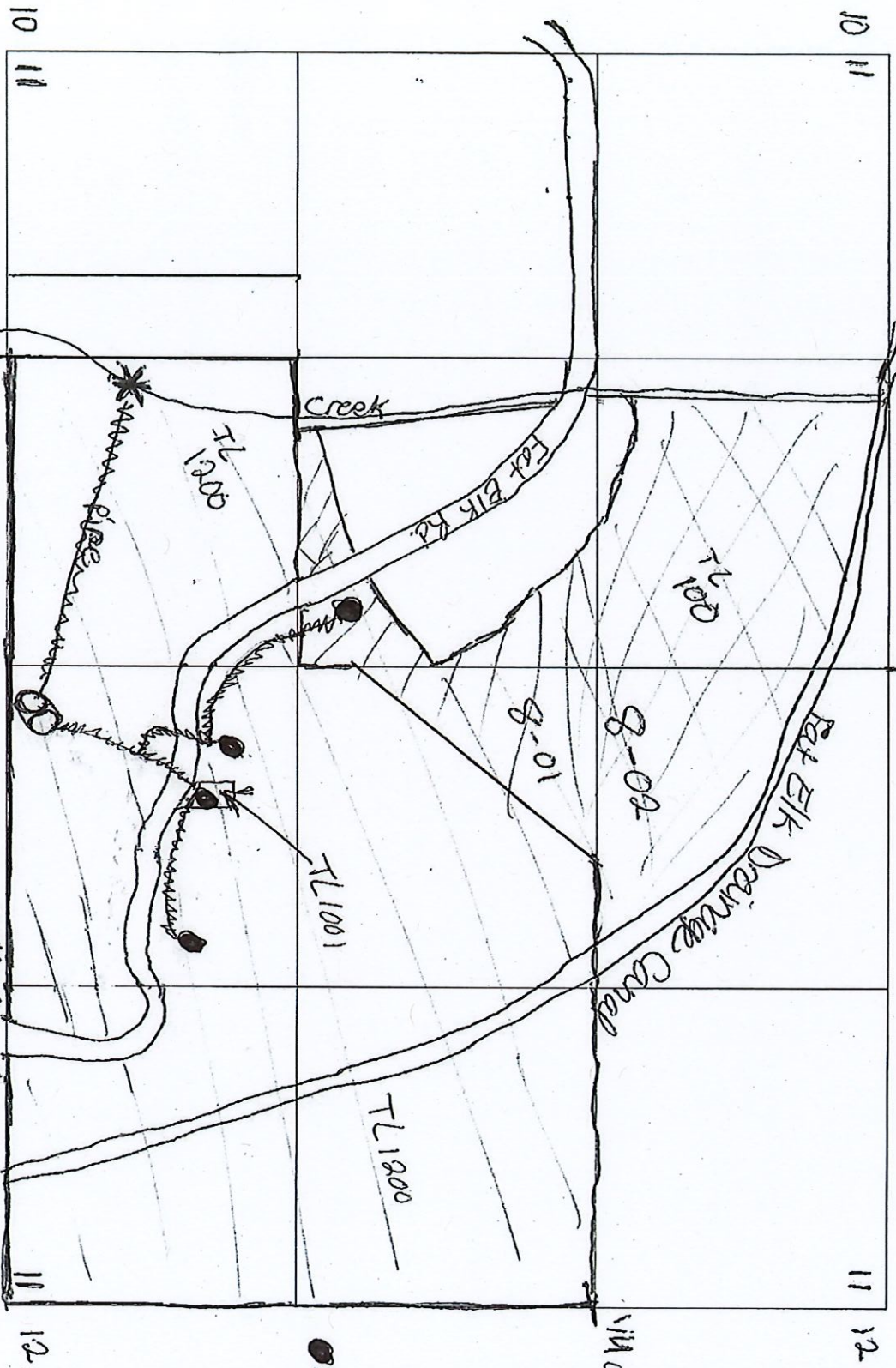

* = Point of Diversion

43.15336°N, 124.21564°W

1800 Ft. East and 700 Ft. North from Southwest corner of Section 11,

O = water holding tanks (2)

----- pipes for water conveyance to/from holding tank to houses

● Existing houses