

RECEIVED

DEC 27 1994

WATER RESOURCES DEPT
SALEM, OREGON



SCALE 1" = 1320'

T 2 S R 38 E

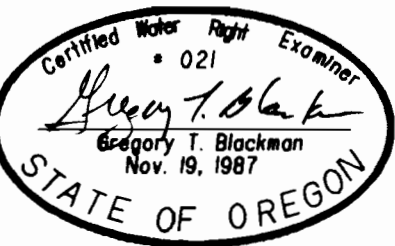
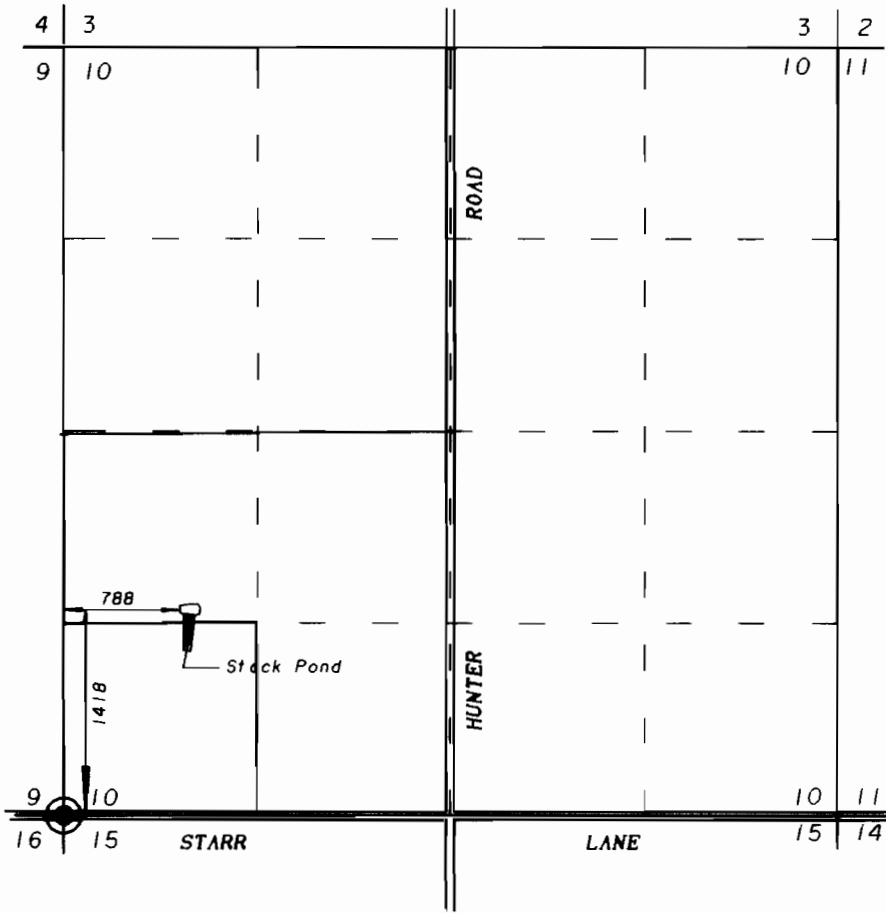

**APPLICATION MAP FOR
WATER RIGHTS ON ONE
STOCK POND**

FOR
THOMAS E. AND JANICE I. KOHR

BY
**BAGETT - GRIFFITH & ASSOCIATES
2006 ADAMS AVENUE
LAGRANDE, OREGON 97850**

DECEMBER 22, 1994

APPLICATION NO

PERMIT NUMBER R11815

NOTE: The preparation of this map was for the purpose of identifying the location of the proposed water right and has no intent to provide dimensions or location of property ownership lines. Location information shown hereon was furnished by the applicant.