

Original of map  
in file 70672d

FINAL PROOF SURVEY MAP

IN THE NAME OF WALTER ALLEN CRAM

SECTION 3, T 28 S, R 14 W, W.M.

APPLICATION R-70671  
APPLICATION 70672

PERMIT R-11348  
PERMIT 51166

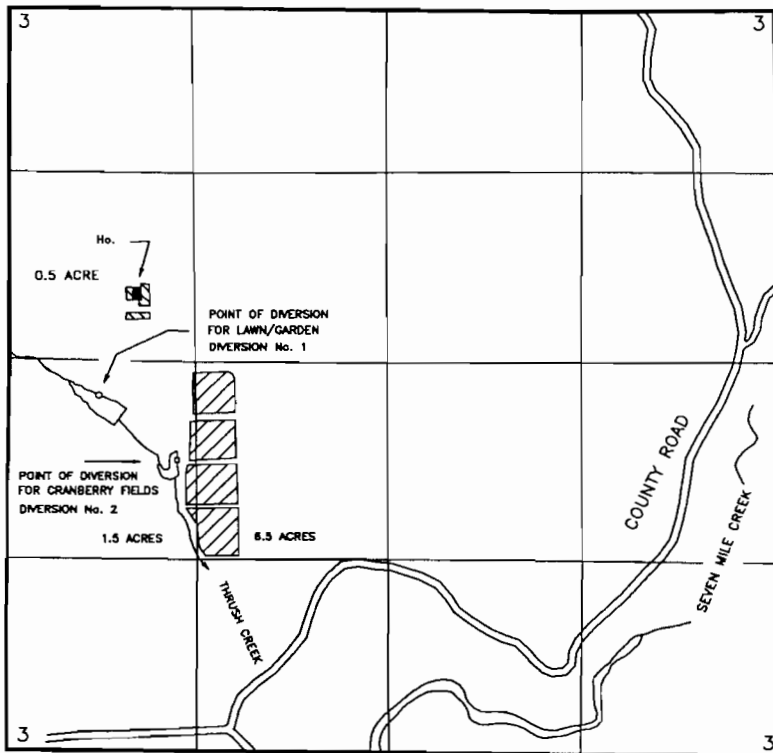

**RECEIVED**

SEP 20 1996

WATER RESOURCES DEPT.  
SALEM, OREGON

THE POINTS OF DIVERSION ARE LOCATED AS FOLLOWS:

| DIVERSION | SOURCE       | SOUTH     | EAST     | ¼ ¼    | SECTION |
|-----------|--------------|-----------|----------|--------|---------|
| POD No. 1 | THRUSH CREEK | 255 FEET  | 610 FEET | NW¼SW¼ | 3       |
| POD No. 2 | THRUSH CREEK | 1160 FEET | 700 FEET | NW¼SW¼ | 3       |
| DAM       | THRUSH CREEK | 740 FEET  | 420 FEET | NW¼SW¼ | 3       |

ALL FROM THE WEST QUARTER CORNER OF SECTION 3 AND WITHIN SECTION 3, TOWNSHIP 28 SOUTH, RANGE 14 WEST, W.M., COOS COUNTY.

THE PURPOSE OF THIS MAP IS TO IDENTIFY THE LOCATION OF THE WATER RIGHT. IT IS NOT INTENDED TO PROVIDE INFORMATION RELATIVE TO THE LOCATION OF PROPERTY OWNERSHIP BOUNDARY LINES.

