

Original of map
in file 70672

FINAL PROOF SURVEY MAP

IN THE NAME OF WALTER ALLEN CRAM

SECTION 3, T 28 S, R 14 W, W.M.

APPLICATION R-70671
APPLICATION 70672

PERMIT R-11348
PERMIT 51166

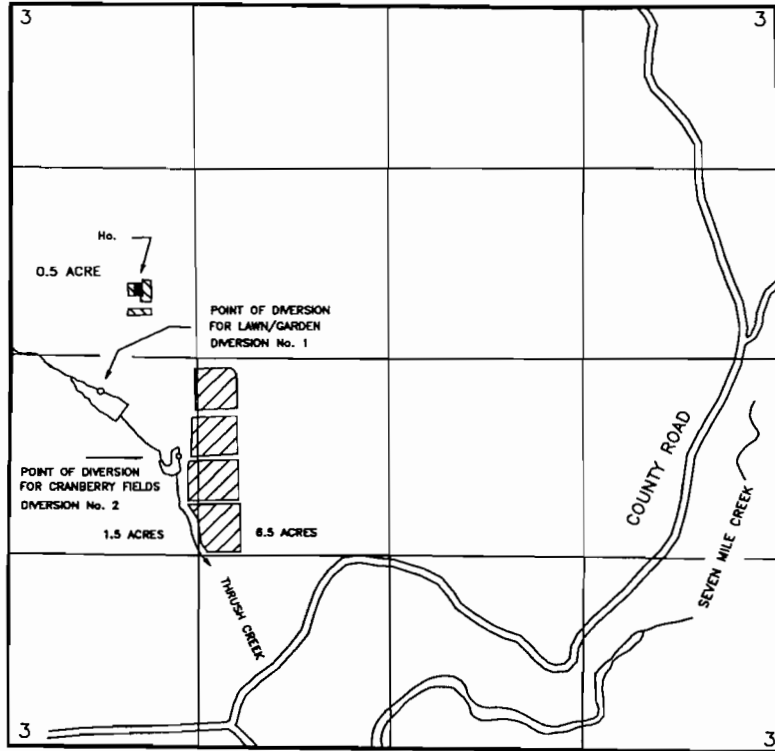

RECEIVED

SEP 20 1996

WATER RESOURCES DEPT.
SALEM, OREGON

THE POINTS OF DIVERSION ARE LOCATED AS FOLLOWS:

DIVERSION	SOURCE	SOUTH	EAST	¼ ¼	SECTION
POD No. 1	THRUSH CREEK	255 FEET	610 FEET	NW¼SW¼	3
POD No. 2	THRUSH CREEK	1160 FEET	700 FEET	NW¼SW¼	3
DAM	THRUSH CREEK	740 FEET	420 FEET	NW¼SW¼	3

ALL FROM THE WEST QUARTER CORNER OF SECTION 3 AND WITHIN SECTION 3, TOWNSHIP 28 SOUTH, RANGE 14 WEST, W.M., COOS COUNTY.

THE PURPOSE OF THIS MAP IS TO IDENTIFY THE LOCATION OF THE WATER RIGHT. IT IS NOT INTENDED TO PROVIDE INFORMATION RELATIVE TO THE LOCATION OF PROPERTY OWNERSHIP BOUNDARY LINES.

