

Name US UMPQUA NATIONAL FOREST
By
Address P.O. Box 1008
Roseburg, OR 97470

Application No. 68233
Permit No. 49176
Certificate No. 61533
64583
Stream Index, Page No. 16-30U

FEES PAID		
Date	Amount	Receipt No.
12/11/84	525.00	45069
FEES REFUNDED		
Date	Amount	Check No.

Date filed December 5, 1984
Priority
Action suspended until *OK cont*

Return to applicant
Date of approval FEB 8 1985

CONSTRUCTION

Date for beginning FEB 8 1986
Date for completion OCT 1 1986
Extended to

Date for application of water OCT 1 1987
Extended to

PROSECUTION OF WORK

Form "A" filed *STARTED*
Form "B" filed *COMPLETED*
Form "C" filed *February 6, 1980*

FINAL PROOF

Blank mailed MAY 14 1990
Proof received
Date certificate issued AUG 13 1990

ASSIGNMENTS				
Date	To Whom	Address	Volume	Page

REMARKS

W.R.I.S.	
Assembled 11/06/84	by RH
Entered 11/06/84	by RH
Verified	by

Form C (690-9-77)

IMPORTANT—This form is a notice to the Water Resources Director that permittee is ready to make final proof to the extent to which the water has actually been applied to the intended use under the terms of the permit. Permittee is cautioned that Certificate of Water Right will be issued based on the extent of the quantity and use as determined by the final proof inspection and survey which will be made in response to the filing of this Form C.

NOTE: In the case of an irrigation permit, this Form C should not be mailed to the Water Resources Department until all of the land described in the permit, which it is intended to irrigate under this permit at any time, has actually been irrigated.

Fill out, detach and mail to the Water Resources Department, Salem, OR 97310, when all of the water has been applied.

Application No. 68233

NOTICE OF COMPLETE APPLICATION OF WATER TO A BENEFICIAL USE

United States, Umpqua National Forest, the holder of Permit No. 49176

to appropriate the public waters of the state of Oregon, completely applied the waters to a beneficial use in accordance with the terms of said permit, on the 1st day of March, 1985.

Remarks: For domestic use and maintenance of fire protection system at Mill Hill administrative site.

IN WITNESS WHEREOF, I have hereunto set my hand this 3rd day of February, 1985.

Sherry Handauer for
Forest Supervisor
(Signature of Applicant)

P.O. Box 1008, Roseburg, OR 97470
(Address)

RECEIVED

FEB - 1986

WATER RESOURCES DEPT
Salem, Oregon

24
R

T. 30S., R. 2W., W.M.

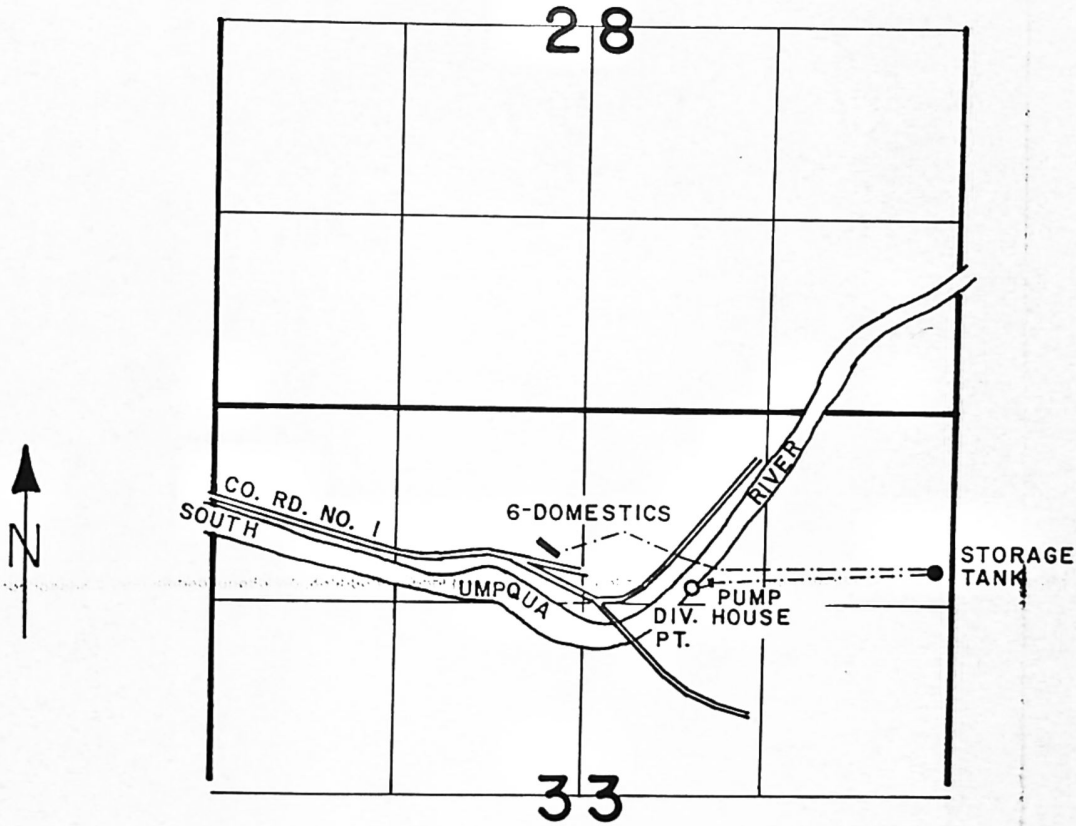

DIV. PT. 15 1220' SOUTH AND 1840' WEST FROM NE CORNER SEC. 33

SCALE: 4" = 1 MILE

FINAL PROOF SURVEY UNDER

Application No. 68233 Permit No. 49176.....
IN NAME OF

UNITED STATES NATIONAL FOREST

Surveyed AUG. 5, 1987, by J. M. SCHMORDE

Application No. 68233

Permit No.

STATE OF OREGON WATER RESOURCES DEPARTMENT RECEIVED
Application for Permit to Appropriate Surface Water DEC 8 1984

WATER RESOURCES DEPT. SALEM, OREGON

I, United States, Umpqua National Forest (Name of Applicant)

of P.O. Box 1008 (Mailing Address), Roseburg (City)

State of Oregon, 97470 (Zip Code) Phone No. (503) 672-6601 do hereby

make application for a permit to appropriate the following described waters of the State of Oregon:

1. The source of the proposed appropriation is South Umpqua River, a tributary of Umpqua River

2. The point of diversion is to be located 1,230 ft. S. and 570 ft. W. (N. or S.) (E. or W.)

from the NE corner of NW 1/4 NE 1/4, Section 33 (Public Land Survey Corner)

(If there is more than one point of diversion, each must be described)

being within the NW 1/4 of the NE 1/4 of Sec. 33 Tp. 30 S. R. 2 W., W. M., in the county of Douglas (N. or S.) (E. or W.)

3. Location of area to be irrigated, or place of use if other than irrigation.

Table with 5 columns: Township, Range, Section, List 1/4 1/4 of Section, List use and/or number of acres to be irrigated. Contains entries for Township 30 S., Range 2 W., Section 33 with irrigation details.

6826c

Handwritten calculations: 200, 100, 125, 100, 525

4. The amount of water which the applicant intends to apply to beneficial use is 0.02
cubic feet per second.

(If water is to be used from more than one source, give quantity from each)

5. The use to which the water is to be applied is domestic use for 6 housing units (0.01 cfs)
and maintenance of fire protection system (0.01 cfs) at Mill Hill Administrative Site.

6.

DESCRIPTION OF WORKS

Include dimensions and type of construction of diversion dam and headgate, length and dimensions of supply ditch or pipeline, size and type of pump and motor, type of irrigation system to adequately describe the proposed distribution system.

*Intake: 8-inch perforated pipe protected by gabions.

*Pump: 5 hp; 52 gpm; centrifugal set-up in jet configuration.

15 hp; 40 gpm; centrifugal

*Storage: 100,000-gallon tank (redwood).

Distribution System: 6-inch pipe across river to a 4-inch pipe loop with
6 hydrants and 4-inch pipe from loop to 6 housing units with 6 hydrants
(see map). Service connection to each housing unit is 1-inch pipe.

*Note: Intake, pumps, and storage tank are all part of the existing water
system for the ranger station.

If for domestic use state number of families to be supplied 4 individuals per housing unit.

7. Construction work will begin on or before Completed

8. Construction work will be completed on or before December 1967^{1/}; October 1982^{2/}

9. The water will be completely applied to the proposed use on or before January 1985

Application No. 68233

Permit No.

Remarks: 1/ 6-inch pipe across river with 4-inch loop;

2/ 4-inch distribution to housing units and hydrants.

The distribution system also includes one washhouse which is attached to the housing units and services only these units.

This application expands on an existing water right for the Tiller Ranger Station evidenced under Permit No. 32552.

This application does not relinquish any further reserved rights or prior beneficial use dates the United States may have.

R. D. Swartzlander
Signature of Applicant

Forest Supervisor

This is to certify that I have examined the foregoing application, together with the accompanying maps and data, and return the same for.....

In order to retain its priority, this application must be returned to the Water Resources Director with corrections on or before, 19.....

WITNESS my hand this day of....., 19.....

..... Water Resources Director

By

This instrument was first received in the office of the Water Resources Director at Salem, Oregon, on the

5th day of December, 19 34, at 8:00 o'clock

A.M.

Application No. *68233*

Permit No.

Application No. 68233

Permit No.

PC

Permit to Appropriate the Public Waters of the State of Oregon

This is to certify that I have examined the foregoing application and do hereby grant the same SUBJECT TO EXISTING RIGHTS INCLUDING THE EXISTING FLOW POLICIES ESTABLISHED BY THE WATER POLICY REVIEW BOARD and the following limitations and conditions:

The right herein granted is limited to the amount of water which can be applied to beneficial use and shall not exceed 0.02 cubic feet per second measured at the point of diversion from the stream, or its equivalent in case of rotation with other water users, from South Umpqua River

The use to which this water is to be applied is domestic and maintenance of a fire protection system, being 0.01 cfs for domestic use and 0.01 cfs for maintenance of the fire protection system

If for irrigation, this appropriation shall be limited to of one cubic foot per second or its equivalent for each acre irrigated

and shall be subject to such reasonable rotation system as may be ordered by the proper state officer.

The priority date of this permit is December 5, 1984

Actual construction work shall begin on or before and shall thereafter be prosecuted with reasonable diligence and be completed on or before October 1, 19

Complete application of the water to the proposed use shall be made on or before October 1, 19

WITNESS my hand this day of, 19

Water Resources Director

RAK C

RECEIVED
3/1/84

Abstract of Permit

This is to certify that I have examined APPLICATION **68233** and do hereby grant the same SUBJECT TO EXISTING RIGHTS INCLUDING THE APPROPRIATE MINIMUM FLOW POLICIES ESTABLISHED BY THE WATER POLICY REVIEW BOARD and the following limitations and conditions:

This permit is issued to **United States, Umpqua National Forest of PO Box 1008, Roseburg, Oregon 97470, phone 672-6601**, for the use of the waters of South Umpqua River, a tributary of Umpqua River, for the PURPOSE of domestic use for 6 families and maintenance of a fire protection system, being 0.01 cubic foot per second for domestic use and 0.01 cfs for maintenance of a fire protection system that the PRIORITY OF THE RIGHT dates from **December 5, 1984**

and is limited to the amount of water which can be applied to beneficial use and shall not exceed **0.02 cfs**

The POINT OF DIVERSION is to be LOCATED: **1230 feet South and 570 feet West from the Northeast Corner of the NW 1/4 NE 1/4 of Section 33**, being within the NW 1/4 NE 1/4 of Section 33, Township 30 South, Range 2 West, WM, in the County of Douglas.

A description of the PLACE OF USE under the permit, and to which such right is appurtenant, is as follows:

Township 30 South, Range 2 West, WM Section 33 NE 1/4 NW 1/4 Domestic use for 6 families
NE 1/4 NW 1/4 Maintenance of fire protection system (5 hydrants)
NW 1/4 NE 1/4 Maintenance of fire protection system (7 hydrants)

BTR-644-212
9/15 8/5/87

14216 ✓
21105 ✓
30300 ✓
32077 ✓
32552 ✓
43477 ✓
48423 ✓
48412 ✓
NORJK

Actual construction work shall begin on or before **February 8, 1986**, and shall thereafter be prosecuted with reasonable diligence and be completed on or before **October 1, 1986**.

Complete application of the water to the proposed use shall be made on or before **October 1, 1987**.

Witness my hand this **8th** day of **February**, 19**85**.

WATER RESOURCES DIRECTOR

This permit, when issued, is for the beneficial use of water. By law, the land use associated with this water use must be in compliance with statewide land-use goals and any local acknowledged land-use plan. It is possible that the land use you propose may not be allowed if it is not in keeping with the goals and the acknowledged plan. Your city or county planning agency can advise you about the land-use plan in your area.

APPLICATION **68233**

⑦ - A

30S 2W SW 49176
PERMIT

INFO.: MET WITH RON LIZOTTE, FACILITIES MANAGER WHO SHOWED TO ME THE WATER SYSTEM AND EXPLAINED ITS USE. WATER IS PUMPED FROM S. UMPQUA USING THE SAME PUMP SYS. SOURCE: S. UMPQUA RIVER FOR DOMESTIC FOR 6 APPTS. & FIRE SUPP. SYSTEM. (CONT.) DIV. PT.: DIRECT-DRAFT FROM RIVER THRU GRAVEL GABION BENEATH THE RIVER BOTTOM ALONG LEFT BANK JARUZZI

PUMP ~~JARUZZI~~ JET 1 1/2" / PT 6

MOTOR BALDOR 7.5 HP 3 PHASE

LIFT: 30 FT SUCTION
0 FT. DISCHARGE

PUMP ~~7.5 HP~~ BERKELEY 2 STAGE 1 1/2 W/P-2 - 7 1/2 HP

MOTOR 7.5 HP CENTURY

LIFT: 0 SUCTION
500' ~~DISCHARGE~~ DISCHARGE

INFO.: CONTINUED - USED FOR THE TILLER ^{PANGER DISTRICT} COMPLEX. THE 5 HYDRANTS AND THE 6 APARTMENTS WERE ADDED TO THE PRE-EXISTING FIRE PROTECTION SYSTEM CONSISTING OF 7 HYDRANTS ON A 4" PVC PIPELINE. WATER IS PUMPED FROM THE RIVER WITH A JET PUMP TO A CHLORINATION TANK, THEN PUMPED TO A 100,000 GALLON STORAGE TANK ON A HILL OVERLOOKING THE COMPLEX, ~~THEN~~ ^{THEN} GRAVITY-FLOW DOWN TO COMPLEX AND ACROSS THE RIVER TO THE APARTMENTS AND THE FIRE PROTECTION SYSTEM. THERE ARE 3 HOSE BIBBS AT THE APARTMENTS TO WATER THE ^{20 FT} LAWN AREA SURROUNDING THE APARTMENTS.

PIPE: ~~60/40~~ 50 FT. OF 2" INTAKE PIPE (RIVER TO PUMP)
50 FT. OF 1 1/2" ~~RETURN~~ RETURN PIPE (PUMP TO RIVER)
CHLORINATION TAKE ^{STEEL} FT. OF 2" PIPE FROM PUMP TO STORAGE TANK
FT. OF 6" STEEL PIPE FROM TANK TO JUNCTION WITH 4" PVC
FT. OF 4" ^{STEEL} PVC PIPE WITH 12 HYDRANTS
3 HOSE BIBBS

USES: DOMESTIC FOR 6 APARTMENTS, USE IN WASHHOUSE, FIRE-SUPPRESSION SYSTEM w/ 12 HYDRANTS
TIE: PHOTO BTR-6HM-212

Mike Edmund
WRF 8/5/87

Calculation

$$Q_p = \frac{(6.6)(7.5)}{102 + 500} = 0.08 \text{ C.F.S.}$$

$$Q_g = \left(\frac{1.49}{0.010}\right)(0.8727)(0.30915)$$

$$(0.46029 = 1.05 \text{ C.F.S.})$$



REPLY TO: 2540

DATE: February 3, 1986

Mr. William H. Young, Director
Water Resources Department
Mill Creek Office Park
555 13th Street, NE
Salem, OR 97310

RECEIVED
FEB 6 - 1986
WATER RESOURCES DEPT
SALEM, OREGON

Dear Mr. Young:

The Umpqua National Forest is ready to make final proof on the use of surface water from the South Umpqua River for the Mill Hill administrative site as stated under the terms of Permit 49176. Form C, Notice of Complete Application of Water to a Beneficial Use, is enclosed.

Sincerely,

SK Handauer

for ROBERT J. DEVLIN
Forest Supervisor

Enclosure

cc: Tiller RD
S. Hofford



February 8, 1985

United States, Umpqua National
Forest

P.O. Box 1008
Roseburg, OR 97470

68233

49176

68233

16-30-4

UNITED STATES
DEPARTMENT
OF AGRICULTURE

NATIONAL
FINANCE
CENTER

P.O. BOX 60000
NEW ORLEANS
LOUISIANA 70160

PRCH10-11

TO: WATER RESOURCES DEPARTMENT
MILL CREEK OFFICE PARK
SALEM OR 97310

DATE: JANUARY 07, 1985

SUBJECT: PAYMENT NOTIFICATION

GENTLEMEN:

WE HAVE RECEIVED YOUR INVOICE NUMBER IN THE AMOUNT
OF 525.00 FOR PURCHASE ORDER NUMBER 41-04T7-5-75022.
OUR RECORDS INDICATE THAT THIS IS A DUPLICATE INVOICE OR THAT THIS
ORDER HAS BEEN TOTALLY SCHEDULED FOR PAYMENT. THE FOLLOWING PAYMENT(S)
HAS BEEN APPLIED AGAINST THIS PURCHASE ORDER AND HAS BEEN OR WILL BE
RELEASED ON THE SCHEDULED PAY DATE INDICATED.

INVOICE	DATE	VENDOR	AMOUNT	SCHEDULED PAY DATE
-----	-----	-----	-----	-----
	12/07/84	ST OF OREGON WATER RES	525.00	12/18/84

IF YOU HAVE ANY QUESTIONS REGARDING THIS MATTER, PLEASE CONTACT
THE USDA, NATIONAL FINANCE CENTER, INQUIRY SECTION, TELEPHONE
FOR ASSISTANCE 504-255-5370 OR (TOLL FREE) 1-800-421-0323.

USDA, NATIONAL FINANCE CENTER
P.O. BOX 60,000
NEW ORLEANS, LA. 70160

ATTACHMENT

*Impqua
Roseburg*

RECEIVED
JAN 15 1985
WATER RESOURCES DEPT
SALEM, OREGON

378-3066

January 7, 1985

R.D. Swartzlender, Forest Supervisor
US Umpqua National Forest
PO Box 1008
Roseburg, OR 97470

Dear Mr. Swartzlender:

REFERENCE: File 68233

Your application for a permit to appropriate 0.02 cubic foot of water per second from the South Umpqua River, being 0.01 cubic foot per second for domestic supplies for six housing units and 0.01 cubic foot per second for maintenance of a fire protection system has been filed and for reference numbered 68233. The five prints of the supporting map and fees in the amount of \$525 were also received. Our Receipt 45069 is enclosed.

There are proposed minimum streamflows and policy statements affecting the use of waters of the South Umpqua River. These have a tentative effective date of November 3, 1983. If these minimum streamflows are adopted, they may have some effect on the use of water that may be allowed under the terms of a permit approving your application. We will be able to advise you further after the adoption of the policy by the Water Policy Review Board.

Your application is in satisfactory form and will be placed with the group to be considered for approval.

Sincerely,

WAYNE J. OVERCASH
Senior Water Rights Examiner

WJO:wpc

enclosure

6236C

STATE OF OREGON
WATER RESOURCES DEPARTMENT

MILL CREEK OFFICE PARK
555 13TH STREET N.E.
SALEM, OREGON 97310

TO: U.S. Umpqua National Forest

DATE: December 7, 1984

ADDRESS: P.O. Box 1008
Roseburg, OR 97470

Filing fees for Application 68233:

Examination fee

\$200 00

Recording fee

325 00

TOTAL DUE

\$525 00

Please make remittance payable to the Water Resources Department and please enclose one copy of this billing with remittance. Thank you.

RE: Purchase Order #41-04T7-5-75022

cc: U.S. Department of Agriculture
National Finance Center
P.O. Box 60075
New Orleans, LA 70160

UNITED STATES DEPARTMENT OF AGRICULTURE
PURCHASE ORDER

THIS NUMBER MUST
APPEAR ON ALL
INVOICES, PACKAGES AND
PAPERS RELATING TO
THIS ORDER

NUMBER	CONTRACT NUMBER	ORDER DATE	ORDER NUMBER	SUB.
1 OF 1	OM	110684	41-04T7-5-75022	

CHECK ONE <input checked="" type="checkbox"/> Purchase Order (See Reverse) <input type="checkbox"/> Delivery Order	TO: (Seller) Water Rights Division State of Oregon Water Resources Dept. 555 13th Street, NE Salem, OR 97310	SHIP TO: (Consignee and Destination) Tiller Ranger District Route 2, Box 1 Tiller, OR 97484	RECEIVED 8 AM DEC 5 1984 WATER RESOURCES DEP SALEM, OREGON
--	--	--	--

LINE ITEM	ACT. CODE	DESCRIPTION	QUANTITY	UNIT ISSUE	UNIT PRICE	AMOUNT
01		Examination Fee for water right application for Mill Hill Administrative Site, Tiller Ranger District, Tiller OR	1	JOB	200.00	200.00
02		Recording Fees for Water Right Application for Mill Hill Administrative Site, Tiller Ranger District, Tiller OR as follows: First Housing Unit - \$100.00 Five Additional Housing Units - \$125.00 Fire Protection - \$100.00 (maintenance of system) - <i>sgf</i> Application and Fees were discussed between Gary Ball, Watermaster, and Steve Hofford.	1	JOB	325.00	325.00

SELLER'S ORIGINAL

Delete terms and conditions on reverse and substitute Attachments A, B, and C.

FOB POINT Destination	DISCOUNT TERMS ----	0	TOTAL ▶	525.00
TIME FOR DELIVERY -----	SHIP VIA -----			

BILLING INSTRUCTIONS:

Furnish invoice with our ORDER NUMBER to:

U.S. DEPARTMENT OF AGRICULTURE
National Finance Center
P.O. Box 60075
New Orleans, Louisiana 70160

Application No. 68233
Permit No.

FAILURE TO SHOW OUR PURCHASE ORDER NUMBER ON INVOICE WILL DELAY PAYMENT

FREIGHT CHARGE OVER \$100 REQUIRES BILL OF LADING

**DO NOT
SHIP ORDER TO
THIS ADDRESS
(Ship to Consignee
Address Above)**

ISSUING OFFICE NAME AND ADDRESS Tiller Ranger District Route 2, Box 1 Tiller, OR 97484	ORDERED BY (Name and Title) Dorothy F. Feigel, PURCHASING AGENT PHONE (Area Code and Number) 503-672-6601 TTS 422-4511 AUTHORIZED SIGNATURE <i>Dorothy F Feigel</i>
---	--

SELLER'S ORIGINAL



United States
Department of
Agriculture

Forest
Service

Umpqua National Forest
P.O. Box 1008
Roseburg, OR 97470

REPLY TO: 2540

DATE: November 26, 1984

Water Rights Division
Water Resources Department
555 13th Street, NE
Salem, OR 97310

RECEIVED

DEC 6 1984

WATER RESOURCES DEPT.
SALEM, OREGON

Dear Examiner:

The Umpqua National Forest submits for your review and approval the enclosed application for permit to appropriate surface water from the South Umpqua River for the Mill Hill administrative site. This applicaiton expands on an existing intake for the Tiller Ranger Station, which is evidenced under Permit No. 32552, by identifying new uses, location of uses, and the associated amount of water.

Purchase Order No. 41-04T7-5-75022 has been issued in the amount of \$525 for total fees (\$200 examination fee and \$325 recording fee). Your copy of this purchase order is enclosed.

Sincerely,

R. D. SWARTZLENDER
Forest Supervisor

Enclosures

Application No. 68233
Permit No.



TREASURY - FISCAL SERVICE TFS 3039 (1)
(Formerly TFS 1)

NOTICE TO CHECK RECIPIENT

VENDOR NAME

ST OF OREGON WATER RESOURCES DEPT

AGENCY BILLING ADDRESS:

USDA-NFC, P O BOX 60800
NEW ORLEANS, LA. 70160
CALL 504-255-5370 OR
TOLL FREE 1-800-421-0323

VENDOR I.D. NUMBER

4104T7575022

CHECK INFORMATION

DISBURSING LOC: KANSAS CITY
CHECK NUMBER: 16 350 843
CHECK AMOUNT: \$525.00
CHECK DATE: 12-21-84

PAYMENT

IDENTIFICATION

INFORMATION

P O @ 41-04T7-5-75022
INV AMOUNT \$525.00

SCHD/SEQ N24353-01552

CREDIT ACCT OF USDA - FOREST SERVICE

RECEIVED
DEC 24 1984
WATER RESOURCES DEPT
SALEM, OREGON

*** WATER RIGHT DATA INPUT FORM ***

WATER RIGHT NO. 1000682331 PERMIT NO. CERTIF. NO. NAME: U.S. UMPQUA N.F.
 ORIG. NO. PREV. NO. SUPER. NO. ADDRESS: PO Box 1008
 CITY/STATE/ZIP/COUNTY: ROSEBURG OR 97470 10
 STREAM-ID 16 1250 0900 RIV.MI. 25.4 WM.DIST. 15 W.R.TYPE SA STATUS

CANCEL YEAR----> CONSTR.COMPLT--> YR.LAST USED-----> NEXT ACTION DUE-->
 PRIORITY-----> 12051984 PUT TO USE-----> LAST TRANS.DATE--> LAST TRANS.TYPE-->
 APPLICATION----> 12051984 SURVEYED-----> EXAM.FEE-----> RECORDING FEE----->
 PERMIT ISSUE--> CONCURRENCE----> CYCLE STATUS-----> REPORTED FLAG----->
 CONSTR.STRT.--> CERTIFIED-----> CORRES.INIT.-----> CORRES.DATE----->

POINT-OF-DIVERSION DATA:
 TWNSP RNGE SECT QTR/QTR STREAM-ID RIV.MI. RATE STATUS S OR P
300S 020W 33 AB 16 1250 0900 25.4 0.02 ✓ P
~~0.0 0.000~~
 0.0 0.000
 0.0 0.000

** REMARKS: - 12051984 ----->
 ** DATED--> 12051984
 ** POD: 12-30'S E 570'W FM NE COR
 ** NW 1/4 NE 1/4 S33. DOMESTIC USE
 ** 6 UNITS. Q = 0.01 FOR DO &
 ** 0.01 FOR FP
 **----->
 **----->
 **----->

PLACE-OF-USE DATA:
 TWNSP RNGE SECT QTR/QTR CNTY USE % CNSMTV ACRES STATUS S OR P
300S 020W 33 BA 10 DO 100.00 .00 ✓ P
1 33 BA 1 FP 1.00 .00 \ I
300S 020W 33 AB 10 FP 100.00 .00 ✓ P

W.R.I.S.
 Assembled 11061984 by RH
 Entered 11061984 by RH
 Verified _____ by _____