

GARRICK & KATHERINE WAALKES

SECTION 16, T41S R35E W.M.
HARNEY COUNTY, OREGON

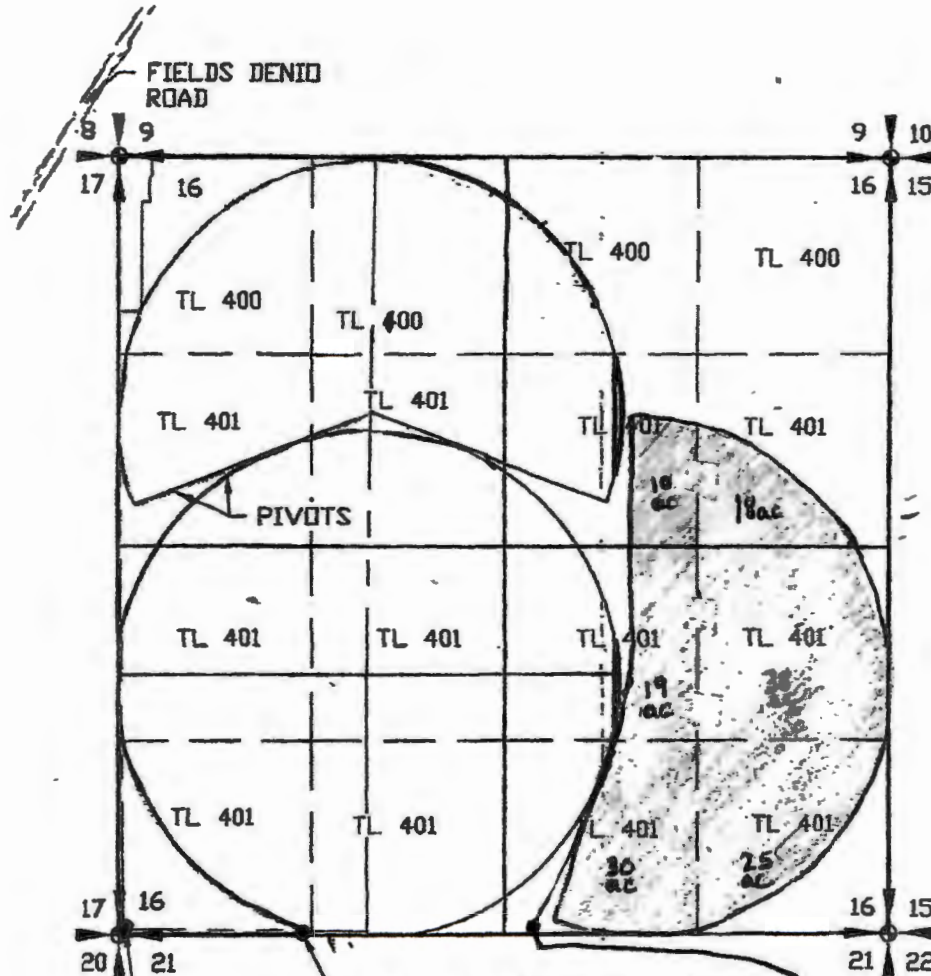

WELL 3 LOCATED 10.00' NORTH
AND 1257.00' EAST OF
SOUTHWEST CORNER SECTION 16
HARN 50924

WELL 1 LOCATED 50.00' NORTH
AND 50.00' EAST OF SOUTHWEST
CORNER SECTION 16
HARN 1831

WELL 4 (PROPOSED)
10.00' NORTH AND 1571.25' EAST
OF SOUTHWEST CORNER SECTION 16

Buried mainline from proposed well to
center of proposed pivot.

LEGEND

- SECTION LINE
- 1/4 SECTION LINE
- 1/16 SECTION LINE
- MAIN LINE

 PLACE OF USE CERTIFICATES 91669 & 91670

 PROPOSED PLACE OF USE 140 ACRES

RECEIVED
NOV 15 2023
OWRD