

Langlois, Oregon

Application No. 18038

Permit No. 13708

Certificate No. 13782 50125

Name P. G. Cope

By

Address Langlois, Oregon

Date filed May 13, 1939

Priority May 13, 1939

Action suspended until

Returned to applicant

Date of approval August 15, 1939

CONSTRUCTION

Date for beginning August 15, 1940

Date for completion October 1, 1941

Extended to

Date for application of water October 1, 1942

Extended to

PROSECUTION OF WORK

Form "A" filed October 27, 1939

Form "B" filed October 27, 1939

Form "C" filed October 27, 1939

FINAL PROOF

Blank mailed 12/22/39 G.N.

Proof received

Date certificate issued July 1, 1941

FEES PAID

Date	Amount	Receipt No.
5/15/39	9.50	24395
Total		
3/27/41	\$1 Cert. Fee	27398
5/15/39	0.10 B.P.	24395

FEES REFUNDED

Date	Amount	Check No.

ASSIGNMENTS

Date	To Whom	Address	Volume	Page

REMARKS

0.38 sf from Illinois Creek (Ocean) for lining of 30 acres  
3-24-41 Form 102

See T-4544 A Pou

OK for certificate

NOTICE OF COMPLETE APPLICATION OF WATER TO A BENEFICIAL USE

I, P.G. Cope, the holder of Permit No. 13708 to appropriate the public waters of the state of Oregon, completely applied the waters to a beneficial use in accordance with the terms of said permit, on the 12 day of May, 1939.

Remarks: If all of the water granted in the permit has not been fully applied to beneficial use, you should so state.

IN WITNESS WHEREOF, I have hereunto set my hand this 26 day of October, 1939.

Signature of Witness: R. J. Duggs, 1411 Euclid - Medford

Signature of Applicant: P.G. Cope, Langlais Oregon

Fill out, detach, and mail to the State Engineer, Salem, Oregon, when all of the water has been applied.

NOTICE OF COMPLETION OF CONSTRUCTION

I, P.G. Cope, the holder of Permit No. 13708 to appropriate the public waters of the state of Oregon, completed the construction of the works described therein on the 12 day of May, 1939.

Remarks: If the works have less capacity than described in the permit, or you have definitely abandoned part of the proposed development, you should so state in order that our records may not be unnecessarily encumbered.

IN WITNESS WHEREOF, I have hereunto set my hand this 26 day of October, 1939.

Signature of Witness: R. J. Duggs, 1411 Euclid - Medford

Signature of Applicant: P.G. Cope, Langlais Oregon

Fill out, detach, and mail to the State Engineer, Salem, Oregon, when construction work is completed.

NOTICE OF BEGINNING OF CONSTRUCTION

I, P.G. Cope, the holder of Permit No. 13708 to appropriate the public waters of the state of Oregon, began the actual construction of the works described therein on the 10 day of May, 1939.

Remarks: Employed two men to install equipment pre-fabricated by Oregon Culvert & Pipe Co. up to the date of this statement, and any additional information which may tend to show the beginning of work in good faith.

Work on installation fully completed

IN WITNESS WHEREOF, I have hereunto set my hand this 26 day of October, 1939.

Signature of Witness: R. J. Duggs, 1411 Euclid - Medford

Signature of Applicant: P.G. Cope, Langlais Oregon

Fill out, detach, and mail to the State Engineer, Salem, Oregon, when construction work is begun.

TOWNSHIP 31S, RANGE 15W, W. M.

North

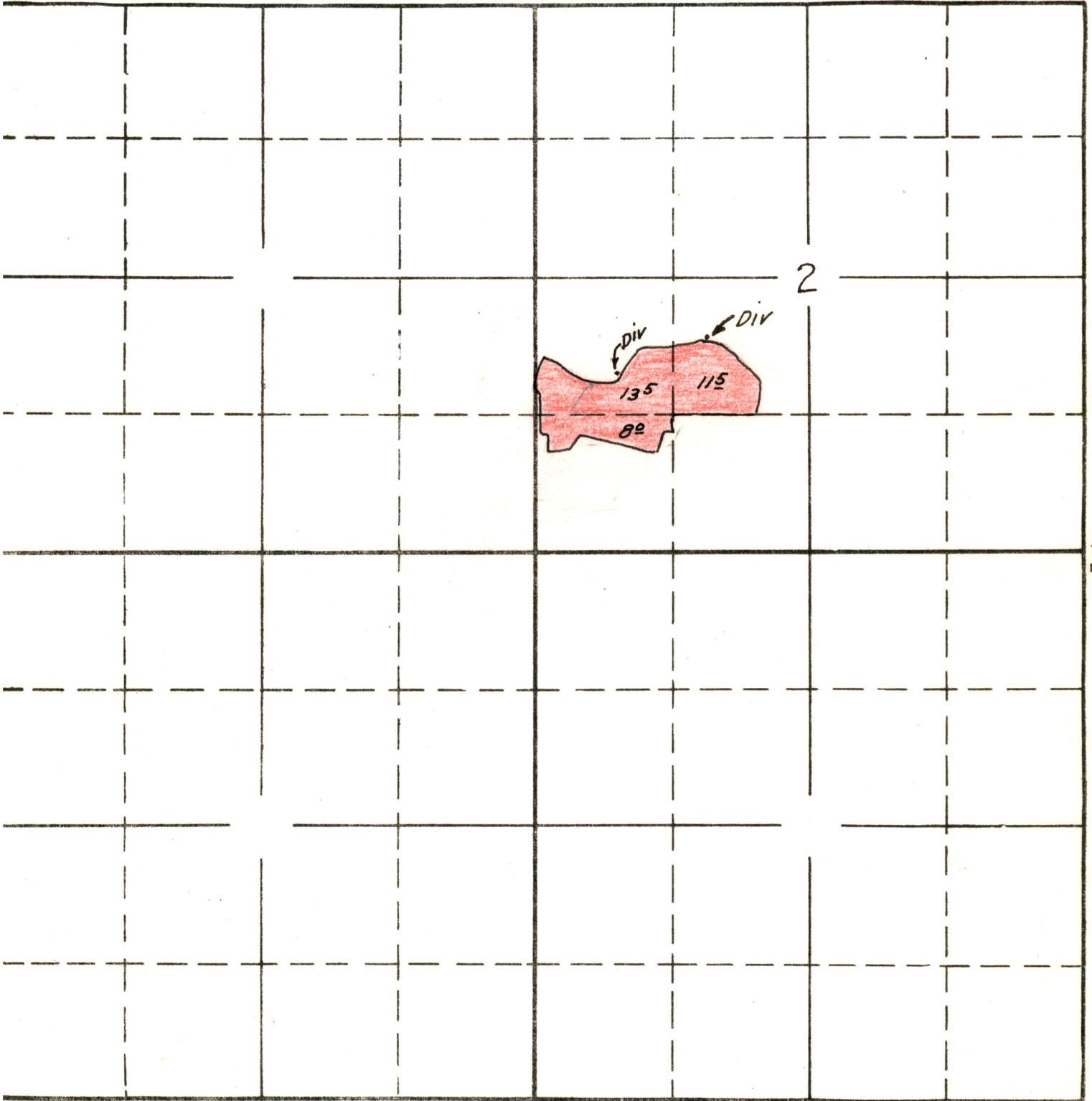

East

Surveyed July 5, 1940 C.A.C.

South

APPLICATION No. 18038

PERMIT No. 13708

SECTION

TOWNSHIP 31 S, RANGE 15 W, W. M.

North

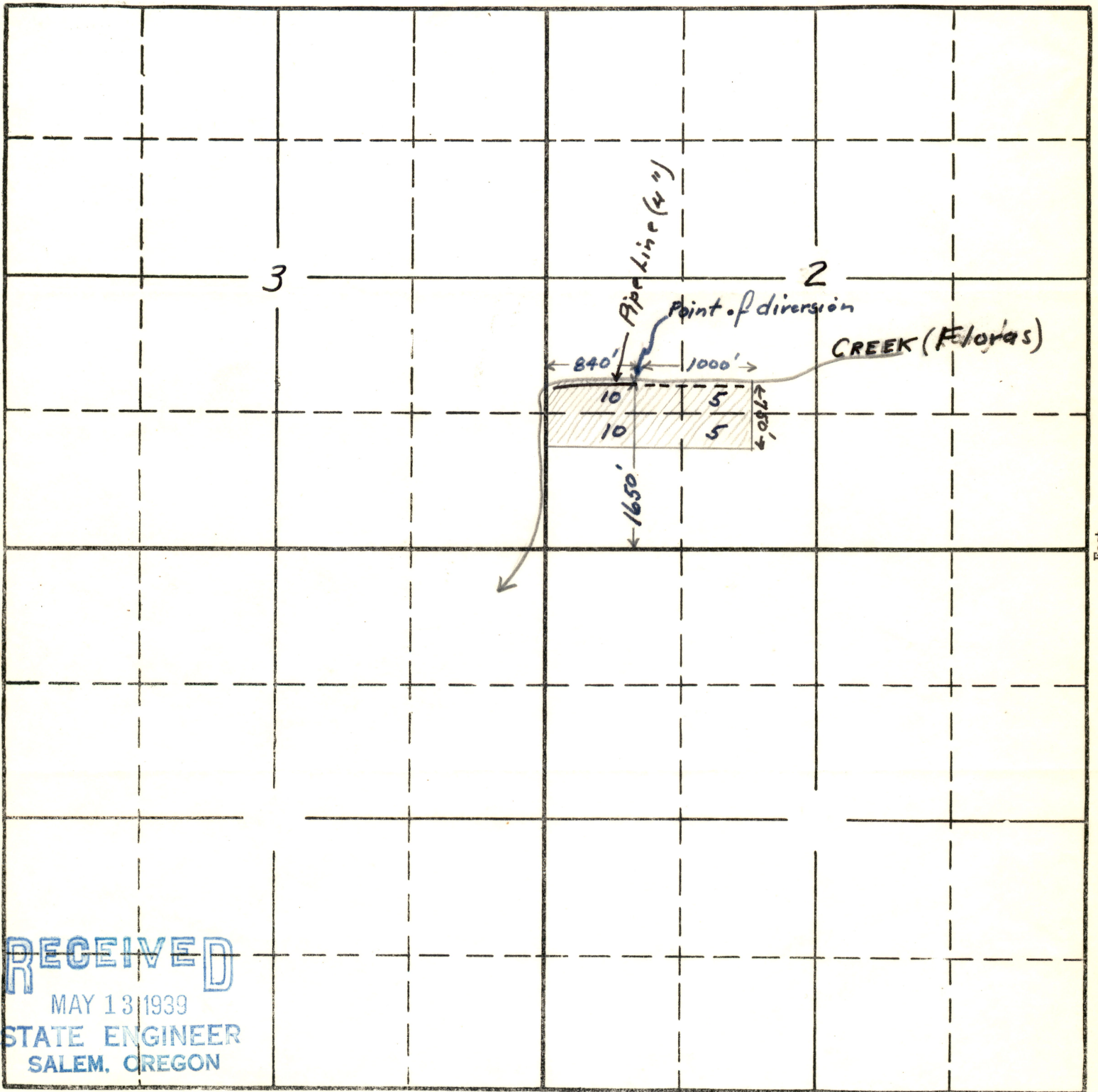

East

RECEIVED  
 MAY 13 1939  
 STATE ENGINEER  
 SALEM, OREGON

South

Filed in the name of P.G. Cope  
 R. E. Cope & Son  
 Langlois - Curry Co

18038  
 17-3  
 APPLICATION No.  
 PERMIT No. 13708

18038

RECEIVED

24 October 1996

OCT 28 1996

Oregon Water Resources Dept.  
158 12th St NE  
Salem, OR 97310

WATER RESOURCES DEPT.  
SALEM, OREGON

Attn: Data Center

Re: Water Right Permits #13708, #17228, #45551 and #49993 as well as Pre-1909 Vested Stock Water Right filed January 05, 1993

Property covered by the above referenced Water Rights has been purchased by Stonecypher Ranch, Inc. Specifically this property is described as follows:

1. Permit #13708 -- NW 1/4 SW 1/4 - 10.5 ACRES, SW 1/4 SW 1/4 - 7.5 ACRES and NE 1/4 SW 1/4 - 8.5 ACRES all in Section 2, T31S, R15W.
2. Permit #17228 --
  - a. NW 1/4 SE 1/4 - 7.6 ACRES, SW 1/4 SE 1/4 - 21.2 ACRES and SE 1/4 SE 1/4 - 5.7 ACRES -- and NE 1/4 SW 1/4 - 6.7 ACRES and SE 1/4 SW 1/4 - 0.2 ACRES all in Section 2, T31S, R15W.
  - b. NE 1/4 NE 1/4 - 10.5 ACRES and NW 1/4 NE 1/4 - 5.4 ACRES all in Section 11, T31S, R15W.
  - c. NW 1/4 NW 1/4 - 2.9 ACRES in Section 12, T31S, R15W.
3. Permit #45551 -- NW 1/4 SE 1/4 - 1.0 ACRES and Domestic Use all in Section 2, T31S, R15W.
4. Permit #49993 -- SW 1/4 SW 1/4 - 8.1 ACRES and SE 1/4 SW 1/4 - 17.0 ACRES all in Section 2, T31S, R15W.
5. All property covered by Pre-1909 Vested Stock Water Right Claim in Sections 2, 3, 11 and 12 of T31S, R15W filed January 05, 1993 by Lloyd C. Kreutzer a copy of which is attached.

In order that Stonecypher Ranch, Inc receives all correspondence and documentation relating to the above Water Rights please change the address of record concerning these Rights and properties to the following:

Stonecypher Ranch Inc  
94141 Stonecypher Road  
Sixes, OR 97476

Sincerely,



Joseph L. Stonecypher, President

Application No. 18038

County Curry

PROOF OF APPROPRIATION OF WATER

- 1. Name P. G. Cope 2. Address Langlois, Oregon
- 3. Source of supply Floras Creek  
Tributary of Pacific Ocean
- 4. Amount of water 0.38 c.f.s. 5. Priority date May 13, 1939 ✓
- 6. Use Irrigation
- 7. Location of point of diversion, NW<sup>1</sup>/<sub>4</sub> SW<sup>1</sup>/<sub>4</sub> & NE<sup>1</sup>/<sub>4</sub> SW<sup>1</sup>/<sub>4</sub> Sec. 2, Twp. 31 S., Range 15 W., W. M. ✓  
(Legal Subdivision)

8. The description of land given below corresponds to that found in your permit covering land to be irrigated, or, if for other purposes, the place of use. In the blank column on the right, headed "No. acres actually irrigated", fill in the number of acres you have irrigated in each of the tracts described:

Township	Range	Section	Forty-acre Tract	No. Acres Described in Permit	No. Acres Actually Irrigated
31 S.	15 W.	2	NW <sup>1</sup> / <sub>4</sub> SW <sup>1</sup> / <sub>4</sub>	10 ✓	135 ✓
		2	SW <sup>1</sup> / <sub>4</sub> SW <sup>1</sup> / <sub>4</sub>	10 ✓	80 ✓
		2	NE <sup>1</sup> / <sub>4</sub> SW <sup>1</sup> / <sub>4</sub>	5 ✓	85 (115) ✓
		2	SE <sup>1</sup> / <sub>4</sub> SW <sup>1</sup> / <sub>4</sub>	5 ✓	0

If for irrigation, this appropriation shall be limited to 1/80th of one cubic foot per second or its equivalent for each acre irrigated and shall be further limited to a diversion of not to exceed 2 1/2 acre feet per acre for each acre irrigated during the irrigation season of each year, and shall be subject to such reasonable rotation system as may be ordered by the proper state officer.

This column must be filled in if water is used for irrigation

*OK for certif.*

(Attach separate sheet if necessary)

DESCRIPTION OF WORKS

9. (a) If a dam has been constructed, give description: Height, ..... ft.; length on top, ..... ft.; length on bottom ..... ft.; material used and character of construction, .....

(b) Give description of headgate: Width, ..... ft.; depth, ..... ft.; material used and character of construction, .....

(c) Size of canal: Width on top (at waterline) ..... ft.; width on bottom, ..... ft.; depth of water, ..... ft.; grade, ..... ft. fall per 1,000 ft. Actual capacity, ..... sec.-ft.

Give general description: .....

(d) Pipe line: Description of intake, .....

Length of pipe, 800 ft.; size at intake, 4 in.; size at ..... ft. from intake, ..... in.; size at place of use, 4 in. Difference in elevation between intake and place of use, 17 ft.

Is grade uniform? Fairly Actual capacity of pipe line, ..... sec.-ft.

Give general description: Galvanized  
(Material: Steel, wrought, cast iron, wood stave, etc.)

Sprinkling system 20 sprinklers

(e) Pumping plant: Give size and type of pump, 2" Centrifugal

Suction lift, ..... ft.; discharge lift, Total 17 ft. Type of motor used Electric

Horse power rating, 7 1/2 H. P. Actual capacity of pump, ..... sec.-ft.

10. During what months is water beneficially used? Irrigation season

11. State character of soil Silt Loam

Kind of crops raised Beets & Clover

12. Does the accompanying map, filed with your application, show correctly the point of diversion, area of land irrigated, or place of use? See proof map

13. If not, wherein is such map in error? .....

14. Domestic use: Give number of families actually using water at this time .....

15. If for power, mining, municipal, manufacturing, storage or any other purpose than irrigation, give extent and method of such use .....

AFFIDAVIT OF APPROPRIATOR

STATE OF OREGON,

County of

*Curry*

} ss.

I,

*P. G. Cope*

being first duly sworn, depose and say that I have read the above and foregoing proof of appropriation of water; that I know the contents thereof, and that the facts therein stated are true.

IN WITNESS WHEREOF, I have hereunto set my hand this

*25*

day

of

*march*

19*41*

*P. G. Cope*

Subscribed and sworn to before me this

*25*

day of

*march*

19*41*

*Art Aldrop*

Notary Public for Oregon

[Notarial Seal]

My commission expires

My Commission Expires Jan. 17, 1943

AFFIDAVIT OF WITNESSES

STATE OF OREGON,

County of

*Curry*

} ss.

We,

*W B Strain*

and

*G P Strain*

of

*Sanglais*

being first duly sworn, depose and say that

we are well acquainted with the facts and conditions set forth in the foregoing statement relative to proof of appropriation of water under Permit No. *13708*; that we and each of us have been over and upon each tract described in said proof, and from such personal inspection have knowledge that all necessary ditches, dams and other diversion and distributing works have been constructed, and water used as stated therein; that we have carefully read such proof of appropriation, and that each and every statement contained therein is true to the best of our knowledge and belief.

*W B Strain*

*G. P. Strain*

Subscribed and sworn to before me this

*25*

day of

*march*

19*41*

*Art Aldrop*

Notary Public for Oregon

[Notarial Seal]

My commission expires

My Commission Expires Jan. 17, 1943



**REPORT OF PERSON MAKING INSPECTION**

(For use by representative of State Engineer)

I, Chester A. Cummings, do hereby certify that I have made an inspection of the works described herein and in Permit No. 13708, on the 5th day of July, 1940, and found the foregoing statements and descriptions of works to be accurate. In my opinion the appropriation has been completed to the extent of \_\_\_\_\_ and I recommend the issuance of water right certificate for this amount. (Quantity of water in second-feet or acre-feet)

**NOTICE TO INSPECTORS**

If conditions do not justify the above report by you, please return the proof without your signature, with a full report by letter.

Chester A. Cummings  
(Name)

(Title)

**PROOF OF APPROPRIATION**

Permit No. \_\_\_\_\_

Recording fee paid \_\_\_\_\_

Receipt No. \_\_\_\_\_

**RECEIVED**  
MAR 27 1941  
STATE ENGINEER  
SALEM, OREGON

STATE OF OREGON



IN WITNESS WHEREOF, I have hereunto set my hand this \_\_\_\_\_ day

the contents thereof, and that the facts therein stated are true.

I \_\_\_\_\_  
County of \_\_\_\_\_  
STATE OF OREGON

VERIDVAIL OF APPROPRIATION

TOWNSHIP 31S, RANGE 15W, W. M.

North

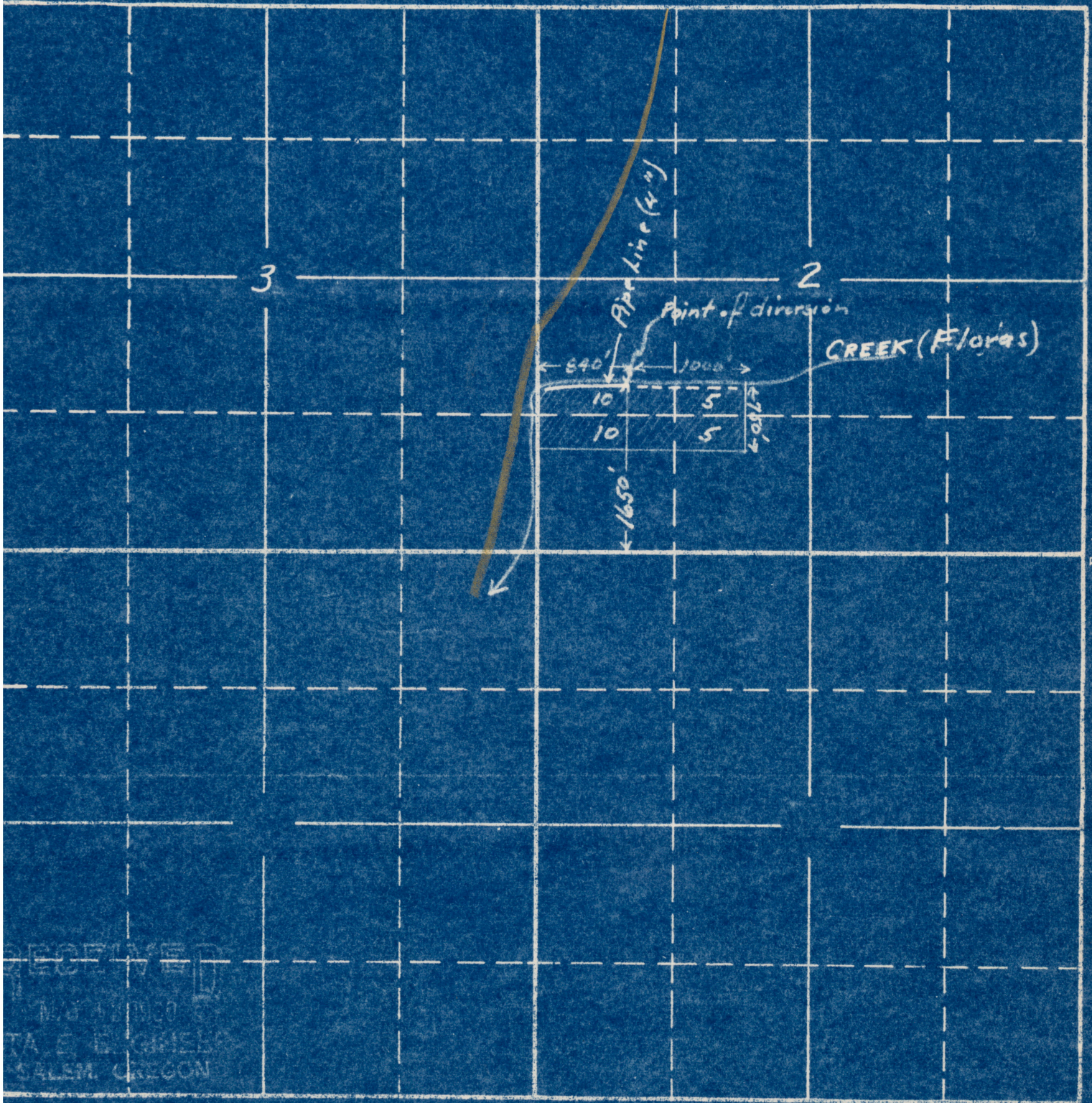

East

South

RECEIVED  
 W. H. HANCOCK &  
 T. A. E. ENGINEERS  
 SALEM, OREGON

Filed in the name of P.G. Cope  
 R.E. Cope & Son  
 Langlois - Curry Co

18038  
 17-3  
 APPLICATION No.  
 PERMIT No. 13708

September 12, 1968

Ralph Cope  
Langlois  
Oregon 97450

Dear Mr. Cope:

With reference to our conversation in Langlois late last month, I am enclosing a print of the final map from your Floras Creek water right file, and information on the right as evidenced by Certificate 13782 is penciled on the enclosed application form for making a change in the existing right.

If you have questions on this matter, I will be pleased to hear from you.

Very truly yours,

CHRIS L. WHEELER  
State Engineer

By James W. Carver, Jr.  
Deputy

JWC:lsa

Enclosure

February 18, 1941

Mr. P. G. Cope  
Langlois, Oregon

Dear Mr. Cope:

If you will sign the enclosed final proof and return it to this office, accompanied by the statutory certificate recording fee in the amount of \$1.00, your water right under Permit No. <sup>13708</sup> will be confirmed by issuance of a certificate defining a right to the use of water as indicated on the proof, when the next group of certificates is issued.

Very truly yours,

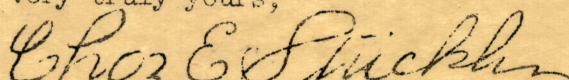

CHAS. E. STRICKLIN  
State Engineer

encl.

September 30, 1940

Mr. P. G. Cope  
Langlois, Oregon

Dear Sir:

This will acknowledge receipt of your letter of September 27, inquiring concerning your water right as defined by Permit No. 13703.

Only one trip is made each year by the inspecting engineer of this office, and he is now in the field on this trip and will probably not be in the office until this winter when he will work up the notes covering all of the projects inspected.

It is probable that the information necessary to issue your certificate will not be available in usable form until a considerably later date. However, in the meantime, the permit which you hold will be valid and sufficient evidence of your water right.

Very truly yours,

CHAS. E. STRICKLIN  
State Engineer

By  
Ed K. Humphrey, Assistant

EKH:hp

STATE OF OREGON

OFFICE OF THE

STATE ENGINEER

WATER RESOURCES DEPARTMENT

SALEM

ADDRESS ALL COMMUNICATIONS  
CHAS. E. STRICKLIN, STATE ENGINEER  
SALEM, OREGON

AND REFER TO FILE NO. 18038

CHAS. E. STRICKLIN, STATE ENGINEER  
SECRETARY  
STATE RECLAMATION COMMISSION  
HYDROELECTRIC COMMISSION OF OREGON

November 7, 1939

Mr. P. G. Cope  
Langlois, Oregon

Dear Sir:

This acknowledges receipt of Forms A, B and C, being notices of the beginning of construction work, the completion of construction work and the complete application of water under your Permit No. 13708.

The matter of issuance of the certificate under this permit will be given consideration as soon as a representative from this office can make an inspection of the project covered by the permit, which probably will not be until spring, for the purpose of checking the irrigated acreage, location, etc., preparatory to final proof, which proof can cover only the acreage which has actually been irrigated. In the meantime, the permit which you hold will be valid and sufficient evidence of the water right.

Very truly yours,

CHAS. E. STRICKLIN  
State Engineer

By *Ed K. Humphrey*  
Ed K. Humphrey, Assistant

RECEIVED  
SEP 30 1940  
STATE ENGINEER  
SALEM, OREGON

*Langlois Ore Sept. 27, 1940*  
*To Chas E. Stricklin Salem Ore*  
*Dear Sir: I would like to know when I*  
*will receive my certificate of water*  
*right, as it has been some three or four months*  
*since the above mentioned inspection has been*  
*made yours truly, P G Cope*

November 7, 1939

Mr. P. G. Cope  
Langlois, Oregon

Dear Sir:

This acknowledges receipt of Forms A, B and C, being notices of the beginning of construction work, the completion of construction work and the complete application of water under your Permit No. 13708.

The matter of issuance of the certificate under this permit will be given consideration as soon as a representative from this office can make an inspection of the project covered by the permit, which probably will not be until spring, for the purpose of checking the irrigated acreage, location, etc., preparatory to final proof, which proof can cover only the acreage which has actually been irrigated. In the meantime, the permit which you hold will be valid and sufficient evidence of the water right.

Very truly yours,

CHAS. E. STRICKLIN  
State Engineer

By

Ed K. Humphrey, Assistant

BB

May 17, 1939

Mr. P. G. Cope  
Langlois, Oregon

Dear Sir:

This acknowledges receipt of your application for a permit to appropriate  $\frac{4}{9}$ th of a second-foot of water from Floras Creek for irrigation, together with your remittance in the amount of \$9.60 for which Receipt No. 24395 is enclosed.

The application which has been checked over, has been filed and given No. 18038. It appears to be in satisfactory form, and is being placed in line for approval and issuance of a permit.

Very truly yours,

CHAS. E. STRICKLIN  
State Engineer

By

Ed K. Humphrey, Assistant

RE  
enc.1



18038

August 15, 1939

Mr. P. G. Cope  
Langlois, Oregon

Dear Sir:

Herewith you will find Application No. 18038, Permit  
No. 13708, together with blue print.

The application has been approved and recorded in  
this office.