

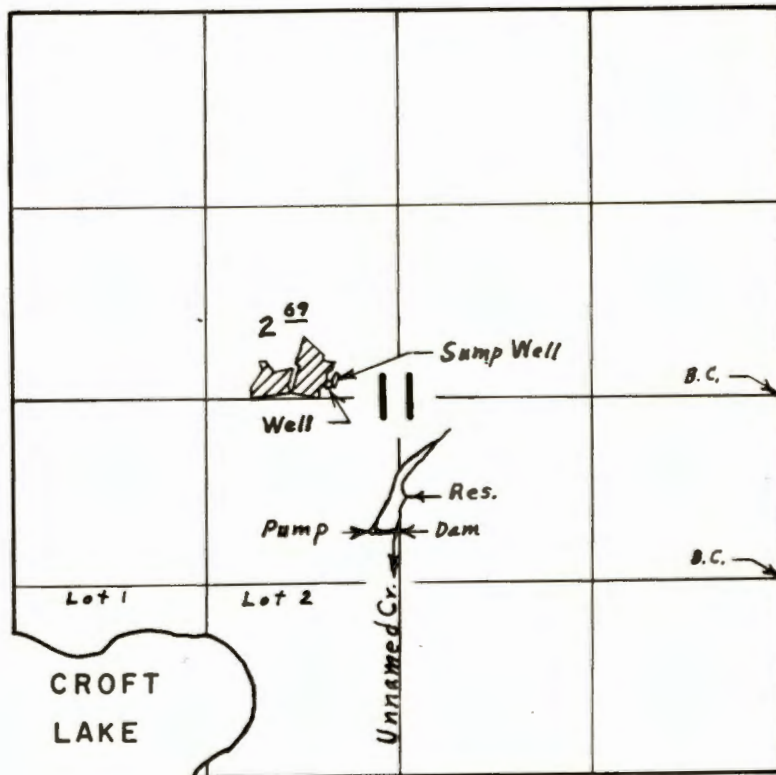

# T.30S. R.15W. W.M.



Div. Pts. located: Sump, 120' N. & 3060' W.; Well, 90' N. & 3100' W.; Res., 900' S. & 2670' W., all from E.  $\frac{1}{4}$  Cor. Section 11

## FINAL PROOF SURVEY UNDER

Application No. 52603 G-6739 Permit No. 39179 G-6265

IN NAME OF

**ADOLPH MOLTHU**

Surveyed Sept. 1., 1976. by L. E. Gould.

July 7, 1998

Alan & Elizabeth E. Foster  
P.O. Box 412  
Langlois, OR. 97450

With regard to the Water Right Ownership Update and the associated water rights:

<u>Application #'s</u>	<u>Permit #'</u>	<u>Certificate #'s</u>
S-52602	S-39820	51718
S-22723	S-18029	51557
S-52603	S-39179	47790
G- 6739	G- 6265	47789
R-52601	R- 6381	50352

The Water Resources Department has reviewed and accepted the letter you submitted. A copy of this letter will be forwarded to the Water Rights section of our department so that the appropriate database updates can be made.

We appreciate your cooperation with this program. If you have any questions, please contact me at (503) 378-8455 ext.289. The Department's toll free number is 1-800-624-3199.

Sincerely,

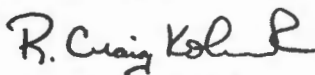

R. Craig Kohanek  
Technical Services Division

cc: Water Rights Section



Commerce Building  
158 12th Street NE  
Salem, OR 97310-0210  
(503) 378-3739  
FAX (503) 378-8130

Select by certificate 47789

Name: ADOLPH L MOLTHU

County : COOS  
 Status : NON-CANCELLED  
 Certificate type: OR  
 Certificate date: 4/23/1979

Application: G 6739  
 Permit : G 6265  
 Certificate: 47789  
 Supercedes certificate: 0

RT 1 BOX 1490  
 BANDON, OR 97411

Related documents:

Remarks :

Source	Use	P/S	Priority	Quantity	Location	LOT/DLC	Status
SUMP #1 > CROFT L	IR	P	11/25/1974	0.0700CFS	30 S 15 W 11 SENW		V

Legal description: 120 FT N & 3060 FT W FM E1/4 COR, S11  
 Rate: 1/40 Limit: 3.0 AFT/acre/year Other limits:

SUMP #1 > CROFT L	AG	P	11/25/1974	0.1400CFS	30 S 15 W 11 SENW		V
-------------------	----	---	------------	-----------	-------------------	--	---

Legal description: 120 FT N & 3060 FT W FM E1/4 COR, S11

SUMP #1 > CROFT L	TC	P	11/25/1974	0.4000CFS	30 S 15 W 11 SENW		V
-------------------	----	---	------------	-----------	-------------------	--	---

Legal description: 120 FT N & 3060 FT W FM E1/4 COR, S11

WELL #2 > CROFT L	TC	A	11/25/1974	0.4000CFS	30 S 15 W 11 SENW		V
-------------------	----	---	------------	-----------	-------------------	--	---

Legal description: 90 FT N & 3100 FT W FM E1/4 COR, S11

WELL #2 > CROFT L	IR	A	11/25/1974	0.0700CFS	30 S 15 W 11 SENW		V
-------------------	----	---	------------	-----------	-------------------	--	---

Legal description: 90 FT N & 3100 FT W FM E1/4 COR, S11

WELL #2 > CROFT L	AG	A	11/25/1974	0.1400CFS	30 S 15 W 11 SENW		V
-------------------	----	---	------------	-----------	-------------------	--	---

Legal description: 90 FT N & 3100 FT W FM E1/4 COR, S11

Points of aporopriations:

Use	P/S	Location	DLC/LOT	Acres	Status
CI	P	30 S 15 W 11 SENW		2.690	V
FR	P	30 S 15 W 11 SENW		0.000	V
CH	P	30 S 15 W 11 SENW		0.000	V

Oregon Water Resources Department  
Water Right Ownership Form

NOTICE TO SELLERS & BUYERS

By law all water belongs to the public [ORS 537.110]. In almost every instance a permit from the Water Resources Department is needed before using, diverting or storing any water [ORS 537.130]. However, most domestic wells do not require water rights. A water right stays with the land. In order to keep track of water right ownership, ORS 537.330 requires persons selling property that has water right to: 1) provide evidence of the water right to the buyer and 2) notify the Water Resources Department of the water right involved with the real estate transaction. Sellers are exempted from this requirement if the water uses are served by a water district or a city.

Water that has been used for a long time in one place or that involves a water structure (like a dam) that already exists is no guarantee that there is a water right which would allow the water use to continue.

If you have any question about this form or water right requirements, please contact your local watermaster or call the Water Resources Department at 378-8455.

Note: Please type or print legibly when filling in the following information. Use additional paper if necessary.

RECEIVED

JUN 30 1998

Property Seller Information:

Name: James C. and Marion M. McBee  
Street Address: P.O. Box 358  
City: Bandon State: OR Zip: 97411  
Phone: 541-347-3328

WATER RESOURCES DEPT.  
SALEM, OREGON

Property Buyer Information:

Name: Alan and Elizabeth E. Foster  
Street Address: P.O. Box 412  
City: Langlois State: OR Zip: 97450  
Phone: 541-348-9980

Property Description (attach additional pages if necessary):

County: COOS Township: 30 S Range: 15 W um Section: 11  
Tax lot number(s): 600  
Meets & bounds description (or attach copy of property deed & tax-lot map with the parcels highlighted): \_\_\_\_\_

Water Right Information (attach copy of water right permit or certificate & final proof map if available):

Application No: G-6739 Permit No: G-6265 Certificate No: 47789  
Will all the land associated with this water right be owned by the buyer?  
Yes  No

Name of individual completing this form: Alan Foster

Water Resources Department  
158 12th Street NE  
Salem, Oregon 97310-0210

Signature: Alan Foster  
Phone: 541-348-9980 Date: 6-22-98

August 11, 1994

JAMES C MCBEE  
PO BOX 358  
BANDON OR 97411

USER-ID: 26195

With regard to the pump test requirements for the following well and its associated water right:

<u>POD-ID</u>	<u>Well</u>	<u>Application</u>	<u>Permit</u>	<u>Certificate</u>	<u>Status</u>
27830	# 2	G-6739	G-6265	47789	Exempt

The Department has received your request for an exemption based on the results of previously tested POD-ID 27828. Our review indicates that the tested well and the well proposed for exemption:

- are located within a five-mile radius and
- appear to be completed in the same water-bearing zone.

Therefore, the Department is granting the exemption. This means that the additional well need not be tested. This exemption is valid only if all of the wells are owned by the same landowner.

We appreciate your cooperation in this program. If you have any questions, please contact Mike Zwart or Bill Ferber at the address below or by calling 378-8455.

Sincerely,

*Wendy Mollgaard*  
for

FRED LISSNER, Manager  
Groundwater/Hydrology Section

cc: Water Rights Section

3561W



Commerce Building  
158 12th Street NE  
Salem, OR 97310-0210  
(503) 378-3739  
FAX (503) 378-8130

June 13, 1994

JAMES C MCBEE  
PO BOX 358  
BANDON OR 97411

RE: USER-ID # 26195

With regard to the pump test requirements for the following well and its associated water right:

<u>POD-ID</u>	<u>Well</u>	<u>Application</u>	<u>Permit</u>	<u>Certificate</u>	<u>Status</u>
27828	# 2	G-6739	G-6265	47789	Approved
27827	# 1	G-6739	G-6265	47789	Exempt
27825	A Sump	G-6739	G-6265	47789	Exempt
27826	A Sump	G-6739	G-6265	47789	Exempt
27828	# 2	G-6739	G-6265	47789	Pending
27829	# 2	G-6739	G-6265	47789	Pending
27830	# 2	G-6739	G-6265	47789	Pending

The Water Resources Department has reviewed and accepted the pump test results you submitted for POD-ID 27828. The Department requires no further testing of this well at this time. However, you will be required to submit a static water level measurement of the well on the ten-year anniversary of the test you conducted.

In regards to POD-ID's 27827, 27826, 27825, they are sump wells (diameter greater than 36 inches and depth less than 30 feet). Such a condition constitutes grounds for a complete exemption for these three.

Our records indicate you have three additional wells on Permit G-6265, in which case, you may qualify for a multiple well exemption if all three of the following criteria are met:

- wells are located within a five-mile radius,
- wells appear to be completed in the same water-bearing zone and
- wells owned by the same landowner.



Commerce Building  
158 12th Street NE  
Salem, OR 97310-0210  
(503) 378-3739  
FAX (503) 378-8130

JAMES C. MCBEE  
JUNE 13, 1994  
PAGE TWO

If you feel you qualify for a multiple well exemption, please send in a request with verification, such as appropriate well logs.

We appreciate your cooperation in this program. If you have any questions, please contact Mike Zwart or Bill Ferber at the address below or by calling 378-8455.

Sincerely,

FRED LISSNER, Manager  
Groundwater/Hydrology Section

cc: Water Rights Section

3399W



Adolph L. Molthu  
Rt. 1, Box 1490  
Bandon, OR 97411

January 28, 1976

G-6739

Dear Mr. Molthu:

G-6265 and map.

January 9, 1975

G-6739  
52603

Adolph L. Molthu  
Rt. 1 Box 1490  
Bandon, OR 97411

Dear Sir:

Thank you for your check in the amount of \$18.00  
for the additional recording fees.

Your applications No. G-6739 and No. 52603 are  
now in satisfactory form for approval by the  
issuance of permits.

Very truly yours,

THOMAS E. SHOOK  
Assistant

TS:db  
Encl: Receipt No. 44642

RECEIVED

JAN 7 1975

STATE ENGINEER  
SALEM, OREGON



STATE  
ENGINEER

WATER RESOURCES DEPARTMENT

1178 CHEMEKETA STREET N.E. • SALEM, OREGON • 97310 • Phone 378-3739

TOM McCALL  
GOVERNOR

CHRIS L. WHEELER  
State Engineer

January 2, 1975

File No. G-6739  
52603

Adolph L. Molthu  
Rt. 1, Box 1490  
Bandon, OR 97411

Dear Mr. Molthu:

Your application for a permit to appropriate 1.27 cubic feet of water per second being 0.27 cubic foot of water per second for the irrigation of 2.69 acres, 0.50 cubic foot of water per second for frost control and 0.50 cubic foot of water per second for flood harvest from sump No. 1 and Well No. 2 has been received along with two legal descriptions and the fees of \$32.00. Your application has been filed as number G-6739.

We have also received your application for a permit to appropriate 1.5 cubic feet of water per second from an unnamed stream for flood harvesting along with a reproducible map and the fees of \$30.00. This application has been filed as number 52603.

Your ground water application numbered G-6739 requires an examination fee of \$15.00 in addition to a \$15.00 recording fee for frost control, a \$15.00 recording fee for flood harvest of cranberries, and a \$10.00 irrigation recording fee. We have applied \$32.00 to this application; however, an additional \$18.00 is required to complete the fees.

Further action will be held on your applications for a reasonable time pending receipt of the additional recording fees.

Very truly yours,

THOMAS E. SHOOK  
Assistant

TES:cdp

Encl. Receipt No. 43988 and 43989

January 2, 1975

G-6739  
52603

Adolph L. Molthu  
Rt. 1, Box 1490  
Bandon, OR 97411

Dear Mr. Molthu:

Your application for a permit to appropriate 1.27 cubic feet of water per second being 0.27 cubic foot of water per second for the irrigation of 2.69 acres, 0.50 cubic foot of water per second for frost control and 0.50 cubic foot of water per second for flood harvest from sump No. 1 and Well No. 2 has been received along with two legal descriptions and the fees of \$32.00. Your application has been filed as number G-6739.

We have also received your application for a permit to appropriate 1.5 cubic feet of water per second from an unnamed stream for flood harvesting along with a reproducible map and the fees of \$30.00. This application has been filed as number 52603.

Your ground water application numbered G-6739 requires an examination fee of \$15.00 in addition to a \$15.00 recording fee for frost control, a \$15.00 recording fee for flood harvest of cranberries, and a \$10.00 irrigation recording fee. We have applied \$32.00 to this application; however, an additional \$18.00 is required to complete the fees.

Further action will be held on your applications for a reasonable length of time pending receipt of the additional recording fees.

Very truly yours,

THOMAS E. SHOOK  
Assistant

TES:odp  
Encl. Receipt No. 43988 and 43989

YED

# Abstract of Permit No. G-6265

Application No. G-6739

Certificate No.

Name Adolph L. Molthu  
Address Route 1, Box 1490  
Bandon, Oregon, 97411

Source of water supply Sump No. 1 and Well No. 2 *trib Croft Lake*

Use Cranberry irrigation, Cranberry harvesting, and frost protection for 2.69 Acres

Point of diversion #1; 2450'S & 2940'W, #2; 2450'S & 2980'W from NE c., s.11, being within SE $\frac{1}{4}$ NW $\frac{1}{4}$  s.11, T.30S., R.15W., W.M.; Coos County

Number of acres ~~2.69~~ Wells located: Sump, 120' N. & 3060' W.; Well, 90' N. & 3100' W., both from E.  $\frac{1}{4}$  Cor. Sec. 11

### DESCRIPTION OF LAND TO BE IRRIGATED OR PLACE OF USE

Twp.	Range	Sec.	NE $\frac{1}{4}$				NW $\frac{1}{4}$				SW $\frac{1}{4}$				SE $\frac{1}{4}$			
			NE $\frac{1}{4}$	NW $\frac{1}{4}$	SW $\frac{1}{4}$	SE $\frac{1}{4}$	NE $\frac{1}{4}$	NW $\frac{1}{4}$	SW $\frac{1}{4}$	SE $\frac{1}{4}$	NE $\frac{1}{4}$	NW $\frac{1}{4}$	SW $\frac{1}{4}$	SE $\frac{1}{4}$	NE $\frac{1}{4}$	NW $\frac{1}{4}$	SW $\frac{1}{4}$	SE $\frac{1}{4}$
30 S	15 W	11								X								
										2.69								
		11	S. E. $\frac{1}{4}$ N. W. $\frac{1}{4}$												2.69			

\*from sump to be made up from Well.

Priority date November 25, 1974

Amount of water 0.40 c.f.s., being 0.07 c.f.s. for irrigation, 0.14 c.f.s. for harvesting and 0.40 c.f.s. for frost protection, with any deficiency in the supply

Time limit to begin construction ~~1-12-76~~ No. 1 when available, with any deficiency in the available supply from Sump No. 1 to be made up by appropriation from Well No. 2 provided the water to be diverted from sump  
Time limit to complete construction ~~10-1-77~~ extended to extended to  
Time limit to completely apply water ~~10-1-78~~ extended to extended to 0.40 c.f.s. for frost protection

Remarks: Limitations: ~~1/80 c.f.s., 2 1/2 ac.~~ 1/40<sup>th</sup> or its equivalent for each acre irrigated and shall be further limited to a diversion of not to exceed 3 acre feet per acre for each acre irrigated during the irrigation season of each year for cranberries. If for the irrigation of any other crop, this appropriation shall be limited to 1/80<sup>th</sup> of one cubic foot per second or its equivalent for each acre irrigated and shall be further limited to a diversion of not to exceed 2 1/2 acre feet per acre for each acre irrigated during the irrigation season of each year.

1976-M  
Sum  
Sept. 1, 1976  
L. E. Gould

CGM

Croft Lake Wells

Basin 17, Volume 3

... SMITH, deceased,  
... in consideration of Ten Dollars (\$10.00) and other  
valuable consideration not herein mentioned, to us paid by CLIFFORD  
GEORGE and DORIS DONLEY GEORGE (formerly Doris Donley Smith),  
husband and wife, grantees, do hereby grant, bargain, sell and  
convey unto the said Clifford George and Doris Donley George, as  
tenants by the entirety, all our right, title and interest in and  
to the following described real property, with the tenements,  
hereditaments and appurtenances thereunto belonging or in anywise  
appertaining, situated in the County of Coos, State of Oregon,  
to-wit:



The West half (W-1/2) of the Southeast quarter (SE-1/4) and the East 850 feet of the East half (E-1/2) of the Southwest quarter (SW-1/4) of Section eleven (11), Township thirty (30) South, Range fifteen (15) West of the Willamette Meridian, Coos County, Oregon, EXCEPT the following described tract of land: Beginning at the South quarter corner of Section eleven (11); thence West along the South line of Section eleven (11), 850 feet; thence North 850 feet; thence East 850 feet to the North and South quarter section line; thence South along said North and South quarter section line 100 feet to a point 750 feet North of the South quarter corner of said Section 11; thence East 282 feet; thence South 200 feet; thence East 1038 feet to the East line of the West half (W-1/2) of the Southeast quarter (SE-1/4) of said Section eleven (11); thence South to the South line of said Section eleven (11); thence West along the South line to the place of beginning; ALSO EXCEPTING, six (6) acres, more or less, in the Northeast corner described as follows: Beginning at a point on the North boundary of the Northwest quarter (NW-1/4) of the Southeast quarter (SE-1/4) of said Section eleven (11), 157 feet West from the Northeast corner of said forty; thence West on said North boundary 420 feet; thence South 7° West 630 feet; thence East parallel to said North boundary 420 feet, more or less, to the center line of existing graveled private roadway; thence North 7° East along said roadway center line 630 feet, more or less, to the point of beginning;

Deed - 1

307 69

RECEIVED

NOV 25 1974

STATE ENGINEER  
SALEM, OREGON

Application No. 52603 + 66739  
Permit No.

WARRANTY DEED  
1800

KNOW ALL MEN THESE PRESENTS, That ROBERT A. CHEATHAM and LUELLA L. CHEATHAM, grantors in consideration of Five Thousand (\$5,000.00), to them paid by ADOLPH L. MOLTHU and MABEL W. MOLTHU, grantees, do we hereby grant, bargain, sell and convey unto said grantees, their heirs and assigns, all the following real property, with the tenements, hereditaments and appurtenances, situated in the County of Coos and State of Oregon, bounded and described as follows, to-wit:

That portion of the following described real property lying South of the Croft Lake County Road:

East half (E $\frac{1}{2}$ ) of the Northwest quarter (NW $\frac{1}{4}$ ), Section Eleven (11), Township Thirty (30) South, Range Fifteen (15) West of the Willamette Meridian;

Except that parcel of land in the Southwest corner of the Northeast quarter (NE $\frac{1}{4}$ ) of the Northwest quarter (NW $\frac{1}{4}$ ) conveyed to I. T. Storm and wife by a deed recorded October 28, 1943, in Book 148, page 458, Deed Records, Coos County, Oregon;

Ernest  
To Isaac  
9-1943

Except those parcels in the West half (W $\frac{1}{2}$ ) of the Southeast quarter (SE $\frac{1}{4}$ ) of the Northwest quarter (NW $\frac{1}{4}$ ) conveyed to W. B. Haynes and wife by a deed recorded October 17, 1924, in Book 94, page 624, Deed Records, Coos County, Oregon, and to L. C. Eaton and wife by a deed recorded November 13, 1930, in Book 112, page 326, Deed Records, Coos County, Oregon;

Except that portion in the East half (E $\frac{1}{2}$ ) of the Southeast quarter (SE $\frac{1}{4}$ ) of the Northwest quarter (NW $\frac{1}{4}$ ) described as beginning at the Southwest corner of the Northwest quarter (NW $\frac{1}{4}$ ) of the Northeast quarter (NE $\frac{1}{4}$ ) of said Section Eleven (11); thence South to the Southwest corner of the Southwest quarter (SW $\frac{1}{4}$ ) of the Northeast quarter (NE $\frac{1}{4}$ ) of said Section; thence Westerly along the quarter section line 250 feet to a stake; thence in a straight line in a Northeasterly direction to the point of beginning.

To Have and to Hold the above described and granted premises unto the said grantees, their heirs and assigns forever.

And We the grantors do covenant that they are lawfully

2 5c

11 1

T30.5 15W

#1 SUMP 2940'W  
#2 Well 2980'W

Scale 1" = 500'

#2 2450.5  
#1 2450.5

HANBERRY  
ROSS

well  
sump

Supplement  
to wells

STREAM

3580 S

2660'W

Application # 52603 + 66734 Adolph L. Mollhu  
Permit No. 39179 & G 6265 1-130x1490 97411  
BANDON OREG.



2 sc

11

T30.5 15W

#1 SUMP 2940'W  
#2 Well 2980'W

Scale 1" = 500'

#2 2450 S  
#1 2450 S

• RANBERRY  
BOGS  
well  
SUMP

Supplement  
to wells

STREAN

3580 S

2660'W

Application Nos. 52665 + 66734 Adolph L. Moltko  
Permit No. 39179 \* G 6265 Box 1-130x1490 97411  
RANDON OREG.

## STATE OF OREGON

COUNTY OF

COOS

## Proof of Appropriation of Water

ADOLPH L. MOLTHU

of Rt. 1, Box 1490, Bandon  
has applied beneficially the waters of  
Sump No. 1 and Well No. 2

, State of Oregon, 97411

a tributary of Croft Lake for the purpose of  
cranberry irrigation, cranberry harvesting, and frost protection for 2.69 acres

under Permit No. G-6265 and that the use of said waters has been completed under the  
terms of said permit; that the priority of the right dates from

November 25, 1974

that the amount of water for the purposes aforesaid, has been actually beneficially used in the  
amount of

0.40 cubic foot per second, being 0.07 c.f.s. for irrigation, 0.14 c.f.s. for  
harvesting and 0.40 c.f.s. for frost protection, water to be diverted from sump  
No. 1 when available with any deficiency in the available supply from Sump No. \*

or its equivalent in case of rotation, measured at the point of diversion from the well.

The well is located in the SE $\frac{1}{4}$  NW $\frac{1}{4}$ , Section 11, T. 30 S., R. 15 W., W. M., Sump-120  
feet North and 3060 feet West; Well-90 feet North and 3100 feet West, both from  
the E $\frac{1}{2}$  Corner, Section 11

The amount of water used for irrigation, together with the amount secured under any other  
right existing for the same lands, shall be limited to one-fortieth of one cubic foot per second  
per acre, or its equivalent for each acre irrigated and shall be further limited  
to a diversion of not to exceed 3 acre feet per acre for each acre irrigated  
during the irrigation season of each year, for cranberries. If for the  
irrigation of any other crop, this appropriation shall be limited to 1/80th of  
one cubic foot per second or its equivalent for each acre irrigated and shall  
be further limited to a diversion of not to exceed 2 $\frac{1}{2}$  acre feet per acre for  
each acre irrigated during the irrigation season of each year,

and shall conform to such reasonable rotation system as may be ordered by the proper state officer.

A description of the place of use under the right, and to which such right is appurtenant, is  
as follows:

2.69 acres SE $\frac{1}{4}$  NW $\frac{1}{4}$   
Section 11  
T. 30 S., R. 15 W., W. M.

\* 1 to be made up by appropriation from Well No. 2 provided the total quantity  
from both sources shall not exceed 0.07 c.f.s. for irrigation, 0.14 c.f.s. for  
harvesting and 0.40 c.f.s. for frost protection.

I have read the above and foregoing proof of appropriation of water; I know the contents  
thereof, and that the facts therein stated are true.

IN WITNESS WHEREOF, I have hereunto set my hand this 6 day of April,

19 79

Adolph L. Molthu

# Abstract of Permit No. G-6265

Application No. G-6739

Certificate No.

1976-M  
Sept. 1, 1976  
L. E. Gould

Name **ADOLPH L. MATHU**  
 Address **RET BOX 1490 BANDON ORE.**  
 Source of water supply **UNNAMED STREAM, TRNS CROFT LAKE**  
 Use **CRANBERRY IRR., HARVESTING & FROST PROTECTION**  
 Point of diversion **COOS #2 2450' S 2940' W FR. NE COR. SEC 11 in SE NW 1/4 Sec 11**  
 Number of acres **5 1/2**

## DESCRIPTION OF LAND TO BE IRRIGATED OR PLACE OF USE

Twp.	Range	Sec.	NE 1/4				NW 1/4				SW 1/4				SE 1/4				
			NE 1/4	NW 1/4	SW 1/4	SE 1/4	NE 1/4	NW 1/4	SW 1/4	SE 1/4	NE 1/4	NW 1/4	SW 1/4	SE 1/4	NE 1/4	NW 1/4	SW 1/4	SE 1/4	
30S	15W	11																	

Priority date **11-25-74**  
 Amount of water **0.4 (0.07 IRR, 1/4 HARVESTING; 1/4 for FROST CONTROL)**  
 Time limit to begin construction **1-12-79**  
 Time limit to complete construction **10-2-78 extended to**  
 Time limit to completely apply water **10-1-79 extended to**

Remarks: **2 1/2" iron pipe 30' well in well. Open ditch pump to sump. Use: Cranberry irrigation, harvesting & temperature control. Tied to E 1/4 Cor. Sec 11 (I.R.C. S.B.2.)**  
 Field Engineer  
 Sept. 1, 1976 L. E. Gould

Abstract of Permit No. 202-11-202  
Mr. M. J. Hill

Certificate No. Application No. 202-11-202

Well #1 An excavation approximately 1/2 acre (Sump) wide on S. end of E. 1/4 Cor. Sec. 11  
Depth, approx. 12'

Pump: 10 H.P. G. Engine (Franklin)  
Belt Dr. Berkeley Cont. 2 1/2" Pulleys, 5" on Motor

DESCRIPTION OF LAND TO BE IRRIGATED OR PLACE OF USE

Two	Range	Sec.	NE 1/4	NW 1/4	SW 1/4	SE 1/4	NE 1/4	NW 1/4	SW 1/4	SE 1/4
Pipe:	140'	4"	V.C.							
	400'	3"	"							
	260'	3"	Alum.							
			2", 1 1/2", 1 1/4", 1"							P.V.C. Lateral.
Heads:	25		R. B. #25							Att
	20		" "	#30						30 op. at 1 time max.
	10		" "	#40						
Lift:	Suction	4' to 14'								Disch. '0'
										Total depth 52'

Well #2 6" Casing, Total depth 52'

Static Water Level (approx) 30'  
Priority date 11-25-74  
Amount of water (approx) 0.4

Pump: 3 H.P. Franklin, 3 stages, 1" Disch,  
Dr. Berkeley Cont. 2 1/2" Pulleys, 5" on Motor

Pipe: 40' 2" P.V.C. (Top well to Sump)  
10' 2" Iron

Lift: 30' all in well. Open disch. pump to sump

Use: Cranberry Irrigation, harvesting & Temperature Control.

Tie: To E. 1/4 Cor. Sec. 11  
(I.P.B.C. 2 B.Ts.)

Sept. 1, 1976, L. E. Gould  
Field Engineer

**Abstract of Permit No. G-6265**

Application No. G-6739

Certificate No.

Name **ADOLPH L. MOTHU**

Address **RT 1 BOX 1490 BANDON ORE.**

Source of water supply **2 Wells UNNAMED STREAM, TRIB CROFT LAKE**

Use **CRANBERRY IRR, HARVESTING & FROST PROTECTION**

Point of diversion **CDOS #1 2450' S 2940' W FR. NE COR. SEC 11 in SE NW & sec 11 #2 2450' S 2980' W**

Number of acres

**DESCRIPTION OF LAND TO BE IRRIGATED OR PLACE OF USE**

Twp.	Range	Sec.	NE <sup>1</sup> / <sub>4</sub>				NW <sup>1</sup> / <sub>4</sub>			SW <sup>1</sup> / <sub>4</sub>				SE <sup>1</sup> / <sub>4</sub>			
			NE <sup>1</sup> / <sub>4</sub>	NW <sup>1</sup> / <sub>4</sub>	SW <sup>1</sup> / <sub>4</sub>	SE <sup>1</sup> / <sub>4</sub>	NE <sup>1</sup> / <sub>4</sub>	NW <sup>1</sup> / <sub>4</sub>	SW <sup>1</sup> / <sub>4</sub>	SE <sup>1</sup> / <sub>4</sub>	NE <sup>1</sup> / <sub>4</sub>	NW <sup>1</sup> / <sub>4</sub>	SW <sup>1</sup> / <sub>4</sub>	SE <sup>1</sup> / <sub>4</sub>	NE <sup>1</sup> / <sub>4</sub>	NW <sup>1</sup> / <sub>4</sub>	SW <sup>1</sup> / <sub>4</sub>
30S	15W	11								2.47 AC. FROST FLOOD HARVESTING							

Priority date **11-25-74**

Amount of water **0.4 (.07 IRR), .14 HARVESTING; .4 for FROST CONTROL**

Time limit to begin construction **1-12-77**

Time limit to complete construction **10-1-78** extended to \_\_\_\_\_ extended to \_\_\_\_\_

Time limit to completely apply water **10-1-79** extended to \_\_\_\_\_ extended to \_\_\_\_\_

Remarks: **1; 2 1/2**

Info: Mr. Mott

Well #1 An excavation approx. 120' x 50' (Sump) wide on S. end & 25' wide on N. end. Depth, approx. 12' with water 8' to 10' deep.

Pump: 10 H.P. G. Engine 3500 R.P.M., Belt Dr. Berkeley Cent. 2 1/2" x 2" Pulleys, 5" on Motor, 4" on Pump

Pipe: 140' 4" P.V.C.  
400' 3" "  
260' 3" Alum.

2", 1 1/2", 1 3/4", 1" P.V.C. Lateral.

Heads: ~~25~~ R. B. #25  $\frac{9}{64} \times \frac{3}{32}$  #30  $\frac{9}{64} \times \frac{3}{32}$  30 op. at 1 time max.  
~~20~~ " " #40  $\frac{9}{64} \times \frac{3}{32}$   
10 " " #20  $\frac{9}{64} \times \frac{3}{32}$

Lift: Suction 4' to 14' Disch. 0'

Well #2 6" casing, Total depth 52'

Static W. 1' - 11'  
Pumping Level 30' (approx)

Pump: 3 H.P. Franklin, 3ph, 3500 R.P.M., Dix. Dr. Jaruz. Di. Sab, 3 stages, 1 1/2" Disch.

Pipe: 40' 2" P.V.C. (in well)  
10' 2" Iron (top well to sump)

Lift: 30' all in well. Open disch. pump to sump

Use: Cranberry Irrigation, harvesting & Temperature Control.

Tie: To E. 1/4 Cor. Sec. 11  
(I.P.B.C. 2 B.Ts.)

Sept. 1, 1976, L. E. Gould  
Field Engineer

G 6939

Name Steve and Mary Josse  
 Address P.O. Box 264 Beatty, OR 97621  
 Assigned Marvin H. & Joyce A. Hutchison ASSIGNED  
 Address P.O. Box 34, Beatty, OR 97621  
 Beginning construction MAR 24 1977  
 Completion of construction OCT 1 1977  
 Extended to .....  
 Complete application of water OCT 1 1978  
 Extended to .....  
 \*\*Martin W. & Lozetta Carelli ASSIGNED  
 P.O.B. 38, Beatty, OR 97621  
 \*\* Richard L. & Barbara Sether  
 215 SW 5th St., Corvallis, OR 97330

5/8/75 ASSIGNED  
 Application No. G 6662  
 Permit No. G 6662