

T 30 S R 15 W
Sec 11

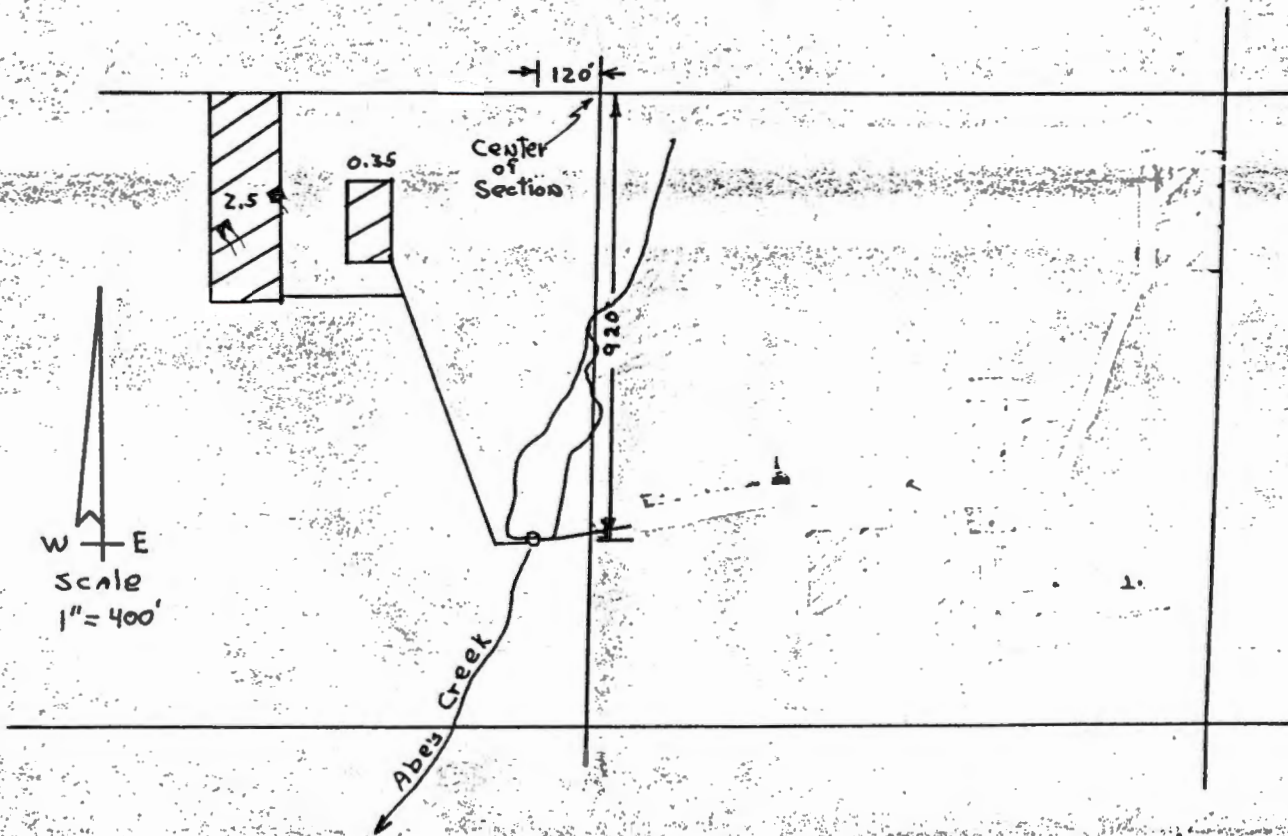

Application No. R-61485 & 61486
Permit No. R 8453 46813

RECEIVED
JUL 20 1982
WATER RESOURCES DEPT.
SALEM, OREGON



RECEIVED
MAY 8 1982
WATER RESOURCES DEPT.
SALEM, OREGON

RECEIVED
MAR 31 1981
WATER RESOURCES DEPT.
SALEM, OREGON

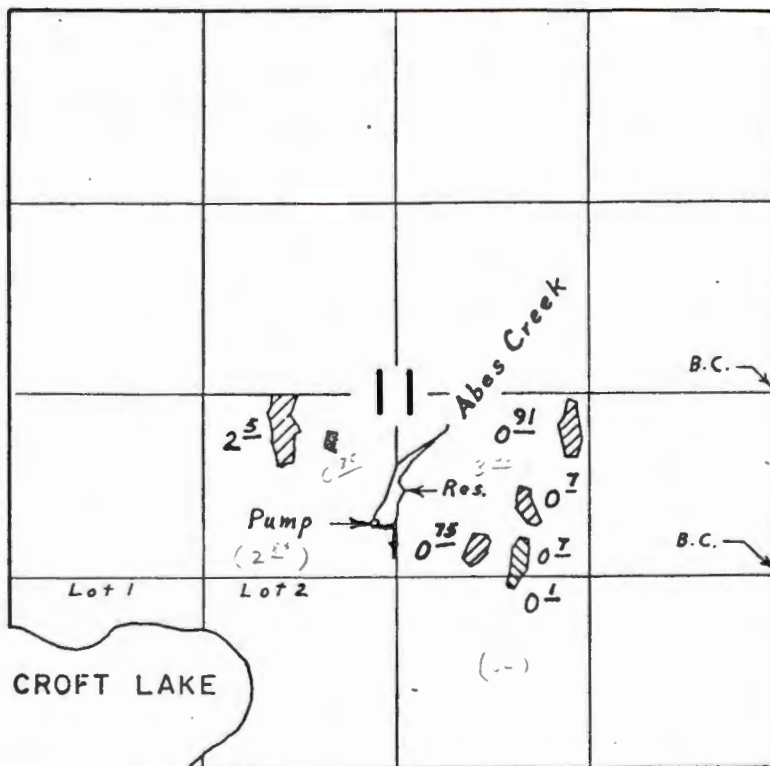
T.30S. R.15W. W.M.



Div. Pt. located 900' S. & 2670' W. from E. $\frac{1}{4}$ Cor. Sec. 11

Supplemental Irrig. 
Primary Irrig. 

FINAL PROOF SURVEY UNDER

R-52601 R-6381
Application No. 52602 Permit No. 39820
IN NAME OF

James C. & Marion M. McPhee

Surveyed Aug. 31, 1976, by L. E. Gould.



STATE OF OREGON
ROUTE SLIP



Date 8/31/88

TO:

Dallas Miller

FROM:

Suzie De

CHECK

- | | |
|------------------------------------------------------|----------------------------------------------------------------|
| <input type="checkbox"/> Approval | <input type="checkbox"/> Investigate |
| <input checked="" type="checkbox"/> Necessary Action | <input type="checkbox"/> Confer |
| <input type="checkbox"/> Prepare Reply | <input checked="" type="checkbox"/> Per Telephone Conversation |
| <input type="checkbox"/> For My Signature | <input checked="" type="checkbox"/> For Your Information |
| <input type="checkbox"/> Your Signature | <input type="checkbox"/> As Requested |
| <input type="checkbox"/> Comment | <input type="checkbox"/> Note and File |
| <input type="checkbox"/> Initial and Return | <input type="checkbox"/> Return With More Details |

COMMENTS:

THANKS FOR THE INFO!!





Oregon

John A. Kitzhaber, M.D., Governor

Water Resources Department

Commerce Building
158 12th Street NE
Salem, OR 97310-0210
(503) 378-3739
FAX (503) 378-8130

RECEIVED

SEP 03 1998

WATER RESOURCES DEPT.
SALEM, OREGON

July 14, 1998

ALAN & ELIZABETH FOSTER
PO BOX 412
LANGLOIS OR 97450

ph. 348.9980

RECEIVED

JUL 20 1998

WATERMASTER
DISTRICT 13

REFERENCE: Files 61486 & R-61485

The assignment of Permits 46813 and R-8453 from James and Marion McBee to you has been recorded in the records of the Water Resources Department.

Our records have been changed accordingly and the original is enclosed along with our receipt number 22414 covering the recording fee of \$25 you submitted. The excess fee of \$35 will be refunded to you as soon as possible.

Sincerely,

DALLAS S. MILLER
Water Rights Specialist

DSM:jh

Enclosure

cc: John Drolet, Watermaster
Sue DeHaas, Grants Pass Office
James & Marion McBee

*F.Y.I. ... FILES: 61486
R-61485
THESE JOBS ARE NOT IN THE
FIELD INVENTORY "TO BE SURVEYED"
THEY MAY NEED TO BE RESUBMITTED
INTO THE FIELD.
Sue De
SWR
8/17/98.*



Oregon

John A. Kitzhaber, M.D., Governor

Water Resources Department

Commerce Building
158 12th Street NE
Salem, OR 97310-0210
(503) 378-3739
FAX (503) 378-8130



RECEIVED
JUL 24 1998
WATERMASTER
DISTRICT 13

July 15, 1998

RICHARD & DONNA RAYBURN
RT 2 BOX 560
BANDON OR 97411

ph. 347-5121

REFERENCE: File 55205

The assignment by deed of Permit 41466 to you has been recorded in the records of the Water Resources Department. Our records have been changed accordingly and the original assignment is enclosed.

Sincerely,

Dallas S. Miller
Water Rights Specialist

DSM:jh

enclosure

cc: John Drolet, Watermaster
Sue DeHaas, Grants Pass Office

NOT INDEXED
DRAFTED MAP; PROPOSED CAPT.
SENT TO SALEM
3/31/92
SURVEYED 10/29/91
Jim De



Oregon

John A. Kitzhaber, M.D., Governor

Water Resources Department

Commerce Building
158 12th Street NE
Salem, OR 97310-0210
(503) 378-3739
FAX (503) 378-8130

August 5, 1998

ALAN FOSTER
PO BOX 412
LANGLOIS OR 97450

RE: Files R-61485 & 61486

Enclosed is our \$35 refund in excess assignment fees collected for Permits R-8453 and 46813.

Sincerely,

Janet Halladey
Water Rights Division

enclosure

STATE OF OREGON
WATER RESOURCES DEPARTMENT

INTEROFFICE MEMORANDUM

TO: MARIE LICARI, FISCAL

CC: FILE

FROM: ~~Russ Klassen~~ Janet Hailaday

*OK Draft
Jul*

SUBJECT: REQUEST FOR REFUND CHECK

PLEASE REFUND \$ 35⁰⁰ TO Alan Foster
FILE # 61486, RECEIPT # 22414. THESE FUNDS ARE
REFUNDED DUE TO :

- APPLICATION REJECTED
- APPLICATION WITHDRAWN
- EXCESS FEES COLLECTED FOR APPLICATION
- FILE CLOSED
- PROTEST FILING FEE
- OTHER: Excess assignment fees

PLEASE INCLUDE THE FOLLOWING MAILING ADDRESS ON THE CHECK:

Alan Foster
P.O. Box 412
Langlois, OR 97450

0428

JUL 17 1998



Oregon

John A. Kitzhaber, M.D., Governor

Water Resources Department

Commerce Building
158 12th Street NE
Salem, OR 97310-0210
(503) 378-3739
FAX (503) 378-8130

July 14, 1998

ALAN & ELIZABETH FOSTER
PO BOX 412
LANGLOIS OR 97450

REFERENCE: Files 61486 & R-61485

The assignment of Permits 46813 and R-8453 from James and Marion McBee to you has been recorded in the records of the Water Resources Department.

Our records have been changed accordingly and the number 22414 covering the recording fee of \$25 you refunded to you as soon as possible.

Sincerely,

DALLAS S. MILLER
Water Rights Specialist

DSM:jh

Enclosure

cc: John Drolet, Watermaster
Sue DeHaas, Grants Pass Office
James & Marion McBee

Janet
Please
REFUND \$35
- they ONLY
need our fee to
do these 2
Dallas

our receipt
\$35 will be



Oregon

John A. Kitzhaber, M.D., Governor

Water Resources Department

Commerce Building
158 12th Street NE
Salem, OR 97310-0210
(503) 378-3739
FAX (503) 378-8130

July 14, 1998

ALAN & ELIZABETH FOSTER
PO BOX 412
LANGLOIS OR 97450

REFERENCE: Files 61486 & R-61485

The assignment of Permits 46813 and R-8453 from James and Marion McBee to you has been recorded in the records of the Water Resources Department.

Our records have been changed accordingly and the original is enclosed along with our receipt number 22414 covering the recording fee of \$25 you submitted. The excess fee of \$35 will be refunded to you as soon as possible.

Sincerely,

DALLAS S. MILLER
Water Rights Specialist

DSM:jh

Enclosure

cc: John Drolet, Watermaster
Sue DeHaas, Grants Pass Office
James & Marion McBee

Janet

Please
Refund \$35

- they ONLY
need one fee to
do these 2

Dallas

REQUEST FOR ASSIGNMENT

I, (permit holder, applicant) James C. MARION M. McPee
P.O. Box 358 Baden OR 97411 541-347-3328
(mailing address) (city) (state) (zip) (phone)

CHECK ONE

- hereby assign all my interest in and to application/permit;

- hereby assign all my interest in and to a portion of application/permit (include a map showing portion of application assigned);

- hereby assign a portion of my interest in and to the entire application/permit;

Application # R-61485, Permit # R-8453;

OR GR Statement # _____, GR Certificate of Registration # _____ as filed in the office of the Water Resources Director, TO:

Alan and Elizabeth E. Foster 541 348-9980
(name of new owner) (phone #)

P.O. Box 412 Langlois OR 97450
(address) (city) (state) (zip)

(Note: If there are other owners of the property described in this Application, Permit of Certificate of Groundwater Registration you must attach a list of their names and addresses to this form.)

I hereby certify that I have notified all other owners of the property described in this Application, Permit or Certificate of Registration of this request for assignment.

Witness my hand this 26 6/26/98 day of June, 19 98.

applicant/permit holder James C. McPee

applicant/permit holder Marion M. McPee

PLEASE DO NOT WRITE IN THIS BOX

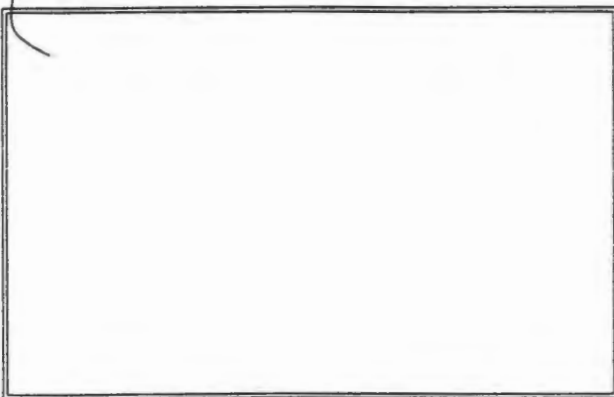

The completed assignment must be submitted to the Water Resources Department together with a recording fee of \$25. Additional pages will cost \$5 per page.

WATER RESOURCES DEPARTMENT
158 12TH STREET NE
SALEM, OREGON 97310-0210

RECEIVED
JUN 30 1998
WATER RESOURCES DEPT
SALEM, OREGON

6K
DSM

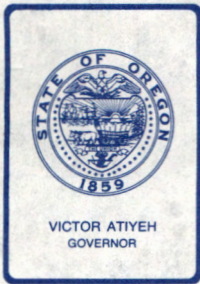

Water Resources Department

3850 PORTLAND ROAD NE, SALEM, OREGON 97310

PHONE 378-8508

SEP 29 1986

James C. and Marion M. McBee
88869 Evers Road
Elmira, OR 97437

Dear Mr. and Mrs. McBee:

REFERENCE: Files R-61485 and .61486

According to the terms of your Permits R-8453 and 46813 complete application of water was to have been made by October 1, 1985. Permit R-84533 for the storage of 3.6 acre-feet from Abe's Creek. Permit 46813 is for the appropriation of 0.43 cubic foot per second of water from Abe's Creek and reservoir for the purpose of temperature control, supplemental irrigation and flood harvesting.

Complete application of water means the application of water to a beneficial use under the permit to the full extent intended. In the case of irrigation, it means beneficial irrigation of all the lands the permittee intends to cover under the terms of the permit. If the water has been used, you should promptly submit notice describing the extent of completion as set forth in the letter accompanying your permit and also in our postal card of November 5, 1985.

ORS 537.260 provides that: "Whenever the time within which any appropriation under a permit should have been perfected has expired and the owner of the permit fails or refuses within three months thereafter to submit to the Water Resources Director proof of completion of the appropriation as required by ORS 537.230 and 537.250, the Water Resources Director may, after 60 days notice by registered mail, order the cancellation of the permit . . ."

In accordance with the provisions of ORS 537.260, you are hereby notified that unless proof of beneficial use is received within 60 days from the date of this letter, the permit(s) may be canceled without further notice.

If, for any reason, you are no longer interested in the project described by the permit, we would appreciate it if you would so advise. If the property involved has changed hands and any part of the project has been completed, you should immediately assign the permit to the new owner and advise us of his name and address. An assignment form will be furnished upon request.

Sincerely,

BRUCE A. ESTES, Supervisor
Survey/Certificate Section

BAE:wpc
6720D

CERTIFIED - RETURN RECEIPT REQUESTED

RECEIVED

OCT 23 1985

WATER RESOURCES DEPT
SALEM, OREGON

ASRSB10 REAL PROPERTY ASSESSMENT ROLL

13:26:53

10/22/85

ACCT NO	13642.00	MCBEE, JAMES C. &	T30 R15 S11	TL 1200
CODE	46.00	MARION M.		
CLASS	542		SPLIT CODE	13642.90
ACRES	37.78	PO BOX 358		
REF NO	84-17055	BANDON, OR	97411	

FIRE PATROL ACRE 50.93

FIRE PATROL 15.00

CURRENT YEAR
MARKET ASSESSED

PRIOR YEAR
MARKET ASSESSED

ZONED FARM & FOREST POTENTIAL	OOPR LAND				
ADDITIONAL	OOPR BLDG				
TAX LIABILITY	OTHER LAND	17,203	17,203	7,851	7,540
	OTHER BLDG				
	TOTAL VALUE	17,203	17,203	7,851	7,540
	TAXABLE VALUE		17,203		

PRESS:

ENTER - SEL	PF6 - PLANNING	PF9 - SALES	PF12 - LAND
PF1 - ADV	PF7 - TAXROLL	PF10 - INDEX	
PF2 - RCD	PF8 - MOBIL XREF	PF11 - OOPR	CLEAR - EXIT

ASRSB10 REAL PROPERTY ASSESSMENT ROLL

13:27:23

10/22/85

ACCT NO	13642.90	MCBEE, JAMES C. &	T30 R15 S11	TL 1200
CODE	46.02	MARION M.		
CLASS	542		SPLIT CODE	13642
ACRES	5.00	PO BOX 358		
REF NO	84-17055	BANDON, OR	97411	

MOBILE XREF 133001

CURRENT YEAR
MARKET ASSESSED

PRIOR YEAR
MARKET ASSESSED

ZONED FARM & FOREST POTENTIAL	OOPR LAND				
ADDITIONAL	OOPR BLDG				
TAX LIABILITY	OTHER LAND	8,694	8,694	9,204	8,840
	OTHER BLDG	4,800	4,800	5,000	4,800
	TOTAL VALUE	13,494	13,494	14,204	13,640
	TAXABLE VALUE		13,494		

PRESS:

ENTER - SEL	PF6 - PLANNING	PF9 - SALES	PF12 - LAND
PF1 - ADV	PF7 - TAXROLL	PF10 - INDEX	
PF2 - RCD	PF8 - MOBIL XREF	PF11 - OOPR	CLEAR - EXIT

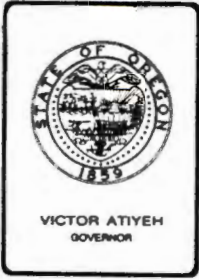

Water Resources Department

MILL CREEK OFFICE PARK

555 13th STREET N.E., SALEM, OREGON 97310

PHONE 378-8508

October 21, 1985

Coos County Assessor's Office
Mr. Raymond E. Philby
Coquille, OR 97423

REFERENCE: File Numbers R-61485 & 61486

Dear Mr. Philby:

Could you please provide this office with the name and address
of the current owner of the lands shown on the enclosed map print?

Your assistance would be appreciated.

Sincerely,

Jackie M. Warner
Secretary
Survey/Certificate Section

JMW

Enclosure

T.30S. R.15W. W.M.

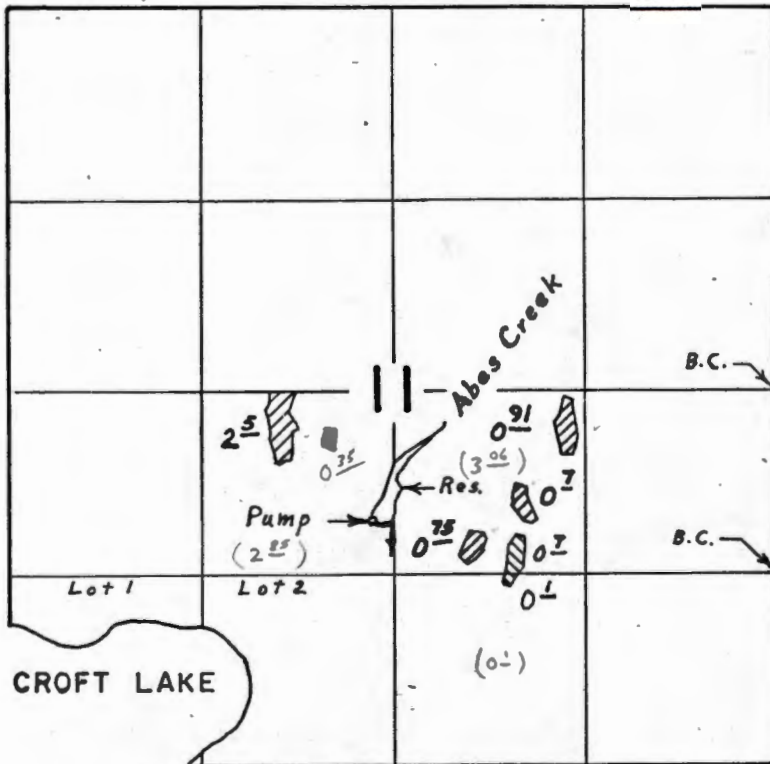

Div. Pt. located 900'S. & 2670'W. from E. 1/4 Cor. Sec. 11

Supplemental Irrig. 

Primary Irrig. 

FINAL PROOF SURVEY UNDER

R-52601 R-6381
Application No. 52602 Permit No. 39820
IN NAME OF

James G. & Marion M. McBee

Surveyed Aug. 31, 1976, by L. E. Gould.

19030

R-61485

Application No.

Permit No.

RECEIVED

MAR 31 1981

STATE OF OREGON WATER RESOURCES DEPARTMENT

Application for a Permit to Construct a Reservoir WATER RESOURCES DE SALEM, OREGON

I, James C. McBee AND MARION M. McBee

(Name of Applicant)

of 88869 EVERS RD

(Mailing Address)

ELMIRA

(City)

State of ORe

97437

(Zip Code)

Phone No. 935-7326

do hereby make application for a permit to construct the UNNAMED Reservoir reservoir and to store the unappropriated waters of the State of Oregon, subject to existing rights.

1. The name of the stream from which the reservoir is to be filled is Abe's Creek

tributary to CROFT LAKE

2. If not in channel of a stream, state how it is to be filled. N/A

3. The dam will be located in the N.E. 1/4 of the S.W. 1/4 of Section 11

Township 30S, Range 15W, W. M.

4. The maximum height will be 9.9 feet above stream bed or ground surface at the

centerline. The top width will be 12 feet, slope of upstream face 1 1/2/1

slope of downstream face 1 1/2/1, and height of dam above water line when full

2 feet.

5. The dam will be (check one) earthfill, concrete, flashboard, other.

If "other", give description:

6. Give the location, description, and dimensions of the outlet conduit: Two 18" phi CMP

(All dams across natural stream channels must be provided with an outlet conduit, of such capacity and location to pass the normal flow of the stream at any time)

Application No. R-61485 Permit No. Supp. 300

7. The impounded water will be used for IRRIGATION, Temp CONTROL, & Supp Flood Harvest
Flood Harvest Flood harvest 1.2 AF Flood Harvest
1.2 AF CRANBERRY IRRIGATION Supplemental

8. The amount of water to be stored is 3.6 8.6 (1.2 AF Temp. Control Supplemental acre feet.)

9. The area submerged by the reservoir, when full, will be 0.34 1.5 acres,
 and the maximum depth of water will be 1.0 feet.

10. Give the location and dimensions of the spillway A HALF CULVERT 18" DIA. AT CENTER
 (State whether over or around dam)

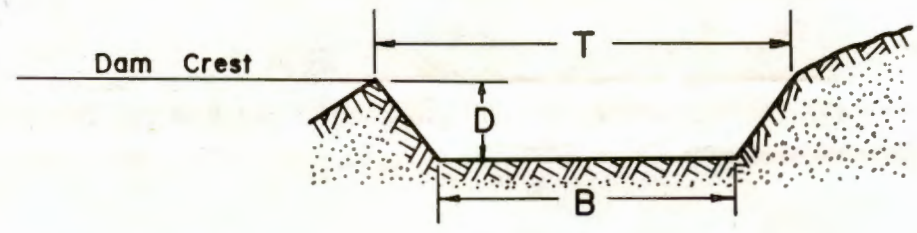

The bottom width of the spillway, B, will be _____ feet.

The top width of the spillway, T, will be _____ feet.

The distance between the crest of the dam and the crest of the spillway, D, will be 30" feet.
 (Must be at least 2 1/4 feet)

If any other type of spillway describe and give dimensions:

.....

11. Construction work will begin on or before Sept 1, 1981

12. Construction work will be completed and the reservoir filled by Sept 1 1983

Remarks: ~~There is insufficient water in She's Creek in order to permit direct pumping for flood harvest use, therefore as water is depleted during summer months for irrigation use and temperature control use, the reservoir will act as a holding pond for storing water for flood harvest.~~

Reservoir spillway & part of structure washed out last year and enlarged by 3.6 AF when rebuilt.

RECEIVED

MAY 3 1982

WATER RESOURCES DEPT
SALEM, OREGON

RECEIVED

JUL 20 1982

WATER RESOURCES DEPT.
SALEM, OREGON

James C. McBee
Signature of Applicant
Marion M. McBee

This is to certify that I have examined the foregoing application, together with the accompanying maps and data, and return the same for..... correction and completion.....

In order to retain its priority, this application must be returned to the Water Resources Director with corrections on or before..... ~~May 3~~ July 6, 1982....., 19. 82

WITNESS my hand this ~~1st~~ 5th day of ~~March~~ May, 19. 82 1982

James E. Sexson..... Water Resources Director

By *Chris L. Hughes*
Chris L. Hughes

This instrument was first received in the office of the Water Resources Director at Salem, Oregon, on the

31 day of *March*, 19 *81*, at *11:00* o'clock *A*.M.

Application No. *R-61485*

Permit No.....

PC ✓

Application No. R-61485

Permit No.

**Permit to Construct a Reservoir
and Store for Beneficial Use the Public Waters
of the State of Oregon**

This is to certify that I have examined the foregoing application and do hereby grant the same subject to the following limitations and conditions. The right herein granted is limited to the ^{enlargement} construction of a _{const under Permit R-6381}

res. and storage of water from Abe's Creek to be
approp. under App. 61486, Per. — for sup. irr,
temp. control, and flood harvest.

The right hereunder shall be limited to the storage of 3.6 acre feet.
being 1.2 a.f. for sup. irr, 1.2 a.f. for temp. cont, and 1.2 a.f. for flood harvest.

The priority date of this permit is July 20, 1982

Actual construction work shall begin on or before and shall thereafter be prosecuted with reasonable diligence and be completed on or before October 1, 19.....

WITNESS my hand this day of, 19.....

Water Resources Director

RWX B

August 27, 1982

James C. & Marion M. McBee
88869 Evers Road
Elmira, OR 97437

61456
R-61485

46813 & R-8453



Water Resources Department

MILL CREEK OFFICE PARK

555 13th STREET N.E., SALEM, OREGON 97310

PHONE 378-3066
1-800-452-7813
(message line)

July 21, 1982

James C. and Marion M. McBee
88869 Evers Road,
Elmira, Oregon 97437

Dear Mr. and Mrs. McBee:

REFERENCE: File Nos. R-61485 and 61486

Thank you for returning Applications R-61485 and 61486, and the accompanying map.

Your applications were returned to you and were endorsed so that in order to retain their priority dates, they were to have been received in this office on or before July 6, 1982. The new priority date of your applications is July 20, 1982, the date they were received.

Your applications are now in satisfactory form and will be considered for issuance of permits with the next group to be processed.

Sincerely,

Chris L. Hughes
Senior Water Rights Examiner

CLH/jw

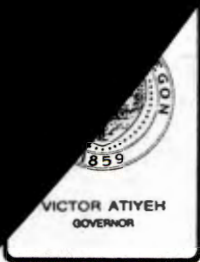

Water Resources Department

MILL CREEK OFFICE PARK

555 13th STREET N.E., SALEM, OREGON 97310

PHONE 378-3066

1-800-452-7813

(message line)

May 5, 1982

James C. and Marion M. McBee
88869 Evers Road
Elmira, Oregon 97437

REFERENCE: File Nos. R-61485 and 61486

Dear Mr. and Mrs. McBee:

Thank you for returning Applications R-61485 and 61486, and the accompanying map.

There are two existing rights of record for use of water from Abe's Creek and an existing right of record for storage of water from Abe's Creek which pertains to the land described in your new application.

All of the land described in your new application except 0.35 acre in the NE $\frac{1}{4}$ SW $\frac{1}{4}$ has full irrigation and flood harvesting rights from Abe's Creek and from 5.0 acre feet of stored water from the reservoir. None of the land has existing rights for temperature control.

Your existing right for storage in your reservoir is for 5.0 acre feet. If you have increased the capacity of your reservoir, please state this fact in the Remarks Section of Application R-61485. The amount of water to be listed in Item 8 is the increased amount of storage, 3.6 acre feet. The 3.6 acre feet can then be broken down to the amount of water to be stored for each use of supplemental irrigation, temperature control, and flood harvesting. It appears that all three of these uses should appear in Item 7 of Application R-61485 and in Item 5 of Application 61486.

Since all lands now have a primary right from Abe's Creek, only supplemental irrigation should be included as a use.

This is the maximum amount we will allow on your new permit for the uses described in your application: 0.90 cubic foot per second for temperature control of 5.96 acres, .01 cubic foot per second for supplemental irrigation of 0.35 acre, and .02 cubic foot per second for flood harvesting of 0.35 acre.

In Item 3 of Application 61486, please list 0.35 acre of supplemental irrigation in the NE $\frac{1}{4}$ SW $\frac{1}{4}$ and delete irrigation of 0.75 acre in the NW $\frac{1}{4}$ SE $\frac{1}{4}$.

James C. and Marion M. McBee
May 5, 1982
Page 2

I am returning your Applications R-61485 and 61486 for correction.
I am also returning the map for reference. The applications are
endorsed and in order to retain their priority date, they must
be received in this office on or before July 6, 1982.

Sincerely,

Chris L. Hughes
Senior Water Rights Examiner

CLH/jw

- - Enclosure

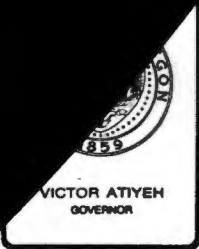

Water Resources Department

MILL CREEK OFFICE PARK

555 13th STREET N.E., SALEM, OREGON 97310

PHONE 378-3066
1-800-452-7813
(message line)

March 1, 1982

James C. & Marion M. McBee
88869 Evers Road
Elmira, OR 97437

Dear Mr. & Mrs. McBee:

Reference: Files R-61485 & 61486

Your Applications R-61485 and 61486 describing the proposed use of 8.6 acre feet and 3.884 cubic feet per second of water from Abe's Creek and a reservoir for temperature control and flood harvest on 5.96 acres; together with the map and legal description, have been reviewed. Enclosed are Receipts 23428 and 23429 for fees. I apologize for the delay in processing your applications.

The reservoir, as shown on your map, is much larger than 0.34 acres as listed in Item 9 of Application R-61485. Please amend the application and/or the map for proper size of the reservoir. A reservoir with a surface area of 0.34 acres and a maximum depth of 10.0 feet will store maybe 2.5 to 3.0 acre feet of water at the most.

The amount of water to be stored as stated in Item 8 of Application R-61485 must be broken down to the amount of water to be stored for each use in Item 7.

Application 61486, as submitted, will not allow the use of stored water from the reservoir. Please include the reservoir along with Abe's Creek as a source in Item 1 of Application 61486.

Please show on the map which 0.75 acre parcel is to be irrigated in the NW $\frac{1}{4}$ SE $\frac{1}{4}$ of Section 11.

The maximum duty allowed for irrigation of cranberries is 1/40 cubic foot per second per acre; for temperature control, 0.15 cubic foot per second per acre; for harvesting, 0.05 cubic foot per second per acre. The total that could be allowed on your permit would be 0.02 cubic foot per second for irrigation, 0.89 cubic foot per second for temperature control, and 0.3 cubic foot per second for harvesting.

Page Two
March 1, 1982
Files R-61485 & 61486

I am returning your applications and map for correction and completion. The applications are endorsed and in order to retain their priority dates, they must be received in this office on or before May 3, 1982.

Sincerely,

Chris L. Hughes
Senior Water Rights Examiner

CLH:slm
Enclosures

Water Resources Department

MILL CREEK OFFICE PARK

555 13th STREET N.E., SALEM, OREGON 97310

PHONE

378-3066 or

1-800-452-7813

April 15, 1981

James C. and Marion M. McBee
88869 Evers Road
Elmira, OR 97437

Dear Mr. and Mrs. McBee:

REFERENCE: Files R-61485 and 61486

Your application for a permit to construct a reservoir to store 8.6 acre-feet of water from Ames Creek for irrigation, temperature control and flood harvesting has been filed as R-61485. Also received was the fee of \$30 for which our Receipt 23428 is enclosed.

Also received was your application for a permit to use 3.884 cubic feet of water per second from Ames Creek and the reservoir for irrigation of 0.75 acre and temperature control and flood harvesting on 5.96 acres. Received with this application and map was the fee of \$92 for which our Receipt 23429 is enclosed.

Because your applications are for generally the same project as Applications R-52601 and 52602, action will be withheld on these applications until final determination of the rights under R-52601 and 52602 are made.

Sincerely,

DONALD R. BUELL
Water Rights Engineer

DRB:wpc
enclosures
4634A

COPY

Undivided Interest
ASSIGNMENT

I, Doris George of
(Name of Permittee)

P.O. Box 1026 Bandon Oregon
(Mailing Address) (City) (State) (Zip)

do here assign all my interest in and to water right application No. R-52601 52602,

R-6381
permit No. 39820, of record in the office of the Water Resources Depart. to

Frederic G. Gernandt of
(Name)

P.O. Box 533 Bandon Oregon
(Mailing Address) (City) (State) (Zip)

WITNESS my hand this 10th day of September, 1980.

Doris George
(Signature of Permittee)

Beginning at a point on the East line of the SW 1/4 of the SE 1/4 of Section 11, Township 30 South, Range 15 West of the Willamette Meridian, Coos County, Oregon, 1265.75 feet North of the Southeast corner of said quarter quarter; thence North along the 1/16th line 1400 feet to the Northeast corner of the NW 1/4 of the SE 1/4 of said Section 11; thence West along the quarter line 157 feet; thence South 7° West 630 feet; thence West 420 feet; thence North 7° East 630 feet to the quarter section line; thence West along the quarter section line 1593 feet, more or less, to the Northwest corner of the East 850 feet to the NE 1/4 of the SW 1/4; thence South and parallel to the N-S 1/4 Section line 1790 feet to a point 850 feet North of the South line of said Section 11; thence East 850 feet to the quarter section line running North and South in said section; thence North 01° 43' 11" East along the quarter section line 417.75 feet; thence South 88° 55' East 1296.84 feet to the point of beginning.-----

The completed assignment must be submitted to the Water Resources Department, Mill Creek Office Park, 555 13th Street, N.E., Salem, Oregon 97310

\$2.00 fee.

Application No.
Permit No.

R-61485 & 61486
R 8453 46813

RECEIVED

MAR 31 1981

WATER RESOURCES DEPT
SALEM, OREGON

COOS COUNTY ASSESSOR
COURTHOUSE
COQUILLE, OREGON 97423-1898

PRESORTED
FIRST CLASS



State of Oregon Water Resources Department
Mill Creek Office Park
% Jackie M. Warner
555 13th St. N.E.
Salem, Ore 97310

PS Form 3811, July 1983 447-845

SENDER: Complete items 1, 2, 3 and 4.
Put your address in the "RETURN TO" space on the reverse side. Failure to do this will prevent this card from being returned to you. The return receipt fee will provide you the name of the person delivered to and the date of delivery. For additional fees the following services are available. Consult postmaster for fees and check box(es) for service(s) requested.

1. Show to whom, date and address of delivery.
2. Restricted Delivery.

3. Article Addressed to:
JAMES C. AND MARION M. McBEE
88869 Evers Rd.
Elmira, OR 97437

4. Type of Service: <input checked="" type="checkbox"/> Registered <input type="checkbox"/> Insured <input type="checkbox"/> Certified <input type="checkbox"/> COD <input type="checkbox"/> Express Mail	Article Number 56709
--------------------------------------------------------------------------------------------------------------------------------------------------------------------------------------------------------------------	-----------------------------

Always obtain signature of addressee or agent and DATE DELIVERED.

5. Signature -- Addressee
X

6. Signature -- Agent
X

7. Date of Delivery

8. Addressee's Address (*ONLY if requested and fee paid*)

DOMESTIC RETURN RECEIPT

R-61485 & 61486 JW



Water Resources Department

3900 PORTLAND ROAD NE
SALISBURY, OREGON 97310

CONSERVE WATER
FOR
OREGON'S FUTURE



Claim Check

No.

399146

Hold

Date

9/30

1ST Notice

2ND Notice

Return

Detached from
PS Form 3849-A,
Oct. 1985

Order expired

RETURNED TO SENDER
REASON CHECKED
Unclaimed
Attempted-Not known
Insufficient Address
No such street
No such office in
Do not re-mail

RECEIVED

OCT - 1 1986

WATER RESOURCES DEPT.
SALISBURY, OREGON

CERTIFIED MAIL
RETURN RECEIPT REQUESTED
No. **56709**

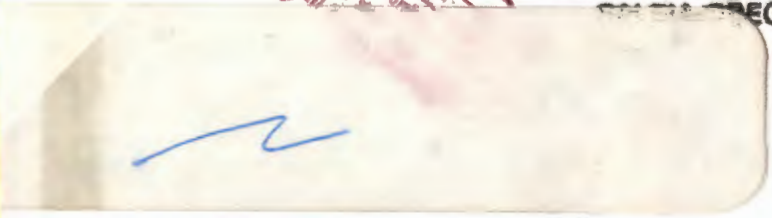



Water Resources Department

3850 PORTLAND ROAD NE
SALEM, OREGON 97310

RETURNED TO SENDER
 REASON CHECKED
 Undelivered _____ Refused _____
 Attempted Not known _____
 Insufficient Address _____
 No such street _____
 No such office in state _____
 Do not remain in this envelope

CONSERVE WATER
FOR
FUTURE GENERATIONS



UNDELIVERABLE AS RETURNED
 TO SENDER
 ADDRESS
 88869 EVERS RD
 ELMIRA, OR 97437

PRIORITY MAIL FIRST CLASS
 OFFICIAL MAIL
 REGISTERED MAIL
 REGISTERED MAIL



WATER RESOURCES DEPT.
SALEM, OREGON

JAMES E. AND MARION M. McBEE
88869 Evers Rd.
Elmira, OR 97437

WR

ELMIRA, OR
7 PM
'APR 22.
1987
97431



RECEIVED

MAR 31 1981

WATER RESOURCES DEPT

SALEM, OREGON

Beginning at a point on the East line of the SW 1/4 of the SE 1/4 of Section 11, Township 30 South, Range 15 West of the Willamette Meridian, Coos County, Oregon, 1265.75 feet North of the Southeast corner of said quarter quarter; thence North along the 1/16th line 1400 feet to the Northeast corner of the NW 1/4 of the SE 1/4 of said Section 11; thence West along the quarter line 157 feet; thence South 7° West 630 feet; thence West 420 feet; thence North 7° East 630 feet to the quarter section line; thence West along the quarter section line 1593 feet, more or less, to the Northwest corner of the East 850 feet to the NE 1/4 of the SW 1/4; thence South and parallel to the N-S 1/4 Section line 1790 feet to a point 850 feet North of the South line of said Section 11; thence East 850 feet to the quarter section line running North and South in said section; thence North 01° 43' 11" East along the quarter section line 417.75 feet; thence South 88° 55' East 1296.84 feet to the point of beginning.-----

Application No R 61485
Permit No. 8453

Send orig letter 1st

Class to:

P.O. Box 358

Benton 9741

60 days

Mailed Form 100
letter again to:

4-29-89

ju

Clelan F. Dudek

G-10230

C 10-1--7

871

G-11075

WATER RESOURCES DEPT
3850 PORTLAND ROAD N.E.
SALEM, OREGON 97310

RECEIVED

OCT 31 1985

WATER RESOURCES DEPT
SALEM, OREGON

James C. & Marion M. McBee
88869 Eyers Rd.
Elmirays OR 97437



UNDELIVERABLE AS ADDRESSED
UNABLE TO FORWARD



REASON CHECKED
Unclaimed _____
Attempted _____
Insufficient Address _____
No such address _____
Do not open _____
Do not mail _____

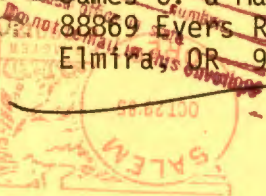
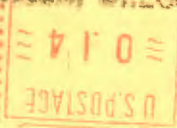

CONSERVE WATER
FOR
OREGON'S FUTURE

R 61485-
61486

C

STATE OF OREGON
Office of the Water Resources Director
Salem, Oregon 97310

R 8453
46813

According to the terms of Permit No. 46813, the water should have been completely applied to the proposed use on or before October 1, 1985. A blank (Form C) upon which to notify this office of the complete application of water to the proposed use is attached to your permit. If the water was so applied, or all you intend to develop, you should promptly fill out and file this notice. If all the water has not been applied and you intend to fully utilize the same, an application for extension of time should be made. If you have abandoned the development, notice to this effect with authority to cancel the permit would be greatly appreciated.

Sub 1981

Application No. **K- 61485**

Permit No. **R 8453**

Name **James C. and Marion M. McBee**

Address **88869 Evers Rd. Elmira, OR 97437**

Assigned

Address

Beginning construction **AUG 16 1983**

Completion of construction **OCT 1 1984**

Extended to

Complete application of water

Extended to